

District I
PO Box 1980, Hobbs, NM 88241-1980

District II
PO Drawer DD, Artesia, NM 88211-0719

District III
1000 Rio Brasos Rd., Aztec, NM 87410

District IV
PO Box 2088, Santa Fe, NM 87504-2088

State of New Mexico
Department of Minerals & Natural Resources

OIL CONSERVATION DIVISION
PO Box 2088
Santa Fe, NM 87504-2088

Form C-102

Revised February 10, 1994

Submit to Appropriate District Office

State Lease - 4 Copies

Fee Lease - 3 Copies

RECEIVED

AUG 10 10 54 AM '95

AMENDED REPORT

WELL LOCATION AND ACREAGE DEDICATION PLAT

API Number 30-015-28667	Pool Code 03715	Pool Name AVALON DELAWARE 3715
Property Code	Property Name AVALON (DELAWARE) UNIT	Well Number 2218
OGRD No. 007673	Operator Name Exxon Corp.	Elevation 3216'

Surface Location

UL or lot no.	Section	Township	Range	Lot Idn	Feet from the	North/South line	Feet from the	East/West line	County
1	31	20S	28E		2438'	SOUTH	78'	EAST	EDDY

Bottom Hole Location If Different From Surface

UL or lot no.	Section	Township	Range	Lot Idn	Feet from the	North/South line	Feet from the	East/West line	County
Dedicated Acres 40	Joint or Infill	Consolidation Code	Order No.						

NO ALLOWABLE WILL BE ASSIGNED TO THIS COMPLETION UNITL ALL INTERESTS HAVE BEEN CONSOLIDATED
OR A NON-STANDARD UNIT HAS BEEN APPROVED BY THE DIVISION

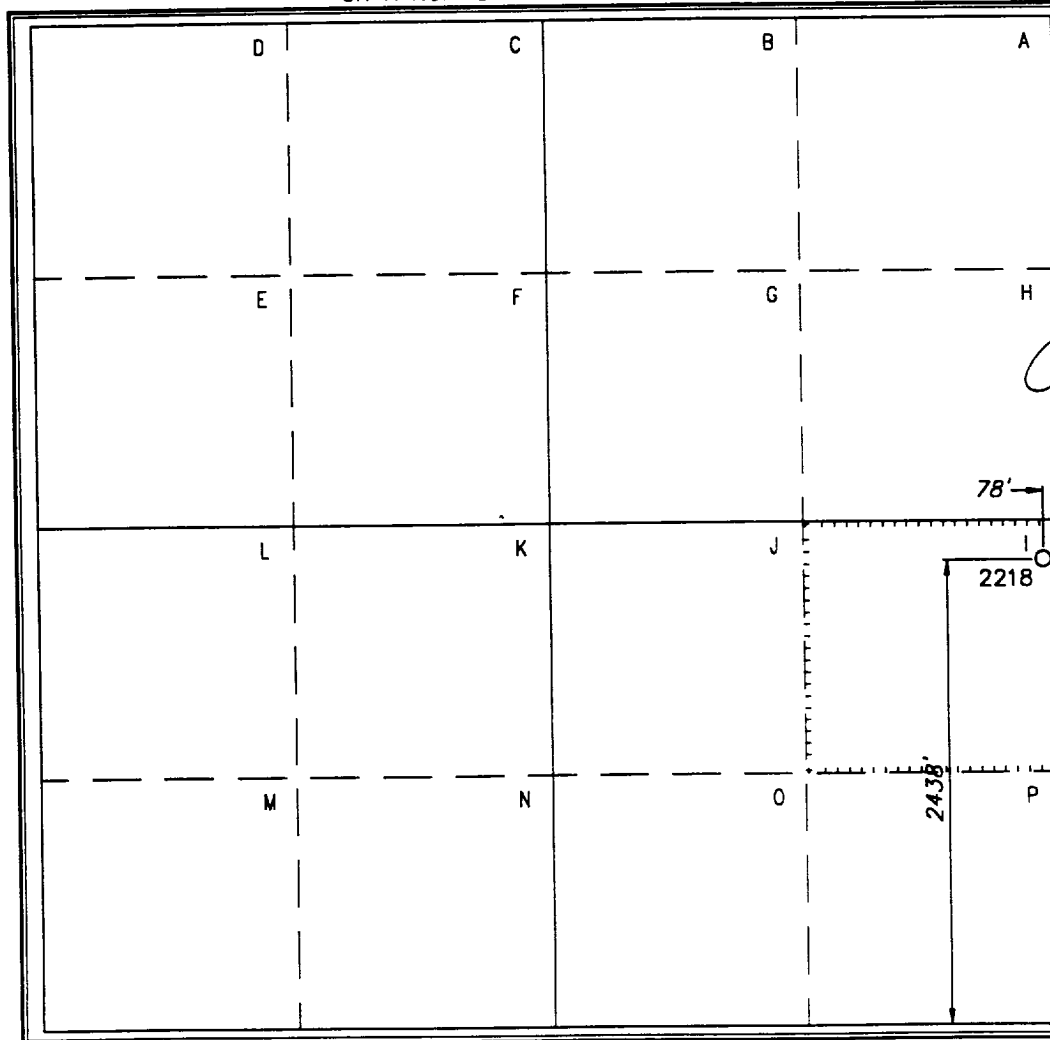

OPERATOR CERTIFICATION

I hereby certify that the information contained herein is true and complete to the best of my knowledge and belief.

Jack R. Glass for
Signature
C.H. Harper
Printed Name
Permits Supervisor
Title
8/9/95
Date

SURVEYOR CERTIFICATION

I hereby certify that the well location shown on this plat was plotted from field notes of actual surveys made by me or under my supervision, and that the same is true and correct to the best of my belief.

6/8/95

Date of Survey

Signature and Seal of Professional Surveyor.

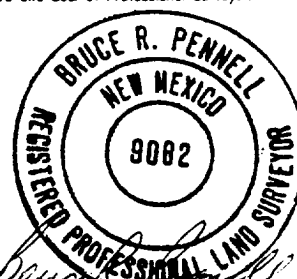

Certificate Number 9082

Distance to nearest Town 5.5 Miles N of CARLSBAD, New Mexico.	Drawn By SRP	Date 7/21/95	Drawing File Name File No.: A10981b
---	------------------------	------------------------	---