

VICINITY MAP

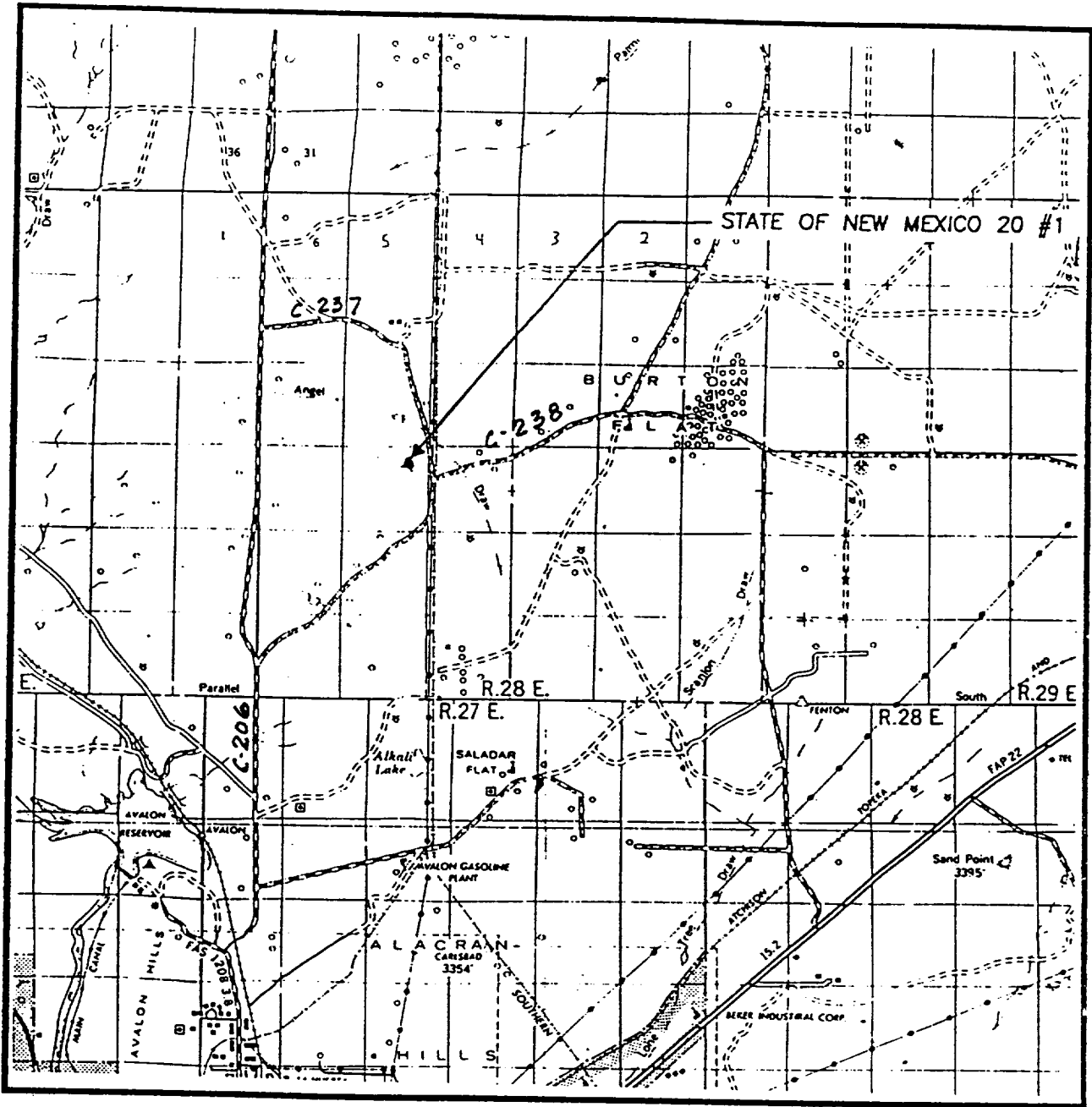

SCALE: 1" = 2 MILES

SEC. 20 TWP. 20-S RGE. 28-E

SURVEY N.M.P.M.

COUNTY EDDY

DESCRIPTION 990' FNL & 990' FEL

ELEVATION 3242'

OPERATOR InterCoast Oil and Gas Company

LEASE STATE OF NEW MEXICO

JOHN WEST ENGINEERING
HOBBS, NEW MEXICO
(505) 393-3117