

DISTRICT I
P.O. Box 1980, Hobbs, NM 88240

DISTRICT II
P.O. Drawer DD, Artesia, NM 88210

DISTRICT III
1000 Rio Brazos Rd., Aztec, NM 87410

DISTRICT IV
PO BOX 2088, SANTA FE, NM 87504-2088

State of New Mexico

Energy, Minerals and Natural Resources Department

Form C-102

Revised February 10, 1994

Instruction on back

Submit to appropriate District Office

Lease - 4 Copies

Fee - 3 Copies

OIL CONSERVATION DIVISION

P.O. Box 2088

Santa Fe, New Mexico 87504-2088

RECEIVED
1997 MAY 30 A 11:28
BUREAU OF LAND MGMT.
CARLSBAD RESOURCE AREA

WELL LOCATION AND ACREAGE DEDICATION PLAT

API Number	Pool Code 96335	Pool Name Burton Flats Bone Springs
Property Code	Property Name FEDERAL "4" ACT (SJS)	Well Number 2
OGRID No.	Operator Name MERIT ENERGY COMPANY	Elevation 3196

Surface Location

UL or lot No.	Section	Township	Range	Lot Idn	Feet from the	North/South line	Feet from the	East/West line	County
B	4	21 S	27 E		660	NORTH	1980	EAST	EDDY

Bottom Hole Location If Different From Surface

UL or lot No.	Section	Township	Range	Lot Idn	Feet from the	North/South line	Feet from the	East/West line	County
Dedicated Acres 40	Joint or Infill	Consolidation Code	Order No.						

NO ALLOWABLE WILL BE ASSIGNED TO THIS COMPLETION UNTIL ALL INTERESTS HAVE BEEN CONSOLIDATED
OR A NON-STANDARD UNIT HAS BEEN APPROVED BY THE DIVISION

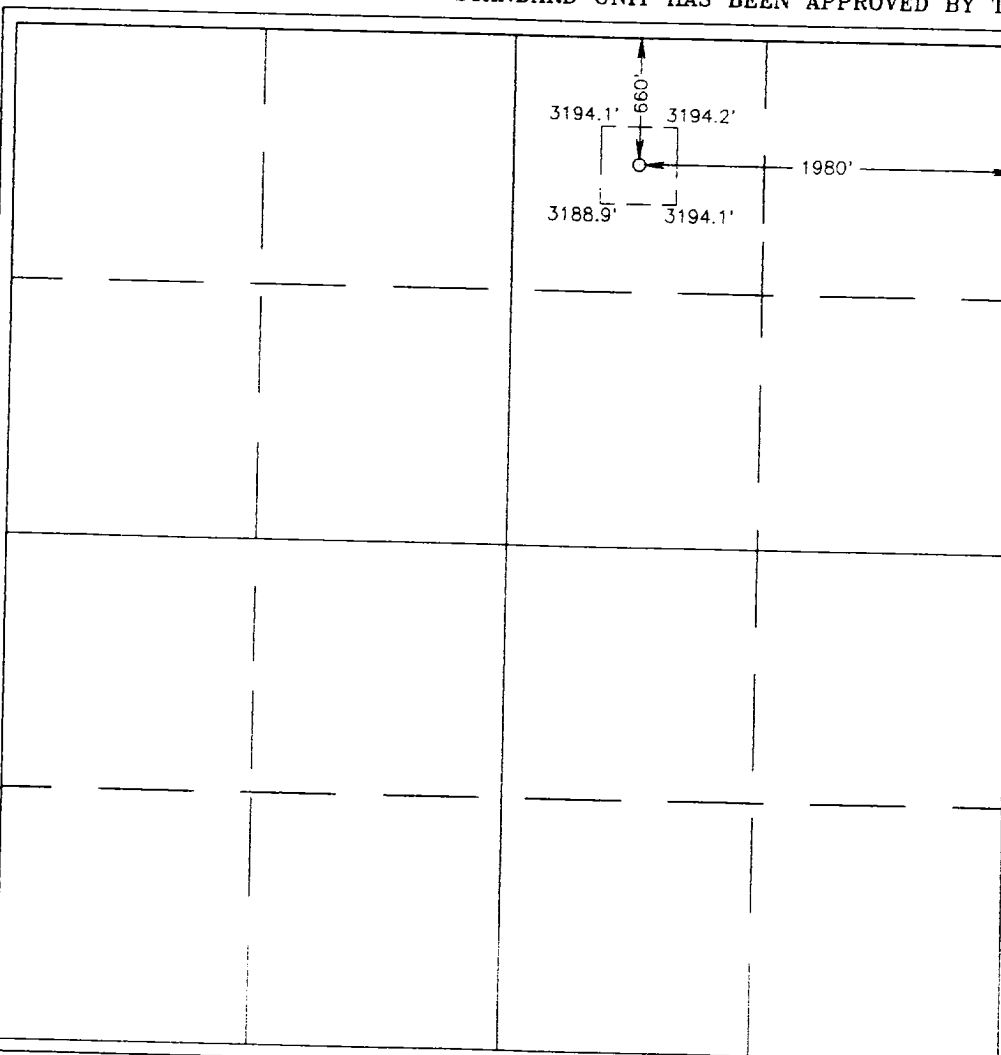

OPERATOR CERTIFICATION

I hereby certify the the information
contained herein is true and complete to the
best of my knowledge and belief.

Russell Whitel
Signature

Russell Whitel
Printed Name

Operations Supt.
Title

6-12-95
Date

SURVEYOR CERTIFICATION

I hereby certify that the well location shown
on this plat was plotted from field notes of
actual surveys made by me or under my
supervision and that the same is true and
correct to the best of my belief.

APRIL 28, 1995

Date Surveyed
Signature & Seal of
Professional Surveyor

Ronald J. Eidson
Signature

5-02-95
Date

95-11-0670
Well Number

Certificate No. **JOHN W. WEST**
RONALD J. EIDSON
CARY EIDSON

676
J236
1264