

District I
PO Box 1980, Hobbs, NM 88241-1980
District II
811 South First, Artesia, NM 88210
District III
1000 Rio Brazos Rd., Aztec, NM 87410
District IV
2040 South Pacheco, Santa Fe, NM 87505

State of New Mexico
Minerals & Natural Resources Department
OIL CONSERVATION DIVISION
2040 South Pacheco
Santa Fe, NM 87505

Form C-101
Revised October 18, 1994
Instructions on back
Submit to Appropriate District Office
State Lease - 6 Copies
Fee Lease - 5 Copies

JUN 20 1997

☐ AMENDED REPORT

APPLICATION FOR PERMIT TO DRILL, RE-ENTER, DEEPEN, PLUGBACK, OR ADD A ZONE

Operator Name and Address. Hallwood Petroleum, Inc., P. O. Box 378111, Denver, CO 80237		OGRID Number 009812
		API Number 30 - 015-29687
Property Code 21040	Property Name 23 Catchlaw Draw Unit	Well No. 2-3

Surface Location

UL or lot no.	Section	Township	Range	Lot Idn	Feet from the	North/South line	Feet from the	East/West line	County
K	23	21S	25E		1980	South	1980	West	Eddy

Proposed Bottom Hole Location If Different From Surface

UL or lot no.	Section	Township	Range	Lot Idn	Feet from the	North/South line	Feet from the	East/West line	County

Proposed Pool 1 Catchlaw Draw (Delaware) 10480	Proposed Pool 2
---	-----------------

Work Type Code N	Well Type Code O	Cable/Rotary R	Lease Type Code S	Ground Level Elevation 3336'
Multiple No	Proposed Depth 4000'	Formation Delaware	Contractor not yet selected	Spud Date Approx. 7/97

Proposed Casing and Cement Program

Hole Size	Casing Size	Casing weight/foot	Setting Depth	Sacks of Cement	Estimated TOC
14.75"	10.75"	40#	300'	240 sx	surface
9.875"	7"	23#	2100'	1310 sx	surface
6.125"	4.50"	11.6#	4000'	430 sx	1500-2000'

Describe the proposed program. If this application is to DEEPEN or PLUG BACK give the data on the present productive zone and proposed new productive zone. Describe the blowout prevention program, if any. Use additional sheets if necessary.

Hallwood Petroleum, Inc. wishes to advise that we intend to drill a 14 3/4" hole with fresh water spud mud to 300' and set 10 3/4", 40#, J-55 ST&C casing to 300', cementing to surface with 240 sx (350 cu ft) Class "H" cement. Drill 9 7/8" hole out of surface to 2100' with fresh water and sweeps and set 7" 23# intermediate casing from 0-2100'. Cement to surface with approximately 1310 sx. Wait on cement 14 hours, NU and test BOP. Drill 6 1/8" hole to 4000'. Log well. Set 4 1/2", 11.6#, K-55 LT&C production casing to 4000' cementing up to 2000' (min) with 300 sx (340 cu ft) of Class "H" cement.

Perforate pay section in the Delaware, acidize perforations and frac with approximately 40,000 gallons of crosslinked gelled KCl water and 120,000# of 16/30 Ottawa sand. Clean up well and install standard production equipment. Test well for a period not to exceed 30 days. (3000 psi-rated BOP's will be utilized)

WOC 18 Hours for 10 3/4" & 7" casing.

Posted ID-1
NLNAP
7-27-97

I hereby certify that the information given above is true and complete to the best of my knowledge and belief.

Signature:

Printed name:

Kevin E. O'Connell

Title:

Drilling and Production Manager

Date:

6/18/97

Phone:

(303) 850-7373

OIL CONSERVATION DIVISION

Approved by:

Title:

Approval Date:

6-20-97

Expiration Date:

6-20-98

Conditions of Approval:

Attached ☐

Notify N.M.O.C.C. in sufficient

time to witness cementing

the 7" casing

District I
PO Box 1980, Hobbs, NM 88241-1980
District II
PO Drawer DD, Artesia, NM 88211-0719
District III
1000 Rio Brazos Rd., Aztec, NM 87410
District IV
PO Box 2088, Santa Fe, NM 87504-2088

State of New Mexico
Energy, Minerals & Natural Resources Department

OIL CONSERVATION DIVISION
PO Box 2088
Santa Fe, NM 87504-2088

Form C-102
Revised February 10, 1994
Instructions on back
Submit to Appropriate District Office
State Lease - 4 Copies
Fee Lease - 3 Copies

☐ AMENDED REPORT

WELL LOCATION AND ACREAGE DEDICATION PLAT

API Number		Pool Code 10480	Pool Name Catclaw Draw (Delaware)
Property Code	Property Name CATCLAW DRAW UNIT		Well Number 23-3
OGRID No. 009812	Operator Name HALLWOOD PETROLEUM, INC.		Elevation 3336.

10 Surface Location

UL or lot no.	Section	Township	Range	Lot Idn	Feet from the	North/South line	Feet from the	East/West line	County
K	23	21-S	25-E		1980	SOUTH	1980	WEST	EDDY

11 Bottom Hole Location If Different From Surface

UL or lot no. (Same - Vertical Well)	Section	Township	Range	Lot Idn	Feet from the	North/South line	Feet from the	East/West line	County

12 Dedicated Acres	13 Joint or Infill	14 Consolidation Code	15 Order No.
40	N	U	

NO ALLOWABLE WILL BE ASSIGNED TO THIS COMPLETION UNTIL ALL INTERESTS HAVE BEEN CONSOLIDATED
OR A NON-STANDARD UNIT HAS BEEN APPROVED BY THE DIVISION

<p>16</p> <p>SECTION 23</p>	<p>17 OPERATOR CERTIFICATION</p> <p>I hereby certify that the information contained herein is true and complete to the best of my knowledge and belief</p> <p><i>Kevin E. O'Connell</i></p> <p>Signature Kevin E. O'Connell</p> <p>Printed Name Drilling & Production Manager</p> <p>Title June 18, 1997</p> <p>Date</p>
	<p>18 SURVEYOR CERTIFICATION</p> <p>I hereby certify that the well location shown on this plat was plotted from field notes of actual surveys made by me or under my supervision, and that the same is true and correct to the best of my belief.</p> <p>MAY 22 1997</p> <p>Date of Survey</p> <p>Signature and Seal of Professional Surveyor:</p> <p><i>[Signature]</i></p> <p>REGISTERED LAND SURVEYOR ENGINEER</p> <p>5412</p> <p>NEW MEXICO</p> <p>5412</p>

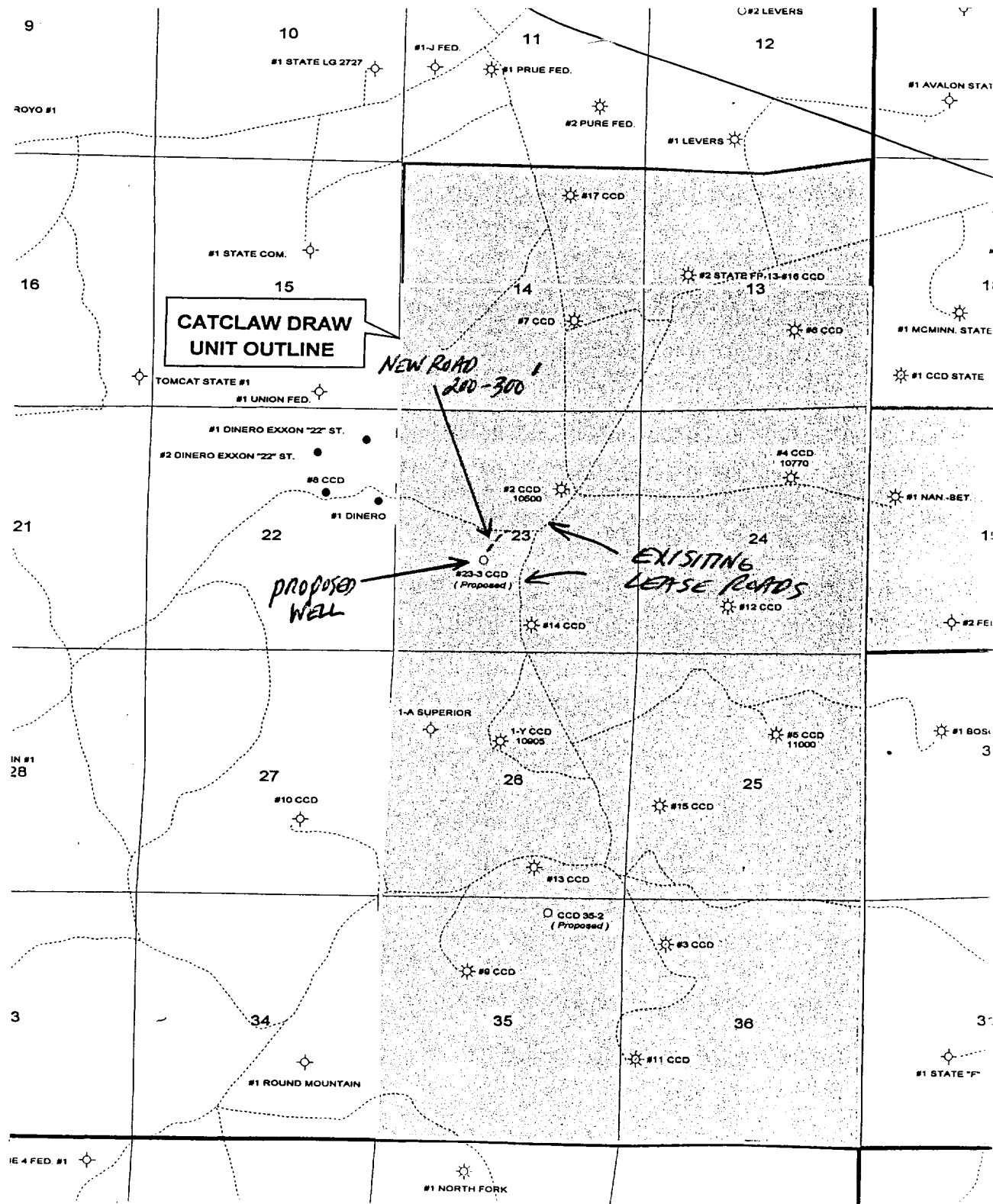

Hallwood Petroleum, Inc.

CATCLAW DRAW EDDY COUNTY, NEW MEXICO

Bill Hook

6/12/97

Catclaw Draw #2

Scale 1:24000.