

District I  
PO Box 1980, Hobbs, NM 88241-1980

District II  
811 South First, Artesia, NM 88210

District III  
1000 Rio Brazos Rd., Aztec, NM 87410

District IV  
2040 South Pacheco, Santa Fe, NM 87505

State of New Mexico  
Energy, Minerals & Natural Resources Department

OIL CONSERVATION DIVISION  
2040 South Pacheco  
Santa Fe, NM 87505

Form C-101  
Revised October 18, 1994  
Instructions on back  
Submit to Appropriate District Office  
State Lease - 6 Copies  
Fee Lease - 5 Copies

☐ AMENDED REPORT

APPLICATION FOR PERMIT TO DRILL, RE-ENTER, DEEPEN, PLUGBACK, OR ADD A ZONE

Operator Name and Address Mewbourne Oil Company PO Box 5270 Hobbs, New Mexico 88241		OGRID Number 14744
Property Name Carlsbad 22 State Com		API Number 30 - 0 15-29851
Property Code 21595	Well No. 1	

Surface Location

UL or lot no.	Section	Township	Range	Lot Idn	Feet from the	North/South line	Feet from the	East/West Line	County
C	22	21S	26E		896	North	1764	West	Eddy

Proposed Bottom Hole Location If Different From Surface

UL or lot no.	Section	Township	Range	Lot Idn	Feet from the	North/South line	Feet from the	East/West Line	County
Proposed Pool 1 Und. Strawn					Proposed Pool 2				

Work Type Code P	Well Type Code G	Cable/Rotary R	Lease Type Code S	Ground Level Elevation 3225
Multiple	Proposed Depth	Formation Strawn	Contractor TBA	Spud Date 06-02-98

Proposed Casing and Cement Program

Hole Size	Casing Size	Casing weight/foot	Setting Depth	Sacks of Cement	Estimated TOC

Describe the proposed program. If this application is to DEEPEN or PLUG BACK give the data on the present productive zone and proposed new productive zone. Describe the blowout prevention program, if any. Use additional sheets if necessary.

Mewbourne Oil Company is currently producing the Morrow @ 11062-72'. MOC would like to isolate these perms & attempt a Strawn test from 9668-9965'. If successful, MOC would apply for commingle of Strawn & Morrow. MOC plans to use 7 1/16" x 3000 psi BOP during test.

I hereby certify that the information given above is true and complete to the best of my knowledge and belief.

Signature:

Printed name: N.M. Young

Title: District Manager

OIL CONSERVATION DIVISION

Approved By: ORIGINAL SIGNED BY TIM W. GUM

Title: DISTRICT II SUPERVISOR

Approval Date:

JUN 03 2002

Expiration Date:

JUN 03 2003

DISTRICT I  
P.O. Box 1980, Hobbs, NM 88241-1960

State of New Mexico  
Energy, Minerals and Natural Resources

Form O-102  
Revised February 10, 1994  
Submit to Appropriate District Office  
State Lease - 4 Copies  
Fee Lease - 3 Copies

DISTRICT II  
P.O. Drawer DD, Artesia, NM 88211-0719

DISTRICT III  
1000 Rio Brazos Rd., Aztec, NM 87410

DISTRICT IV  
P.O. BOX 2088, SANTA FE, N.M. 87504-2088

OIL CONSERVATION DIVISION  
P.O. Box 2088  
Santa Fe, New Mexico 87504-2088

☐ AMENDED REPORT

WELL LOCATION AND ACREAGE DEDICATION PLAT

API Number	Pool Code	Pool Name
Property Code	Property Name CARLSBAD 22 STATE	Well Number 1
OGRID No. 14744	Operator Name MEWBOURNE OIL COMPANY	Elevation 3225

Surface Location

UL or lot No. C	Section 22	Township 21 S	Range 26 E	Lot Idn	Feet from the 896	North/South line NORTH	Feet from the 1764	East/West line WEST	County EDDY
--------------------	---------------	------------------	---------------	---------	----------------------	---------------------------	-----------------------	------------------------	----------------

Bottom Hole Location If Different From Surface

UL or lot No.	Section	Township	Range	Lot Idn	Feet from the	North/South line	Feet from the	East/West line	County
---------------	---------	----------	-------	---------	---------------	------------------	---------------	----------------	--------

Dedicated Acres 320	Joint or Infill	Consolidation Code	Order No.
------------------------	-----------------	--------------------	-----------

NO ALLOWABLE WILL BE ASSIGNED TO THIS COMPLETION UNTIL ALL INTERESTS HAVE BEEN CONSOLIDATED  
OR A NON-STANDARD UNIT HAS BEEN APPROVED BY THE DIVISION

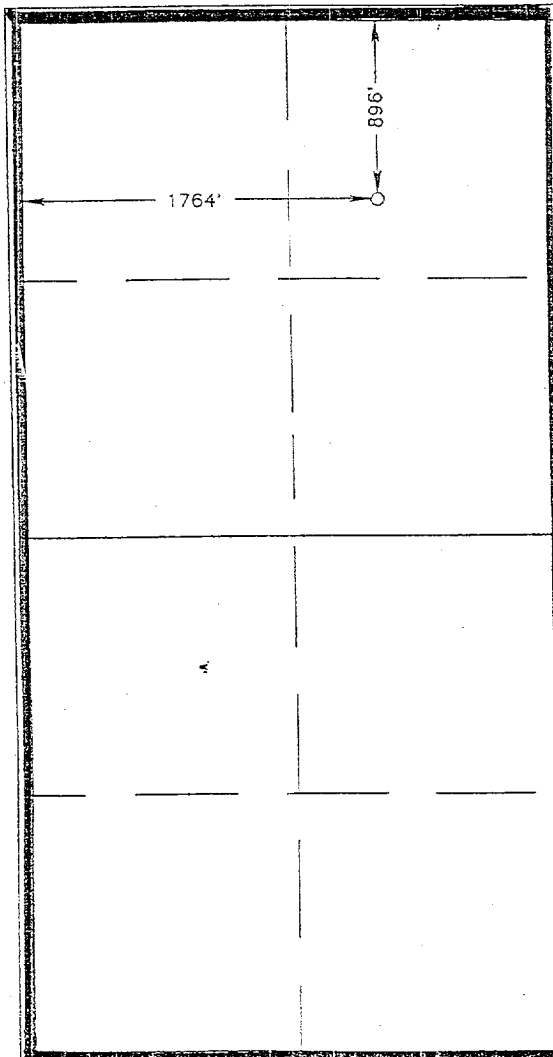

OPERATOR CERTIFICATION

I hereby certify the the information  
contained herein is true and complete to the  
best of my knowledge and belief.

Signature  
Steve Matthews  
Printed Name  
Drilling Super.  
Title  
04-21-98  
Date

SURVEYOR CERTIFICATION

I hereby certify that the well location shown  
on this plat was plotted from field notes of  
actual surveys made by me or under my  
supervision, and that the same is true and  
correct to the best of my belief.

APRIL 20, 1998

Date Surveyed DMCC

Signature & Seal of  
Professional Surveyor  
RONALD J. EDSON  
4-21-98  
68-11-0648  
Certificate No. RONALD J. EDSON 3239  
GARY EIER 1254  
MAGGIE McDONALD 1218