

DISTRICT I  
P. O. Box 1980  
Hobbs, NM 88241-1980

DISTRICT II  
P. O. Drawer DD  
Artesia, NM 88211-0719

DISTRICT III  
1000 Rio Brazos Rd.  
Aztec, NM 87410

DISTRICT IV  
P. O. Box 2088  
Santa Fe, NM 87507-2088

State of New Mexico  
Department of Geology, Minerals, and Natural Resources

Form C-102  
Revised 02-10-94  
Instructions on back

Submit to the Appropriate  
District Office  
State Lease - 4 copies  
Fee Lease - 3 copies

## OIL CONSERVATION DIVISION

P. O. Box 2088  
Santa Fe, New Mexico 87504-2088

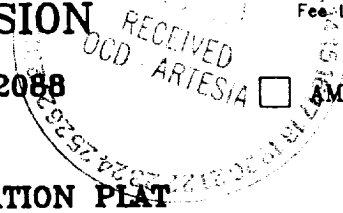

AMENDED REPORT

### WELL LOCATION AND ACREAGE DEDICATION PLAT

1 API Number		2 Pool Code		3 Pool Name					
4 Property Code		5 Property Name NAGOODLEE PEAK '5' FEDERAL						6 Well Number 3	
7 OGRID No.		8 Operator Name SANTA FE ENERGY RESOURCES, INC.						9 Elevation 4347'	
10 SURFACE LOCATION									
UL or lot no. M	Section 5	Township 22 SOUTH	Range 24 EAST, N.M.P.M.	Lot Ida	Feet from the 1230'	North/South line SOUTH	Feet from the 800'	East/West line WEST	County EDDY
11 BOTTOM HOLE LOCATION IF DIFFERENT FROM SURFACE									
UL or lot no.	Section	Township	Range	Lot Ida	Feet from the	North/South line	Feet from the	East/West line	County
12 Dedicated Acres		13 Joint or Infill		14 Consolidation Code		15 Order No.			

NO ALLOWABLE WELL BE ASSIGNED TO THIS COMPLETION UNTIL ALL INTERESTS HAVE BEEN  
CONSOLIDATED OR A NON-STANDARD UNIT HAS BEEN APPROVED BY THE DIVISION

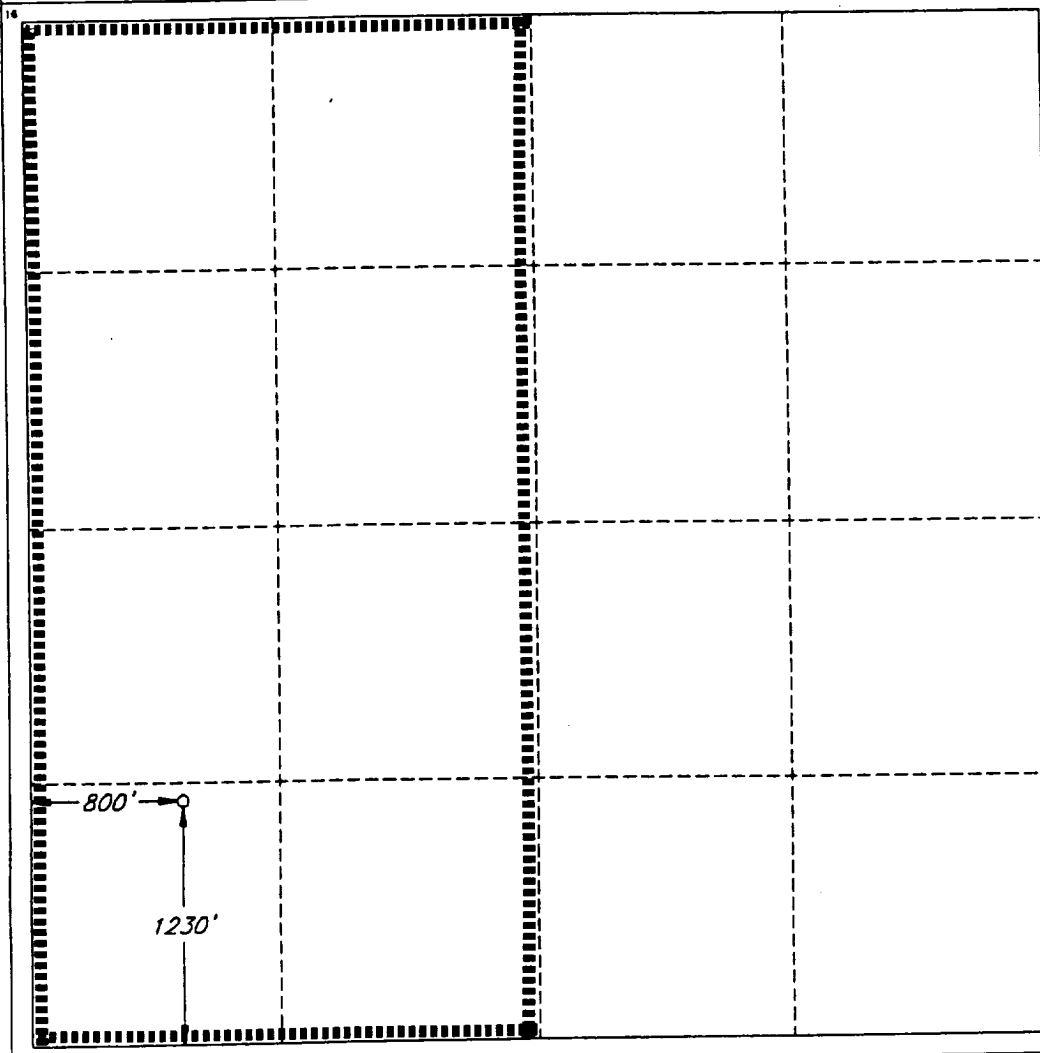

#### OPERATOR CERTIFICATION

I hereby certify that the information  
contained herein is true and complete  
to the best of my knowledge and belief.

Signature *Mike Burton*  
Mike Burton  
Printed Name  
Drilling Manager  
Title  
Santa Fe Snyder Corporation  
Date  
December 3, 1999

#### SURVEYOR CERTIFICATION

I hereby certify that the well  
location shown on this plat was  
plotted from field notes of actual  
surveys made by me or under  
my supervision, and that the  
same is true and correct to the  
best of my belief.

Date of Survey  
SEPTEMBER 8, 1997  
Signature and Seal of  
Professional Surveyor  
*Roger M. Robbins*  
Certificate No.  
ROGER M. ROBBINS, P.S. #12128  
JOB # 54019 / 51 NE / JSJ