

District I  
PO Box 1980, Hobbs, NM 88241-1980  
District II  
PO Drawer DD, Artesia, NM 88211-0719  
District III  
1000 Rio Brazos Rd., Aztec, NM 87410  
District IV  
PO Box 2088, Santa Fe, NM 87504-2088

State of New Mexico  
Energy, Minerals & Natural Resources Department

OIL CONSERVATION DIVISION  
PO Box 2088  
Santa Fe, NM 87504-2088

Form C-101  
Revised February 10, 1994  
Instructions on back  
Submit to Appropriate District Office  
State Lease - 6 Copies  
Fee Lease - 5 Copies



AMENDED REPORT

APPLICATION FOR PERMIT TO DRILL, RE-ENTER, DEEPEN, PLUGBACK, OR ADD A ZONE

<sup>2</sup> Operator Name and Address. Devon Energy Corporation (Nevada) 1500 Mid America Tower 20 N. Broadway Oklahoma City, OK 73102-8260		<sup>1</sup> OGRID Number 6137
<sup>4</sup> Property Code 22904	<sup>5</sup> Property Name CARLSBAD "22E" STATE	<sup>3</sup> API Number 10-015-30125
		<sup>6</sup> Well No. 1

<sup>7</sup> Surface Location

UL or lot no. E	Section 22	Township 21S	Range 26E	Lot Ids	Feet from the 1650	North/South line NORTH	Feet from the 660	East/West line WEST	County EDDY
--------------------	---------------	-----------------	--------------	---------	-----------------------	---------------------------	----------------------	------------------------	----------------

<sup>8</sup> Proposed Bottom Hole Location If Different From Surface

UL or lot no.	Section	Township	Range	Lot Ids	Feet from the	North/South line	Feet from the	East/West line	County
<sup>9</sup> Proposed Pool 1 Avalon (Morrow Gas)					<sup>10</sup> Proposed Pool 2				

<sup>11</sup> Work Type Code N	<sup>12</sup> Well Type Code G	<sup>13</sup> Cable/Rotary R	<sup>14</sup> Lease Type Code S	<sup>15</sup> Ground Level Elevation 3224
<sup>16</sup> Multiple No	<sup>17</sup> Proposed Depth 11,200'	<sup>18</sup> Formation Morrow	<sup>19</sup> Contractor unknown at this time	<sup>20</sup> Spud Date

<sup>21</sup> Proposed Casing and Cement Program

Hole Size	Casing Size	Casing weight/foot	Setting Depth	Sacks of Cement	Estimated TOC
17 1/2"	13 3/8"	48	350'	400	Post TD-1 surface
12 1/4"	8 5/8"	24 & 32	2,200'	1000	3-6-98 surface
7 7/8"	5 1/2"	15.5 & 17	11,200'	1000	API Y 7,000'
					Loc

<sup>22</sup> Describe the proposed program. If this application is to DEEPEN or PLUG BACK give the data on the present productive zone and proposed new productive zone. Describe the blowout prevention program, if any. Use additional sheets if necessary.  
Devon plans to drill this well to a total depth of 11,200 feet and complete it as a Morrow development well. If it is deemed non-commercial then it will be plugged and abandoned in accordance with the rules and regulations established by the New Mexico OCD or converted to salt water disposal after installing casing and obtaining the necessary disposal permits. Blowout prevention equipment will be installed while drilling the intermediate and production holes.

<sup>23</sup> I hereby certify that the information given above is true and complete to the best of my knowledge and belief.		OIL CONSERVATION DIVISION	
Signature: <i>Walter M. Frank</i>	Approved by: ORIGINAL SIGNED BY TIM W. GUM	Title: DISTRICT II SUPERVISOR	
Printed name: Walter M. Frank	Approval Date: MAR 2 1998	Expiration Date:	
Title: District Engineer	Conditions of Approval:	3-2-99	
Date: 2/18/98	Phone: (405) 235-3611	Attached	

DISTRICT I  
P. O. Box 1980  
Hobbs, NM 88241-1980

State of New Mexico  
Energy, Minerals, and Natural Resources Department

Form C-102  
Revised 02-10-94

Instructions on back

DISTRICT II  
P. O. Drawer DD  
Artesia, NM 88211-0719

**OIL CONSERVATION DIVISION**  
**P. O. Box 2088**  
**Santa Fe, New Mexico 87504-2088**

Submit to the Appropriate  
District Office  
State Lease - 4 copies  
Fee Lease - 3 copies

☐ AMENDED REPORT

DISTRICT III  
1000 Rio Brazos Rd.  
Aztec, NM 87410

DISTRICT IV  
P. O. Box 2088  
Santa Fe, NM 87507-2088

**WELL LOCATION AND ACREAGE DEDICATION PLAT**

1 API Number		2 Pool Code		3 Pool Name Avalon (Morrow Gas)			
4 Property Code		5 Property Name CARLSBAD 22E STATE				6 Well Number 1	
7 OGRID No.		8 Operator Name DEVON ENERGY CORPORATION				9 Elevation 3226'	

**10 SURFACE LOCATION**

UL or lot no. E	Section 22	Township 21 SOUTH	Range 26 EAST, N.M.P.M.	Lot Ida	Feet from the 1650'	North/South line NORTH	Feet from the 660'	East/West line WEST	County EDDY
--------------------	---------------	----------------------	----------------------------	---------	------------------------	---------------------------	-----------------------	------------------------	----------------

**11 BOTTOM HOLE LOCATION IF DIFFERENT FROM SURFACE**

UL or lot no.	Section	Township	Range	Lot Ida	Feet from the	North/South line	Feet from the	East/West line	County
---------------	---------	----------	-------	---------	---------------	------------------	---------------	----------------	--------

12 Dedicated Acres 320	13 Joint or Infill	14 Consolidation Code	15 Order No.
---------------------------	--------------------	-----------------------	--------------

NO ALLOWABLE WELL BE ASSIGNED TO THIS COMPLETION UNTIL ALL INTERESTS HAVE BEEN CONSOLIDATED OR A NON-STANDARD UNIT HAS BEEN APPROVED BY THE DIVISION

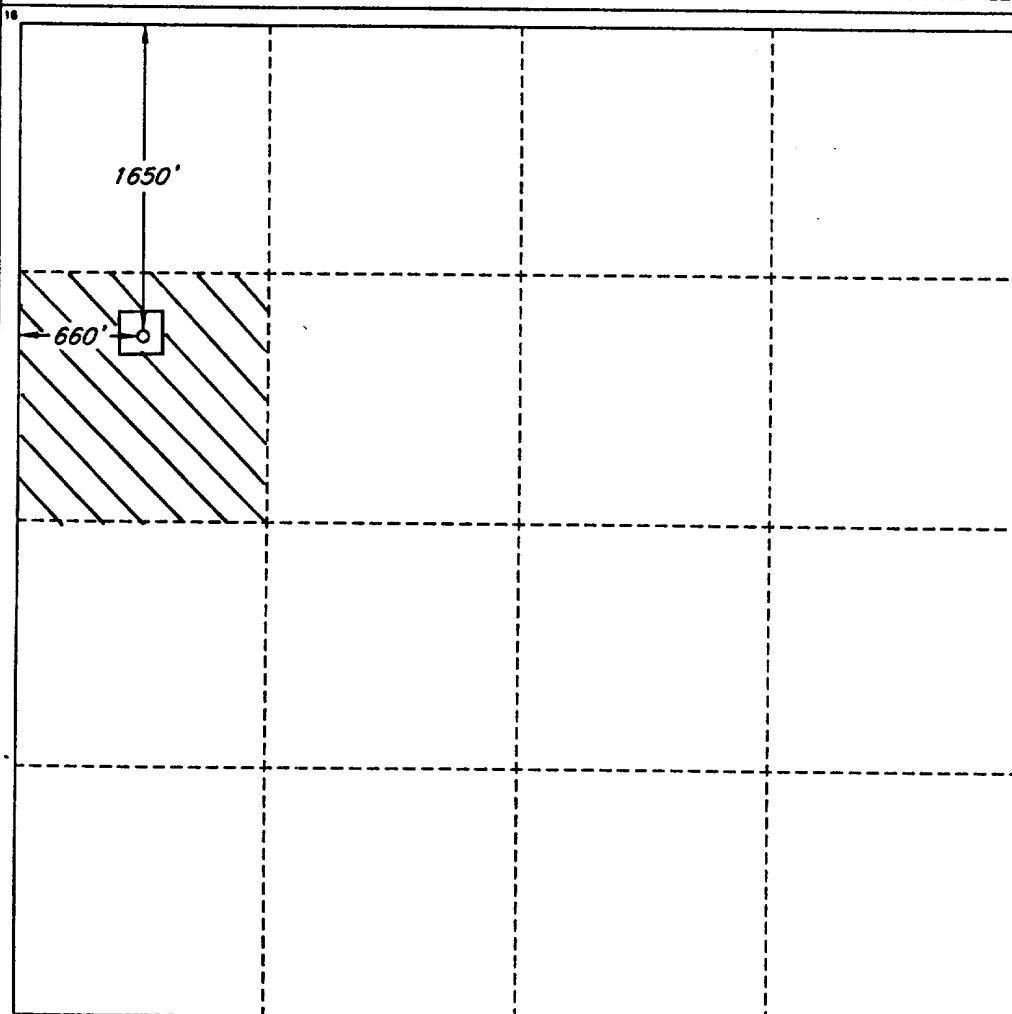

**OPERATOR CERTIFICATION**

I hereby certify that the information contained herein is true and complete to the best of my knowledge and belief.

Signature

Printed Name

Walter M. Frank

Title

District Engineer

Date

2/18/98

**SURVEYOR CERTIFICATION**

I hereby certify that the well location shown on this plat was plotted from field notes of actual surveys made by me or under my supervision, and that the same is true and correct to the best of my belief.

Date of Survey  
FEBRUARY 13, 1998

Signature and Seal of Professional Surveyor

Roger M. Robbins

Certificate No. ROGER M. ROBBINS P.S. #12128

JOB #56805 / 50 NE / JSJ

**New Mexico Oil Conservation Division  
C-102 Instructions**

IF THIS IS AN AMENDED REPORT, CHECK THE BOX LABELED "AMENDED REPORT" AT THE TOP OF THIS DOCUMENT.

Surveyors shall use the latest United States government survey or dependent resurvey. Well locations will be in reference to the New Mexico Principal Meridian. If the land is not surveyed contact the appropriate OCD district office. Independent subdivision surveys will not be acceptable.

1. The OCD assigned API number for this well
2. The pool code for this (proposed) completion
3. The pool name for this (proposed) completion
4. The property code for this (proposed) completion
5. The property name (well name) for this (proposed) completion
6. The well number for this (proposed) completion
7. Operator's OGRID number
8. The operator's name
9. The ground level elevation of this well
10. The surveyed surface location of this well measured from the section lines. NOTE: If the United States government survey designates a Lot Number for this location use that number in the "UL or lot no." box. Otherwise use the OCD unit letter.
11. Proposed bottom hole location. If this is a horizontal hole indicate the location of the end of the hole.
12. The calculated acreage dedicated to this completion to nearest hundredth of an acre
13. Put a Y if more than one completion will be sharing this same acreage or N if this is the only completion on this acreage
14. If more than one lease of different ownership has been dedicated to the well show the consolidation code from the following table:

C	Communitization
U	Unitization
F	Forced pooling
O	Other
P	Consolidation pending

NO ALLOWABLE WILL BE ASSIGNED TO THIS COMPLETION UNTIL ALL INTERESTS HAVE BEEN CONSOLIDATED OR A NON-STANDARD UNIT HAS BEEN APPROVED BY THE DIVISION!

15. Write in the OCD order(s) approving a non-standard location, non-standard spacing, or directional or horizontal drilling

16. This grid represents a standard section. You may superimpose a non-standard section over this grid. Outline the dedicated acreage and the separate leases within that dedicated acreage. Show the well surface location and bottom hole location, if it is directionally drilled, with the dimensions from the section lines in the cardinal directions. (Note: A legal location is determined from the perpendicular distance to the edge of the tract.) If this is a high angle or horizontal hole show that portion of the well bore that is open within this pool.

Show all lots, lot numbers, and their respective acreage.

If more than one lease has been dedicated to this completion, outline each one and identify the ownership as to both working interest and royalty.

17. The signature, printed name, and title of the person authorized to make this report, and the date this document was signed.
18. The Registered surveyors certification. This section does not have to be completed if this form has been previously accepted by the OCD and is being filed for a change of pool or dedicated acreage.

# LOCATION & ELEVATION VERIFICATION MAP

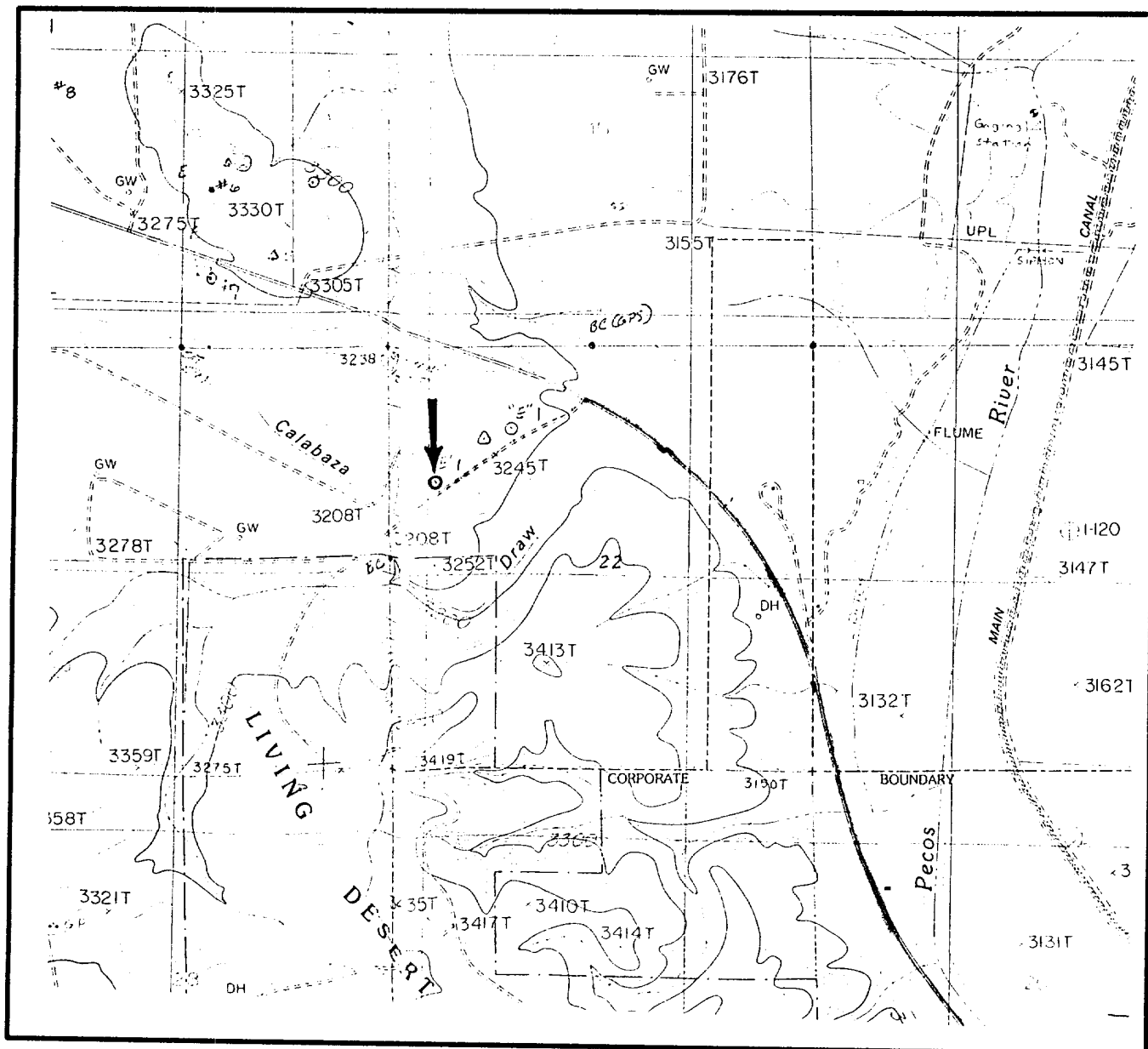

SCALE : 1" = 2000'

CONTOUR INTERVAL 20'

SECTION 22 TWP 21-S RGE 26-E

SURVEY NEW MEXICO PRINCIPAL MERIDIAN

COUNTY EDDY STATE NM

DESCRIPTION 1650' FNL & 660' FWL

ELEVATION 3226'

OPERATOR DEVON ENERGY CORPORATION

LEASE CARLSBAD 22E STATE #1

U.S.G.S. TOPOGRAPHIC MAP

CARLSBAD WEST, NEW MEXICO

SCALED LAT. N 32°28'05.3"

LONG. W 104°17'11.8"



This location has been very carefully staked on the ground according to the best official survey records, maps, and other data available to us.  
Review this plat and notify us immediately of any possible discrepancy.

## TOPOGRAPHIC LAND SURVEYORS

*Surveying & Mapping for the Oil & Gas Industry*

1307 N. HOBART  
PAMPA, TX. 79065  
(800) 658-6382

6709 N. CLASSEN BLVD.  
OKLAHOMA CITY, OK. 73116  
(800) 654-3219

2903 N. BIG SPRING  
MIDLAND, TX. 79705  
(800) 767-1653

# VICINITY MAP

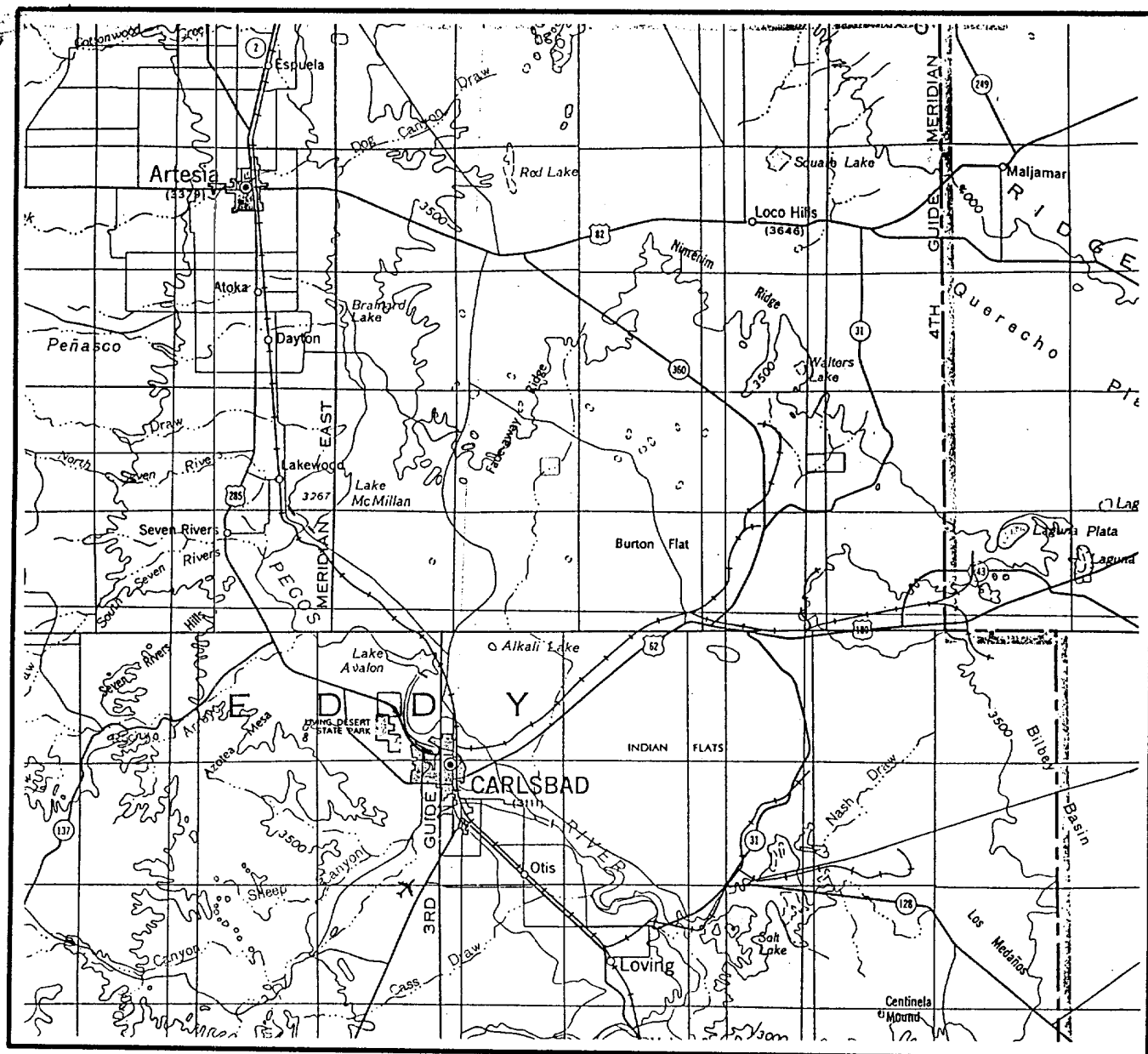

SECTION 22 TWP 21-S RGE 26-E  
 SURVEY NEW MEXICO PRINCIPAL MERIDIAN  
 COUNTY EDDY STATE NM  
 DESCRIPTION 1650' FNL & 660' FWL

OPERATOR DEVON ENERGY CORPORATION  
 LEASE CARLSBAD 22E STATE D#1

DISTANCE & DIRECTION FROM CARLSBAD, GO NORTHWEST  
3.6 MILES ON U.S. 285, THENCE SOUTHWEST 0.4 MILE  
ON LEASE ROAD TO A POINT ±125' SOUTHEAST OF THE  
LOCATION.



This location has been very carefully staked on the ground according to the best official survey records, maps, and other data available to us.  
 Review this plot and notify us immediately of any possible discrepancy.

## TOPOGRAPHIC LAND SURVEYORS

*Surveying & Mapping for the Oil & Gas Industry*

1307 N. HOBART  
 PAMPA, TX. 79065  
 (800) 658-6382

6709 N. CLASSEN BLVD.  
 OKLAHOMA CITY, OK. 73116  
 (800) 654-3219

2903 N. BIG SPRING  
 MIDLAND, TX. 79705  
 (800) 767-1653