

DISTRICT I
P. O. Box 1980
Hobbs, NM 88241-1980

DISTRICT II
P. O. Drawer DD
Artesia, NM 88211-0719

DISTRICT III
1000 Rio Brazos Rd.
Aztec, NM 87410

DISTRICT IV
P. O. Box 2088
Santa Fe, NM 87507-2088

State of New Mexico
Energy, Minerals, and Natural Resources Department

Form C-102
Revised 02-10-94

OIL CONSERVATION DIVISION
P. O. Box 2088
Santa Fe, New Mexico 87504-2088

X Amended
changed unit configuration
and bottom hole location

WELL LOCATION AND ACREAGE DEDICATION PLAT

1 API Number 30-015-30359		2 Pool Code 33685		3 Pool Name INDIAN BASIN (UPPER PENN) ASSOC.					
4 Property Code 20201		5 Property Name WINSTON GAS COM						6 Well Number 3	
7 OGRID No. 6137		8 Operator Name PRODUCTION COMPANY, L.P. DEVON ENERGY CORPORATION						9 Elevation 3906'	
10 SURFACE LOCATION									
UL or lot no. K	Section 31	Township 21 SOUTH	Range 24 EAST, N.M.P.M.	Lot Ida	Feet from the 2167'	North/South line SOUTH	Feet from the 1998'	East/West line WEST	County EDDY
11 BOTTOM HOLE LOCATION IF DIFFERENT FROM SURFACE									
UL or lot no. O	Section 31	Township 21 SOUTH	Range 24 EAST, N.M.P.M.	Lot Ida	Feet from the =666'	North/South line SOUTH	Feet from the =1850'	East/West line EAST	County EDDY
12 Dedicated Acres 320		13 Joint or Infill		14 Consolidation Code		15 Order No. 675' 1832'			

NO ALLOWABLE WELL BE ASSIGNED TO THIS COMPLETION UNTIL ALL INTERESTS HAVE BEEN CONSOLIDATED OR A NON-STANDARD UNIT HAS BEEN APPROVED BY THE DIVISION

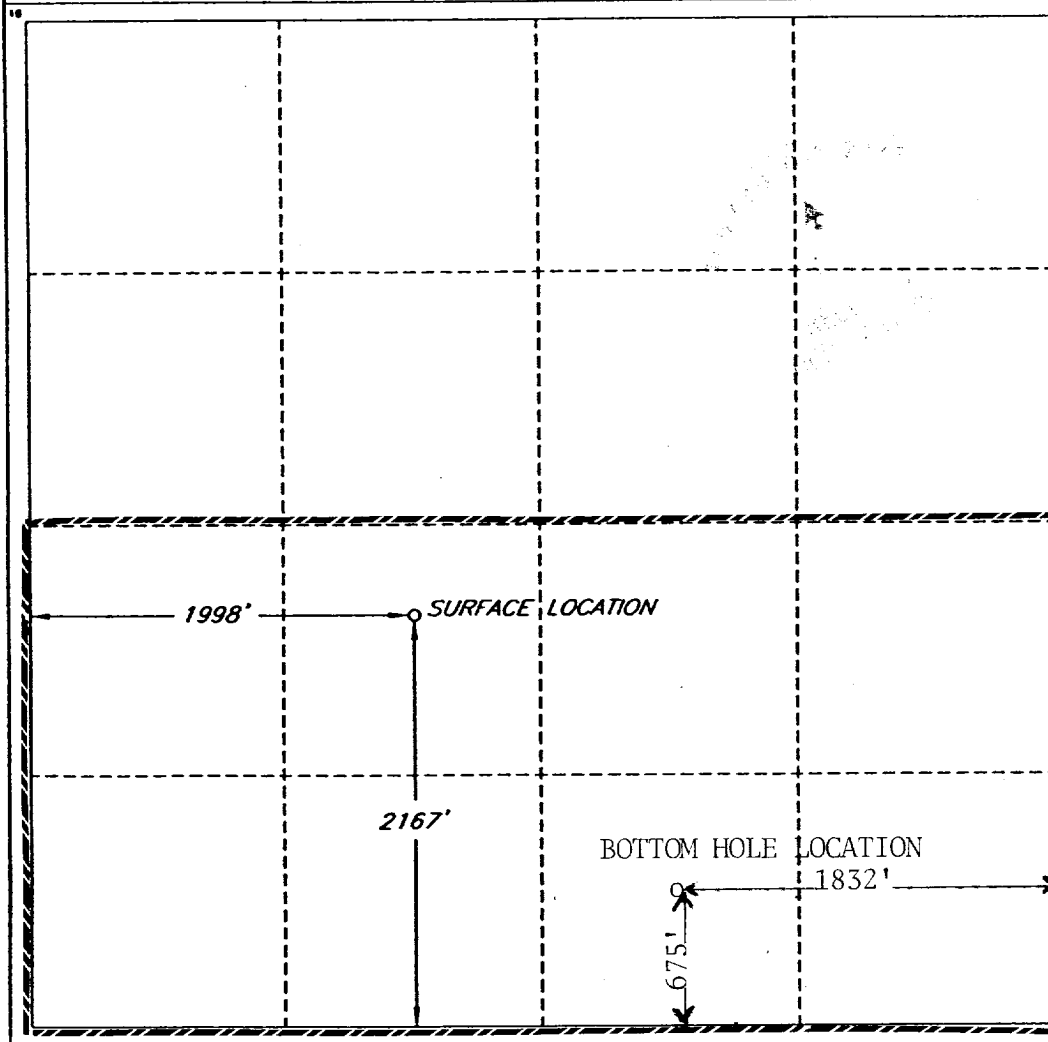

OPERATOR CERTIFICATION

I hereby certify that the information contained herein is true and complete to the best of my knowledge and belief.

Signature

Candace R. Graham

Printed Name

Candace R. Graham

Title

Engineering Tech.

Date

February 6, 2003

SURVEYOR CERTIFICATION

I hereby certify that the well location shown on this plat was plotted from field notes of actual surveys made by me or under my supervision, and that the same is true and correct to the best of my belief.

Date of Survey

Signature

Professional Surveyor

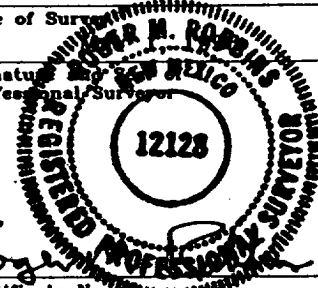

Certificate No.

ROGER M. ROBBINS P.S. #12128

JOB #58199 / 51 NE / V.H.B.