

UNITED STATES
DEPARTMENT OF THE INTERIOR
BUREAU OF LAND MANAGEMENT

311 S. 1ST ST.
SUSAN IN TRI
(Other Instruc
reverse side)

FORM APPROVED
OMB NO. 1004-0136
Expires: February 28, 1995

APPLICATION FOR PERMIT TO DRILL OR DEEPEN

1a. TYPE OF WORK
DRILL ☒ DEEPEN ☐

b. TYPE OF WELL
OIL WELL ☐ GAS WELL ☒ OTHER ☐ SINGLE ZONE ☐ MULTIPLE ZONE ☐

2. NAME OF OPERATOR
YATES PETROLEUM CORPORATION

3. ADDRESS AND TELEPHONE NO.
105 South Fourth Street, Artesia, New Mexico 88210 (505) 748-1471

4. LOCATION OF WELL (Report location clearly and in detail on State requirements.)
At surface: 660' FNL and 1310' FEL
At proposed prod. zone: 1310' *Wt A*
Same

14. DISTANCE IN MILES AND DIRECTION FROM NEAREST TOWN OR POST OFFICE*
3963' GR

15. DISTANCE FROM PROPOSED* LOCATION TO NEAREST PROPERTY OR LEASE LINE, FT. (Also to nearest drlg. unit line, if any)
660'

16. NO. OF ACRES IN LEASE
320

17. NO. OF ACRES ASSIGNED TO THIS WELL
320

18. DISTANCE FROM PROPOSED LOCATION* TO NEAREST WELL, DRILLING, COMPLETED, OR APPLIED FOR, ON THIS LEASE, FT.
8100'

19. PROPOSED DEPTH
8100'

20. ROTARY OR CABLE TOOLS
Rotary

21. ELEVATIONS (Show whether DF, RT, GR, etc.)
3963' GR

22. APPROX. DATE WORK WILL START*
ASAP

5. LEASE DESIGNATION AND SERIAL NO.
NM-0399448

6. IF INDIAN, ALLOTTEE OR TRIBE NAME

7. UNIT AGREEMENT NAME

8. FARMOR/LEASE NAME, WELL NO. #2
Malone ASA Federal

9. API WELL NO.
30-015-30769

10. FIELD AND POOL, OR WILDCAT
Indian Basin Upper Penn

11. SEC., T., R. M., OR BLK. AND SURVEY OR AREA
Section 12, T22S-R23E

12. COUNTY OR PARISH
Eddy County

13. STATE
New Mexico

PROPOSED CASING AND CEMENTING PROGRAM

SIZE OF HOLE	GRADE SIZE OF CASING	WEIGHT PER FOOT	SETTING DEPTH	QUANTITY
14 3/4"	9 5/8"	36#	1500'	1150 sx Circulate
8 3/4"	7"	23# & 26#	TD	1600 sx Circulate

Yates Petroleum Corporation proposes to drill and test the Canyon and intermediate formations. Approximately 1500' of intermediate casing will be set and cement circulated to shut off gravel and cavings. If commercial, production casing will be run and cemented with adequate cover, perforated and stimulated as needed for production.

MUD PROGRAM: 0-1500' FW Spud Mud; 1500'-7500' Cut Brine; 7500'-8100' SW Gel/Starch/Drispac.

BOPE PROGRAM: BOPE will be installed on the 9 5/8" casing and tested daily for operational.

APPROVAL SUBJECT TO
GENERAL REQUIREMENTS AND
SPECIAL STIPULATIONS
ATTACHED

Post ID-1
10-1-99
APE + loc

IN ABOVE SPACE DESCRIBE PROPOSED PROGRAM: If proposal is to deepen, give data on present productive zone and proposed new productive zone. If proposal is to drill or deepen directionally, give pertinent data on subsurface locations and measured and true vertical depths. Give blowout preventer program, if any.

24. SIGNED *Ken S. Smith* TITLE Landman DATE April 13, 1999
(This space for Federal or State office use)

PERMIT NO. APPROVAL DATE

Application approval does not warrant or certify that the applicant holds legal or equitable title to those rights in the subject lease which would entitle the applicant to conduct operations thereon.
CONDITIONS OF APPROVAL, IF ANY:

Acting Assistant Field Office Manager
Lands and Minerals

/S/LARRY D. BRAY

ED BY TITLE DATE 7-27-99

*See Instructions On Reverse Side

C. Section 1001, makes it a crime for any person knowingly and willfully to make to any department or agency of the States any false, fictitious or fraudulent statements or representations as to any matter within its jurisdiction.



District I
PO Box 1988, Hobbs, NM 88240-2988
District II
PO Drawer DD, Artesia, NM 88211-0719
District III
1000 Rio Bravo Rd., Aztec, NM 87410
District IV
PO Box 2088, Santa Fe, NM 87504-2088

State of New Mexico
Energy, Minerals & Natural Resources Department

OIL CONSERVATION DIVISION
PO Box 2088
Santa Fe, NM 87504-2088

Form C-102
Revised February 10, 1994
Instructions on back
Submit to Appropriate District Office
State Lease - 4 Copies
Fee Lease - 3 Copies

☐ AMENDED REPORT

WELL LOCATION AND ACREAGE DEDICATION PLAT

1 API Number		2 Pool Code		3 Pool Name Indian Basin Upper Penn		
4 Property Code		5 Property Name MALONE "ASA" FEDERAL COM			6 Well Number 2	
7 OGRID No. 025575		8 Operator Name YATES PETROLEUM CORPORATION			9 Elevation 3950.	

10 Surface Location

UL or lot no.	Section	Township	Range	Lot Idn	Feet from the	North/South line	Feet from the	East/West line	County
A	12	22-S	23-E		660	NORTH	1310	EAST	EDDY

11 Bottom Hole Location If Different From Surface

UL or lot no.	Section	Township	Range	Lot Idn	Feet from the	North/South line	Feet from the	East/West line	County

12 Dedicated Acres 320	13 Joint or Infill	14 Consolidation Code	15 Order No.
---------------------------	--------------------	-----------------------	--------------

NO ALLOWABLE WELL BE ASSIGNED TO THIS COMPLETION UNTIL ALL INTERESTS HAVE BEEN CONSOLIDATED
OR A NON-STANDARD UNIT HAS BEEN APPROVED BY THE DIVISION

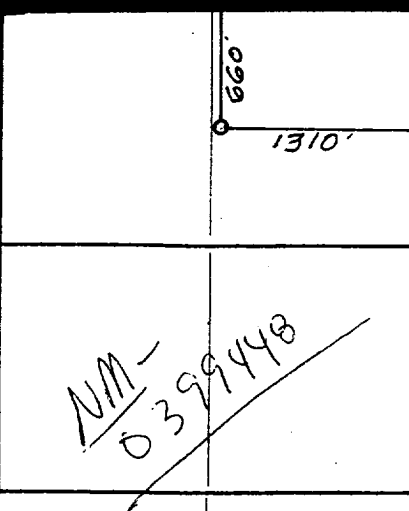
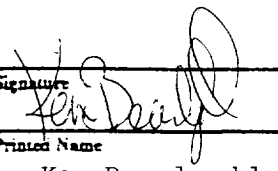
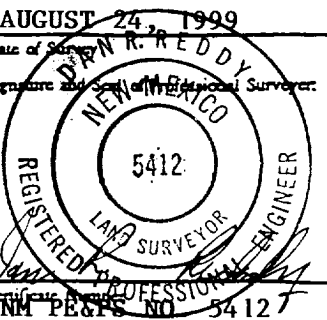
16			17 OPERATOR CERTIFICATION	
			I hereby certify that the information contained herein is true and complete to the best of my knowledge and belief.	
			Signature:  Printed Name: Ken Beardemphl Title: Landman Date: August 25, 1999	
			18 SURVEYOR CERTIFICATION	
			I hereby certify that the well location shown on this plat was plotted from field notes of actual surveys made by me or under my supervision, and that the same is true and correct to the best of my belief.	
			AUGUST 24, 1999 Date of Survey Signature and Seal of Professional Surveyor: 	

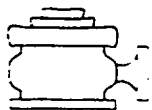

Yates Petroleum Corporation

BOP-3

Typical 3,000 psi Pressure System
Schematic
Annular with Double Ram Preventer Stack

Yates Petroleum Corporation
105 SOUTH 4th STREET
ARTESIA, NEW MEXICO 88210

Malone ASA Federal Com. #2
810' FNL and 660' FEL
Section 12, T22S-R23E
Eddy County, New Mexico
NM-0399448

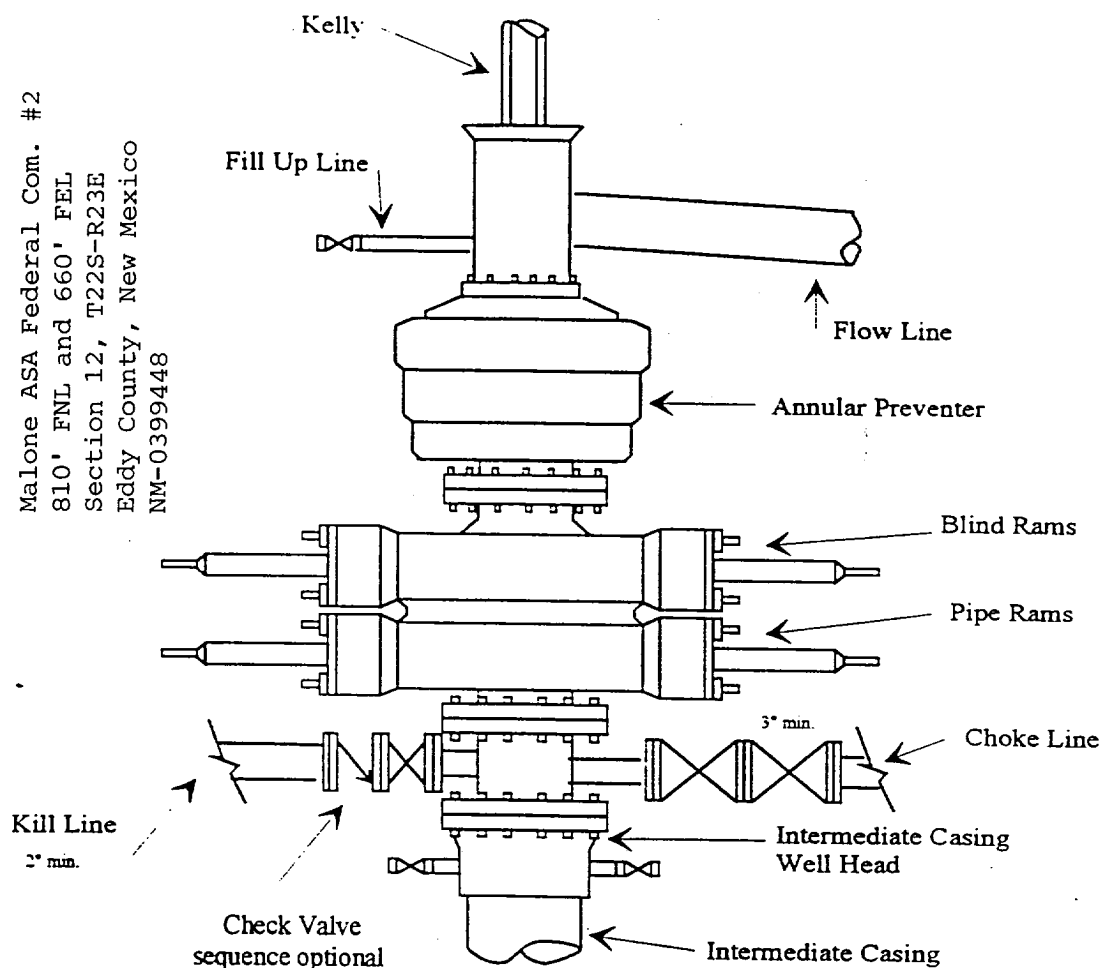

Typical 3,000 psi choke manifold assembly with at least these minimum features

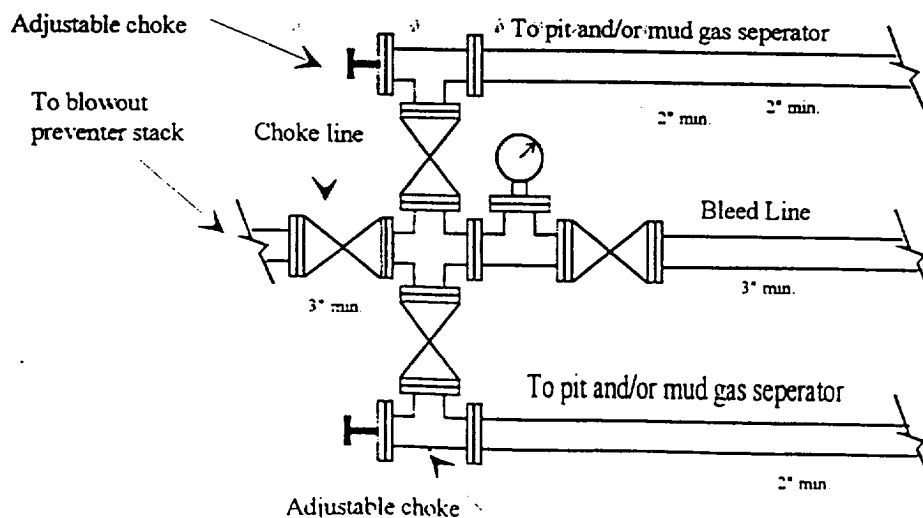

YATES PETROLEUM CORPORATION
Malone "ASA" Federal Com. #2
810' FNL & 660' FEL
Section 12-T22S-R23E
Eddy County, New Mexico

1. The estimated tops of geologic markers are as follows:

San Andres	750'
Glorietta	2200'
Bone Spring	2750'
Wolf Camp	6800'
Canyon	7550'
TD	8100'

2. The estimated depths at which anticipated water, oil or gas formations are expected to be encountered:

Water: 250' - 350'
Oil or Gas: All potential zones.

3. Pressure Control Equipment: BOPE will be installed on the 9 5/8" casing and rated for 3000 BOP systems will be consistent with API RP 53. Pressure tests will be conducted before drilling out from under all casing strings which are set and cemented in place. Blowout Preventor controls will be installed prior to drilling the surface plug and will remain in use until the well is completed or abandoned. Preventors will be inspected and operated at least daily to ensure good mechanical working order, and this inspection recorded on the daily drilling report. See Exhibit B.

Auxiliary Equipment:

- A. Auxiliary Equipment: Kelly cock, pit level indicators, flow sensor equipment and a sub with full opening valve to fit the drill pipe and collars will be available on the rig floor in the open position at all times for use when kelly is not in use.

4. THE PROPOSED CASING AND CEMENTING PROGRAM:

- A. Casing Program: (All New)

<u>Hole Size</u>	<u>Casing Size</u>	<u>Wt./Ft</u>	<u>Grade</u>	<u>Coupling</u>	<u>Interval</u>	<u>Length</u>
14 3/4"	9 5/8"	36#	J-55	ST&C	0-1500'	1500'
8 3/4"	7.0"	23#	J-55	LT&C	0-5500'	5500'
8 3/4"	7.0"	26#	J-55	LT&C	5500'-7600'	2100'
8 3/4"	7.0"	26#	N-80	LT&C	7600'-8100'	500'

Minimum Casing Design Factors: Collapse 1.125, Burst 1.0, Joint Strength 1.8