

DISTRICT I
P. O. Box 1980
Hobbs, NM 88241-1980

State of New Mexico
Department of Energy, Minerals, and Natural Resources

EXHIBIT # 2
Form C-102
Revised 02-10-94

Instructions on back

DISTRICT II
P. O. Drawer DD
Artesia, NM 88211-0719

OIL CONSERVATION DIVISION
P. O. Box 2088
Santa Fe, New Mexico 87504-2088

Submit to the Appropriate
District Office
State Lease - 4 copies
Fee Lease - 3 copies

☐ AMENDED REPORT

DISTRICT III
1000 Rio Brazos Rd.
Aztec, NM 87410

DISTRICT IV
P. O. Box 2088
Santa Fe, NM 87507-2088

WELL LOCATION AND ACREAGE DEDICATION PLAT

| | | | | | | | |
|---------------------|--|--|--|--|--|----------------------|--|
| 1 API Number | | 2 Pool Code | | 3 Pool Name INDIAN BASIN (UPPER PENN) | | | |
| 4 Property Code | | 5 Property Name WINSTON GAS COM | | | | 6 Well Number 8 | |
| 7 OGRID No. 6137 | | 8 Operator Name DEVON ENERGY CORPORATION (NEVADA) | | | | 9 Elevation 3829' | |

10 SURFACE LOCATION

| UL or lot no. | Section | Township | Range | Lot Ida | Feet from the | North/South line | Feet from the | East/West line | County |
|---------------|---------|----------|-------------------|---------|---------------|------------------|---------------|----------------|--------|
| B | 31 | 21 SOUTH | 24 EAST, N.M.P.M. | | 938' | NORTH | 1873' | EAST | EDDY |

"BOTTOM HOLE LOCATION IF DIFFERENT FROM SURFACE

| UL or lot no. | Section | Township | Range | Lot Ida | Feet from the | North/South line | Feet from the | East/West line | County |
|---------------|---------|----------|-------------------|---------|---------------|------------------|---------------|----------------|--------|
| I | 31 | 21 SOUTH | 24 EAST, N.M.P.M. | | 1980' | SOUTH | 660' | EAST | EDDY |

| | | | |
|---------------------------|--------------------|-----------------------|--------------|
| 12 Dedicated Acres 320 | 13 Joint or Infill | 14 Consolidation Code | 15 Order No. |
|---------------------------|--------------------|-----------------------|--------------|

NO ALLOWABLE WELL BE ASSIGNED TO THIS COMPLETION UNTIL ALL INTERESTS HAVE BEEN
CONSOLIDATED OR A NON-STANDARD UNIT HAS BEEN APPROVED BY THE DIVISION

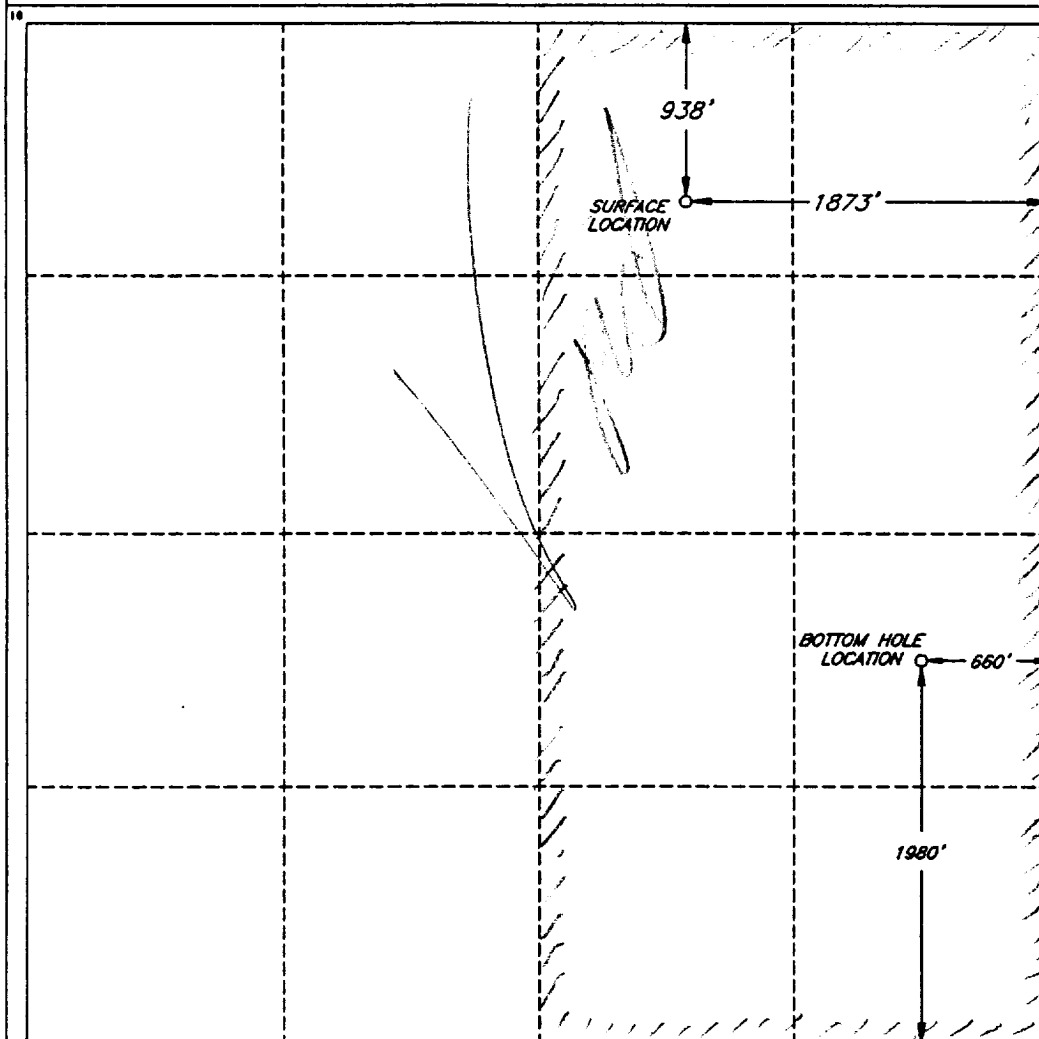

OPERATOR CERTIFICATION

I hereby certify that the information
contained herein is true and complete
to the best of my knowledge and belief.

Signature
Candace R. Graham

Printed Name
Candace R. Graham

Title
Engineering Tech.

Date
October 15, 1999

SURVEYOR CERTIFICATION

I hereby certify that the well
location shown on this plat was
plotted from field notes of actual
surveys made by me or under
my supervision, and that the
same is true and correct to the
best of my belief.

Date of Survey
SEPTEMBER 8, 1999

Signature and Seal of
Professional Surveyor

V. L. Bezner
9-22-99

Certificate No.
V. L. BEZNER - P.S. #7920

JOB #64996 / 51 NE / V.H.B.