

UNITED STATES
DEPARTMENT OF THE INTERIOR
BUREAU OF LAND MANAGEMENT

SUBMIT IN ☐ "PLICATE"
(Other instructions on
reverse side)

FORM APPROVED
OMB NO. 1004-0136
Expires: February 28, 1995

APPLICATION FOR PERMIT TO DRILL OR DEEPEN

1a. TYPE OF WORK

DRILL ☒

DEEPEEN ☐

b. TYPE OF WELL

OIL
WELL ☐

GAS
WELL ☒

OTHER ☐

SINGLE
ZONE ☒

MULTIPLE
ZONE ☐

2. NAME OF OPERATOR

Nearburg Producing Company

15742

3. ADDRESS AND TELEPHONE NO.

3300 North A Street, Building 2, Suite 120, Midland, Texas 79705 (915) 686-8235

4. LOCATION OF WELL (Report location clearly and in accordance with any State requirements.)*

At surface 660' FSL and 710' FEL

At proposed prod. zone

Revelation

Unit P

7. UNIT AGREEMENT NAME

8. FARM OR LEASE NAME, WELL NO.

White Tip 12 Federal Com #1

26123

9. API WELL NO.

30-015-31209

10. FIELD AND POOL, OR WILDCAT

Morrow (Gas)

11. SEC., T., R., M., OR BLK.
AND SURVEY OR AREA

Section 12, T22S, R25E

14. DISTANCE IN MILES AND DIRECTION FROM NEAREST TOWN OR POST OFFICE*

5 miles Southwest of Carlsbad

12. COUNTY OR PARISH

Eddy

13. STATE

New Mexico

15. DISTANCE FROM PROPOSED*

LOCATION TO NEAREST
PROPERTY OR LEASE LINE, FT
(Also to nearest drig. unit line, if any)

660'

16. NO. OF ACRES IN LEASE

120

17. NO. OF ACRES ASSIGNED
TO THIS WELL

330.50

18. DISTANCE FROM PROPOSED LOCATION*
TO NEAREST WELL, DRILLING, COMPLETED,
OR APPLIED FOR, ON THIS LEASE, FT.

NA

19. PROPOSED DEPTH

11,700'

20. ROTARY OR CABLE TOOLS

Rotary

21. ELEVATIONS (Show whether DF, RT, GR, etc.)

3,757' GR

22. APPROX. DATE WORK WILL START*

07/01/00

23.

PROPOSED CASING AND CEMENTING PROGRAM

SIZE OF HOLE	GRADE, SIZE OF CASING	WEIGHT PER FOOT	SETTING DEPTH	QUANTITY OF CEMENT
17-1/2"	13-3/8"	48#	300'	500 sx cmt, circ to surface
12-1/4"	9-5/8"	36#	2600'	1000 sx cmt, circ to surface
7-7/8"	5-1/2"	17# & 20#	11,700'	500 sx cmt

WITNESS
WITNESS

Propose to drill well to sufficient depth to evaluate the Morrow formation. After reaching TD, logs will be run and casing set if the evaluation is positive. Perforate, test and stimulate as necessary to establish production.

Acreage dedication 320; E/2 of Section

Notify OCD at SPUD & TIME
to witness cementing the
casing.



APPROVAL SUBJECT TO
GENERAL REQUIREMENTS AND
SPECIAL STIPULATIONS

IN ABOVE SPACE DESCRIBE PROGRAM: If proposal is to deepen, give data on present productive zone and proposed new productive zone. If proposal is to drill or deepen directionally, give pertinent data on subsurface locations and measured and true vertical depths. Give blowout preventer program, if any.

24.

SIGNED

TITLE Drilling Superintendent

DATE

4-3-2000

(This space for Federal or State office use)

PERMIT NO.

APPROVAL DATE

Application approval does not warrant or certify that the applicant holds legal or equitable title to those rights in the subject lease which would entitle the applicant to conduct operations thereon.
CONDITIONS OF APPROVAL, IF ANY:

APPROVED BY

CLAYTON D. BRAY

TITLE

Assistant Field Manager,
Lands And Minerals

DATE

JUN 22 2000

*See Instructions On Reverse Side

Title 18 U.S.C. Section 1001, makes it a crime for any person knowingly and willfully to make to any department or agency of the United States any false, fictitious or fraudulent statements or representations as to any matter within its jurisdiction.

APPROVED FOR 1 YEAR

•••••



RECEIVED
1955 APR - 6 A 9 56
THE OFFICE OF THE
SHERIFF

STATEMENT ACCEPTING RESPONSIBILITY FOR OPERATIONS

Nearburg Producing Company
3300 North "A" Street, Building 2, Suite 120
Midland, Texas 77905

The undersigned accepts all applicable terms, conditions, stipulations and restrictions covering operations conducted on the leased land or portion thereof, as described below:

Lease No: LC-0624528 (A)

Legal Description of Land: 660' FSL & 710' FEL
Section 12, T22S, R25E
Eddy County, New Mexico

Formation(s) (if applicable): Happy Valley; Morrow (Gas)

Bond Coverage: \$25,000 statewide bond of Nearburg Producing Company

BLM Bond File No: NM1307

Date

4-3-2000

H. R. Willis

Drilling Superintendent

**ATTACHMENT TO FORM 3160-3
WHITE TIP 12 FEDERAL #1
SECTION 12, T22S, R25E
EDDY COUNTY, NEW MEXICO**

DRILLING PROGRAM

1. GEOLOGIC NAME OF SURFACE FORMATION

Red Bed

2. ESTIMATED TOPS OF IMPORTANT GEOLOGIC MARKERS

T/Ruslter	1,400'	T/Atoka	10,450'
T/Delaware	2,600'	T/Morrow	10,850'
T/Wolfcamp	4,850'		
T/Strawn	9,950'		

3. ESTIMATED DEPTHS OF ANTICIPATED FRESH WATER, OIL, OR GAS

Delaware	3,640'	Oil
Strawn	10,180'	Gas
Morrow	11,040'	Gas

4. CASING AND CEMENTING PROGRAM

<u>Casing Size</u>	<u>From</u>	<u>To</u>	<u>Weight</u>	<u>Grade</u>	<u>Joint</u>
13-3/8"	0'	300'	48#	H40	STC
8-5/8"	0'	2,600'	36#	J55	LTC
5-1/2"	0'	11,700'	17#&20#	J55,N80	LTC

Equivalent or adequate grades and weights of casing may be substituted at time casing is run, depending on availability.

We plan to drill a 17-1/2" hole to equal 300'. 13-3/8" casing will be cemented with 500 sx or volume necessary to bring cement back to surface.

12-1/4" hole will be drilled to 2,600' and 9-5/8" casing will be cemented with 1,200 sx Class "C" or volume necessary to bring cement back to surface.

7-7/8" hole will be drilled to 11,700' and 5-1/2" production casing will be cemented with approximately 500 sx of Class "H" cement.

5. MINIMUM SPECIFICATIONS FOR PRESSURE CONTROL

The BOP stack will consist of a 5,000 psi working pressure, dual ram type preventer and annular.

A BOP sketch is attached.

6. TYPES AND CHARACTERISTICS OF THE PROPOSED MUD SYSTEM

Spud and drill to 300' with fresh water mud for surface string. The intermediate section will be drilled with 10 ppg Brine water mud to 2,600'. Intermediate casing will be run at this depth. The production section from 2,600' to 11,700' will be 9.2 – 9.6 ppg cut Brine/Pac/XCD system with mud weight sufficient to control formation pressures.

7. AUXILIARY WELL CONTROL AND MONITORING EQUIPMENT

None required.

8. LOGGING, TESTING, AND CORING PROGRAM

DLL/CNL/LDT/CAL/GR logging is planned. Drill stem tests, cores and sidewall cores are possible.

9. ABNORMAL CONDITIONS, PRESSURES, TEMPERATURES & POTENTIAL HAZARDS

None anticipated.

BHP expected to be 3,500 psi.

10. ANTICIPATED STARTING DATE:

Is planned that operations will commence on July 1, 2000 with drilling and completion operation lasting about 30 day.

SURFACE USE AND OPERATIONS PLAN FOR
DRILLING, COMPLETION, AND PRODUCING

NEARBURG PRODUCING COMPANY
WHITE TIP 12 FEDERAL #1
SECTION 12-T22S-R25E
EDDY COUNTY, NEW MEXICO

LOCATED

5 miles Southwest of Carlsbad, New Mexico

OIL & GAS LEASE

LC-064528-A

RECORD LESSEE

Union Oil Co. Of California, et al

BOND COVERAGE

\$25,000 statewide bond of Nearburg Producing Company

ACRES IN LEASE

120.00 acres

330.50 (Unit)

GRAZING LEASE

None

POOL

Happy Valley; Morrow (Gas)

EXHIBITS

- A. Area Road Map
- B. Drilling Rig Layout
- C. Vicinity Oil & Gas Map
- D. Topographic & Location Verification Map
- E. Well Location & Acreage Dedication Map

This well will be drilled to a depth of approximately 11,700'.

1. EXISTING ROADS

A. Exhibit A is a portion of a section map showing the location of the proposed well as staked.

B. Exhibit C is a plat showing existing roads in the vicinity of the proposed well site.

2. ACCESS ROADS

A. Length and Width

The access road will be built and is shown on Exhibit D.

B. Surface Material

Existing.

C. Maximum Grade

Less than five percent

D. Turnouts

None necessary.

E. Drainage Design

Existing.

F. Culverts

None necessary.

G. Gates and Cattle Guards

None needed.

3. LOCATION OF EXISTING WELLS

Existing wells in the immediate area are shown in Exhibit C.

4. LOCATION OF EXISTING AND/OR PROPOSED FACILITIES

Necessary production facilities for this well will be located on the well pad.

5. LOCATION AND TYPE OF WATER SUPPLY

It is not contemplated that a water well will be drilled. Water necessary for drilling will be purchased and hauled to the site over existing roads shown on Exhibit D.

6. METHODS OF HANDLING WASTE DISPOSAL

- A. Drilling fluids will be allowed to evaporate in the drilling pits until the pits are dry.
- B. Water produced during tests will be disposed of in the drilling pits.
- C. Oil produced during tests will be stored in test tanks.
- D. Trash will be contained in a trash trailer and removed from well site.
- E. All trash and debris will be removed from the well site within 30 days after finishing drilling and/or completion operations.

7. ANCILLARY FACILITIES

None required.

8. WELL SITE LAYOUT

Exhibit B shows the relative location and dimensions of the well pad, mud pits, reserve pit, and trash pit, and the location of major rig components.

9. PLANS FOR RESTORATION OF THE SURFACE

- A. After completion of drilling and/or completion operations, all equipment and other material not needed for operations will be removed. The well site will be cleaned of all trash and junk to leave the site in an as aesthetically pleasing condition as possible.
- B. After abandonment, all equipment, trash, and junk will be removed and the site will be clean.

10. OTHER INFORMATION

A. Topography

The land surface at the well site is rolling native grass with a regional slope being to the east.

B. Soil

Topsoil at the well site is sandy soil.

C. Flora and Fauna

The location is in an area sparsely covered with mesquite and range grasses.

D. Ponds and Streams

There are no rivers, lakes, ponds, or streams in the area.

E. Residences and Other Structures

There are no residences within a mile of the proposed well site.

F. Archaeological, Historical, and Cultural Sites

None observed on this area.

G. Land Use

Grazing

H. Surface Ownership

Bureau of Land Management

11. OPERATOR'S REPRESENTATIVE

H. R. Willis
3300 North "A" Street, Bldg 2, Suite 120
Midland, Texas 79705
Office: (915) 686-8235
Home: (915) 697-2484

12. CERTIFICATION

I hereby certify that I, or persons under my direct supervision, have inspected the proposed drill site and access route; that I am familiar with the conditions which presently exist; that the statements made in this plan are, to the best of my knowledge, true and correct; and, that the work associated with the operations proposed herein will be performed by Nearburg Producing Company and its contractors and subcontractors in conformity with this plan and the terms and conditions under which it is approved.

Date

4-3-2000

H. R. Willis

Drilling Superintendent

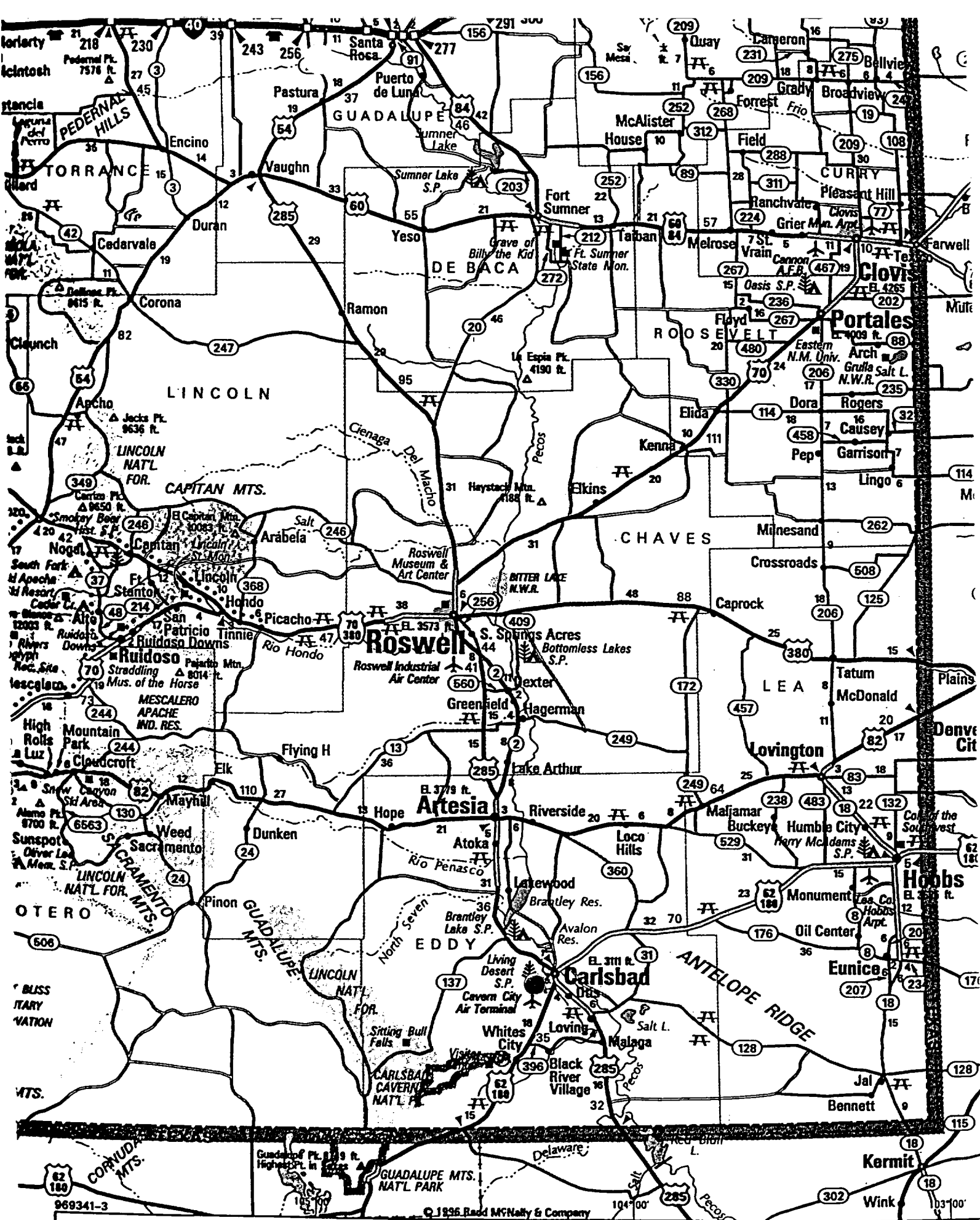

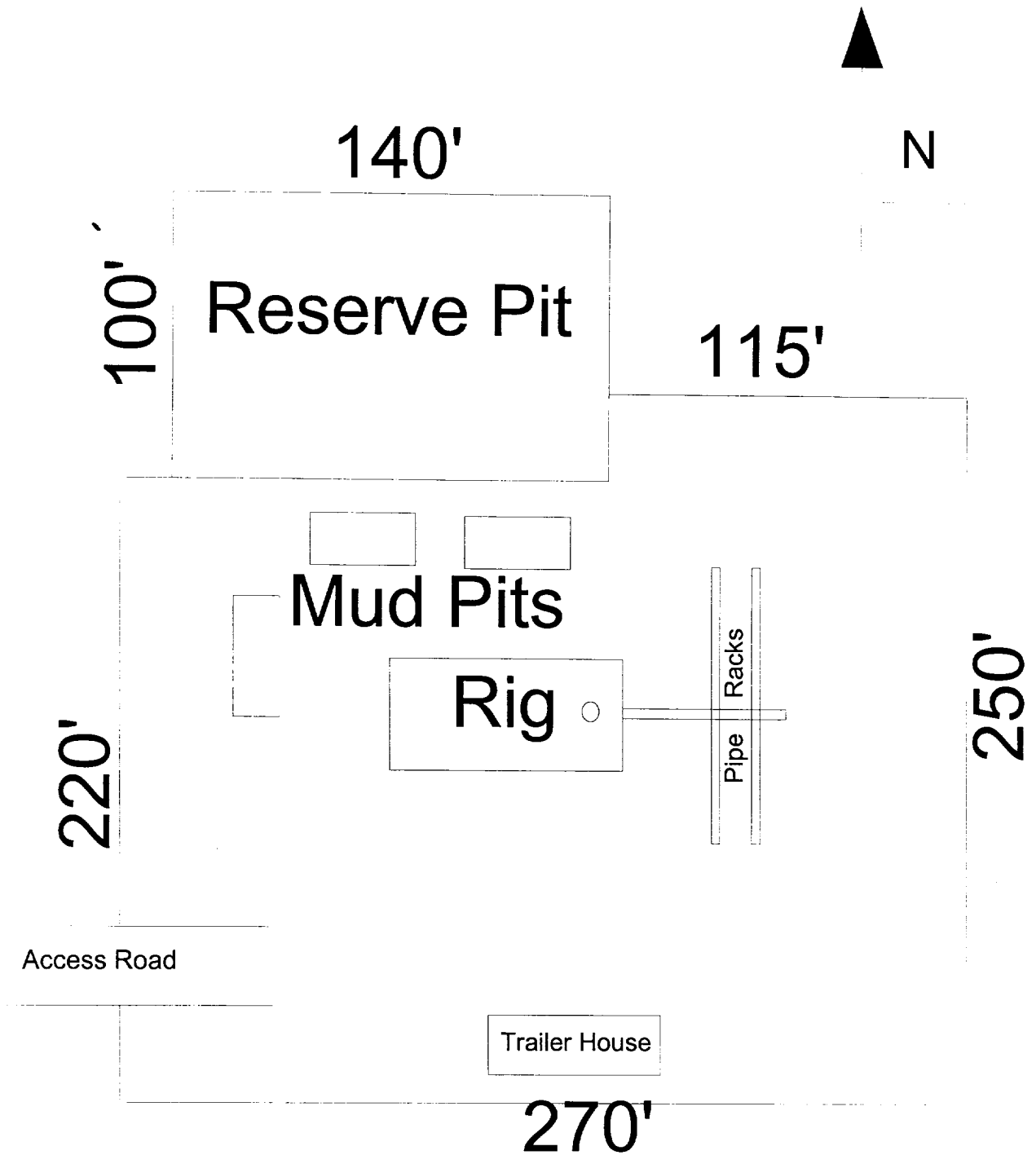
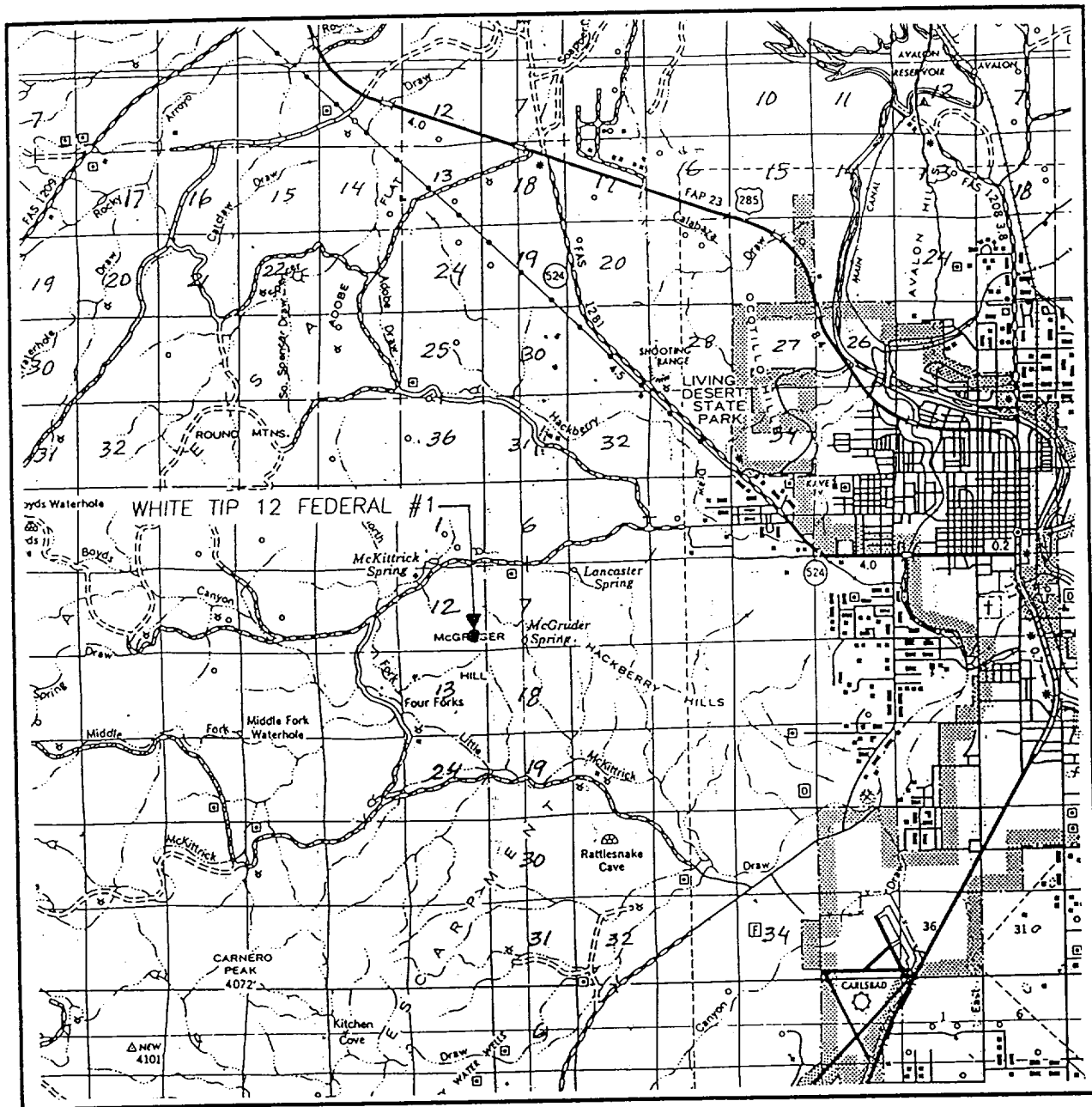

EXHIBIT B
DRILLING RIG LAYOUT
NEARBURG PRODUCING COMPANY
White Tip 12 Federal #1
SCALE 1" = 50'

VICINITY MAP



SCALE: 1" = 2 MILES

SEC. 12 TWP. 22-S RGE. 25-E

SURVEY N.M.P.M.

COUNTY EDDY

DESCRIPTION 660' FSL & 710' FEL

ELEVATION 3757

NEARBURG

OPERATOR PRODUCING COMPANY

LEASE WHITE TIP 12 FEDERAL

JOHN WEST SURVEYING
HOBBS, NEW MEXICO
(505 393-3117)

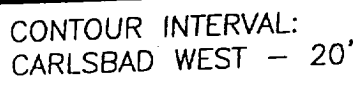

SEC. 12 TWP. 22-S RGE. 25-E
SURVEY _____ N.M.P.M. _____
COUNTY _____ EDDY _____
DESCRIPTION 660' FSL & 710' FEL
ELEVATION _____ 3757 _____
NEARBURG
OPERATOR _____ PRODUCING COMPANY _____
LEASE _____ WHITE TIP 12 FEDERAL _____
U.S.G.S. TOPOGRAPHIC MAP
CARLSBAD WEST, N.M.

**JOHN WEST SURVEYING
HOBBS, NEW MEXICO
(505 393-3117**

DISTRICT I
P.O. Box 1880, Hobbs, NM 88241-1880

DISTRICT II
P.O. Drawer DD, Artesia, NM 88211-0719

DISTRICT III
1000 Rio Brazos Rd., Artesia, NM 87410

DISTRICT IV
P.O. BOX 2088, SANTA FE, N.M. 87504-2088

State of New Mexico
Energy, Minerals and Natural Resources Department

Form C-102
Revised February 10, 1994
Submit to Appropriate District Office
State Lease - 4 Copies
Fee Lease - 3 Copies

OIL CONSERVATION DIVISION

P.O. Box 2088
Santa Fe, New Mexico 87504-2088

☐ AMENDED REPORT

WELL LOCATION AND ACREAGE DEDICATION PLAT

API Number	Pool Code 78060	Pool Name Happy Valley; Morrow (Gas)
Property Code	Property Name WHITE TIP 12 FEDERAL	Well Number 1
OGRID No.	Operator Name NEARBURG PRODUCING COMPANY	Elevation 3757

Surface Location									
UL or lot No.	Section	Township	Range	Lot Idn	Feet from the	North/South line	Feet from the	East/West line	County
P	12	22 S	25 E		660	SOUTH	710	EAST	EDDY

Bottom Hole Location If Different From Surface									
UL or lot No.	Section	Township	Range	Lot Idn	Feet from the	North/South line	Feet from the	East/West line	County
Dedicated Acres 330.50	Joint or Infill N	Consolidation Code	Order No.						

NO ALLOWABLE WILL BE ASSIGNED TO THIS COMPLETION UNTIL ALL INTERESTS HAVE BEEN CONSOLIDATED
OR A NON-STANDARD UNIT HAS BEEN APPROVED BY THE DIVISION

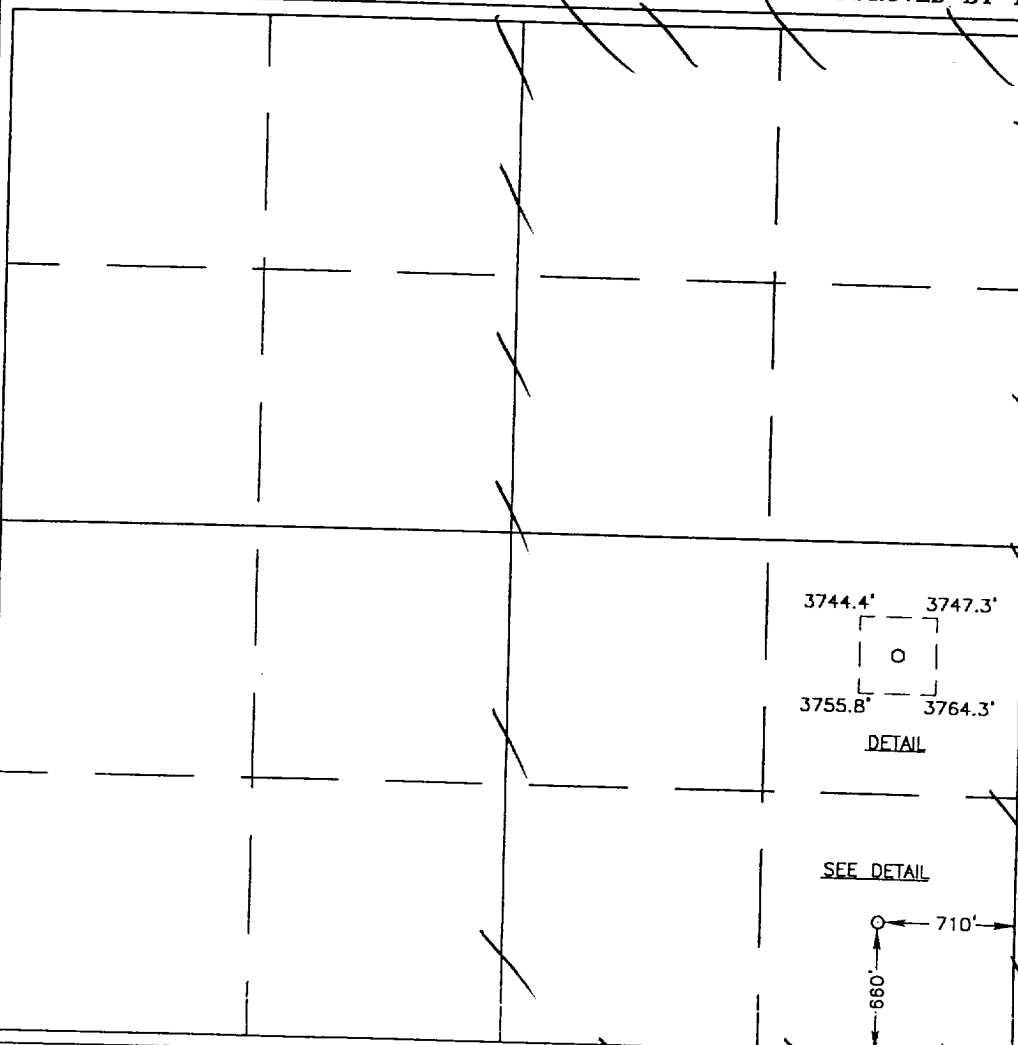
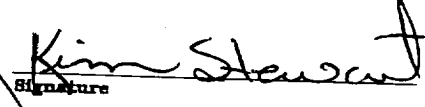
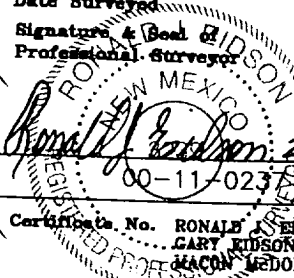
						OPERATOR CERTIFICATION <i>I hereby certify the the information contained herein is true and complete to the best of my knowledge and belief.</i>  Signature Kim Stewart Printed Name Regulatory Analyst Title April 3, 2000 Date
						SURVEYOR CERTIFICATION <i>I hereby certify that the well location shown on this plat was plotted from field notes of actual surveys made by me or under my supervision and that the same is true and correct to the best of my belief.</i> FEBRUARY 22, 2000 Date Surveyed Signature & Seal of Professional Surveyor  Certificate No. RONALD J. EDSON 3239 GARY EDSON 12841 JACON McDONALD 12185

NEARBURG PRODUCING COMPANY
BOPE SCHEMATIC

Rotating Head (Optional)
Drilling Nipple option
must include a fill-up
line. Do not use kill line
for fill up.

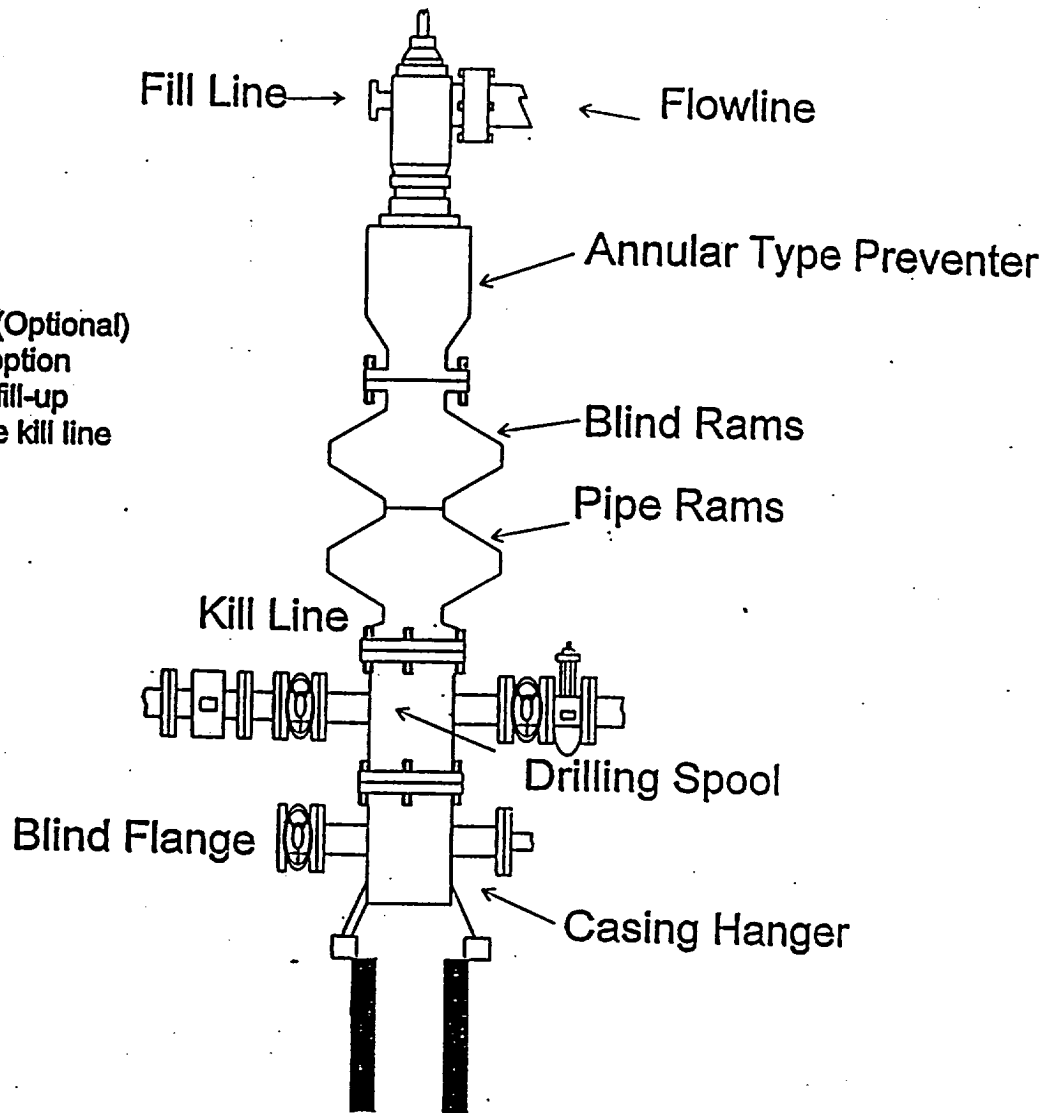

1500 Series

ARBURG PRODUCING COMPA
CHOKE MANIFOLD
5M SERVICE

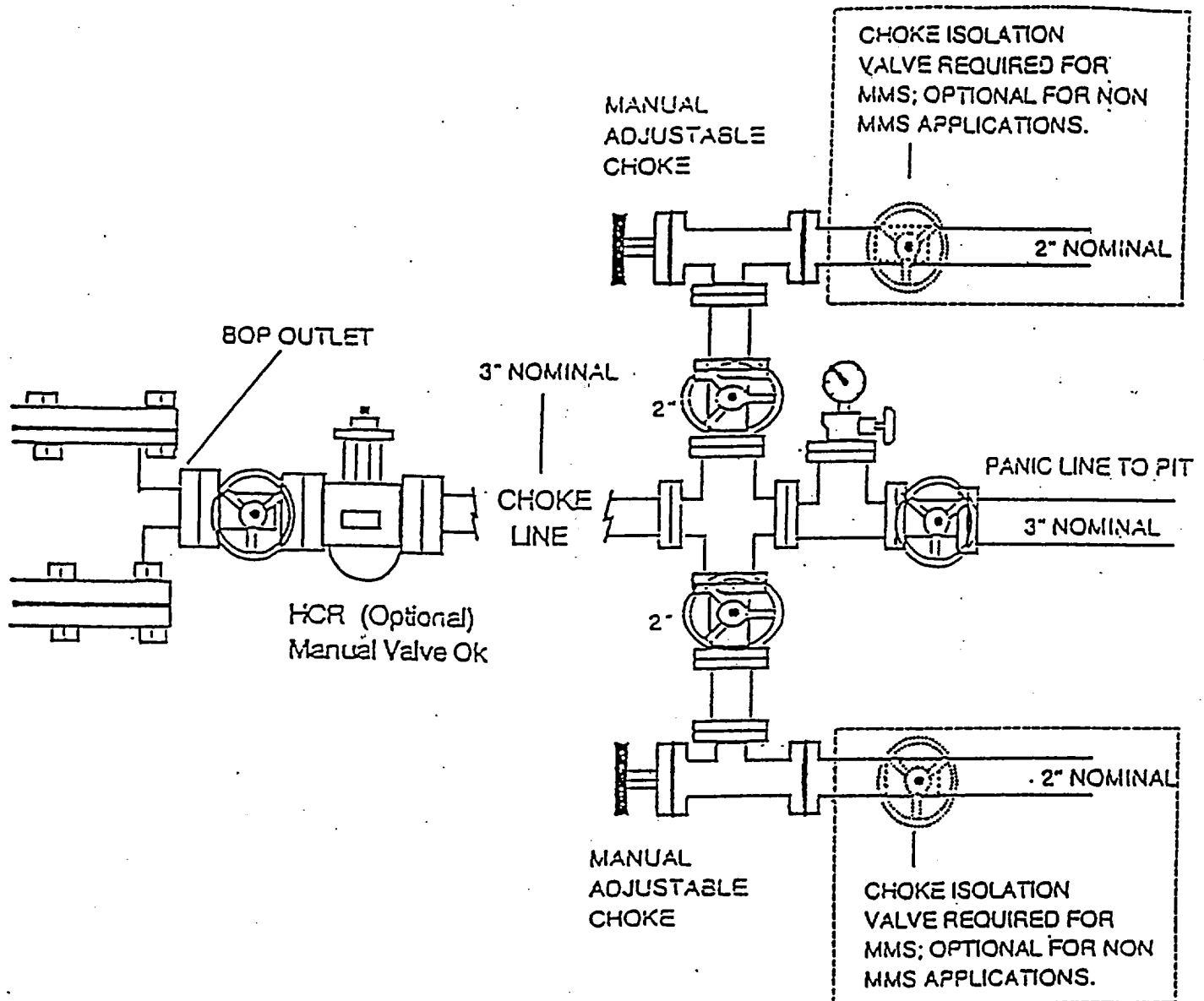

**HYDROGEN SULFIDE DRILLING OPERATIONS PLANS
NEARBURG PRODUCING COMPANY
WHITE TIP 12 FEDERAL #1**

1. HYDROGEN SULFIDE TRAINING

A. All regularly assigned personnel, contracted or employed by Nearburg Producing Company, will receive training from a qualified instructor in the following areas prior to commencing drilling potential hydrogen sulfide bearing formations in this well:

1. The hazards and characteristics of hydrogen sulfide (H₂S).
2. The proper use and maintenance of personal protective equipment and life support systems.
3. The proper use of H₂S detectors, alarms, warning systems, briefing areas, evacuation procedures and prevailing winds.
4. The proper techniques for first aid and rescue procedures.

B. In addition, supervisory personnel will be trained in the following areas:

1. The effects of H₂S on metal components. If high tensile tubulars are to be used, personnel will be trained in their special maintenance requirements.
2. Corrective action and shut-in procedures when drilling or reworking a well and blowout prevention and well control procedures.
3. The contents and requirements of the H₂S Drilling Operations Plan.

C. There will be an initial training session just prior to encountering a known or probable H₂S zone (within 3 days or 500 feet) and weekly H₂S and well control drills for all personnel in each crew. The initial training session shall include a review of the site specific H₂S Drilling Operations Plan. This plan shall be available at the well site. All personnel will be required to carry documentation that they have received the proper training.

HYDROGEN SULFIDE DRILLING OPERATIONS PLANS

PAGE 2

2. H2S SAFETY EQUIPMENT AND SYSTEMS

Note: All H2S safety equipment and systems will be installed, tested and operational when drilling reaches a depth of 500 feet above, or three days prior to penetrating the first zone containing or reasonably expected to contain H2S.

A. Well Control Equipment:

1. Flare line with continuous pilot.
2. Choke manifold with a minimum of one remote choke.
3. Blind rams and pipe rams to accommodate all sizes with properly sized closing unit.
4. Auxiliary equipment to include: annular preventer, mud-gas separator, rotating head and flare gun with flares as needed.

B. Protective Equipment for Essential Personnel:

Mark II Surviveair 30-minute units located in the dog house and at briefing areas, as indicated on well site diagram.

C. H2S Detection and Monitoring Equipment:

1. Two portable H2S monitors positioned and location for best coverage and response. These units have warning lights and audible sirens when H2S levels of 20 ppm are reached.
2. One portable SO2 monitor positioned near flare line.

D. Visual Warning systems:

1. Wind direction indicators as shown on well site diagram.
2. Caution/Danger signs shall be posted on roads providing direct access to location. Signs will be painted a high visibility yellow with black lettering of sufficient size to be readable at a reasonable distance from the immediate location. Bilingual signs will be used when appropriate. See example attached.

HYDROGEN SULFIDE DRILLING OPERATIONS PLANS

PAGE 3

E. Mud Program

1. The Mud Program has been designed to minimize the volume of H₂S circulated to the surface. Proper mud weights, safe drilling practices and the use of H₂S scavengers will minimize hazards when penetrating H₂S bearing zones.
2. A mud-gas separator will be utilized as needed.

F. Metallurgy

All drill strings, casing, tubing, wellhead, blowout preventers, drilling spool, kill lines, choke manifold and line and valves shall be suitable for H₂S service.

G. Communication

1. Cellular telephone communications in company vehicles and mud logging trailer.
2. Land line (telephone) communications at area office.

H. Well Testing

Drill stem testing will be performed with a minimum number of personnel in the immediate vicinity, which are necessary to safely and adequately conduct the test. The drill stem testing in an H₂S environment will be conducted during the daylight hours.

WARNING

**YOU ARE ENTERING A H2S AREA
AUTHORIZED PERSONNEL ONLY**

1. BEARDS OR CONTACT LENSES NOT ALLOWED
2. HARD HATS REQUIRED
3. SMOKING IN DESIGNATED AREAS ONLY
4. BE WIND CONSCIOUS AT ALL TIMES
5. CHECK WITH NEARBURG SUPERINTENDENT AT MAIN OFFICE

NEARBURG PRODUCING COMPANY

(915) 686-8235

Location Entry

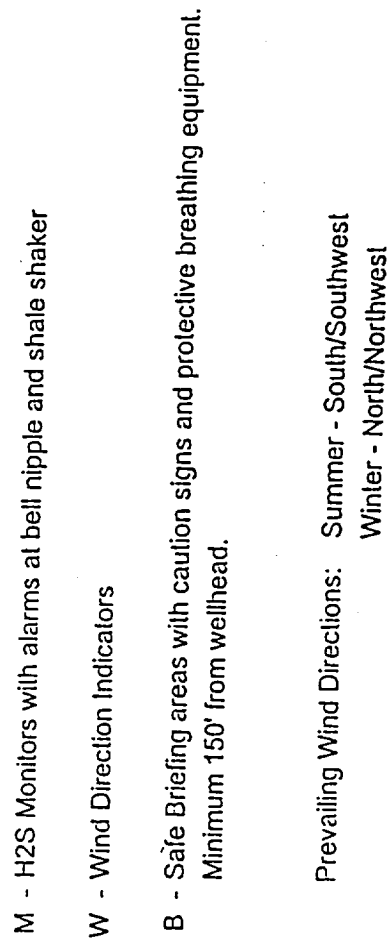

M - H₂S Monitors with alarms at bell nipple and shale shaker

W - Wind Direction Indicators

**B - Safe Briefing areas with caution signs and protective breathing equipment.
Minimum 150' from wellhead.**

Prevailing Wind Directions: Summer - South/Southwest
Winter - North/Northwest