

N.M. Oil & Gas Division Dist. 2
1301 W. 6th Avenue
Artesia, NM 88210
UNITED STATES DEPARTMENT OF THE INTERIOR
BUREAU OF LAND MANAGEMENT

FORM APPROVED
OMB NO. 1004-0136
Expires: February 28, 1995

CSF

APPLICATION FOR PERMIT TO DRILL OR DEEPEN

1a. TYPE OF WORK

DRILL ☒

DEEPEN ☐

b. TYPE OF WELL

OIL WELL ☐

GAS WELL ☒

OTHER

SINGLE ZONE ☒

MULTIPLE ZONE ☐

2. NAME OF OPERATOR

Marathon Oil Company

3. ADDRESS AND TELEPHONE NO.

P.O. Box 552 Midland, TX 79702

4. LOCATION OF WELL (Report location clearly and in accordance with any State requirements.)*

At surface

1087' FNL & 2037' FEL

At proposed prod. zone

U.P. 685' FSL & 2310' FEL, Mor. 1252' FSL, 2397' FEL

14. DISTANCE IN MILES AND DIRECTION FROM NEAREST TOWN OR POST OFFICE*

15 miles NW of Carlsbad

15. DISTANCE FROM PROPOSED*

LOCATION TO NEAREST
PROPERTY OR LEASE LINE, FT.

(Also to nearest drlg. unit line, if any) 1087'

18. DISTANCE FROM PROPOSED LOCATION*

TO NEAREST WELL, DRILLING, COMPLETED,
OR APPLIED FOR, ON THIS LEASE, FT.

1060'

16. NO. OF ACRES IN LEASE

320/640

17. NO. OF ACRES ASSIGNED
TO THIS WELL

320/640

19. PROPOSED DEPTH

10,700'

20. ROTARY OR CABLE TOOLS

Rotary

21. ELEVATIONS (Show whether DF, RT, GR, etc.)

4123' G.L

Carlsbad Controlled Water Basin

22. APPROX. DATE WORK WILL START*

ASAP

23.

PROPOSED CASING AND CEMENTING PROGRAM

SIZE OF HOLE	GRADE, SIZE OF CASING	WEIGHT PER FOOT	SETTING DEPTH	QUANTITY OF CEMENT
12.25"	9-5/8" K-55	36#	1800'	785 sks.
8.75"	8-3/4" K-55	23#/ 26#	10,700'	1400 sks.

Marathon is proposing to directionally drill the Indian Hills Unit # 35 to a Standard Upper Perm penetration point and a Non Standard Morrow penetration point. This well is on the existing well pad of the Indian Hills Unit # 9 where the old reserve pit will be re-entered.

Distance from the Terminus point of the IHU # 35 to the SHL of Indian Hills Unit # 20 located @ 1730' FEL & 2250' FSL of Sec. 28, T-21-S, R-24-E) is 1060'.

Reference Arch. Report ASC 95-113 preformed Nov. 8, 1995 600' surveyed area. Any additional surface to be used will be surveyed by contract Archaeologist.

APPROVAL SUBJECT TO
GENERAL REQUIREMENTS AND
SPECIAL STIPULATIONS
ATTACHED

IN ABOVE SPACE DESCRIBE PROPOSED PROGRAM: If proposal is to deepen, give data on present productive zone and proposed new productive zone. If proposal is to drill or deepen directionally, give pertinent data on subsurface locations and measured and true vertical depths. Give blowout preventer program, if any.

24.

SIGNED

James F. Fletcher

TITLE Engineer tech.

DATE 10/08/01

(This space for Federal or State office use)

PERMIT NO.

APPROVAL DATE

Application approval does not warrant or certify that the applicant holds legal or equitable title to those rights in the subject lease which would entitle the applicant to conduct operations thereon.

CONDITIONS OF APPROVAL, IF ANY:

APPROVED BY

/s/ LESLIE A. THEISS

TITLE

FIELD MANAGER

DATE

FEB 05 2002

*See Instructions On Reverse Side

Title 18 U.S.C. Section 1001, makes it a crime for any person knowingly and willfully to make to any department or agency of the United States any false, fictitious or fraudulent statements or representations as to any matter within its jurisdiction.

APPROVAL FOR 1 YEAR

RECEIVED
2001 OCT 10 AM 9:13
BUREAU OF LAND MANAGEMENT
FISHKILL OFFICE

DISTRICT I
P.O. Box 1980, Hobbs, NM 88241-1980

DISTRICT II
P.O. Boxer RD, Artesia, NM 88211-0719

DISTRICT III
1000 Rio Brazos Rd., Aztec, NM 87410

DISTRICT IV
P.O. Box 8068, Santa Fe, N.M. 87504-2068

State of New Mexico
Energy, Minerals and Natural Resources Department

OIL CONSERVATION DIVISION

P.O. Box 2088
Santa Fe, New Mexico 87504-2088

Form C-102
Revised February 10, 1994
Submit to Appropriate District Office
State Lease - 4 Copies
Fee Lease - 3 Copies

WELL LOCATION AND ACREAGE DEDICATION PLAT

☐ AMENDED REPORT

API Number	Pool Code	Pool Name
		See attached C-102 forms
Property Code	Property Name	Well Number
	INDIAN HILLS UNIT	35
OGRID No.	Operator Name	Elevation
14021	MARATHON OIL COMPANY	4123'

Surface Location

UL or lot No.	Section	Township	Range	Lot Idn	Feet from the	North/South line	Feet from the	East/West line	County
B	33	21-S	24-E		1087	NORTH	2037	EAST	EDDY

Bottom Hole Location If Different From Surface

UL or lot No.	Section	Township	Range	Lot Idn	Feet from the	North/South line	Feet from the	East/West line	County
Dedicated Acres	Joint or Infill	Consolidation Code	Order No.						

NO ALLOWABLE WILL BE ASSIGNED TO THIS COMPLETION UNTIL ALL INTERESTS HAVE BEEN CONSOLIDATED
OR A NON-STANDARD UNIT HAS BEEN APPROVED BY THE DIVISION

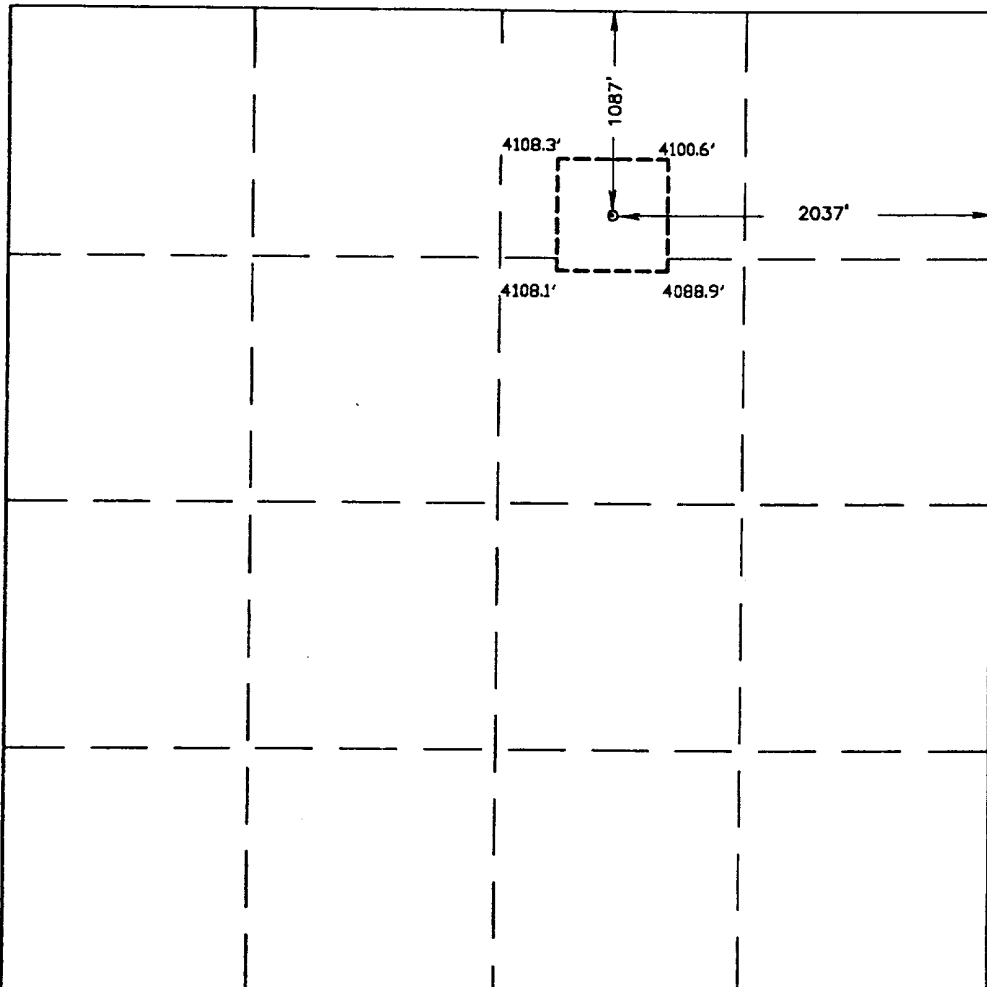
	<p>OPERATOR CERTIFICATION</p> <p>I hereby certify the the information contained herein is true and complete to the best of my knowledge and belief.</p> <p><i>Jerry Fletcher</i> Signature</p> <p><u>Jerry Fletcher</u> Printed Name</p> <p><u>Engineer Tech.</u> Title</p> <p><u>10/04/01</u> Date</p>	
	<p>SURVEYOR CERTIFICATION</p> <p>I hereby certify that the well location shown on this plat was plotted from field notes of actual surveys made by me or under my supervision, and that the same is true and correct to the best of my belief.</p> <p>SEPTEMBER 6, 2001</p> <p>Date Surveyed <u>AWB</u></p> <p>Signature & Seal of Professional Surveyor <i>Ronald J. Edson</i> 01-11-1001</p> <p>Certificate No. <u>RONALD J. EDSON 3239</u> <u>CARY EDSON 12841</u></p>	

Thirteen Point Surface Use Plan
MARATHON OIL COMPANY

INDIAN HILLS UNIT #35
Sec. 33, T-21-S, R-24-E
Eddy County, New Mexico

1. Existing Roads: Refer to Vicinity Lease Map.
 - a. The proposed well site is staked and the surveyor's plat is attached.
 - b. To reach the location from Carlsbad, New Mexico: Follow Hwy. 285 North of Carlsbad 11 miles. Turn left on (NM)137. Go 6 miles west, take left @ "Y" of Marathon Road and Hwy. 137, travel 4.7 miles , turn left on lease road, follow 1.5 miles, turn left, go .3 mile, turn left @ "Y" follow 4-3/4 miles to existing access road on the left. Well site on same location as IHU # 9.
 - c. Existing roads within a one-mile radius (refer to Vicinity Lease Map).
 - d. The existing road will be maintained as necessary to provide access during the drilling operation.
2. An existing access road will be used. The access road enters the drilling pad on the Southeast corner. The drilling location will have a V-Door facing North. Construction plans will require blading and rolling the road and pad.
3. Location of Existing Wells: See Vicinity Lease Map.
4. Location of Existing and Proposed Production Facilities within a one-mile radius:
 - a. Existing: There are five oil and gas wells operated by Marathon within a one-mile radius of the proposed location. These locations have production facilities including separators, condensate, oil, water storage tanks. Marathon operates a variety of dehydrators, meter runs, and several gathering lines in the one-mile radius.
 - b. New Facilities: Facility is in place . Two flow lines will be constructed to go to existing facility# 133. A separate action will be filed for R.O.W. permit.
 - c. Rehabilitation of disturbed areas no longer needed for operations will be accomplished by grading, leveling and seeding as recommended.
5. Location and Type of Water Supply:
 - a. Source: Indian Basin Gas Plant, NE/4 Sec. 23, T-21-S, R-23-E.
 - b. The water will be transported by a trucking contractor. If Fas-line is to be used, Marathon will follow existing ROW corridor.
 - c. No water well will be drilled on this location.

A. P. D. (cont.)
Thirteen Point Surface Use Plan
Indian Hills Unit #35

6. Source of Construction Materials:

- a. Construction materials may be obtained from the construction site.
- b. If production is obtained, native materials will be used on the location and for installation of production facilities.
- c. On-site inspection may dictate any changes in location construction.

7. Methods of Handling Waste Material Disposal:

- a. Cuttings - will be deposited in the reserve pit.
- b. Drilling fluids - contained in reserve pit and allowed to evaporate. Free water will be removed and transported to an approved disposal site to accelerate pit drying.
- c. Produced fluids - none anticipated.
- d. A portable chemical toilet will be provided.
- e. Garbage and other waste material - garbage and trash will be stored in a receptacle on location and periodically hauled to an approved sanitary landfill.
- f. After the rig moves out, all materials not necessary for operations will be removed. Pits will be backfilled and leveled. The location will be cleaned of all trash and debris.

8. Ancillary Facilities: Camp facilities will not be required. Portable trailers will be on location to house a company drilling foreman and contract tool pusher.

9. Well site Layout:

- a. The well pad layout shows the drill site layout as staked. Topsoil will be stockpiled per specifications.
- b. The reserve pit will be fenced on three sides before drilling begins. The fourth side will be fenced when the drilling rig leaves location.
- c. The reserve pit will be lined (8 mil material).

A. P. D. (cont.)
Thirteen Point Surface Use Plan
Indian Hills Unit #35

10. Plans for Restoration of the Surface:

- a. Backfilling, leveling, and contouring are planned as soon as all pits have dried. Waste disposal and spoiled materials will be hauled away immediately after drilling is completed. If production is obtained, the unused area will be restored as soon as possible.
- b. The soil banked material will be spread over the area. Re-vegetation will be accomplished by planting mixed grasses as per formula provided by the BLM. Re-vegetation is recommended for road area, as well as around the drill pad.
- c. The reserve pit will be fenced during drilling operations. Fencing will be maintained until leveling and cleanup are accomplished.
- d. If any oil is in the pits and is not immediately removed after operations cease, the pit containing the oil or other adverse substances will be flagged overhead or covered with mesh.
- e. The rehabilitation operations will begin after the completion rig is removed. Removal of oil or other adverse substances will begin immediately or area will be flagged and fenced. Other cleanup will be done as needed. Planting and re-vegetation will be done between July 15 and September 15.
- f. All efforts will be made to minimize surface disturbances and protect the visual resources along the scenic byway.

11. Other Information:

- a. There are no significant archaeological or cultural sites visible in the area of disturbance. A cultural resource survey was performed by Archaeological Consultants Inc. of Roswell.
- b. General topography: Shown on Vicinity Lease Map. The terrain at the well site is gently rolling hills. Vegetation is primarily sage brush and natural grasses.
- c. Animal life: Prairie dogs, domestic livestock, rabbits and native rodents and predators.
- d. Dwellings (nearest): Approximately 2 miles.
- e. General location: Approximately 15 miles Northwest of Carlsbad, New Mexico.
- f. Drainage: Internal
- g. Surface Owner: The surface is owned by the Bureau of Land Management.
- h. Due to proximity of the location and nearby drainage, Marathon will make every effort to minimize surface disturbance. Please see the location pad and reserve pit dimensions..

A. P. D. (cont.)
Thirteen Point Surface Use Plan
Indian Hills Unit #35

12. Operator Representatives:

R. J. Longmire
Drilling, Completion, & Workover Superintendent
P. O. Box 552
Midland, TX 79702
800/351-1417
915/682-1626
915/687-8344 (Direct Line)
915/499-7964(Pager)

13. Certification:

I hereby certify that I, or someone under my direct supervision, have inspected the proposed drill site and access route; that I am familiar with the conditions that presently exist; that the statements made in this plan are, to the best of my knowledge and belief, true and correct; and that the work associated with the operations proposed herein will be performed by MARATHON OIL COMPANY and its contractors and subcontractors in conformity with this plan and the terms and conditions under which it is approved.

8 October 2001

Date

R. J. Longmire

R. J. Longmire

A. P. D. (cont.)
Thirteen Point Surface Use Plan
Indian Hills Unit #35

DRILLING PROGRAM
MARATHON OIL COMPANY
INDIAN HILLS UNIT #35

1. Estimated KB Elevation: 4140' KB 17' Rig Floor

<u>FORMATION</u>	<u>-----TOP-----</u>		<u>-----BASE-----</u>		<u>FLUID CONTENT</u>
	<u>MEASURED</u>	<u>SUBSEA</u>	<u>MEASURED</u>	<u>SUBSEA</u>	
Queen	Surface	+4140'	650'	+ 3490'	Water
San Andres	650'	+3490'	2825'	+1315'	water
Glorietta	2825'	+1315'	6960'	-2820'	
Dean	6960'	-2820'	7240'	-3100'	
Wolfcamp	7240'	-3100'	7890'	-3750'	Oil & Gas
Cisco	7890'	-3750'	8060'	-3920'	
Canyon	8060'	-3920'	8570'	-4430'	
Strawn	8570'	-4430'	9320'	-5150'	Gas, Oil & Water
Atoka	9320'	-5180'	9660'	-5520'	
Morrow	9660'	-5520'	10,220'	-6080'	Gas
T.D.	10,200'	-6080'	10,700'	-6560'	

<u>FORMATION</u>	<u>---EST PSIG</u>	<u>SBHP--- PPG EMW</u>	<u>EST DEG f</u>	<u>SBHT</u>	<u>H2S PPM</u>	<u>---SIGNIFICANCE---</u> <u>(obj, marker, etc.)</u>
Glorietta	1210	8.5			500	marker
Wolfcamp	1680	9.0			5000	marker
Canyon	1810	9.0				marker
Strawn/ U.P.	2050	9.0			500	objective pay
Morrow	3460	9.2			0	objective pay

2. See (1) above.
 If any unexpected water or mineral bearing zones are encountered, they will be reported, evaluated, and protected as circumstances and regulations require.

3. **Pressure Control Equipment:**

9-5/8" Surface: 11" 3M annular tested to 300#/3000#, 11" 3M dual rams, choke manifold and mud cross, tested to 300#/3000#.

Auxiliary Equipment:

Surface Hole: Annular or rotating head w/air rig.

Intermediate Hole: N/A

Production Hole: Flow indicator, PVT, H₂S Sensors, air packs, stroke counter, rotating head.

BOP systems will be consistent with API RP 53. Blowout preventer will be installed and tested prior to drilling the surface casing plug and will remain in use until the well is completed or abandoned. Preventer will be inspected and operated at least daily to ensure good mechanical working order, and this inspection recorded

A. P. D. (cont.)
Thirteen Point Surface Use Plan
Indian Hills Unit #35

on the daily drilling report. Preventer and casing will be pressure tested before drilling casing cement plugs. Upper and lower kelly cocks with valve handle, safety valve and subs to fit all drill string connections in use will be available on rig floor.

Test Frequency

1. When installed.
2. Anytime a pressure seal is broken (test confined only to affected equipment).
3. At least every 20 days.
4. Blind and pipe rams shall be activated each trip but not more than once/day.

4. Casing and Cement Program:

---DEPTH---		SECTION		HOLE	CSG	WT.		THREADS		NEW
FROM	TO	LENGTH		SIZE	SIZE	PPF	GRADE	COUPLINGS		USED
0	1800'	1800'		12.25"	9-5/8"	36#	K-55	8rd, STC		New
0	4800'	4800'		8.75"	7-0"	23#	K-55	8rd, LT&C		New
4800'	10,700'	5900'		8.75"	7-0"	26#	K-55	8rd, LT&C		New
Casing String	DV Depth	Stg.	Lead Tail	Amt SXS	Type Cement	Yield CF/SX	Wt. PPG.	TOC		Additives
9-5/8"	none	1	L	100	Thix-set	1.52	14.0	surf.		1.0% Thix-set A
9-5/8"		1	T	485	Prem Plus.	2.02	14.8	surf		2% cacl; 5#/sk Flocele
9-5/8"			T	200	Prem. Plus	1.34	14.8	surf		2% CaCl
7"	6400'	1	L	250	"H" Foamed	2.13	9.3	6400'		Foamed N2
7"		1	T	350	"H" Foamed.	1.44	13.0	7000'		Foamed N2
7"		2	L	700	Interfill "C"	2.47	14.0	Surf.		Flocele 1/4#/ sk
7"		2	T	100	"C" Neat	1.32	14.8	5900'		5# /sk Gilsonite

Each stage will be preceded by an appropriate mud flush. Actual production hole volumes will be based on the caliper volume plus 25% excess.

A. P. D. (cont.)
Thirteen Point Surface Use Plan
Indian Hills Unit #35

Centralizer Program:

9-5/8" Conventional centralizers , Bottom 3-joints and every 4th joint to surface.

7.0" Conventional centralizers middle of 1st joint, then every joint to 7500', and 1 cent. Every 4th joint thereafter to 10,700'.

5. Mud Program

---DEPTH---			WEIGHT		WL	ADDITIVES	VISUAL MONTR.
FROM	TO	MUD TYPE	(PPG)	VIS	CC		
0	1200'	fresh water	8.3	28	N/A	Gel, Lime	Reserve
1200'	5000'	fresh	8.5	28-32	N/C	Gel, caustic, H ₂ S Scavenger	Reserve
5000'	7000'	fresh	8.9	32-36	N/C	Gel, caustic, H ₂ S Scavenger	Reserve
7000'	8800'	cut brine	9.0	32-36	<20	Gel, caustic, H ₂ S Scavenger	Steel Pits
8800'	10,700'	cut brine	9.2	32-36	<20	Gel. caustic, H ₂ s Scavenger	Steel Pits

Sufficient quantities of additives will be on location to maintain above mud properties for any anticipated well conditions.

6. Logging, Testing & Coring Programs:

LOG/TEST/CORE/MUDLOG/OTHER	--INTERVAL--		REMARKS
	FROM	TO	
DLL/MSFL/GR/CNL/LDT/CAL	TD	5000'	
LDT/CNL/GR/CAL	TD	surf casing	
MUD LOGGER	6000'	TD	ROP, Lithology, Gas Analysis, Chromatograph
NO CORES OR DST'			

7. Abnormal Pressures, Temperatures or Potential Hazards:

None anticipated. Possible H₂S in Cisco & Strawn. See H₂S Drilling Operations Plan.

8. Other Information:

Anticipated Starting Date: As soon as possible.

Duration of Well: drilling - 25 days, completion - 10 days.

This well shall be directionally drilled to a standard Upper Penn/ Strawn BHL. and a Non standard Morrow BHL . Directional plan provided by Baker Inteq is attached.

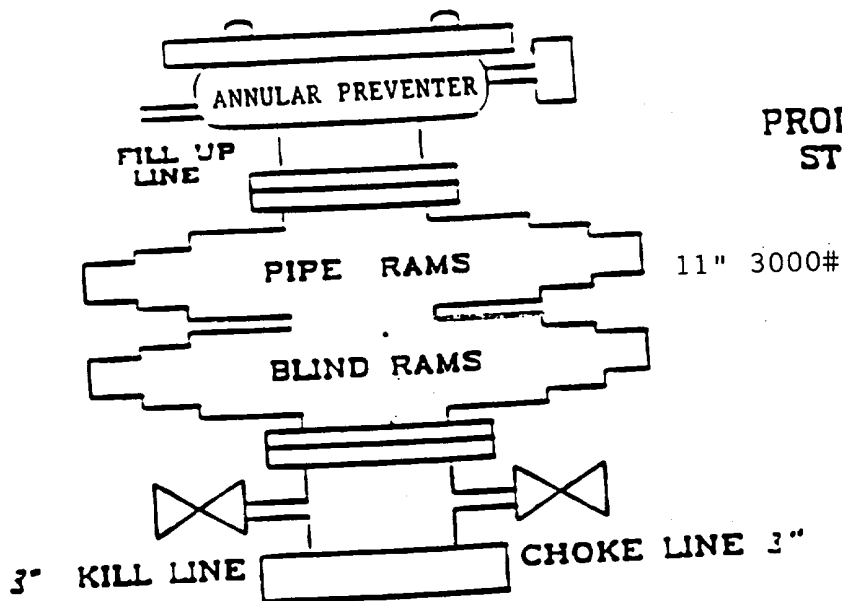

PRODUCTION
STACK

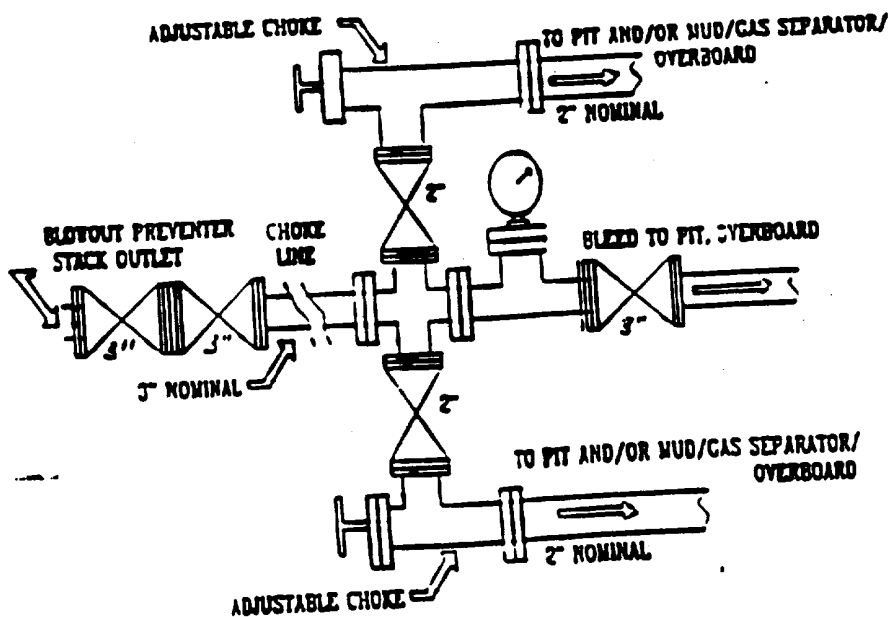

MARATHON OIL COMPANY

H2S DRILLING OPERATIONS PLAN

I. HYDROGEN SULFIDE TRAINING

All contractors and subcontractors employed by Marathon Oil Company will receive or have received training from a qualified instructor within the last twelve months in the following areas prior to commencing drilling operations on this well.

1. The hazards and characteristics of hydrogen sulfide (H2S)
2. Safety precautions
3. Operations of safety equipment and life support systems

In addition, contractor supervisory personnel will be trained or prepared in the following areas:

1. The effect of H2S on metal components in the system. If high tensile tubulars are to be used, personnel will be trained in their special maintenance requirements.
2. Corrective action and shut-down procedures when drilling or reworking a well, blowout prevention and well control procedures, if the nature of work performed involves these items.
3. The contents and requirements of the contingency plan when such plan is required.

All personnel will be required to carry documentation of the above training on their person.

II. H2S EQUIPMENT AND SYSTEMS

1. Safety Equipment

The following safety equipment will be on location.

- A. Wind direction indicators as seen in attached diagram.
- B. Automatic H2S detection alarm equipment (both audio and visual).
- C. Clearly visible warning signs as seen on the attached diagram. Signs will use the words "POISON GAS" and "CAUTION" with a strong color contrast.
- D. Protective breathing equipment will be located in the dog house and at briefing areas as seen in the attached diagram.

2. WELL CONTROL SYSTEMS

A. Blowout Prevention Equipment

Equipment includes but is not limited to:

- a. pipe rams to accomodate all pipe sizes
- b. blind rams
- c. choke manifold
- d. closing unit

Auxillary equipment added as appropriate includes:

- a. annular preventor ☒
- b. rotating head ☒
- c. mud- gas separator ☒
- d. flare line and means of ignition ☒
- e. remote operated choke ☒

B. Communication

The rig contractor will be required to have two-way communication capability. Marathon Oil Company will have either land-line or mobile telephone capabilities.

C. Mud Program

The mud program has been designed to minimize the volume of H₂S circulated to surface. Proper mud weight, safe drilling practices, and the use of H₂S scavengers when appropriate will minimize hazards when penetrating H₂S bearing zones.

D. Drill Stem Test intervals are as follows:

DST No. 1	_____ ft. to _____ ft.
DST No. 2	_____ ft. to _____ ft.
DST No. 3	_____ ft. to _____ ft.

Drill Stem Testing Safety Rules are attached.

III. WELL SITE DIAGRAM

A complete well site diagram including the following information is attached.

- 1. Rig orientation
- 2. Terrain
- 3. Briefing areas
- 4. Ingress and egress
- 5. Pits and flare lines
- 6. Caution and danger signs
- 7. Wind indicators and prevailing wind direction

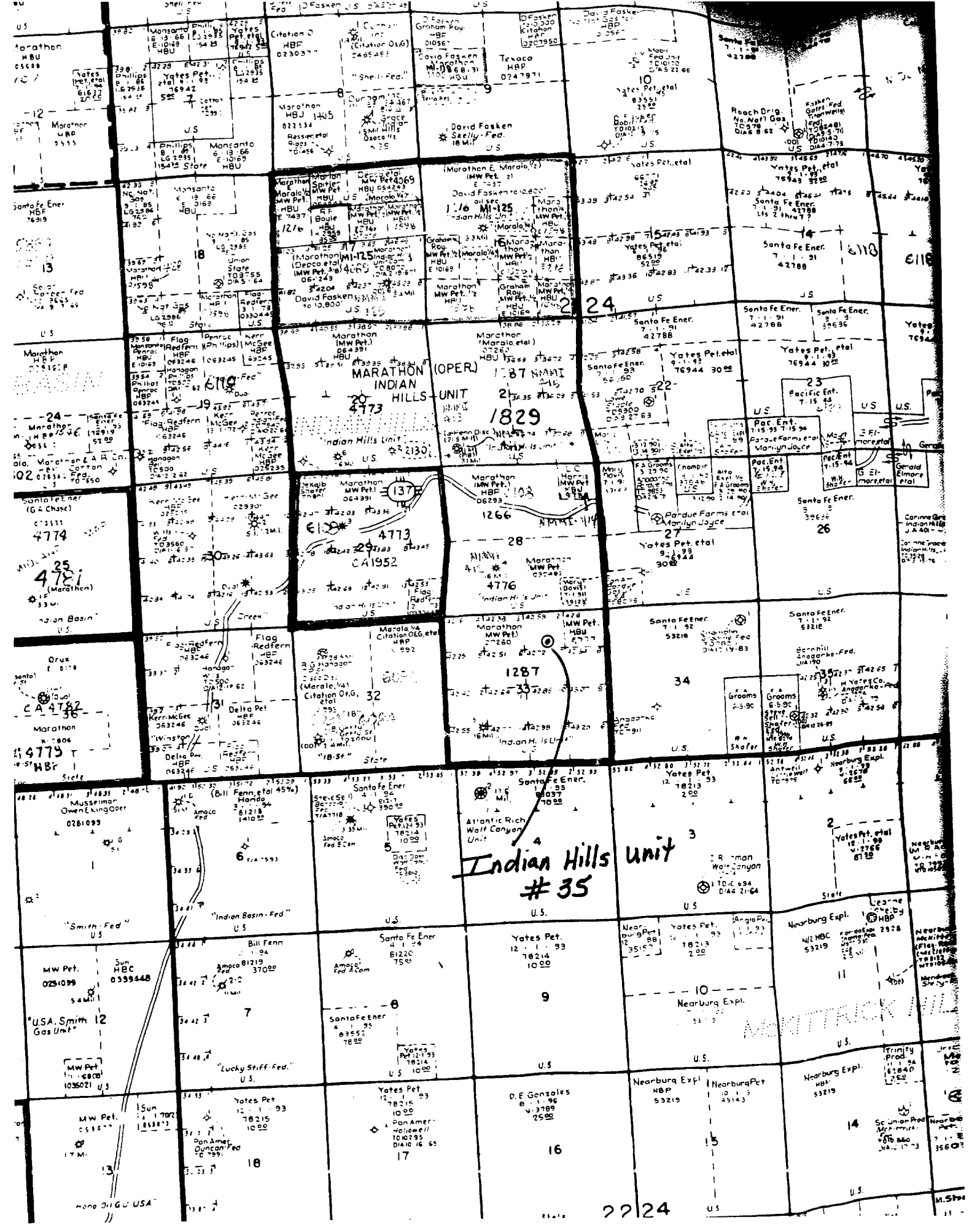

Indian Hills Unit
#35

McKITTRICK HILL

DISTRICT I
P.O. Box 1990, Hobbs, NM 88241-1990

DISTRICT II
P.O. Drawer DD, Artesia, NM 88211-0719

DISTRICT III
1000 Rio Brazos Rd., Aztec, NM 87410

DISTRICT IV
P.O. BOX 2088, SANTA FE, N.M. 87504-2088

State of New Mexico
Energy, Minerals and Natural Resources Department

OIL CONSERVATION DIVISION
P.O. Box 2088
Santa Fe, New Mexico 87504-2088

Form C-102
Revised February 10, 1994
Submit to Appropriate District Office
State Lease - 4 Copies
Fee Lease - 3 Copies

WELL LOCATION AND ACREAGE DEDICATION PLAT

☐ AMENDED REPORT

API Number	Pool Code	Pool Name
		See attached C-102 Forms
Property Code	Property Name INDIAN HILLS UNIT	Well Number 35
OGRID No.	Operator Name MARATHON OIL COMPANY	Elevation 4123'



Surface Location

UL or lot No.	Section	Township	Range	Lot Idn	Feet from the	North/South line	Feet from the	East/West line	County
B	33	21-S	24-E		1087	NORTH	2037	EAST	EDDY

Bottom Hole Location If Different From Surface

UL or lot No.	Section	Township	Range	Lot Idn	Feet from the	North/South line	Feet from the	East/West line	County
Dedicated Acres	Joint or Infill	Consolidation Code	Order No.						

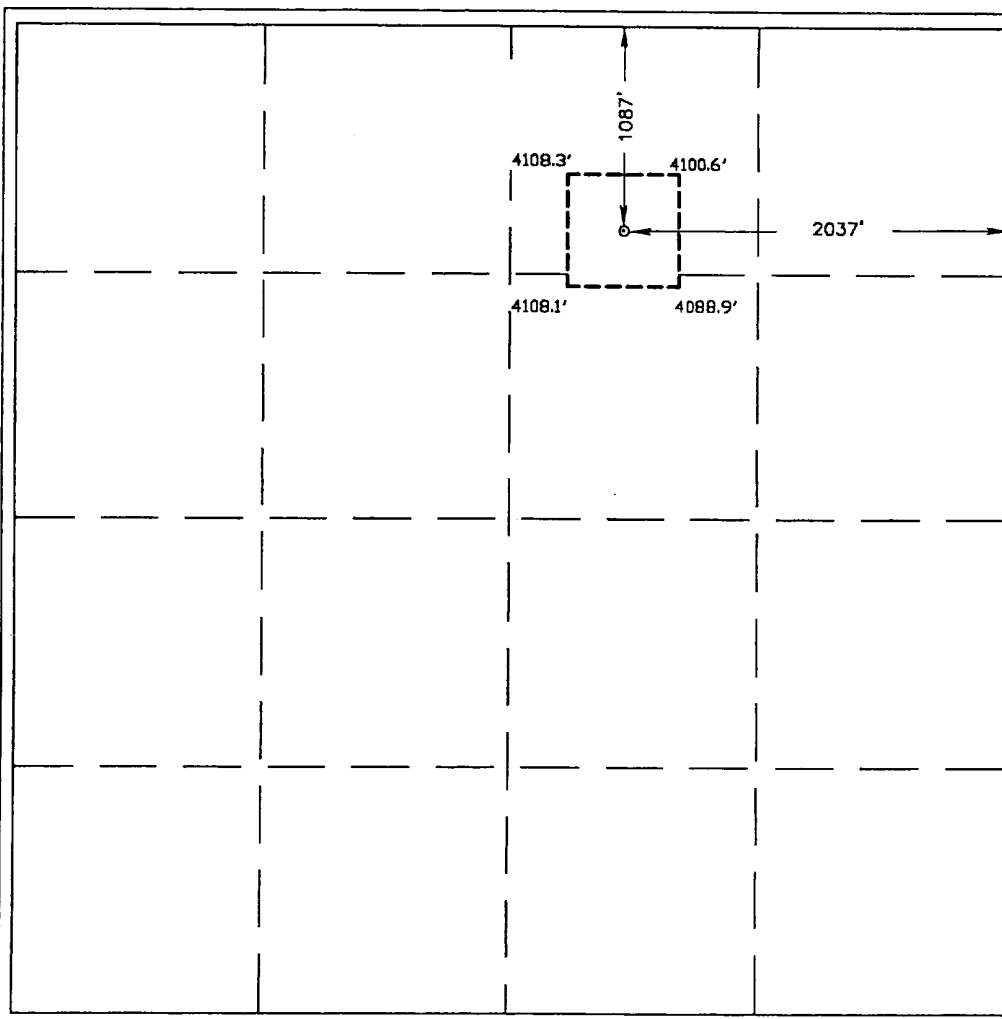
NO ALLOWABLE WILL BE ASSIGNED TO THIS COMPLETION UNTIL ALL INTERESTS HAVE BEEN CONSOLIDATED
OR A NON-STANDARD UNIT HAS BEEN APPROVED BY THE DIVISION

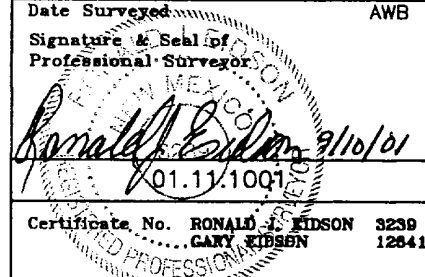
	<p>OPERATOR CERTIFICATION</p> <p>I hereby certify the the information contained herein is true and complete to the best of my knowledge and belief.</p> <p> Signature</p> <p>Jerry Fletcher Printed Name</p> <p>Engineer Tech. Title</p> <p>10/04/01 Date</p>
	<p>SURVEYOR CERTIFICATION</p> <p>I hereby certify that the well location shown on this plat was plotted from field notes of actual surveys made by me or under my supervision, and that the same is true and correct to the best of my belief.</p> <p>SEPTEMBER 6, 2001</p> <p>Date Surveyed _____ AWB</p> <p>Signature & Seal of Professional Surveyor  Certificate No. RONALD J. EDSON 3239 GARY EIDSON 12641</p>

DISTRICT I
P.O. Box 1980, Hobbs, NM 88241-1980

DISTRICT II
P.O. Drawer DD, Artesia, NM 86211-0719

DISTRICT III
1000 Rio Brazos Rd., Aztec, NM 87410

DISTRICT IV
P.O. Box 2088, Santa Fe, N.M. 87504-2088

State of New Mexico
Energy, Minerals and Natural Resources Department
OIL CONSERVATION DIVISION
P.O. Box 2088
Santa Fe, New Mexico 87504-2088

Form C-102
Revised February 10, 1994
Submit to Appropriate District Office
State Lease - 4 Copies
Fee Lease - 3 Copies

WELL LOCATION AND ACREAGE DEDICATION PLAT

☐ AMENDED REPORT

API Number	Pool Code	Pool Name
Property Code	Property Name	Well Number
UGRID No.	Operator Name	Elevation
14021	Indian Hills Unit	35
	MARATHON OIL COMPANY	4123

Surface Location

UL or lot No.	Section	Township	Range	Lot Idn	Feet from the	North/South line	Feet from the	East/West line	County
B	33	21-S	24-E		1087	NORTH	2037	EAST	EDDY

Bottom Hole Location If Different From Surface

UL or lot No.	Section	Township	Range	Lot Idn	Feet from the	North/South line	Feet from the	East/West line	County
0	28	21-S	24-E		685	SOUTH	2310	EAST	EDDY
Dedicated Acres	Joint or Infill	Consolidation Code	Order No.						
320S/2									

NO ALLOWABLE WILL BE ASSIGNED TO THIS COMPLETION UNTIL ALL INTERESTS HAVE BEEN CONSOLIDATED
OR A NON-STANDARD UNIT HAS BEEN APPROVED BY THE DIVISION

<div><p>Project Area</p><p>Producing Area</p></div>	<div><p>OPERATOR CERTIFICATION</p><p>I hereby certify the the information contained herein is true and complete to the best of my knowledge and belief.</p><p><i>Jerry Fletcher</i></p><p>Signature</p><p>Jerry Fletcher</p><p>Printed Name</p><p>Engineer Tech.</p><p>Title</p><p>10/04/01</p><p>Date</p><p>SURVEYOR CERTIFICATION</p><p>I hereby certify that the well location shown on this plat was plotted from field notes of actual surveys made by me or under my supervision, and that the same is true and correct to the best of my knowledge and belief.</p><p>Date Surveyed</p><p>Signature & Seal of Professional Surveyor</p><p>Certificate No.</p></div>
<div><p>SHL</p></div>	<div><p>OPERATOR CERTIFICATION</p><p>I hereby certify the the information contained herein is true and complete to the best of my knowledge and belief.</p><p>Signature</p><p>Printed Name</p><p>Title</p><p>Date</p><p>SURVEYOR CERTIFICATION</p><p>I hereby certify that the well location shown on this plat was plotted from field notes of actual surveys made by me or under my supervision, and that the same is true and correct to the best of my knowledge and belief.</p><p>Date Surveyed</p><p>Signature & Seal of Professional Surveyor</p><p>Certificate No.</p></div>

DISTRICT IV
P.O. BOX 2088, SANTA FE, N.M. 87504-2088

P.O. Box 2088
Santa Fe, New Mexico 87504-2088

Form C-102
Revised February 10, 1994
Submit to Appropriate District Office
State Lease - 4 Copies
Fed Lease - 3 Copies

☐ AMENDED REPORT

Surface Location

Bottom Hole Location If Different From Surface

NO ALLOWABLE WILL BE ASSIGNED TO THIS COMPLETION UNTIL ALL INTERESTS HAVE BEEN CONSOLIDATED
OR A NON-STANDARD UNIT HAS BEEN APPROVED BY THE DIVISION

<div><p>IHU # 17</p><p>2220</p><p>Indian Basin Standard internal spacing window 330' from quarter/quarter section line.</p><p>28</p><p>Terminus</p><p>Morrow Base</p><p>Morrow top</p><p>Upper Penn. Base</p><p>Upper Penn. Top</p></div>	<div><p>OPERATOR CERTIFICATION</p><p>I hereby certify the the information contained herein is true and complete to the best of my knowledge and belief.</p><p><u>Jerry Fletcher</u></p><p>Signature</p><p>Jerry Fletcher</p><p>Printed Name</p><p>Engineer Tech.</p><p>Title</p><p>10/04/01</p><p>Date</p></div>
	<div><p>SURVEYOR CERTIFICATION</p><p>I hereby certify that the well location shown on this plat was plotted from field notes of actual surveys made by me or under my supervision, and that the same is true and correct to the best of my knowledge and belief.</p><p>Date Surveyed</p><p>Signature & Seal of Professional Surveyor</p><p>Certificate No.</p></div>
<div><p>IHU # 9</p><p>990' FNL 1980' FEL</p><p>2037'</p><p>SHL</p><p>1087'</p><p>33</p></div>	<div><p>OPERATOR CERTIFICATION</p><p>I hereby certify the the information contained herein is true and complete to the best of my knowledge and belief.</p><p>Signature</p><p>Printed Name</p><p>Title</p><p>Date</p></div>
	<div><p>SURVEYOR CERTIFICATION</p><p>I hereby certify that the well location shown on this plat was plotted from field notes of actual surveys made by me or under my supervision, and that the same is true and correct to the best of my knowledge and belief.</p><p>Date Surveyed</p><p>Signature & Seal of Professional Surveyor</p><p>Certificate No.</p></div>