

DISTRICT I
P.O. Box 1980, Hobbs, NM 88241-1980

State of New Mexico
Energy, Minerals and Natural Resources Department

Form C-102
Revised February 10, 1984
Submit to Appropriate District Office
State Lease - 4 Copies
Fee Lease - 3 Copies

DISTRICT II
P.O. Drawer DD, Artesia, NM 88211-0719

DISTRICT III
1000 Rio Brazos Rd., Aztec, NM 87410

DISTRICT IV
P.O. BOX 2088, SANTA FE, N.M. 87504-2088

OIL CONSERVATION DIVISION

P.O. Box 2088
Santa Fe, New Mexico 87504-2088

☒ AMENDED REPORT

Change in unit configuration

WELL LOCATION AND ACREAGE DEDICATION PLAT

API Number 30-015-32295	Pool Code 33658	Pool Name Indian Basin (Upper Penn) Assoc.
Property Code 16875 30647	Property Name OLD RANCH KNOLL FEDERAL 8	Well Number 6
OGRID No. 6137	Operator Name DEVON ENERGY PRODUCTION COMPANY, L.P. DEVON-SFS-OPERATING, INC.	Elevation 4272

Surface Location

UL or lot No.	Section	Township	Range	Lot Idn	Feet from the	North/South line	Feet from the	East/West line	County
G	8	22 S	24 E		2120	NORTH	1600	EAST	EDDY

Bottom Hole Location If Different From Surface

UL or lot No.	Section	Township	Range	Lot Idn	Feet from the	North/South line	Feet from the	East/West line	County
H	8	22 S	24 E		1945	NORTH	714	EAST	EDDY
Dedicated Acres 320	Joint or Infill	Consolidation Code	Order No.						

NO ALLOWABLE WILL BE ASSIGNED TO THIS COMPLETION UNTIL ALL INTERESTS HAVE BEEN CONSOLIDATED
OR A NON-STANDARD UNIT HAS BEEN APPROVED BY THE DIVISION

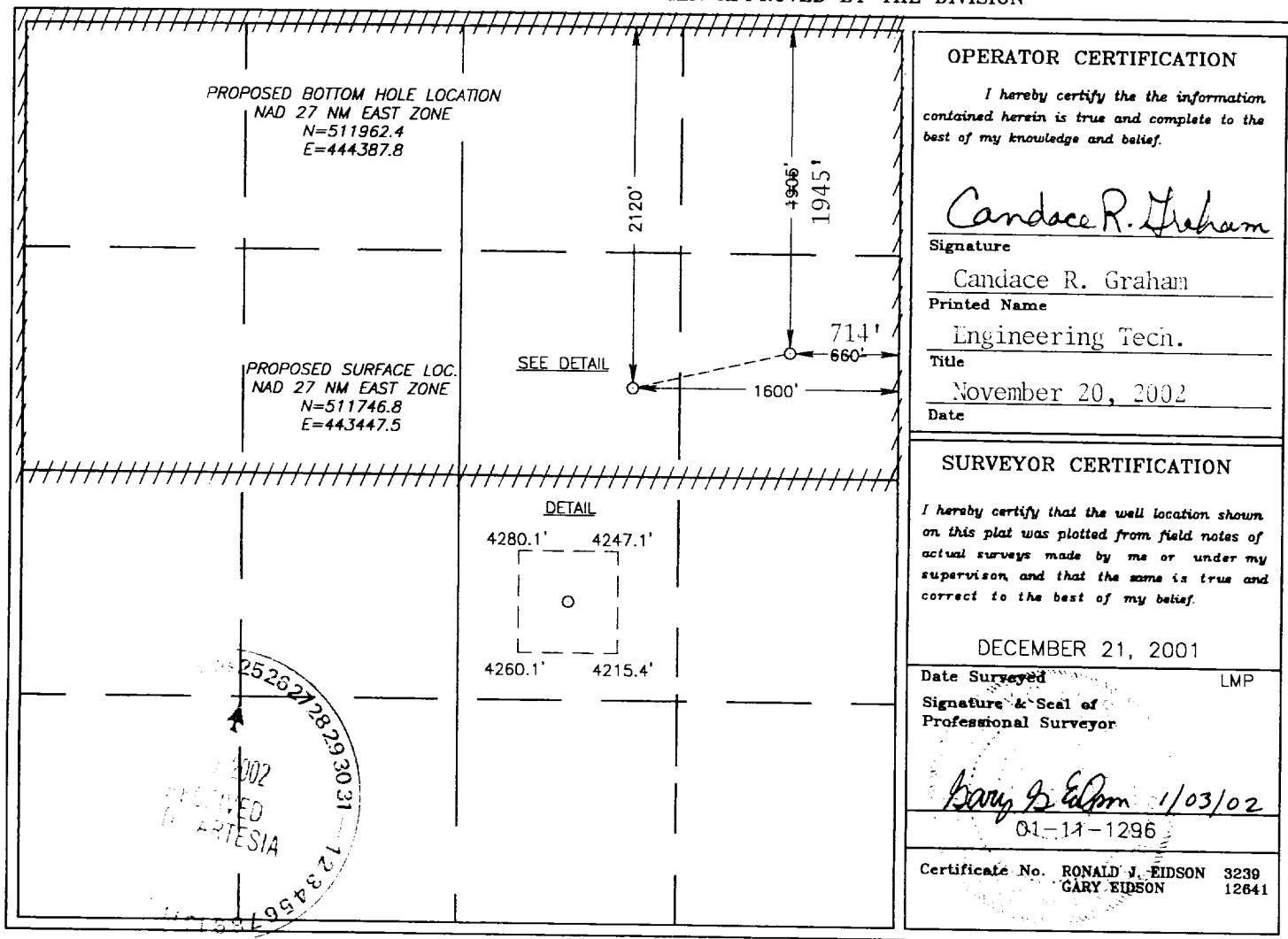

OPERATOR CERTIFICATION

I hereby certify the the information
contained herein is true and complete to the
best of my knowledge and belief.

Candace R. Graham
Signature

Candace R. Graham
Printed Name

Engineering Tech.
Title

November 20, 2002
Date

SURVEYOR CERTIFICATION

I hereby certify that the well location shown
on this plat was plotted from field notes of
actual surveys made by me or under my
supervision, and that the same is true and
correct to the best of my belief.

DECEMBER 21, 2001

Date Surveyed LMP
Signature & Seal of
Professional Surveyor

Gary J. Eidson 1/03/02
01-11-1296

Certificate No. RONALD J. EIDSON 3239
GARY EIDSON 12641