

District II
811 South First, Artesia, NM 88210
District III
1000 Rio Brazos Road, Aztec, NM 87410
District IV
2040 South Pacheco, Santa Fe, NM 87505

Energy Minerals and Natural Resources

Oil Conservation Division
2040 South Pacheco
Santa Fe, NM 87505

Revised March 17, 1999

Submit to appropriate District Office
State Lease - 6 Copies
Fee Lease - 5 Copies

☐ AMENDED REPORT

APPLICATION FOR PERMIT TO DRILL, RE-ENTER, DEEPEN, PLUGBACK, OR ADD A ZONE

Operator Name and Address POGO PRODUCING COMPANY P.O. BOX 10340 MIDLAND, TEXAS 79702-4345		OGRID Number 17891
Property Code 26401		API Number 30-015-32354
Property Name LOST TANK "35" STATE		Well No. 2

Surface Location

UL or lot no.	Section	Township	Range	Lot Idn	Feet from the	North/South line	Feet from the	East/West line	County
0	35	21S	31E		330'	SOUTH	1980'	EAST	EDDY

Proposed Bottom Hole Location If Drilled

UL or lot no.	Section	Township	Range	Lot Idn	Feet from the	County
Proposed Pool 1 LOST TANK - DELAWARE (40299)						NOTIFY OCD SPUD & TIME TO WITNESS CEMENTING OF ALL CASING STRINGS

Work Type Code N	Well Type Code O	Cable/Rotary ROTARY	Lease Type Code S	Ground Level Elevation 3536'
Multiple NO	Proposed Depth 8500'	Formation DELAWARE	Contractor KEY	Spud Date WHEN APPROVED

Proposed Casing and Cement Program

Hole Size	Casing Size	Casing weight/foot	Setting Depth	Sacks of Cement	Estimated TOC
25"	20"	NA	40'	Redi-mix	SURFACE
17½"	13 3/8"	48	800'	800 Sx.	Surface
11"	8 5/8"	32	4200'	1500 Sx.	Surface
7 7/8"	5½"	17 & 15.5	8500'	1650 Sx.	Surface

Describe the proposed program. If this application is to DEEPEN or PLUG BACK, give the data on the present productive zone and proposed new productive zone.
Describe the blowout prevention program, if any. Use additional sheets if necessary.

R- III-P

1. Drill 25" hole to 40'. Set 40' of 20" conductor pipe and cement to surface with Redi-mix.
2. Drill 17½" hole to 800'. Run and set 800' of 13 3/8" 48# H-40 ST&C casing. Cement with 800 Sx. of Class "C" cement + 2% CaCl + ½# Flocele/Sx. circulate to surface.
3. Drill 11" hole to 4200'. Run and set 4200' of 8 5/8" 32# J-55 ST&C casing. Cement with 1500 Sx. of Class "C" cement + additives, circulate cement to surface.
4. Drill 7 7/8" hole to 8500'. Run and set 8500' of 5½" casing as follows: 2500' of 5½" 17# J-55 LT&C, 5000' of 15.5# J-55 LT&C, 1000' of 5½" 17# J-55 LT&C casing. Cement in 3 stages, DV tools at 6100' & 3700'. Cement 1st stage with 650 Sx. of Class "H" + additives, 2nd stage cement with 600 Sx. of Class "C" cement + additives, 3rd stage cement with 400 Sx. of Class "C" cement + additives, circulate cement to surface.

I hereby certify that the information given above is true and complete to the best of my knowledge and belief.

Signature:

Printed name: Joe T. Janica

Title: Agent

Date: 07/02/02

Phone: 505-391-8503

OIL CONSERVATION DIVISION

Approved by:

ORIGINAL SIGNED BY TIM W. GUM
DISTRICT II SUPERVISOR

Title:

Approval Date:

Conditions of Approval:

Amended ☐

08 2002

08 2003

DISTRICT I
P.O. Box 1980, Hobbs, NM 88241-1980

DISTRICT II
P.O. Drawer DD, Artesia, NM 88211-0719

DISTRICT III
1000 Rio Brazos Rd., Aztec, NM 87410

DISTRICT IV
P.O. BOX 2088, SANTA FE, N.M. 87504-2088

State of New Mexico
Energy, Minerals and Natural Resources Department

Form C-102
Revised February 10, 1994
Submit to Appropriate District Office
State Lease - 4 Copies
Fee Lease - 3 Copies

OIL CONSERVATION DIVISION
P.O. Box 2088
Santa Fe, New Mexico 87504-2088

☐ AMENDED REPORT

WELL LOCATION AND ACREAGE DEDICATION PLAT

API Number	Pool Code 40299	Pool Name LOST TANK -DELAWARE
Property Code 26401	Property Name LOST TANK 35 STATE	Well Number 2
OGRID No. 17891	Operator Name POGO PRODUCING COMPANY	Elevation 3536

Surface Location

UL or lot No.	Section	Township	Range	Lot Idn	Feet from the	North/South line	Feet from the	East/West line	County
0	35	21 S	31 E		330	SOUTH	1980	EAST	EDDY

Bottom Hole Location If Different From Surface

UL or lot No.	Section	Township	Range	Lot Idn	Feet from the	North/South line	Feet from the	East/West line	County
Dedicated Acres 40	Joint or Infill	Consolidation Code	Order No.						

NO ALLOWABLE WILL BE ASSIGNED TO THIS COMPLETION UNTIL ALL INTERESTS HAVE BEEN CONSOLIDATED
OR A NON-STANDARD UNIT HAS BEEN APPROVED BY THE DIVISION

	OPERATOR CERTIFICATION <i>I hereby certify the the information contained herein is true and complete to the best of my knowledge and belief.</i> Signature Joe T. Janica Printed Name Agent Title 07/02/02 Date
	SURVEYOR CERTIFICATION <i>I hereby certify that the well location shown on this plat was plotted from field notes of actual surveys made by me or under my supervision, and that the same is true and correct to the best of my belief.</i> MARCH 21, 1997 Date Surveyed Signature & Seal of Professional Surveyor 3-24-97 Certificate No. JOHN W. WEST 676 RONALD J. EIDSON 3239 PROFES. EIDSON 12641
	DMCC

VICINITY MA.

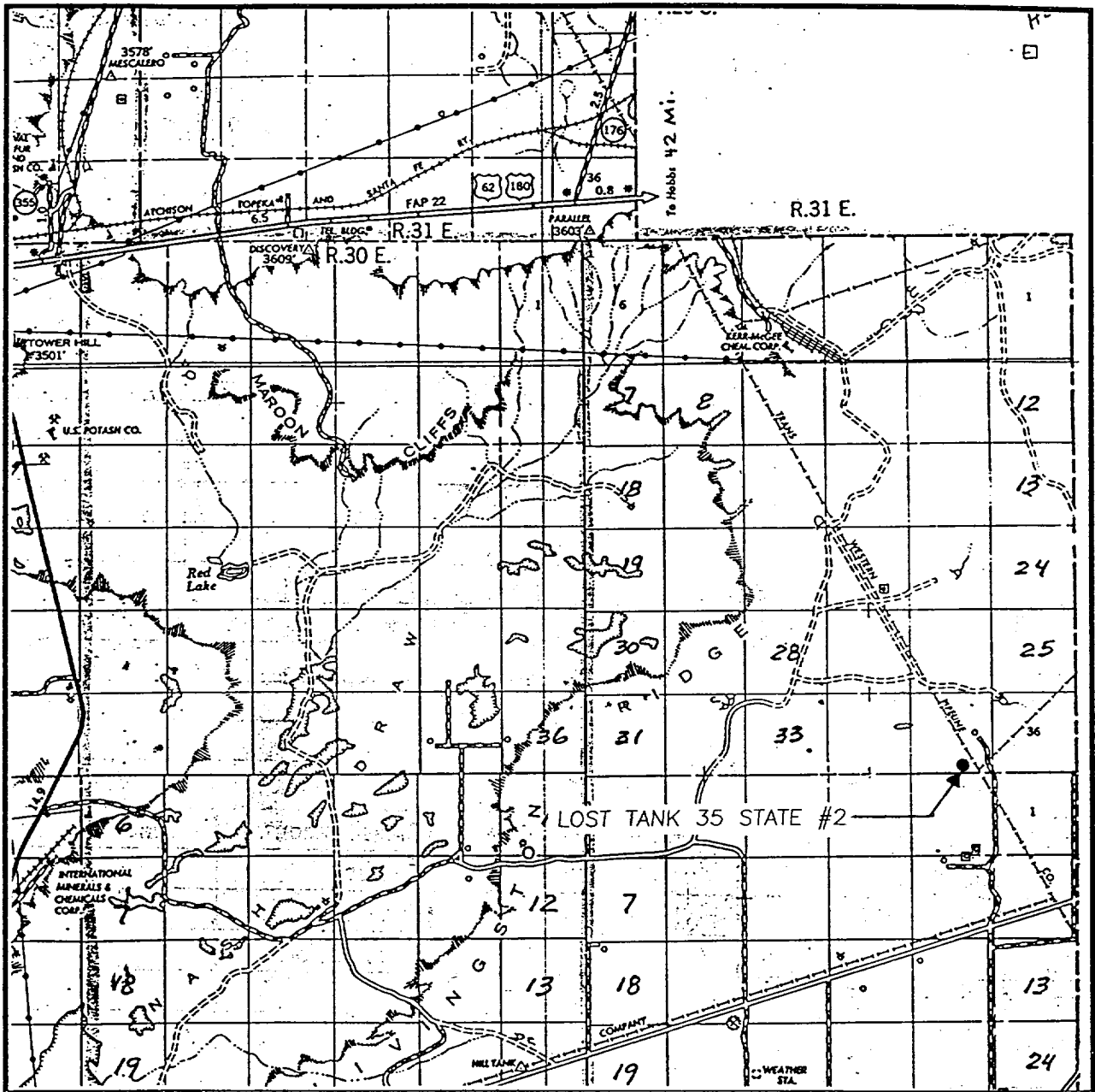

SCALE: 1" = 2 MILES

SEC. 35 TWP. 21-S RGE. 31-E

SURVEY N.M.P.M.

COUNTY EDDY

DESCRIPTION 330' FSL & 1980' FEL

ELEVATION 3536

OPERATOR POGO PRODUCING COMPANY

LEASE LOST TANK 35 STATE

JOHN WEST ENGINEERING
HOBBS, NEW MEXICO
(505) 393-3117

NORTH



CONTOUR INTERVAL:
LIVINGSTON RIDGE - 10'
THE DIVIDE - 10'

LIVINGSTON RIDGE, THE DIVIDE, N.M.

**JOHN WEST ENGINEERING
HOBBS, NEW MEXICO
(505) 393-3117**

BLOWOUT PREVENTER SYSTEM

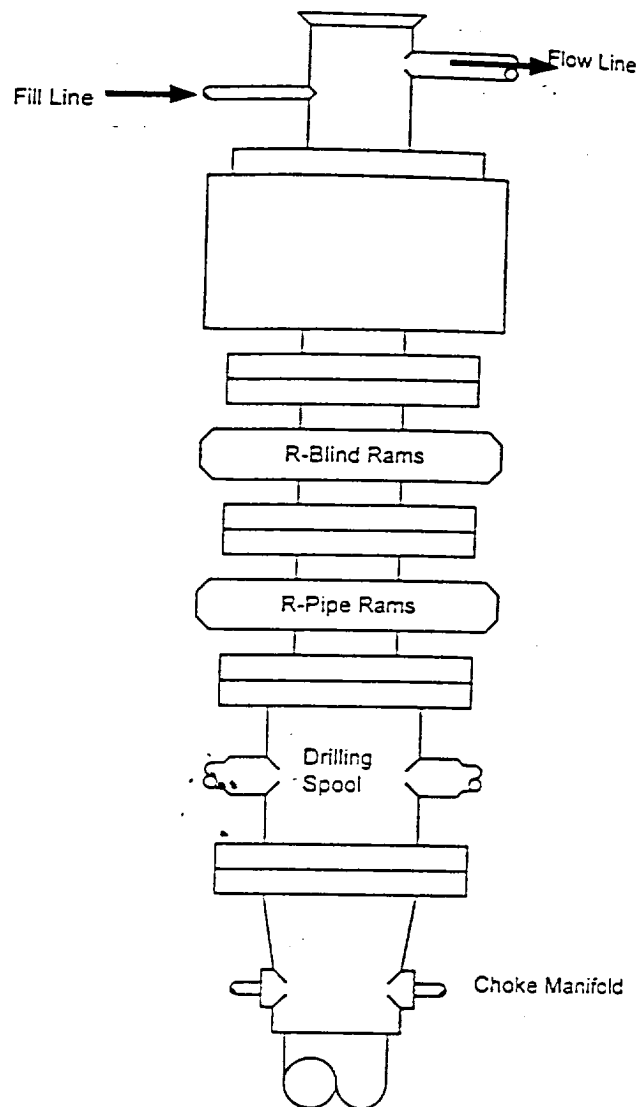

Type 900 Series
3000 psi WP.

Choke Manifold Assembly for 3M WP System

