

N. M. O. C. C. COPY

Land Office Las Cruces

Lease No. 046034 B

Unit Las Cruces "D"

SEP 5 1961

O. C. C. OFFICE

30-815-00003

Form 9-331a
(Feb. 1951)

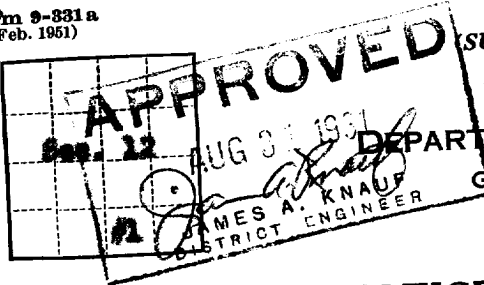

SUBMIT IN TRIPLICATE

UNITED STATES
DEPARTMENT OF THE INTERIOR
GEOLOGICAL SURVEY

SUNDRY NOTICES AND REPORTS ON WELLS

NOTICE OF INTENTION TO DRILL	<input checked="" type="checkbox"/>	SUBSEQUENT REPORT OF WATER SHUT-OFF	
NOTICE OF INTENTION TO CHANGE PLANS		SUBSEQUENT REPORT OF SHOOTING OR ACIDIZING	
NOTICE OF INTENTION TO TEST WATER SHUT-OFF		SUBSEQUENT REPORT OF ALTERING CASING	
NOTICE OF INTENTION TO RE-DRILL OR REPAIR WELL		SUBSEQUENT REPORT OF RE-DRILLING OR REPAIR	
NOTICE OF INTENTION TO SHOOT OR ACIDIZE		SUBSEQUENT REPORT OF ABANDONMENT	
NOTICE OF INTENTION TO PULL OR ALTER CASING		SUPPLEMENTARY WELL HISTORY	
NOTICE OF INTENTION TO ABANDON WELL			

(INDICATE ABOVE BY CHECK MARK NATURE OF REPORT, NOTICE, OR OTHER DATA)

Hobbs, New Mexico - August 25, 19 61

Las Cruces "D"
Well No. 1 is located 1650 ft. from S line and 660 ft. from E line of sec. 12

NR/4 SE/4 Sec. 12
(1/4 Sec. and Sec. No.)

21-S
(Twp.)

21-E
(Range)

N.M.P.M.
(Meridian)

Wildcat
(Field)

Blair
(County or Subdivision)

New Mexico
(State or Territory)

The elevation of the derrick floor above sea level is _____ ft.

DETAILS OF WORK

(State names of and expected depths to objective sands; show sizes, weights, and lengths of proposed casings; indicate mudding jobs, cementing points, and all other important proposed work)

Propose to drill with Rotary Tools from surface to total depth of approx. 4750' in the Abo Formation. We plan to drill to the Penn Formation at a TD of approx. 6250' if the Abo Formation is non productive. Casing program to be approx. as follows:

Size Hole	Size Casing	Approx. Casing Point	Bags Cement
12-1/4"	13-3/8"	60'	75
12-1/4"	9-5/8"	1600'	400
9-1/4"	5-1/2"	4750'	250

The pump & plug process will be used in cementing all strings of casing. Cement will be circulated to surface behind 13-3/8" OD casing. The well will be drilled with air from 60' to 1600' and with mud from 1600' to total depth. If we encounter severe loss of circulation between 1600' and total depth we will then run 7" OD casing from 1600' to total depth instead of the 5-1/2" OD casing. The well will be treated with approx. 3000 gals. of 15% Reg. Acid and 500 gals. Mud Acid.

I understand that this plan of work must receive approval in writing by the Geological Survey before operations may be commenced.

Company Skelly Oil Company

Address P. O. Box 38

Hobbs, New Mexico

By J. E. Cab

Title Dist. Engt.

NEW MEXICO OIL CONSERVATION COMMISSION
WELL LOCATION AND ACREAGE DEDICATION PLAT

RECEIVED
Revised 8/1/57

SEP 5 1961

SEE INSTRUCTIONS FOR COMPLETING THIS FORM ON THE REVERSE SIDE

SECTION A

Operator Skelly Oil Company		Lease Las Cruces "D"		ARTESIA, OFFICE	
Unit Letter I	Section 12	Township 24 South	Range 21 East	County Eddy	
Actual Footage Location of Well: 1650 feet from the South line and 660 feet from the East line					
Ground Level Elev.	Producing Formation Undetermined		Pool Exploratory	Dedicated Acreage: 40 Acres	

1. Is the Operator the only owner in the dedicated acreage outlined on the plat below? YES _____ NO _____. ("Owner" means the person who has the right to drill into and to produce from any pool and to appropriate the production either for himself or for himself and another. (65-3-29 (e) NMSA 1935 Comp.)
2. If the answer to question one is "no," have the interests of all the owners been consolidated by communitization agreement or otherwise? YES _____ NO _____. If answer is "yes," Type of Consolidation _____
3. If the answer to question two is "no," list all the owners and their respective interests below:

Owner	Land Description

RECEIVED
AUG 29 1961
U. S. GEOLOGICAL SURVEY
ARTESIA, NEW MEXICO
CERTIFICATION

SECTION B

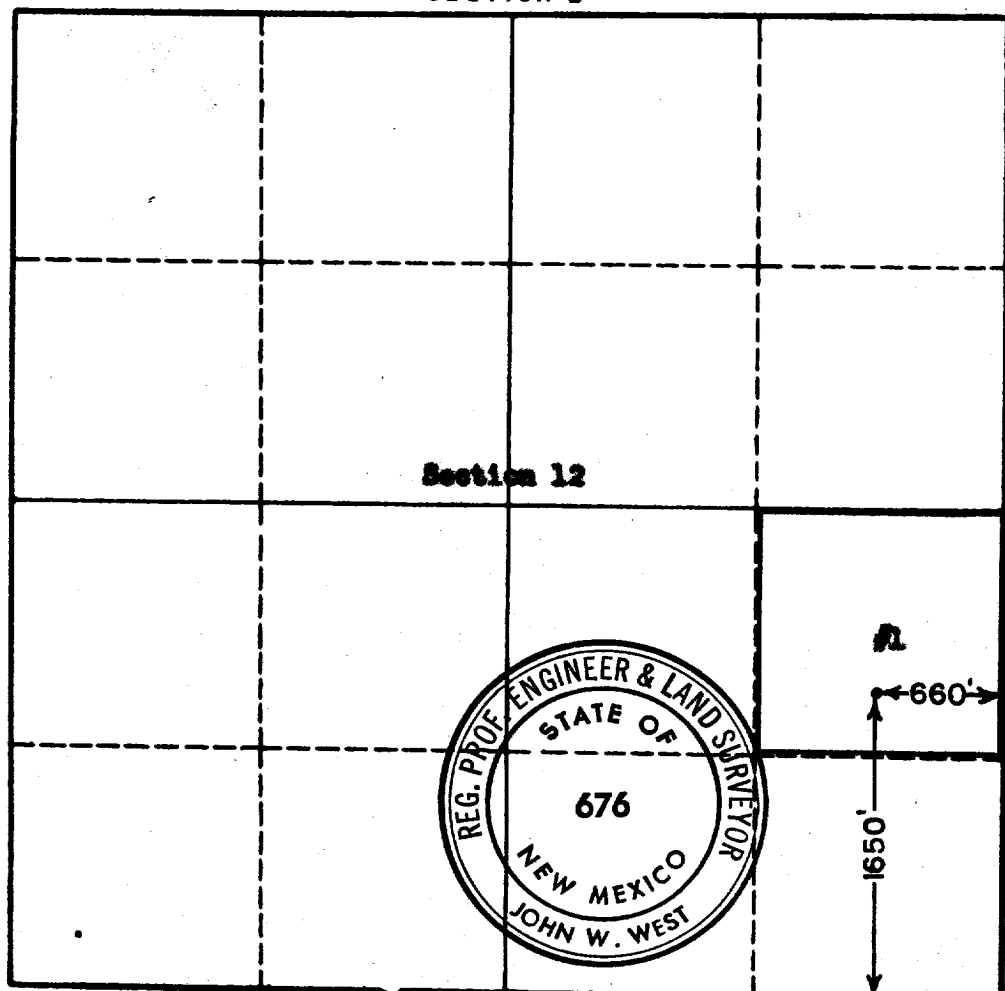

I hereby certify that the information in SECTION A above is true and complete to the best of my knowledge and belief.

Name	J. E. Galt
Position	Dist. Supt.
Company	Skelly Oil Company
Date	August 25, 1961

I hereby certify that the well location shown on the plat in SECTION B was plotted from field notes of actual surveys made by me or under my supervision, and that the same is true and correct to the best of my knowledge and belief.

Date Surveyed	Aug. 26, 1961
Registered Professional Engineer and/or Land Surveyor, JOHN W. WEST	
John W. West	
Certificate No.	N. M. - P. E. & L. S. NO. 676

0 330 660 990 1320 1650 1980 2310 2640 2000 1500 1000 500 0