

NUMBER OF COPIES RECEIVED	
DISTRIBUTION	
SANTA FE	1
FILE	1
U.S.G.S.	2
LAND OFFICE	
TRANSPORTER	
OIL	
GAS	
PRODUCTION OFFICE	
OPERATOR	1

NEW MEXICO OIL CONSERVATION COMMISSION
Santa Fe, New Mexico

Form C-101
Revised (12/1/55)

NOTICE OF INTENTION TO DRILL

Notice must be given to the District Office of the Oil Conservation Commission and approval obtained before drilling or recompletion begins. If changes in the proposed plan are considered advisable, a copy of this notice showing such changes will be returned to the sender. Submit this notice in **QUINTUPLICATE**. One copy will be returned following approval. See additional instructions in Rules and Regulations of the Commission. **If State Land submit 6 Copies Attach Form C-128 in triplicate to first 3 copies of form C-101**

Artesia, New Mexico.

December 12, 1961.

(Place)

RECEIVED

DEC 15 1961

OIL CONSERVATION COMMISSION
SANTA FE, NEW MEXICO

Gentlemen:

You are hereby notified that it is our intention to commence the **Drilling** of a well to be known as

Martin Yates, III

(Company or Operator)

O. C. C.

ARTESIA OFFICE

Belle McCord

(Lease)

Well No. **2-2**, in **F** (Unit) The well is

located **2304** feet from the **North** line and **1656** feet from the **West** line of Section **22**, T. **23 S**, R. **26 E**, NMPM.

(GIVE LOCATION FROM SECTION LINE) **Undesignated** *Artesia* County

If State Land the Oil and Gas Lease is No. _____

If patented land the owner is **Belle McCord**

Address **Carlsbad, New Mexico**

We propose to drill well with drilling equipment as follows: **Cable Tools**

The status of plugging bond is **Blanket Bond**

Drilling Contractor **Harvey E. Yates**

Artesia, New Mexico

We intend to complete this well in the **Delaware**

formation at an approximate depth of **1900** feet.

CASING PROGRAM

We propose to use the following strings of Casing and to cement them as indicated:

Size of Hole	Size of Casing	Weight per Foot	New or Second Hand	Depth	Sacks Cement
	8 5/8"		New	525'	100
	5 1/2"		New	1900'	50

If changes in the above plans become advisable we will notify you immediately.

ADDITIONAL INFORMATION (If recompletion give full details of proposed plan of work.)

If commercial production is indicated, production string of 5 1/2" casing will be run.

DEC 15 1961

Approved _____, 19_____
Except as follows:

Sincerely yours,

Martin Yates, III
(Company or Operator)

By *Nolan Carder*

Position **Bookkeeper**
Send Communications regarding well to

Name **Martin Yates, III**

Address **323 Carper Bldg., Artesia, N.**

OIL CONSERVATION COMMISSION

By *M. L. Armstrong*

NUMBER OF COPIES RECEIVED	
DISTRIBUTION	
SANTA FE	
FILE	
U.S.G.S.	
LAND OFFICE	
TRANSPORTER	OIL GAS
PRORATION OFFICE	
OPERATOR	

NEW MEXICO OIL CONSERVATION COMMISSION
WELL LOCATION AND ACREAGE DEDICATION PLAT
 SEE INSTRUCTIONS FOR COMPLETING THIS FORM ON THE REVERSE SIDE

FORM C-128
 Revised 5/1/57

SECTION A

Operator Martin Yates III		Lease Belle McCorn		Well No. 2-X	
Unit Letter MPM	Section 22	Township 23 S	Range 26 E	County Eddy	
Actual Footage Location of Well: 2304 feet from the N line and 1656 feet from the W line					
Ground Level Elev.	Producing Formation Delaware		Pool Dark Canyon	Dedicated Acreage: 40 Acres	

1. Is the Operator the only owner in the dedicated acreage outlined on the plat below? YES ☒ NO ____ . ("Owner" means the person who has the right to drill into and to produce from any pool and to appropriate the production either for himself or for himself and another. (65-3-29 (e) NMSA 1935 Comp.)
2. If the answer to question one is "no," have the interests of all the owners been consolidated by communitization agreement or otherwise? YES ____ NO ____ . If answer is "yes," Type of Consolidation ____
3. If the answer to question two is "no," list all the owners and their respective interests below:

Owner	Land Description

SECTION B

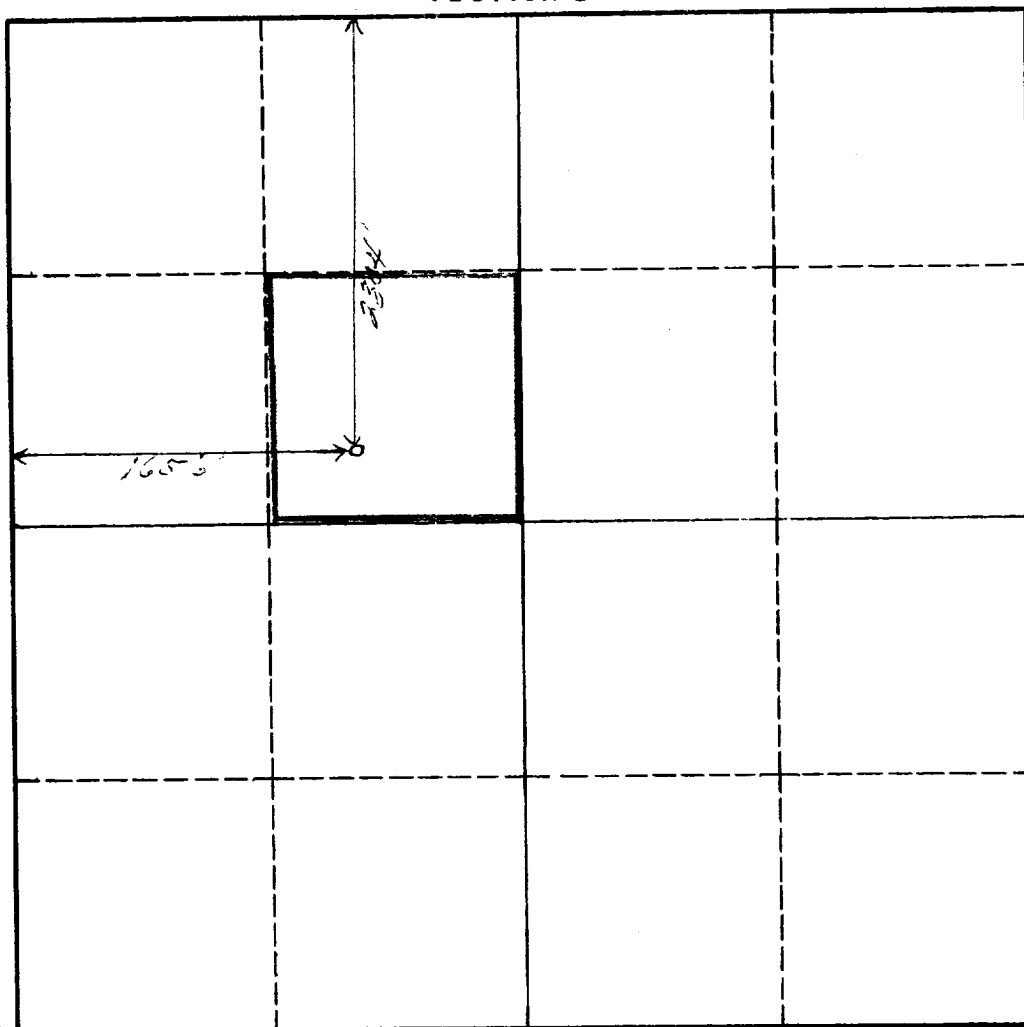

CERTIFICATION

I hereby certify that the information in SECTION A above is true and complete to the best of my knowledge and belief.

Name	Nola Bander
Position	Bookkeeper
Company	Martin Yates, III
Date	12-13-61

I hereby certify that the well location shown on the plat in SECTION B was plotted from field notes of actual surveys made by me or under my supervision, and that the same is true and correct to the best of my knowledge and belief.

Date Surveyed	12/13/61
Registered Professional Engineer and/or Land Surveyor	

H. C. Yates
 Certificate No. **772**