

NEW MEXICO OIL CONSERVATION COMMISSION
Well Location and Acreage Dedication Plat

Date March 24, 1959

Section A.

Operator HUMBLE OIL & REFG. CO Lease Bandana Point Unit
Well No. 1 Unit Letter "O" Section 13 Township 23S Range 23E NMPM
located 750 Feet From South Line, 1900 Feet From East Line
County Eddy G. L. Elevation _____ Dedicated Acreage 40 Acres
Name of Producing Formation Ellenburger Pool Wildcat

1. Is the Operator the only owner* in the dedicated acreage outlined on the plat below?
Yes _____ No ✓.
2. If the answer to question one is "no," have the interests of all the owners been consolidated by communitization agreement or otherwise? Yes ✓ No _____. If answer is "yes," Type of Consolidation Unitization
3. If the answer to question two is "no," list all the owners and their respective interests below:

Owner

Land Description

RECEIVED
MAR 30 1959
U. S. GEOLOGICAL SURVEY
ARTESIA, NEW MEXICO

Section B

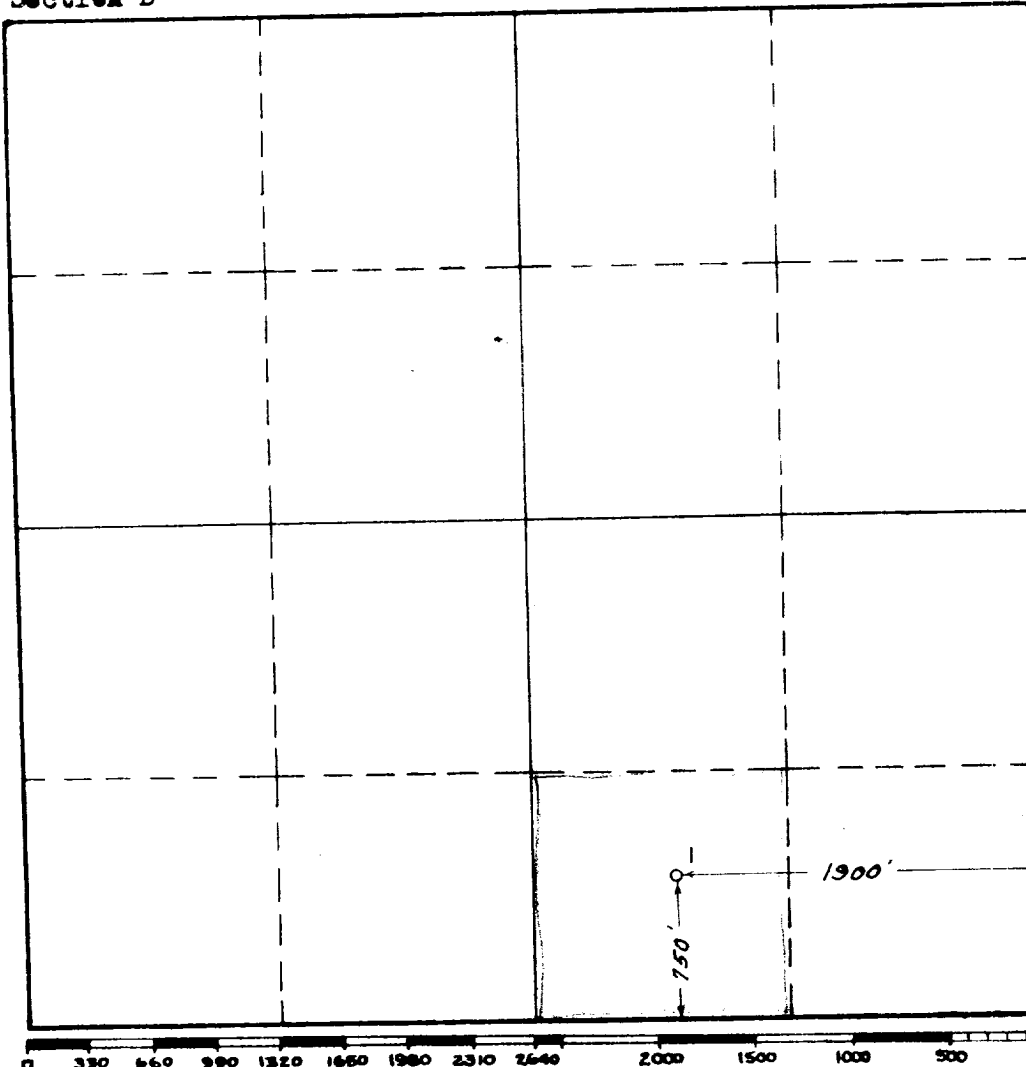

This is to certify that the information in Section A above is true and complete to the best of my knowledge and belief.

HUMBLE OIL & REFG. CO
(Operator)
Henry H. Hesterfeld
(Representative)
Assistant Division Supt.
Box 1600 Midland, Texas
Address

This is to certify that the well location shown on the plat in Section B was plotted from field notes of actual surveys made by me or under my supervision and that the same is true and correct to the best of my knowledge and belief.

Date Surveyed 4-23-59

W. S. Hesterfeld
Registered Professional
Engineer and/or Land Surveyor.

Certificate No. 1382