

OIL CONSERVATION DIVISION

P.O. Box 2088
Santa Fe, New Mexico 87504-2088

DISTRICT I

P.O. Box 1980, Hobbs, NM 88240

DISTRICT II

P.O. Drawer DD, Artesia, NM 88210

DISTRICT III

1000 Rio Brazos Rd., Aztec, NM 87410

WELL LOCATION AND ACREAGE DEDICATION PLAT

All Distances must be from the outer boundaries of the section

Operator HARVEY E. YATES CO.			Lease LOVING "2" STATE		Well No. 1
Unit Letter B	Section 2	Township 23 SOUTH	Range 28 EAST	NMPM	County EDDY
Actual Footage Location of Well: 660 feet from the NORTH line and 1650 feet from the EAST line					
Ground Level Elev. 3069.0'	Producing Formation Bone Spring	Pool Herradura Bend East		Dedicated Acreage: 40 Acres	

1. Outline the acreage dedicated to the subject well by colored pencil or hachure marks on the plat below.
2. If more than one lease is dedicated to the well, outline each and identify the ownership thereof (both as to working interest and royalty).
3. If more than one lease of different ownership is dedicated to the well, have the interest of all owners been consolidated by communitization, unitization, force-pooling, etc.?

☐ Yes ☐ No If answer is "yes" type of consolidation _____

If answer is "no" list of owners and tract descriptions which have actually been consolidated. (Use reverse side of this form necessary.)

No allowable will be assigned to the well unit all interests have been consolidated (by communitization, unitization, forced-pooling, otherwise) or until a non-standard unit, eliminating such interest, has been approved by the Division.

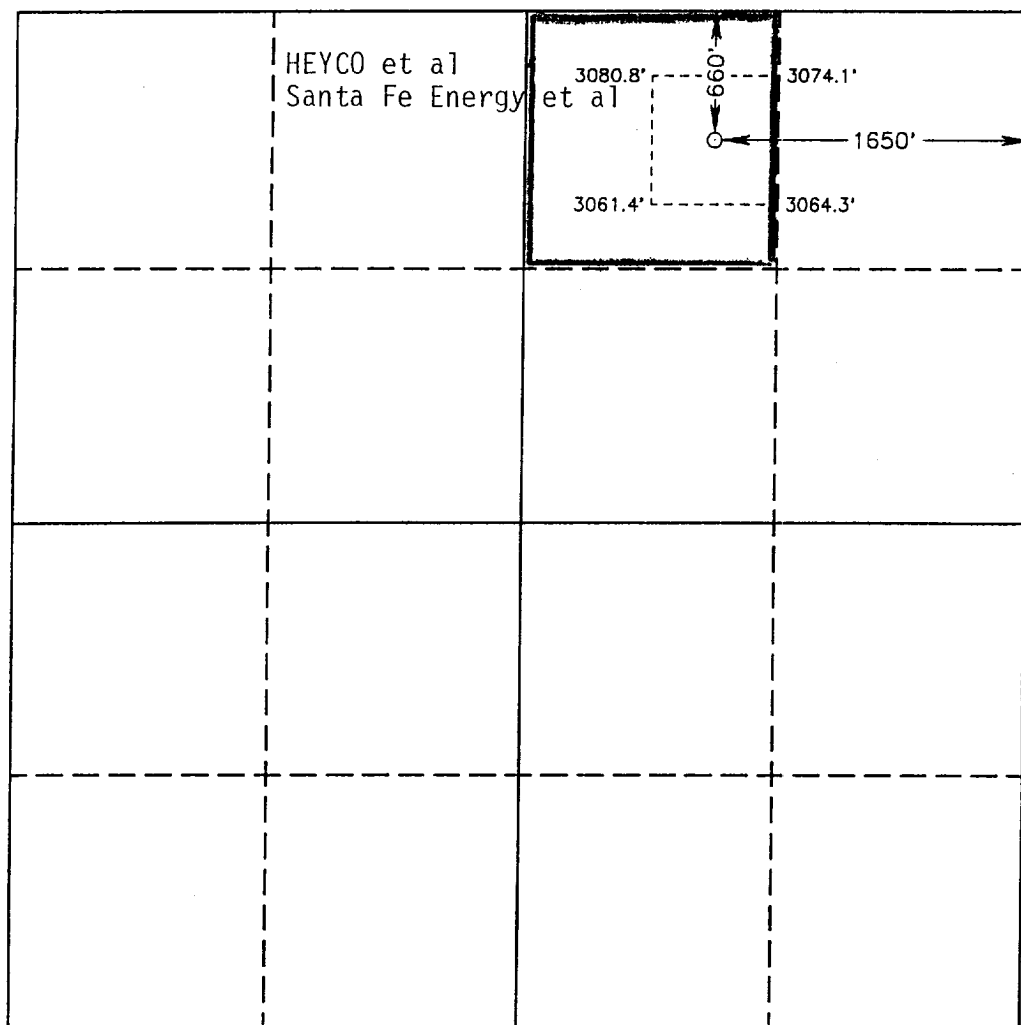

OPERATOR CERTIFICATION

I hereby certify the the information contained herein is true and complete to the best of my knowledge and belief.

Signature

Vickie Teel

Printed Name

Vickie Teel

Position

Drilg/Prod Analyst

Company

Harvey E. Yates Company

Date

1/15/93

SURVEYOR CERTIFICATION

I hereby certify that the well location shown on this plat was plotted from field notes of actual surveys made by me or under my supervision, and that the same is true and correct to the best of my knowledge and belief.

Date Surveyed

DECEMBER 29, 1992

Signature & Seal of Professional Surveyor

Gary L. Jones
Certificate No. JOHN W. WEST, 1876
RONALD J. EIDSON, 3239
GARY L. JONES, 7977
92-11-2031

0 330 660 990 1320 1650 1980 2310 2640 2000 1500 1000 500 0

Harvey E. Yates Company
Loving 2 State #1
Sec. 2, T23S, R28E
660' FNL & 1650' FEL
Eddy Co., New Mexico

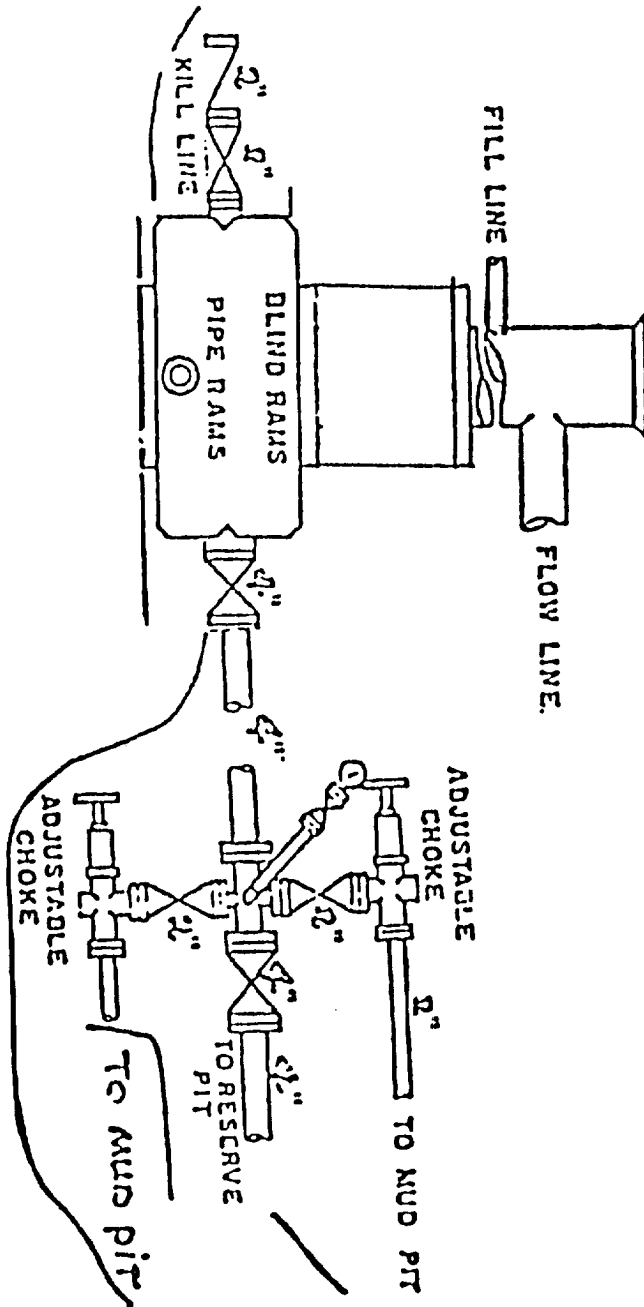

900 Series