

(SUBMIT IN TRIPLICATE)

UNITED STATES
DEPARTMENT OF THE INTERIOR
GEOLOGICAL SURVEY

Land Office Santa Fe
Lease No. N.M. 087
Unit _____

SUNDRY NOTICES AND REPORTS ON WELLS

NOTICE OF INTENTION TO DRILL	<input checked="" type="checkbox"/>	SUBSEQUENT REPORT OF WATER SHUT-OFF	
NOTICE OF INTENTION TO CHANGE PLANS		SUBSEQUENT REPORT OF SHOOTING OR ACIDIZING	
NOTICE OF INTENTION TO TEST WATER SHUT-OFF		SUBSEQUENT REPORT OF ALTERING CASING	
NOTICE OF INTENTION TO RE-DRILL OR REPAIR WELL		SUBSEQUENT REPORT OF RE-DRILLING OR REPAIR	
NOTICE OF INTENTION TO SHOOT OR ACIDIZE		SUBSEQUENT REPORT OF ABANDONMENT	
NOTICE OF INTENTION TO PULL OR ALTER CASING		SUPPLEMENTARY WELL HISTORY	
NOTICE OF INTENTION TO ABANDON WELL			

(INDICATE ABOVE BY CHECK MARK NATURE OF REPORT, NOTICE, OR OTHER DATA)

May 1, 1959

Well No. 1 is located 1980 ft. from N line and 660 ft. from W line of sec. 27
SW 1/4 NW 1/4, Sec. 27, T. 24 S., R. 28 E.
(1/4 Sec. and Sec. No.) (Twp.) (Range) (Meridian)
Wildcat Eddy New Mexico
(Field) (County or Subdivision) (State or Territory)

The elevation of the derrick floor above sea level is 3006 ft.

DETAILS OF WORK

(State names of and expected depths to objective sands; show sizes, weights, and lengths of proposed casings; indicate mudlogging jobs, cementing points, and all other important proposed work)

We propose to drill a rotary test to an approximate depth of 2800 feet in order to test the Delaware Sand.

Casing Program (approved by State Engineers Office):
7", 20#, new casing to 150' w/75 sx.
4 1/2", 9 1/2#, new casing from surface to T.D. w/100 sx.

APPROVAL IS SUBJECT TO STATE
ENGINEERS OFFICE APPROVAL
OIL FIELD DIVISION, U.S. GEOLOGICAL SURVEY
DEPARTMENT OF THE INTERIOR
BOX 610, ROSWELL, NEW MEXICO

I understand that this plan of work must receive approval in writing by the Geological Survey before operations may be commenced.

Company Ernest A. Hanson & S. D. Denison

Address P. O. Box 852

Roswell, New Mexico

By Harry J. Hansen

Title Geologist, E. A. Hanson

NEW MEXICO OIL CONSERVATION COMMISSION
Well Location and Acreage Dedication Plat

Form C-128
Revised 5/1/57

Section A.

Date May 2, 1959

Operator Ernest A. Hanson & S.D. Denison Lease Todhunter Federal
Well No. 1 Unit Letter E Section 27 Township 24 South Range 28 East NMPM
Located 1980 Feet From North Line, 660 Feet From West Line
County Eddy G. L. Elevation 2995 Dedicated Acreage 40 Acres
Name of Producing Formation Delaware Sand Pool Wilocal

1. Is the Operator the only owner* in the dedicated acreage outlined on the plat below?
Yes X No .
2. If the answer to question one is "no," have the interests of all the owners been consolidated by communitization agreement or otherwise? Yes No . If answer is "yes," Type of Consolidation
3. If the answer to question two is "no," list all the owners and their respective interests below:

Owner

Land Description

RECEIVED

MAY 4 1959

U. S. GEOLOGICAL SURVEY
ROSWELL, NEW MEXICO

Section B

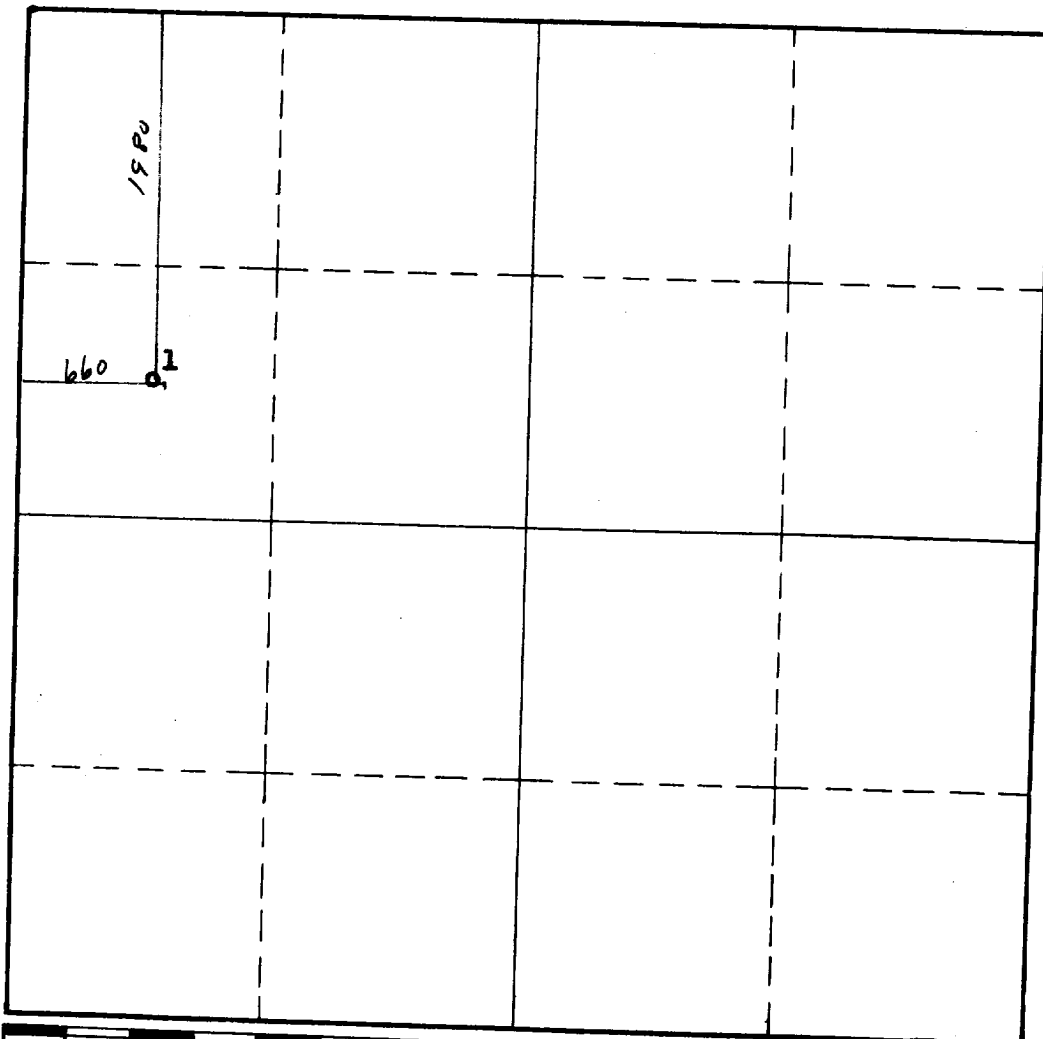

This is to certify that the information in Section A above is true and complete to the best of my knowledge and belief.

Ernest A. Hanson & S. D. Denison
(Operator)

Harry F. Schram
(Representative)

P.O. Box 852, Roswell, New Mex.
Address

This is to certify that the well location shown on the plat in Section B was plotted from field notes of actual surveys made by me or under my supervision and that the same is true and correct to the best of my knowledge and belief.

Date Surveyed 5/2/59

John A. Mathis Jr.
Registered Professional
Engineer and/or Land Surveyor.

Certificate No. 1502

(See instructions for completing this form on the reverse side)

INSTRUCTIONS FOR COMPLET :

1. Operator shall furnish and certify to the information called for in Section A.
2. Operator shall outline the dedicated acreage for both oil and gas wells on the plat in Section B.
3. A registered professional engineer or land surveyor registered in the State of New Mexico or approved by the Commission shall show on the plat the location of the well and certify this information in the space provided.
4. All distances shown on the plat must be from the outer boundaries of Section.
5. If additional space is needed for listing owners and their respective interests as required in question 3, Section A, please use space below

* "Owner" means the person who has the right to drill into and to produce from any pool and to appropriate the production either for himself or for himself and another. (65-3-29 (e) NMSA 1953 Comp.)