

NEW MEXICO OIL CONSERVATION COMMISSION
WELL LOCATION AND ACREAGE DEDICATION PLAT

JAN 16 1973

Form C-102
Supersedes
Effective 1-

All distances must be from the outer boundaries of the Section.

Operator Shell Oil Company			Lease James Ranch Unit		O. C. C. ARTESIA, OFFICE No. 1	
Unit Letter 0	Section 36	Township 22S	Range 30E	County Eddy		
Actual Footage Location of Well: 660 feet from the South line and 2009 feet from the East line						
Ground Level Elev: 3326 DF	Producing Formation Los Madanos Atoka		Pool Atoka		Dedicated Acreage: 160 Acres	

1. Outline the acreage dedicated to the subject well by colored pencil or hatchure marks on the plat below.
2. If more than one lease is dedicated to the well, outline each and identify the ownership thereof (both as to working interest and royalty).
3. If more than one lease of different ownership is dedicated to the well, have the interests of all owners been consolidated by communitization, unitization, force-pooling, etc?

☐ Yes ☐ No If answer is "yes," type of consolidation _____

If answer is "no," list the owners and tract descriptions which have actually been consolidated. (Use reverse side of this form if necessary.) _____

No allowable will be assigned to the well until all interests have been consolidated (by communitization, unitization, forced-pooling, or otherwise) or until a non-standard unit, eliminating such interests, has been approved by the Commission.

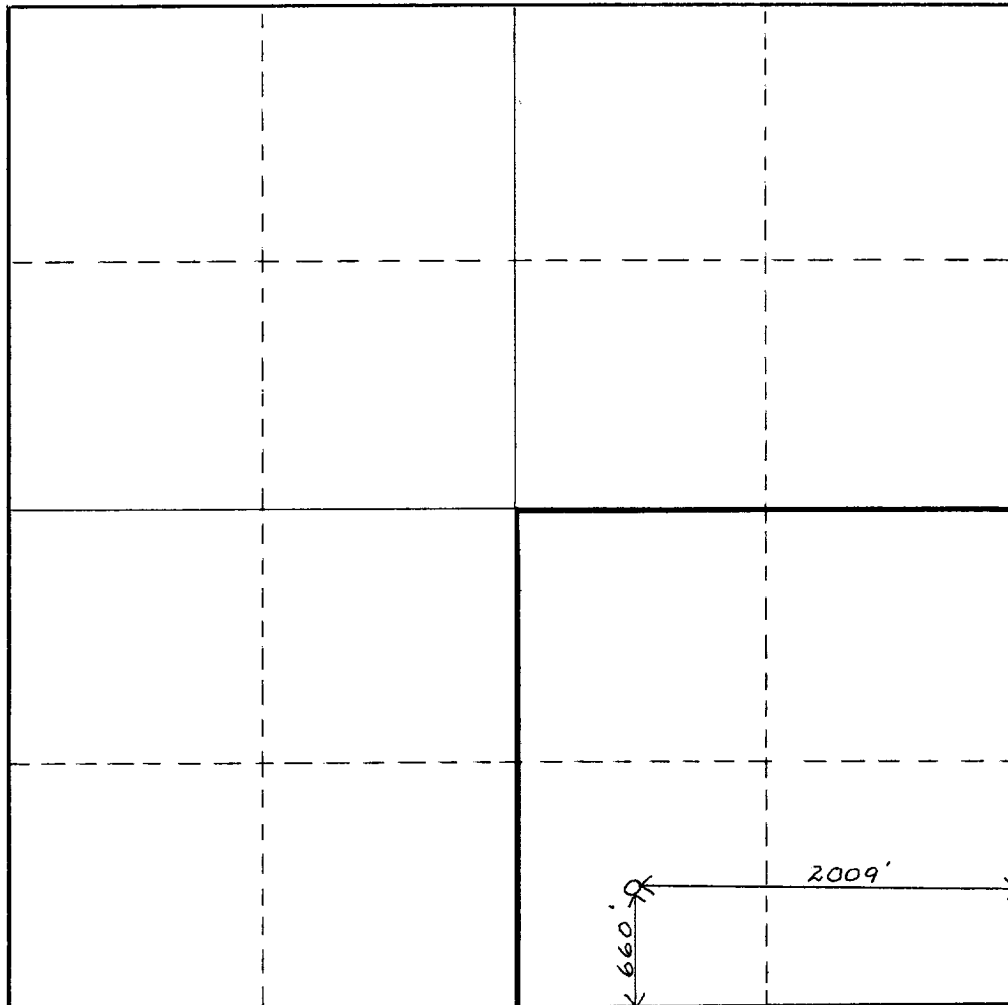

CERTIFICATION

I hereby certify that the information contained herein is true and complete to the best of my knowledge and belief.

A. E. Cordray
Name

A. E. Cordray
Position

Staff Engineer
Company

Shell Oil Company
Date

1-15-73

I hereby certify that the well location shown on this plat was plotted from field notes of actual surveys made by me or under my supervision, and that the same is true and correct to the best of my knowledge and belief.

Date Surveyed

Registered Professional Engineer
and/or Land Surveyor

Certificate No.

