

NEW MEXICO OIL CONSERVATION COMMISSION
WELL LOCATION AND ACREAGE DEDICATION PLAT

FORM C-128
 Revised 5/1/57

SEE INSTRUCTIONS FOR COMPLETING THIS FORM ON THE REVERSE SIDE

SECTION A

Operator TEXAS CRUDE OIL COMPANY		Lease WRIGHT FEDERAL		Well No. 1-23
Well Letter P	Section 23	Township 22 SOUTH	Range 31 EAST	County EDDY
Actual Footage Location of Well: 330 feet from the SOUTH line and 330 feet from the EAST line				
Ground Level Elev. 3500	Producing Formation DELTA	Pool WRIGHT	Dedicated Acreage: 40 Acres	

1. Is the Operator the only owner in the dedicated acreage outlined on the plat below? YES ☐ NO ☒. ("Owner" means the person who has the right to drill into and to produce from any pool and to appropriate the production either for himself or for himself and another. (65-3-29 (e) NMSA 1955 Comp.)
2. If the answer to question one is "no," have the interests of all the owners been consolidated by communitization agreement or otherwise? YES ☐ NO ☒. If answer is "yes," Type of Consolidation _____
3. If the answer to question two is "no," list all the owners and their respective interests below:

Owner	Land Description

SECTION B

CERTIFICATION

I hereby certify that the information in SECTION A above is true and complete to the best of my knowledge and belief.

Name *John W. West*
 Position _____
 Company *Texas Crude Oil Co.*
 Date *April 12, 1962*

I hereby certify that the well location shown on the plat in SECTION B was plotted from field notes of actual survey made by me or under my supervision, and that the same is true and correct to the best of my knowledge and belief.

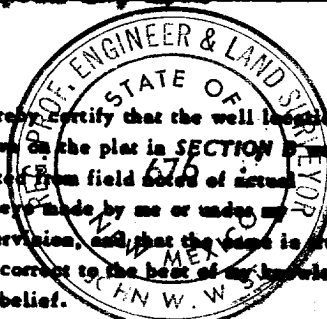

Date Surveyed
2-14-62
 Registered Professional Engineer and/or Land Surveyor, **JOHN W. WEST**
John W. West
 Certificate No. **N. M. - P. E. & L. S. NO. 676**

0 330 660 990 1320 1650 1980 2310 2640 2970 3300 3630 3960 4290 4620 4950 5280 5610 5940 6270 6600