

NEW MEXICO OIL CONSERVATION COMMISSION  
Santa Fe, New Mexico

NOTICE OF INTENTION TO DRILL OR RECOMPLETE

Notice must be given to the District Office of the Oil Conservation Commission and approval obtained before drilling or recompletion begins. If changes in the proposed plan are considered advisable, a copy of this notice showing such changes will be returned to the sender. Submit this notice in QUINTUPLICATE. One copy will be returned following approval. See additional instructions in Rules and Regulations of the Commission.

Hobbs, New Mexico

(Place)

September 7, 1958

(Date)

OIL CONSERVATION COMMISSION  
SANTA FE, NEW MEXICO

Gentlemen:

You are hereby notified that it is our intention to commence the (Drilling) (~~Recompletion~~) of a well to be known as

Charles P. Miller

(Company or Operator)

Pauley-Harrison State

(Lease)

Well No. 1, in M. The well is

(Unit)

located 660 feet from the South line and 660 feet from the

West line of Section 36, T. 23 S., R. 31 E., NMPM.

(GIVE LOCATION FROM SECTION LINE) Wildcat Pool, Eddy County

D	C	B	A
E	F	G	H
L	K	J	I
M	N	O	P

If State Land the Oil and Gas Lease is No.

If patented land the owner is.

Address.

We propose to drill well with drilling equipment as follows: Rotary tools from surface to total depth.

The status of plugging bond is Blanket bond.

Drilling Contractor Murphy-Dyer Drilling Company, Inc.

We intend to complete this well in the Delaware Sand formation at an approximate depth of 4500 feet.

CASING PROGRAM

We propose to use the following strings of Casing and to cement them as indicated:

Size of Hole	Size of Casing	Weight per Foot	New or Second Hand	Depth	Sacks Cement
11"	8-5/8"	24#	S.H.	250'	Circulate
7-7/8"	5-1/2"	14#	New	4500'	150

If changes in the above plans become advisable we will notify you immediately.

ADDITIONAL INFORMATION (If recompletion give full details of proposed plan of work.)

SEP 10 1958

Approved....., 19.....  
Except as follows:

Sincerely yours,

Charles P. Miller

(Company or Operator)

By Charles P. Miller

Position Operator for Murphy-Dyer Drilling Co.

Name Charles P. Miller

Address Box 385, Hobbs, New Mexico.

OIL CONSERVATION COMMISSION

By M. L. Armstrong

Title Oil and Gas Inspector

NEW MEXICO OIL CONSERVATION COMMISSION

Well Location and Acreage Dedication Plat

Section A.

Date \_\_\_\_\_

Operator Charles P. Miller Lease Pauley-Harrison State  
Well No. 1 Unit Letter M Section 36 Township 23S Range 31E NMPM  
Located 660 Feet From South Line, 660 Feet From West Line  
County Eddy G. L. Elevation \_\_\_\_\_ Dedicated Acreage 40 Acres  
Name of Producing Formation Delaware Sand Pool Wildcat

1. Is the Operator the only owner\* in the dedicated acreage outlined on the plat below?  
Yes \_\_\_\_\_ No \_\_\_\_\_.
2. If the answer to question one is "no," have the interests of all the owners been consolidated by communitization agreement or otherwise? Yes \_\_\_\_\_ No \_\_\_\_\_. If answer is "yes," Type of Consolidation \_\_\_\_\_
3. If the answer to question two is "no," list all the owners and their respective interests below:

Owner

Land Description

Section B

R 31E

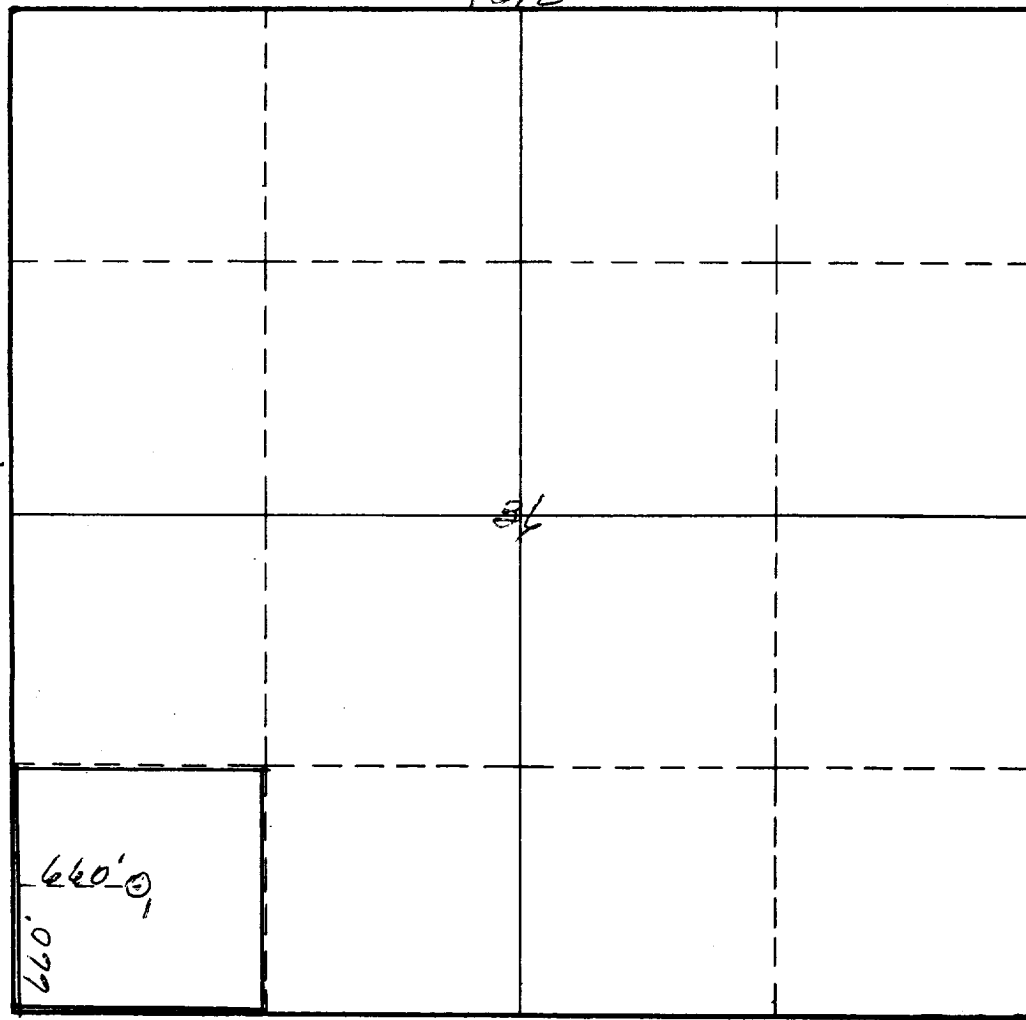

This is to certify that the information in Section A above is true and complete to the best of my knowledge and belief.

Charles P. Miller  
(Operator)

(Representative)

Box 385 - Hobbs, N.M.  
Address

This is to certify that the well location shown on the plat in Section B was plotted from field notes of actual surveys made by me or under my supervision and that the same is true and correct to the best of my knowledge and belief.

Date Surveyed Sept 5, 1958

James H. Brown  
Registered Professional  
Engineer and/or Land Surveyor.

Certificate No. 542

(See instructions for completing this form on the reverse side)

INSTRUCTIONS FOR COMPLETION:

1. Operator shall furnish and certify to the information called for in Section A.
2. Operator shall outline the dedicated acreage for both oil and gas wells on the plat in Section B.
3. A registered professional engineer or land surveyor registered in the State of New Mexico or approved by the Commission shall show on the plat the location of the well and certify this information in the space provided.
4. All distances shown on the plat must be from the outer boundaries of Section.
5. If additional space is needed for listing owners and their respective interests as required in question 3, Section A, please use space below

OFFICE OF THE COMMISSIONER  
NEW MEXICO  
LAND AND MINERAL RIGHTS  
DIVISION

\* "Owner" means the person who has the right to drill into and to produce from any pool and to appropriate the production either for himself or for himself and another. (65-3-29 (e) NMSA 1953 Comp.)