

NUMBER OF COPIES RECEIVED	
DISTRIBUTION	
SANITARY	
FILE	
LAND OFFICE	
TRANSPORTER	OIL GAS
PRODUCTION OFFICE	
OPERATOR	

NEW MEXICO OIL CONSERVATION COMMISSION  
Santa Fe, New Mexico

Form O-201  
Revised (12/1/55)

# NOTICE OF INTENTION TO DRILL

Notice must be given to the District Office of the Oil Conservation Commission and approval obtained before drilling or recompletion begins. If changes in the proposed plan are considered advisable, a copy of this notice showing such changes will be returned to the sender. Submit this notice in QUINTUPPLICATE. One copy will be returned following approval. See additional instructions in Rules and Regulations of the Commission. If State Land submit 6 Copies Attach Form G-128 in triplicate to first 3 copies of form G-101

MIDLAND, TEXAS  
(Place)

NOVEMBER 20, 1964  
(Date)

OIL CONSERVATION COMMISSION  
SANTA FE, NEW MEXICO

Gentlemen:

You are hereby notified that it is our intention to commence the Drilling of a well to be known as

PAUL E. HASKINS

(Company or Operator)

HAGERMAN

(Lease)

Well No. 1

in A

(Unit)

The well is

located 560 feet from the NORTH line and 330 feet from the

EAST LINE line of Section 14, T. 23S, R. 27E, NMPM.

(GIVE LOCATION FROM SECTION LINE) Und Case Draw Oil Pool, EDDY County

If State Land the Oil and Gas Lease is No.

If patented land the owner is LOWRY HAGERMAN

Address BOX 941, SANTE FE, NEW MEXICO

We propose to drill well with drilling equipment as follows: CABLE TOOL

The status of plugging bond is EXPIRES 11/24/65

Drilling Contractor SOUTHWESTERN INC.

We intend to complete this well in the DELAWARE

formation at an approximate depth of 2,350 feet.

## CASING PROGRAM

We propose to use the following strings of Casing and to cement them as indicated:

Size of Hole	Size of Casing	Weight per Foot	New or Second Hand	Depth	Sacks Cement
12	8-5/8	24#	USED	350	CIRCULATE
8	4-1/2	9.5#	USED	2,350	125 SX

If changes in the above plans become advisable we will notify you immediately.

ADDITIONAL INFORMATION (If recompletion give full details of proposed plan of work.)

RECEIVED

NOV 25 1964

NOV 30 1964

Approved: \_\_\_\_\_, 19\_\_\_\_\_  
Except as follows:

Sincerely yours,

O. C. C.  
ARTESIA, OFFICE

PAUL E. HASKINS

(Company or Operator)

By

Position OWNER

Send Communications regarding well to

Name PAUL E. HASKINS

Address 2007 WILCO BLDG., MIDLAND, TEXAS

We will need to inspect all pipe before it is run

OIL CONSERVATION COMMISSION

By M. Armstrong

NEW MEXICO OIL CONSERVATION COMMISSION  
WELL LOCATION AND ACREAGE DEDICATION PLAT

FORM C-128  
Revised 5/1/57

SEE INSTRUCTIONS FOR COMPLETING THIS FORM ON THE REVERSE SIDE

SECTION A

Operator <b>Paul E. Haskins</b>		Lease <b>Hagerman</b>		Well No. <b>1</b>
Unit Letter <b>A</b>	Section <b>14</b>	Township <b>23 South</b>	Range <b>27 East</b>	County <b>Eddy</b>
Actual Postage Location of Well: <b>660</b> feet from the <b>North</b> line and <b>330</b> feet from the <b>East</b> line				
Ground Level Elev.	Producing Formation <b>Delaware</b>		Pool <b>Cass Draw</b>	Dedicated Acreage: <b>40</b> Acres

1. Is the Operator the only owner in the dedicated acreage outlined on the plat below? YES ☒ NO ☐ ("Owner" means the person who has the right to drill into and to produce from any pool and to appropriate the production either for himself or for himself and another. (65-3-29 (a) NMSA 1935 Comp.)
2. If the answer to question one is "no," have the interests of all the owners been consolidated or consolidated by agreement or otherwise? YES ☐ NO ☐ If answer is "yes," Type of Consolidation \_\_\_\_\_
3. If the answer to question two is "no," list all the owners and their respective interests below:

Owner	Land Description
	<b>NOV 25 1964</b>
	<b>O. C. C.</b>
	<b>ARTESIA, OFFICE</b>

SECTION B

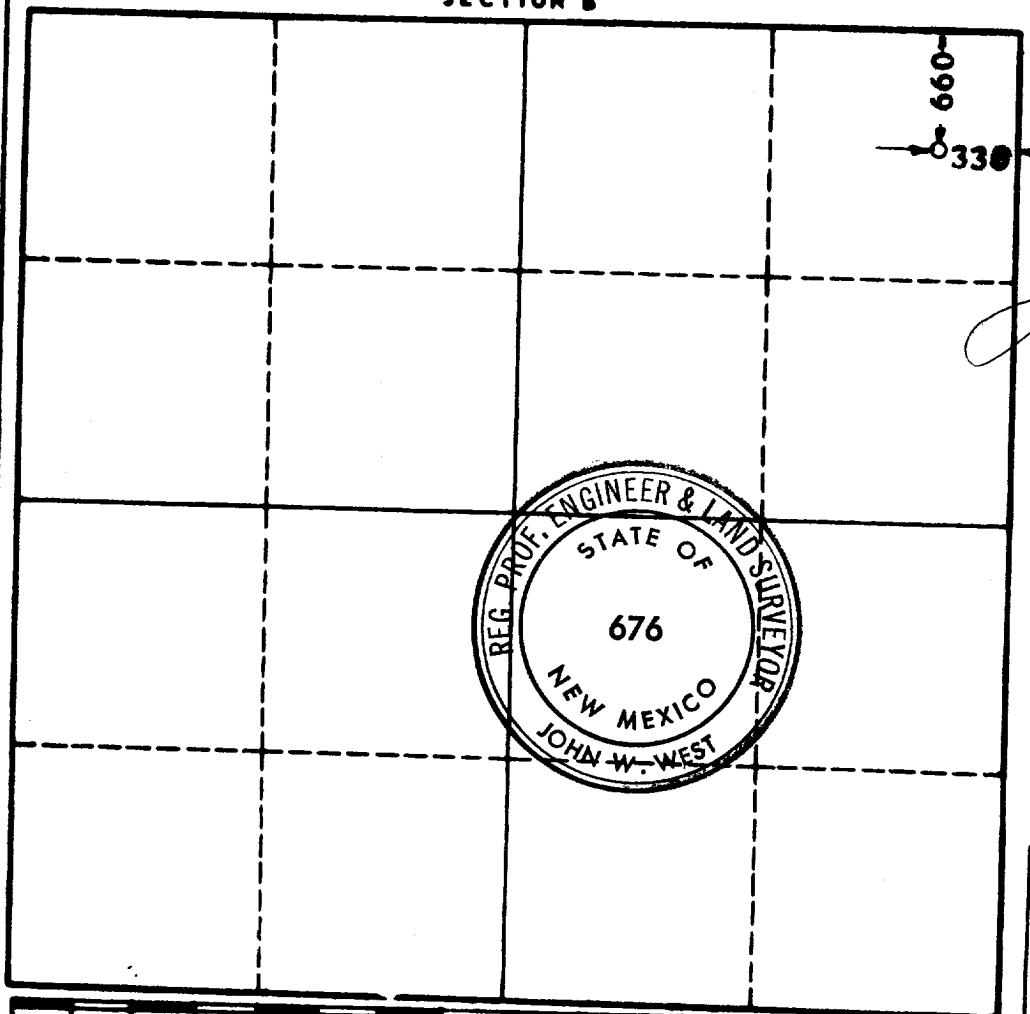

CERTIFICATION

I hereby certify that the information in SECTION A above is true and complete to the best of my knowledge and belief.

Name **John W. West**  
Position **Agent**  
Company **Paul E. Haskins**  
Date **11-24-1964**

I hereby certify that the well location shown on the plat in SECTION B was plotted from field notes of actual surveys made by me or under my supervision, and that the same is true and correct to the best of my knowledge and belief.

Date Surveyed **11-24-1964**  
Registered Professional Engineer and/or Land Surveyor, **JOHN W. WEST**  
Certificate No. **676**  
N. M. - P. E. & L. S. NO. 676