

NO. OF COPIES RECEIVED	
DISTRIBUTION	
SANTA FE	
FILE	
U.S.G.S.	
LAND OFFICE	
OPERATOR	

NEW MEXICO OIL CONSERVATION COMMISSION
RECEIVED

Form C-101
Revised 1-1-65

JAN 18 1982

O. C. D.

ARTESIA, OFFICE

5A. Indicate Type of Lease	
STATE <input checked="" type="checkbox"/>	FEE <input type="checkbox"/>
5. State Oil & Gas Lease No. K 2538	

APPLICATION FOR PERMIT TO DRILL, DEEPEN, OR PLUG BACK

1a. Type of Work		7. Unit Agreement Name	
b. Type of Well OIL WELL <input checked="" type="checkbox"/> GAS WELL <input type="checkbox"/> OTHER (Re-entry) <input type="checkbox"/> DEEPEN <input type="checkbox"/> PLUG BACK <input checked="" type="checkbox"/>		8. Farm or Lease Name State "AK"	
2. Name of Operator The Desana Corporation		9. Well No. 1	
3. Address of Operator 600 Building of the Southwest		10. Field and Pool, or Wildcat Bone Spring-Wildcat	
4. Location of Well UNIT LETTER K LOCATED 1976 FEET FROM THE South LINE AND 1980 FEET FROM THE West LINE OF SEC. 32 TWP. 23-S RGE. 27-E NMPM		12. County Eddy	
19. Proposed Depth 5700' PB		19A. Formation Bone Spring	
20. Rotary or C.T. WO Rig		21. Elevations (Show whether DF, RT, etc.) 3246' GL	
21A. Kind & Status Plug. Bond \$50,000 State Wide		21B. Drilling Contractor	
22. Approx. Date Work will start February 1, 1982			

23.

PROPOSED CASING AND CEMENT PROGRAM

SIZE OF HOLE	SIZE OF CASING	WEIGHT PER FOOT	SETTING DEPTH	SACKS OF CEMENT	EST. TOP
Currently in hole	13-3/8"	NA	375	375	
" "	9-5/8"	NA	5850	1860	
7-7/8" (Clean Out)	4-1/2"	10.50#	5700	250	4550

Re-entry of Phillips Petroleum State Lease K 2538 Well #1 which was plugged and abandoned November 1965. The well will be re-entered and cleaned out to a depth of 5700'; 4-1/2" csg run to 5700'. The 4-1/2", 10.50# csg will be cemented w/ 250 sx 50/50 Poz-C cmt containing 6# salt /sx.

APPROVAL VALID FOR 180 DAYS
PERMIT EXPIRES 7-22-82
UNLESS DRILLING UNDERWAY

IN ABOVE SPACE DESCRIBE PROPOSED PROGRAM: IF PROPOSAL IS TO DEEPEN OR PLUG BACK, GIVE DATA ON PRESENT PRODUCTIVE ZONE AND PROPOSED NEW PRODUCTIVE ZONE. GIVE BLOWOUT PREVENTER PROGRAM, IF ANY.

I hereby certify that the information above is true and complete to the best of my knowledge and belief.

Signed Tom B. Cook Title Production Superintendent Date January 11, 1982

(This space for State Use)

APPROVED BY Mike Williams TITLE OIL AND GAS INSPECTOR DATE JAN 22 1982

CONDITIONS OF APPROVAL, IF ANY:

MEXICO OIL CONSERVATION COMMISSION
WELL LOCATION AND ACREAGE DEDICATION PLAT

RECEIVED

Form C-102
 Supersedes C-128
 Effective 1-1-65

JAN 18 1982

All distances must be from the outer boundaries of the Section.

Operator The Desana Corporation			Lease O. C. D.		Well No. 1
State "AK"			ARTESIA OFFICE		
Unit Letter K	Section 32	Township 23-S	Range 27-E	County Eddy	
Actual Footage Location of Well: 1976 feet from the South line and 1980 feet from the West line					
Ground Level Elev. 3246	Producing Formation Bone Spring	Pool Wildcat		Dedicated Acreage: 40 Acres	

1. Outline the acreage dedicated to the subject well by colored pencil or hachure marks on the plat below.
2. If more than one lease is dedicated to the well, outline each and identify the ownership thereof (both as to working interest and royalty).
3. If more than one lease of different ownership is dedicated to the well, have the interests of all owners been consolidated by communitization, unitization, force-pooling, etc?

☐ Yes ☐ No If answer is "yes," type of consolidation _____

If answer is "no," list the owners and tract descriptions which have actually been consolidated. (Use reverse side of this form if necessary.) _____

No allowable will be assigned to the well until all interests have been consolidated (by communitization, unitization, forced-pooling, or otherwise) or until a non-standard unit, eliminating such interests, has been approved by the Commission.

NOTE: This is a re-entry of The Phillips Petroleum State Lease K 2538 Well #1 which was plugged and abandoned in 1965.

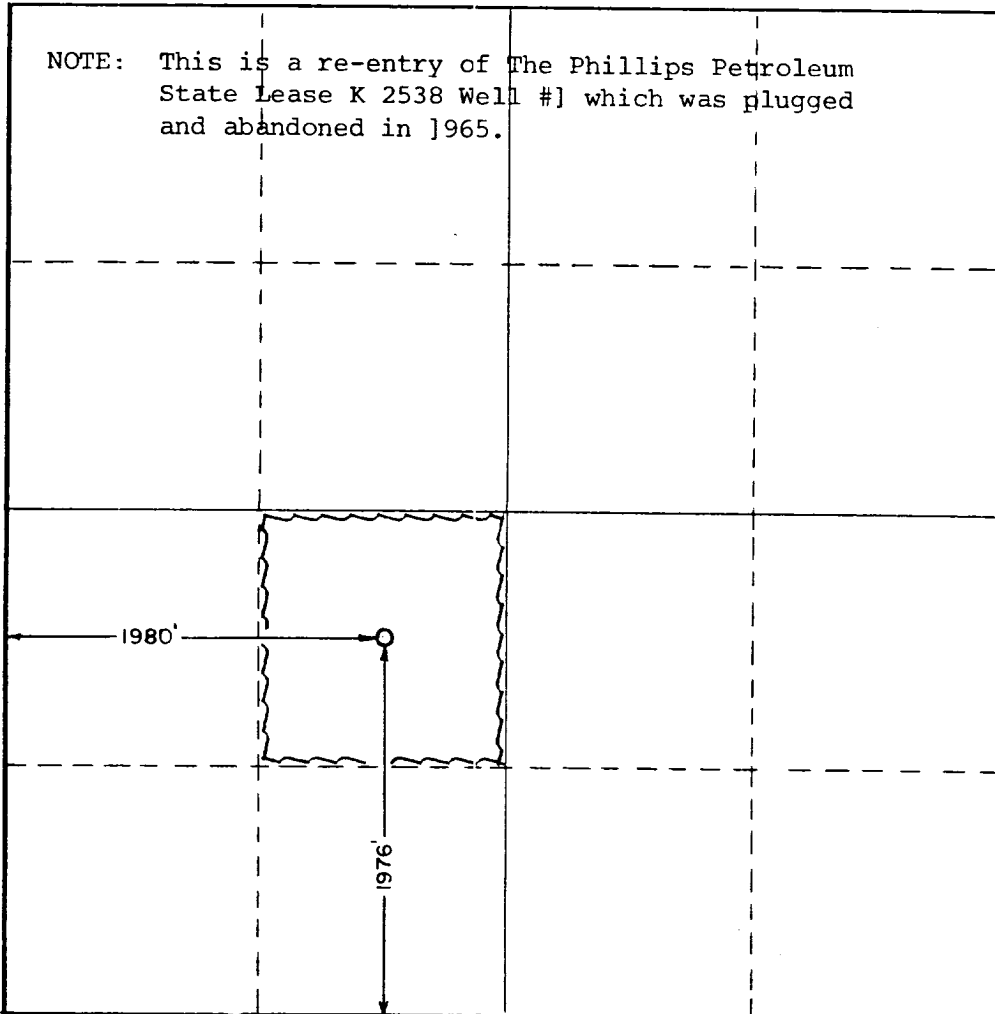

CERTIFICATION

I hereby certify that the information contained herein is true and complete to the best of my knowledge and belief.

Tom R. Cook

Name
Tom R. Cook

Position
Production Superintendent

Company
The Desana Corporation

Date
January 12, 1982

I hereby certify that the well location shown on this plat was plotted from field notes of actual surveys made by me or under my supervision, and that the same is true and correct to the best of my knowledge and belief.

Date Surveyed _____

Registered Professional Engineer and/or Land Surveyor _____

Certificate No. _____

