

NEW MEXICO OIL CONSERVATION COMMISSION
WELL LOCATION AND ACREAGE DEDICATION PLAT

FORM C-128
Revised 5/1/57

SEE INSTRUCTIONS FOR COMPLETING THIS FORM ON THE REVERSE SIDE

SECTION A

Operator Union Oil Company of California		Lease Dark Canyon State		Well No. 1-30
Unit Letter J	Section 30	Township 23-8	Range 25-E	County Eddy
Actual Footage Location of Well: 1700 feet from the south line and 2230 feet from the east line				
Ground Level Elev. 3908'	Producing Formation Upper Pennsylvanian		Pool Wildcat	Dedicated Acreage: 320 Acres

1. Is the Operator the only owner in the dedicated acreage outlined on the plat below? YES _____ NO ☒ . ("Owner" means the person who has the right to drill into and to produce from any pool and to appropriate the production either for himself or for himself and another. (65-3-29 (e) NMSA 1935 Comp.)
2. If the answer to question one is "no," have the interests of all the owners been consolidated by communitization agreement or otherwise? YES ☒ NO _____. If answer is "yes," Type of Consolidation **Joint Operating Agreement**
3. If the answer to question two is "no," list all the owners and their respective interests below:

Owner	Land Description
	RECEIVED
	JUN 29 1964

SECTION B

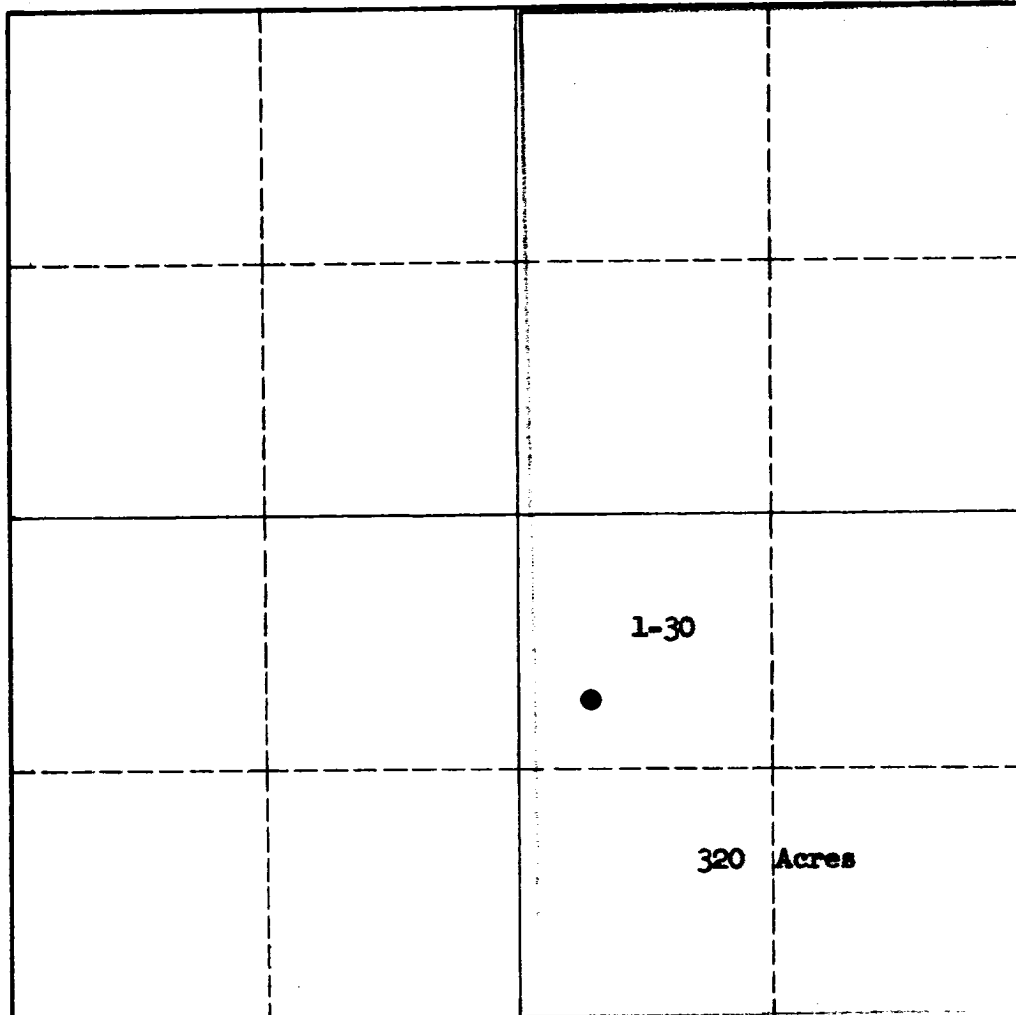

CERTIFICATION
ARTESIA, OFFICE

I hereby certify that the information in SECTION A above is true and complete to the best of my knowledge and belief.

Name Paul Wecker
Position Production Clerk
Company Union Oil Co. of California
Date June 22, 1964

I hereby certify that the well location shown on the plat in SECTION B was plotted from field notes of actual surveys made by me or under my supervision, and that the same is true and correct to the best of my knowledge and belief.

Date Surveyed
Registered Professional Engineer and/or Land Surveyor
Certificate No.

0 330 660 990 1320 1650 1980 2310 2640 2000 1500 1000 500 0

INSTRUCTIONS FOR COMPLETION OF FORM C-128

1. Operator shall furnish and certify to the information called for in Section A.
2. Operator shall outline the dedicated acreage for *both* oil and gas wells on the plat in Section B.
3. A registered professional engineer or land surveyor registered in the State of New Mexico or approved by the Commission shall show on the plat the location of the well and certify this information in the space provided.
4. All distances shown on the plat must be from the outer boundaries of the Section.
5. If additional space is needed for listing owners and their respective interests as required in question 3 of Section A, please use space below.

OIL CONSERVATION COMMISSION	
ALBUQUERQUE DISTRICT OFFICE	
No. Copies Received	3
DISTRIBUTION	
	NO. FURNISHED
OPERATOR	
SANTA FE	1
PROPRIETARY	
STATE LAND COMMISSION	
U. S. G. S.	1
TRANSPORTATION	
FILE	1-
BUREAU OF MINES	