

NUMBER OF COPIES RECEIVED 5	
DISTRIBUTION	
SANTA FE	
FILE	
U.S.G.S.	
LAND OFFICE	
TRANSPORTER	
OIL	
GAS	
PRODUCTION OFFICE	
OPERATOR	

NEW MEXICO OIL CONSERVATION COMMISSION
Santa Fe, New Mexico

Form C-101
Revised (12/1/55)

NOTICE OF INTENTION TO DRILL

Notice must be given to the District Office of the Oil Conservation Commission and approval obtained before drilling or recompletion begins. If changes in the proposed plan are considered advisable, a copy of this notice showing such changes will be returned to the sender. Submit this notice in QUINTUPPLICATE. One copy will be returned following approval. See additional instructions in Rules and Regulations of the Commission. If State Land submit 6 Copies Attach Form G-128 in triplicate to first 3 copies of form C-101

Hobbs, New Mexico

May 29, 1964

(Place)

(Date)

OIL CONSERVATION COMMISSION
SANTA FE, NEW MEXICO

Gentlemen:

You are hereby notified that it is our intention to commence the Drilling of a well to be known as

John D. Blake

(Company or Operator)

A. J. Crawford

(Lease)

Well No. **1**, in **H** (Unit) The well is

located **2310** feet from the **North** line and **330** feet from the

East

line of Section **10**, T. **24 S**, R. **27 E**, NMPM.

(GIVE LOCATION FROM SECTION LINE)

Wildest

Pool,

Eddy

County

If State Land the Oil and Gas Lease is No.

If patented land the owner is **A. J. Crawford**

Address **311 N. Halaguano, Carlsbad, New Mexico**

We propose to drill well with drilling equipment as follows: **Cable tools**

The status of plugging bond is **Bond mailed to Santa Fe 5/29/64**

Drilling Contractor **Harry Sindorf**

We intend to complete this well in the **Dalmore**

formation at an approximate depth of **2500** feet.

CASING PROGRAM

We propose to use the following strings of Casing and to cement them as indicated:

Size of Hole	Size of Casing	Weight per Foot	New or Second Hand	Depth	Sacks Cement
12	10 3/4	32.75#	SH	350	Circ.
8	4 1/2	9.5#	SH	2500	50

If changes in the above plans become advisable we will notify you immediately.

ADDITIONAL INFORMATION (If recompletion give full details of proposed plan of work.)

RECEIVED

JUN 1 - 1964

Approved **JUN 3 1964**, 19
Except as follows:

Sincerely yours,

D. C. C.
ARTERIAL DEPT

John D. Blake

(Company or Operator)

By

Position **Agent**

Send Communications regarding well to

% OIL REPORTS & GAS SERVICES

Name

BOX 763 HOBBS, NEW MEXICO

Address

OIL CONSERVATION COMMISSION

By **M. L. Armstrong**
OIL AND GAS INSPECTOR

NEW MEXICO OIL CONSERVATION COMMISSION
WELL LOCATION AND ACREAGE DEDICATION PLAT

FORM C-128
Revised 5/1/57

SEE INSTRUCTIONS FOR COMPLETING THIS FORM ON THE REVERSE SIDE

SECTION A

Operator JOHN D. BLAKE		Lease A. J. CRAWFORD		Well No. 1
Unit Letter H	Section 10	Township 24 SOUTH	Range 27 EAST	County EDDY COUNTY
Actual Footage Location of Well: 2310 feet from the NORTH line and 330 feet from the EAST line				
Ground Level Elev. Delaware	Producing Formation Wildcat		Dedicated Acreage: 40 Acres	

1. Is the Operator the only owner in the dedicated acreage outlined on the plat below? YES ☒ NO ____ ("Owner" means the person who has the right to drill into and to produce from any pool and to appropriate the production either for himself or for himself and another. (65-3-29 (a) NMSA 1955 Comp.)
2. If the answer to question one is "no," have the interests of all the owners been consolidated by communitization agreement or otherwise? YES ____ NO ____ If answer is "yes," Type of Consolidation _____
3. If the answer to question two is "no," list all the owners and their respective interests below: **RECEIVED**

Owner	Land Description JUN 1 - 1964
-------	---

SECTION B

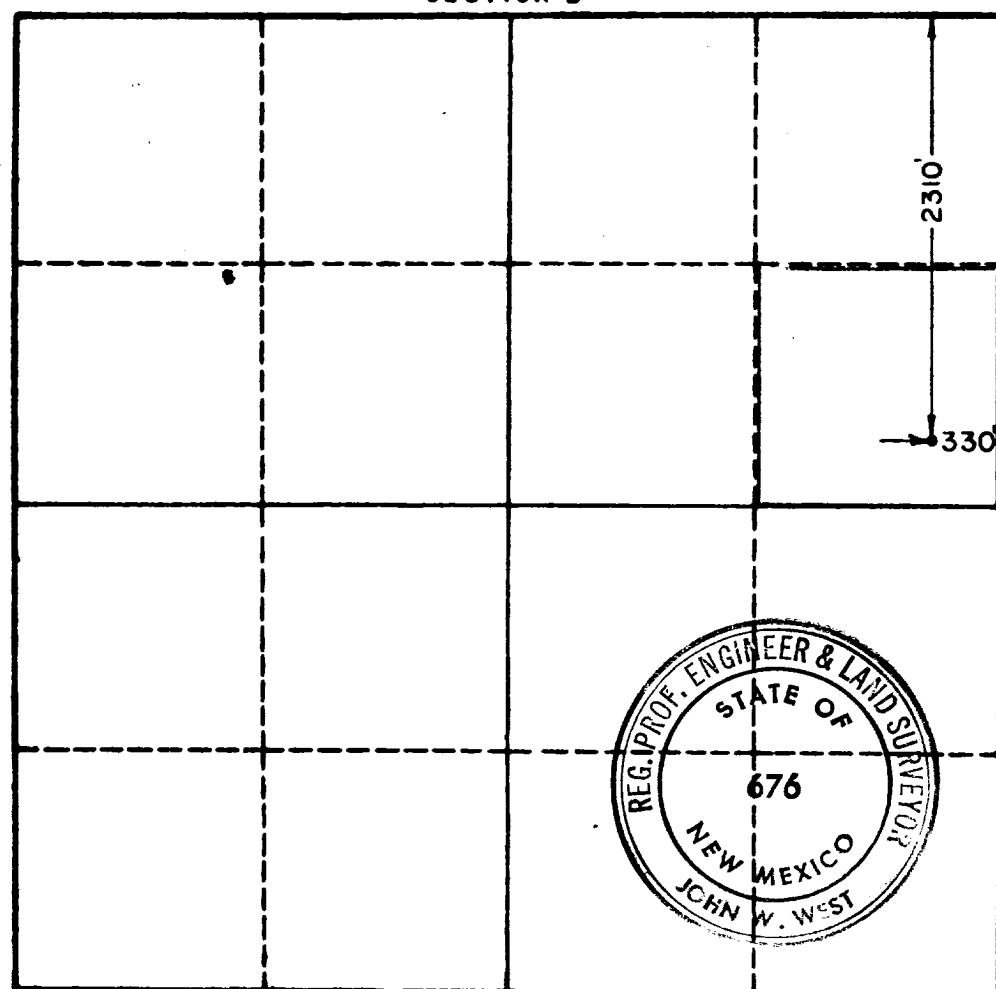

O. C. C.
ARTESIA, OFFICE
CERTIFICATION

I hereby certify that the information in SECTION A above is true and complete to the best of my knowledge and belief.

Name **H. L. Smith**
Position **Agent**
Company **John D. Blake**
Date **May 29, 1964**

I hereby certify that the well location shown on the plat in SECTION B was plotted from field notes of actual surveys made by me or under my supervision, and that the same is true and correct to the best of my knowledge and belief.

Date Surveyed **5-9-64**
Registered Professional Engineer and/or Land Surveyor, **JOHN W. WEST**
John W. West
Certificate No. **N. M. - P. E. & L. S. No. 676**

0 300 600 900 1200 1500 1800 2100 2400 2700 3000 3300 3600 3900 4200 4500 4800 5100 5400 5700 6000