

N. MEXICO OIL CONSERVATION COMMISSION
WELL LOCATION AND ACREAGE DEDICATION PLAT

Form C-102
Supersedes C-128
Effective 1-1-65

All distances must be from the outer boundaries of the Section.

Operator Shagan Petroleum Corporation			Lease Shagato		Well No. 11
Unit Letter	Section 1	Township 23 North	Range 22 East	County Wyo	
Actual Footage Location of Well: 1970 feet from the East line and 660 feet from the North line					
Ground Level Elev: 4361	Producing Formation Upper & Lower Penn		Pool 11 coat	Dedicated Acreage: 320 (N$\frac{1}{2}$ Sec. 1) Acres	

1. Outline the acreage dedicated to the subject well by colored pencil or hachure marks on the plat below.
2. If more than one lease is dedicated to the well, outline each and identify the ownership thereof (both as to working interest and royalty).
3. If more than one lease of different ownership is dedicated to the well, have the interests of all owners been consolidated by communitization, unitization, force-pooling, etc?

☐ Yes ☐ No If answer is "yes," type of consolidation _____ **SEP 23 1965**

If answer is "no," list the owners and tract descriptions which have actually been consolidated. (Use reverse side of this form if necessary.) _____

No allowable will be assigned to the well until all interests have been consolidated (by communitization, unitization, forced-pooling, or otherwise) or until a non-standard unit, eliminating such interests, has been approved by the Commission.

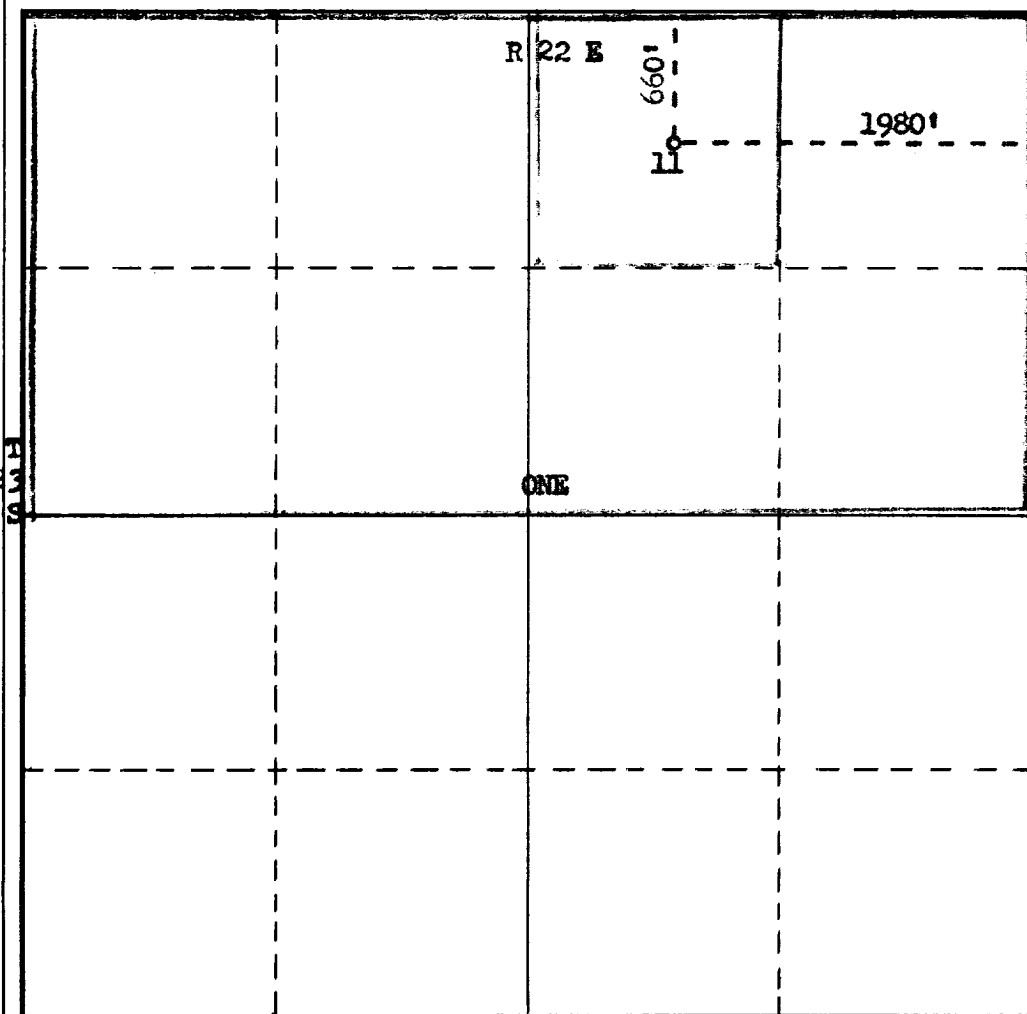

CERTIFICATION

I hereby certify that the information contained herein is true and complete to the best of my knowledge and belief.

Robert P. Shagan
Name **Robert P. Shagan**

Position **President**

Company **Shagan Petroleum Corp.**

Date **September 15, 1965**

I hereby certify that the well location shown on this plat was plotted from field notes of actual surveys made by me or under my supervision, and that the same is true and correct to the best of my knowledge and belief.

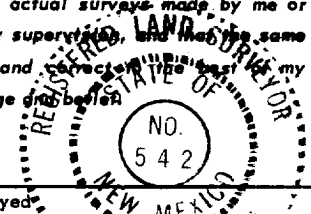

Date Surveyed **September 2, 1965**

Registered Professional Engineer and/or Land Surveyor

James H. Brown

Certificate No. _____

N.M.L.S. No. 542