

Humble Lse.No. 600350

NEW MEXICO OIL CONSERVATION COMMISSION

Form C-102  
Supersedes C-128  
Effective 1-1-65

State Lse.No. WELL LOCATION AND ACREAGE DEDICATION PLAT

Federal Lse.No. NM 059249 &amp; 251

All distances must be from the outer boundaries of the Section.

Operator Humble Oil & Refining Co.			Lease NORTH WHITE CITY UNIT		Well No. 1
Unit Letter C	Section 31	Township 23 SOUTH	Range 26 EAST	County EDDY	
Actual Footage Location of Well: 960 feet from the NORTH line and 1980 feet from the West line					
Ground Level Elev. Later	Producing Formation MORROW	Pool WILDCAT		Dedicated Acreage: 318.55 Acres	

1. Outline the acreage dedicated to the subject well by colored pencil or hatchure marks on the plat below.
2. If more than one lease is dedicated to the well, outline each and identify the ownership thereof (both as to working interest and royalty).
3. If more than one lease of different ownership is dedicated to the well, have the interests of the owners been consolidated by communitization, unitization, force-pooling, etc?

☒ Yes ☐ No If answer is "yes," type of consolidation UNITIZATION

If answer is "no," list the owners and tract descriptions which have actually been consolidated. (Use reverse side of this form if necessary.)

No allowable will be assigned to the well until all interests have been consolidated (by communitization, unitization, forced-pooling, or otherwise) or until a non-standard unit, eliminating such interests, has been approved by the Commission.

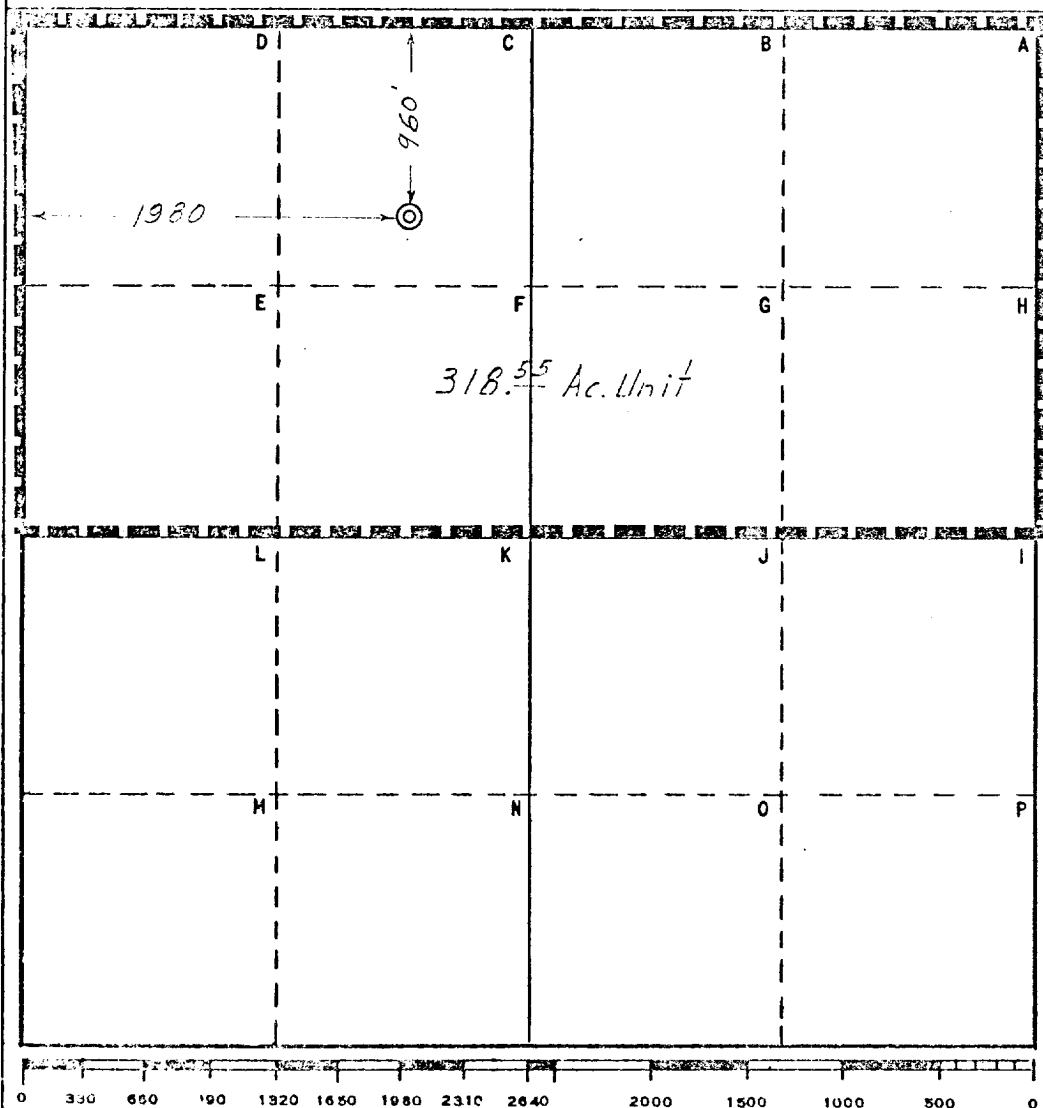

## CERTIFICATION

I hereby certify that the information contained herein is true and complete to the best of my knowledge and belief.

Name R. E. Pinkerton  
Position Production Engineer  
Company Humble Oil & Refining Co.  
Box 1600 Midland, Texas  
Date May 13, 1968

I hereby certify that the well location shown on this plat was plotted from field notes of actual surveys made by me or under my supervision, and that the same is true and correct to the best of my knowledge and belief.

Date Surveyed May 2, 1968  
Registered Professional Engineer  
and/or Land Surveyor

Certificate No. 1382