

10. OF COPIES RECEIVED	
DISTRIBUTION	
SANTA FE	1
FILE	1
U.S.G.S.	21
LAND OFFICE	
OPERATOR	1

NEW MEXICO OIL AND GAS COMMISSION

NOV 6 1969

O. C. C.
ARTESIA, OFFICE

30-015-20264

Form C-101
Revised 1-1-65

5A. Indicate Type of Lease	
STATE <input type="checkbox"/>	FEE <input checked="" type="checkbox"/>

5. State Oil & Gas Lease No.

APPLICATION FOR PERMIT TO DRILL, DEEPEN, OR PLUG BACK

1a. Type of Work		7. Unit Agreement Name	
b. Type of Well DRILL <input checked="" type="checkbox"/> DEEPEN <input type="checkbox"/> PLUG BACK <input type="checkbox"/> OIL WELL <input checked="" type="checkbox"/> GAS WELL <input type="checkbox"/> OTHER <input type="checkbox"/> SINGLE ZONE <input checked="" type="checkbox"/> MULTIPLE ZONE <input type="checkbox"/>		8. Farm or Lease Name Tracy	
2. Name of Operator Union Oil Company of California		9. Well No. 2	
3. Address of Operator P.O. Box 671 - Midland, Texas 79701		10. Field and Pool, or Wildcat Esperanza Delaware	
4. Location of Well UNIT LETTER E LOCATED 1980 FEET FROM THE North LINE AND 760 FEET FROM THE West LINE OF SEC. 10 TWP. 22-S RGE. 27-E NMPM		12. County Eddy	
19. Proposed Depth 3550		19A. Formation Delaware	
20. Rotary or C.T. Rotary		21. Elevations (Show whether DF, RT, etc.) Unknown	
21A. Kind & Status Plug. Bond Blanket		21B. Drilling Contractor Contract not let	
22. Approx. Date Work will start On approval			

23.

PROPOSED CASING AND CEMENT PROGRAM

SIZE OF HOLE	SIZE OF CASING	WEIGHT PER FOOT	SETTING DEPTH	SACKS OF CEMENT	EST. TOP
11"	8-5/8"	24#	550'	200	Circ. to surface
7-7/8"	4 1/2"	9.5#	3550'	300	2650'

3000 psi double manual preventers

APPROVAL VALID
FOR 90 DAYS UNLESS
DRILLING COMMENCED,
EXPIRES 2-6-70

IN ABOVE SPACE DESCRIBE PROPOSED PROGRAM: IF PROPOSAL IS TO DEEPEN OR PLUG BACK, GIVE DATA ON PRESENT PRODUCTIVE ZONE AND PROPOSED NEW PRODUCTIVE ZONE. GIVE BLOWOUT PREVENTER PROGRAM, IF ANY.

I hereby certify that the information above is true and complete to the best of my knowledge and belief.

Signed R.G. Ladd, Jr. Title District Drilling Supt. Date November 4, 1969

(This space for State Use)

APPROVED BY W.A. Gressett TITLE OIL AND GAS INSPECTOR DATE NOV 6 1969

CONDITIONS OF APPROVAL, IF ANY:

Cement must be circulated to
surface behind 8 5/8" casing

**NEW MEXICO OIL CONSERVATION COMMISSION
WELL LOCATION AND ACREAGE DEDICATION PLAT**

Form C-102
Supersedes C-128
Effective 1-1-65

All distances must be from the outer boundaries of the Section.

Operator UNION OIL COMPANY OF CALIFORNIA			Lease TRACY		Well No. 2
Unit Letter E	Section 10	Township 22 SOUTH	Range 27 EAST	County EDDY	
Actual Postage Location of Well: 1980 feet from the NORTH line and 760 feet from the WEST line					
Ground Level Elev. Unknown	Producing Formation Delaware		Pool Esperanza Delaware		Dedicated Acreage: 40 Acres

1. Outline the acreage dedicated to the subject well by colored pencil or hatchure marks on the plat below.
2. If more than one lease is dedicated to the well, outline each and identify the ownership thereof (both as to working interest and royalty).
3. If more than one lease of different ownership is dedicated to the well, have the interests of all owners been consolidated by communitization, unitization, force-pooling, etc?

☐ Yes ☐ No If answer is "yes," type of consolidation _____

If answer is "no," list the owners and tract descriptions which have actually been consolidated. (Use reverse side of this form if necessary.) _____

No allowable will be assigned to the well until all interests have been consolidated (by communitization, unitization, forced-pooling, or otherwise) or until a non-standard unit, eliminating such interests, has been approved by the Commission.

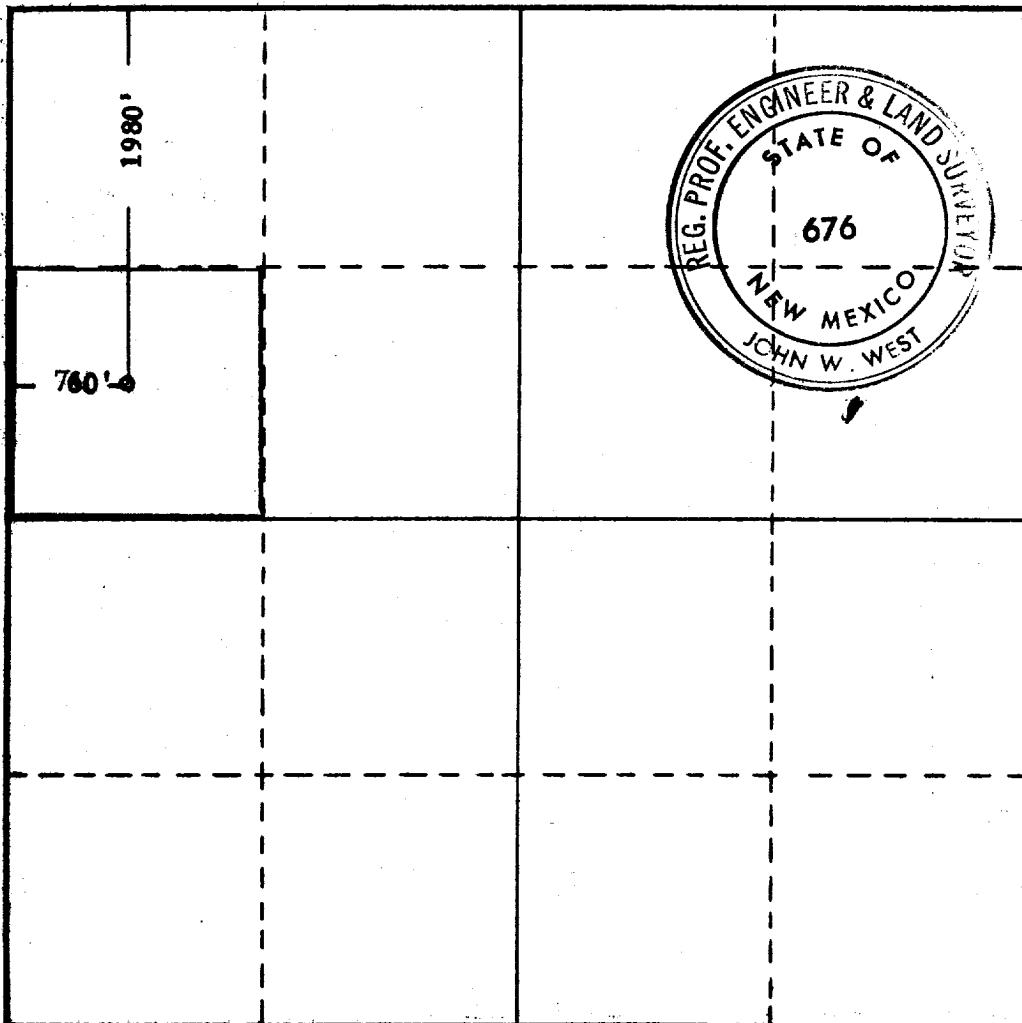

CERTIFICATION

I hereby certify that the information contained herein is true and complete to the best of my knowledge and belief.

Name *R. L. Ladd*
 Position **District Drilling Supt.**
 Company **Union Oil Co. of California**
 Date **November 4, 1969**

I hereby certify that the well location shown on this plat was plotted from field notes of actual surveys made by me or under my supervision, and that the same is true and correct to the best of my knowledge and belief.

Date Surveyed
8-9-1969
 Registered Professional Engineer and/or Land Surveyor
John W. West
 Certificate No. **676**

0 300 600 900 1200 1500 1800 2100 2400 2700 3000 3300 3600