

**MEXICO OIL CONSERVATION COMMISSION
WELL LOCATION AND ACREAGE DEDICATION PLAT**

Form C-102
Supersedes C-128
Effective 1-1-65

All distances must be from the outer boundaries of the Section.

Operator TEXAS AMERICAN OIL CORP.			Lease TODD 36 STATE		Well No. 1
Unit Letter F	Section 36	Township 23 SOUTH	Range 31 EAST	County EDDY	
Actual Footage Location of Well: 1980 feet from the WEST line and 1980 feet from the NORTH line					
Ground Level Elev. 3499.4	Producing Formation Atoka & Morrow		Pool <i>Ind. Land from Atoka</i> Wildcat	Dedicated Acreage: 640 Acres	

1. Outline the acreage dedicated to the subject well by colored pencil or hachure marks on the plat below.
2. If more than one lease is dedicated to the well, outline each and identify the ownership thereof (both as to working interest and royalty).
3. If more than one lease of different ownership is dedicated to the well, have the interests of all owners been consolidated by communitization, unitization, force-pooling, etc?

☒ Yes ☐ No If answer is "yes," type of consolidation Pursuant to joint operating agreement.

If answer is "no," list the owners and tract descriptions which have actually been consolidated. (Use reverse side of this form if necessary.) _____

No allowable will be assigned to the well until all interests have been consolidated (by communitization, unitization, forced-pooling, or otherwise) or until a non-standard unit, eliminating such interests, has been approved by the Commission.

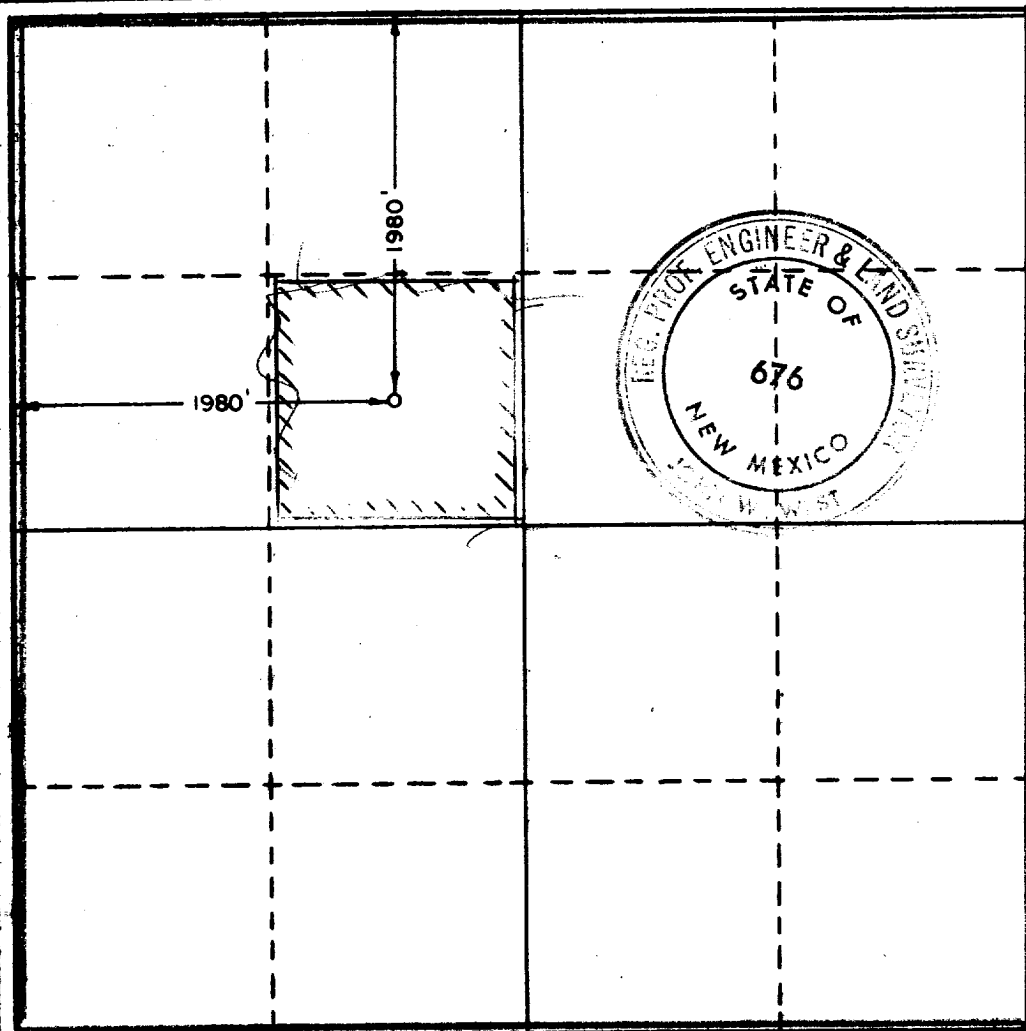

CERTIFICATION

I hereby certify that the information contained herein is true and complete to the best of my knowledge and belief.

Name
N. T. Emanuel

Position
Petroleum Engineer

Company
Texas American Oil Corp.

Date
October 26, 1970

I hereby certify that the well location shown on this plat was plotted from field notes of actual surveys made by me or under my supervision, and that the same is true and correct to the best of my knowledge and belief.

Date Surveyed
10-20-1970

Registered Professional Engineer and/or Land Surveyor
John W. West

Certificate No. **676**