

AUG 26 1971

Distances must be from the outer boundaries of the

El Paso Natural Gas Company			Lease ARCO State		D. C. C. ARTESIA OFFICE		Well No. 1
Unit Letter K	Section 15	Township 33-S	Range 21-W	County El Paso			
Actual Well Location as Well:							
1947		feet from the South		1986		feet from the West	
Ground Level Elev. 3359'	Producing Formation Alto		Pool Wildcat		Dedicated Acreage: 320 Acres		

1. Outline the acreage dedicated to the subject well by colored pencil or hachure marks on the plat below.
2. If more than one lease is dedicated to the well, outline each and identify the ownership thereof (both as to working interest and royalty).
3. If more than one lease of different ownership is dedicated to the well, have the interests of all owners been consolidated by communitization, unitization, force-pooling, etc?

☒ Yes ☐ No If answer is "yes," type of consolidation Communitization

If answer is "no," list the owners and tract descriptions which have actually been consolidated. (Use reverse side of this form if necessary.)

No allowable will be assigned to the well until all interests have been consolidated (by communitization, unitization, forced-pooling, or otherwise) or until a non-standard unit, eliminating such interests, has been approved by the Commission.

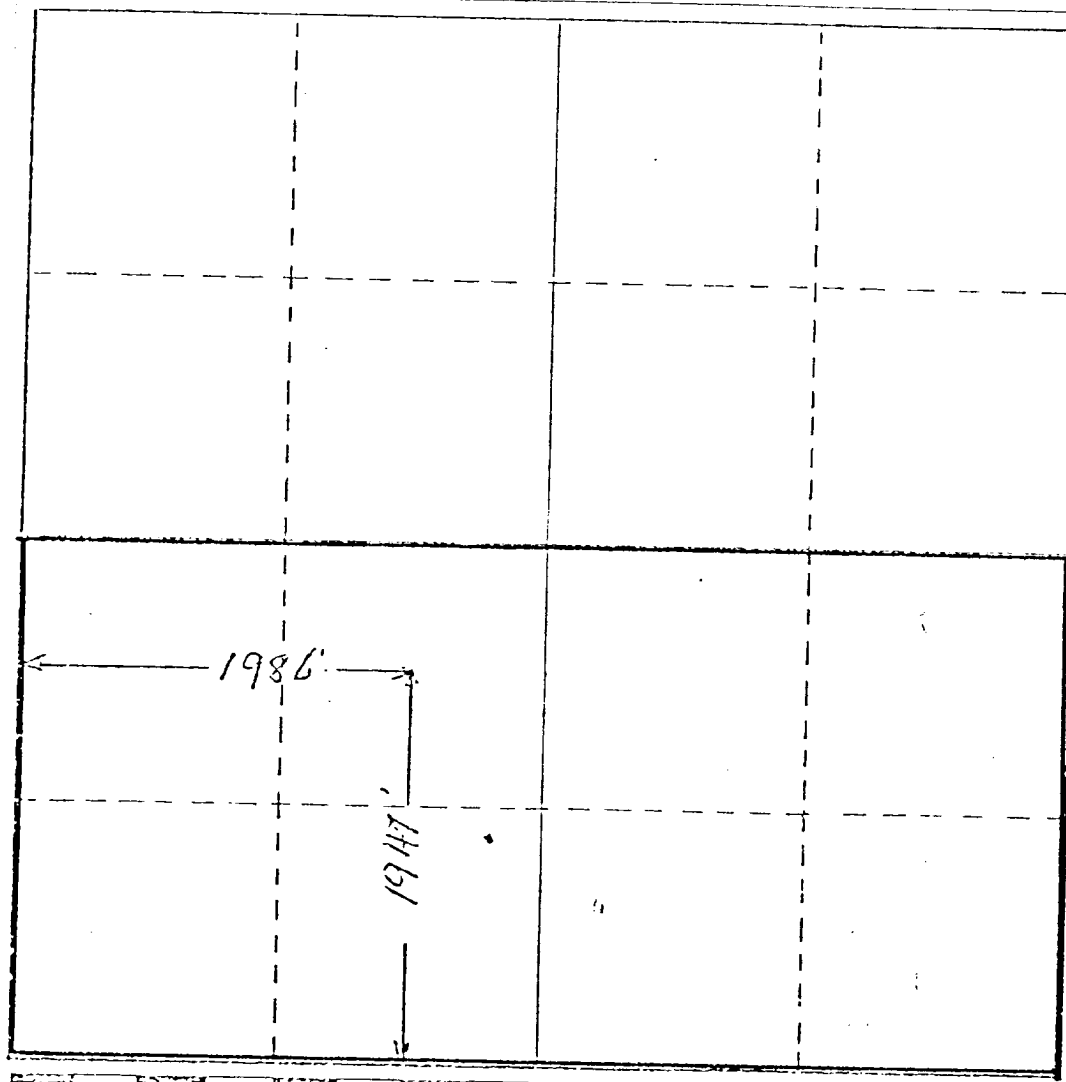

CERTIFICATION

I hereby certify that the information contained herein is true and complete to the best of my knowledge and belief.

Bessie C. Loder
Name

Production Clerk

Position

El Paso Natural Gas Company

Company

August 24, 1971

Date

I hereby certify that the well location shown on this plat was plotted from field notes of actual surveys made by me or under my supervision, and that the same is true and correct to the best of my knowledge and belief.

Date Surveyed

8-23-71

Registered Professional Engineer
and/or Land Surveyor

James D. Gelin
Certificate No.

3067 LS

0 330 660 990 1320 1650 1980 2310 2640 2970 3300 3630 3960 4290 4620 4950 5280 5610 5940 6270 6600