

Submit to Appropriate  
District Office  
State Leases - 6 copies  
Fee Leases - 5 copies

State of New Mexico  
Energy, Minerals and Natural Resources Department

Form C-101  
Revised 1-1-89

OIL CONSERVATION DIVISION

P.O. Box 2088  
Santa Fe, New Mexico 87504-2088

DEC 19 1991

DISTRICT I  
P.O. Box 1980, Hobbs, NM 88240

DISTRICT II  
P.O. Drawer DD, Artesia, NM 88210

DISTRICT III  
1000 Rio Brazos Rd., Aztec, NM 87410

O. C. D.  
ARTESIA OFFICE

API NO. (assigned by OCD on New Wells)	
30-015-20459	
5. Indicate Type of Lease STATE <input type="checkbox"/> FEE <input checked="" type="checkbox"/>	
6. State Oil & Gas Lease No.	
7. Lease Name or Unit Agreement Name Merland A	
8. Well No. 1	
9. Pool name or Wildcat Carlsbad Strawn, South	

APPLICATION FOR PERMIT TO DRILL, DEEPEN, OR PLUG BACK					
1a. Type of Work: DRILL <input type="checkbox"/> RE-ENTER <input type="checkbox"/> DEEPEN <input type="checkbox"/> PLUG BACK <input checked="" type="checkbox"/>					
1b. Type of Well: OIL WELL <input type="checkbox"/> GAS WELL <input checked="" type="checkbox"/> OTHER <input type="checkbox"/> SINGLE ZONE <input checked="" type="checkbox"/> MULTIPLE ZONE <input type="checkbox"/>					
2. Name of Operator OXY USA Inc.					
3. Address of Operator P.O. Box 50250 Midland, TX. 79710					
4. Well Location Unit Letter O : 660 Feet From The South Line and 1400 Feet From The East Line Section 19 Township 22S Range 27E NMPM Eddy County					
10. Proposed Depth 10375'		11. Formation Strawn		12. Rotary or C.T.	
13. Elevations (Show whether DF, RT, GR, etc.) 3161'		14. Kind & Status Plug Bond Required/Approved		15. Drilling Contractor Unknown	
16. Approx. Date Work will start ASAP					
17. PROPOSED CASING AND CEMENT PROGRAM					
SIZE OF HOLE	SIZE OF CASING	WEIGHT PER FOOT	SETTING DEPTH	SACKS OF CEMENT	EST. TOP
15 1/2"	13 3/8"	48#	353'	380	Circulated
12 1/2"	9 5/8"	36-40#	5299'	2150	"
8 3/4"	5 1/2"	17-20#	11749'	1000	TS - 7470'

TD - 11750' PBTD - 11700' It is proposed to plug the Morrow Perfs 11318' - 11654' and recompleate in the Strawn formation as follows:

See other side

180 0013  
6/23/92  
CITIZENSHIP OF NEW MEXICO

IN ABOVE SPACE DESCRIBE PROPOSED PROGRAM: IF PROPOSAL IS TO DEEPEN OR PLUG BACK, GIVE DATA ON PRESENT PRODUCTIVE ZONE AND PROPOSED NEW PRODUCTIVE ZONE. GIVE BLOWOUT PREVENTER PROGRAM, IF ANY.

I hereby certify that the information above is true and complete to the best of my knowledge and belief.

SIGNATURE David Stewart TITLE Production Accountant DATE 12/18/91

TYPE OR PRINT NAME David Stewart TELEPHONE NO. 9156855717

(This space for State Use)  
ORIGINAL SIGNED BY  
MIKE WILLIAMS

DEC 20 1991

APPROVED BY SUPERVISOR DISTRICT II TITLE  DATE

CONDITIONS OF APPROVAL, IF ANY:

1. MIRU PU. Kill well w/produced water. ND WH, NU BOP. Release anchor type seal assembly, RU Baker Scanalog and TOO H w/2-3/8" Buttress tbg while running Baker Scanalog.
2. RU wireline and set 5-1/2" CIBP at 11230'. Dump 4 sx cement (42') on top of CIBP. PU 2-7/8" 6.5# N-80 workstring and TIH to 10375'. Circ hole w/10# brine water. TOO H w/tbg.
3. TIH w/5-1/2" Baker Lok-Set pkr and a on-off tool w/1.87" profile nipple on the 2-7/8" workstring. Set pkr at  $\pm$  10250'.
4. RU perforators, perforate Strawn formation (10329' - 10375') w/a thru tbg gun using premium shots 2 JSPF at the following depths: 10329', 30', 31', 32', 33', 34', 53', 54', 55', 56', 57', 58', 59', 60', 61', 69', 70', 71', 72', 73', 74', 10375'. Total of 44 holes. Depth reference log Schlumberger Borehole Compensated Sonic log dated August 27, 1971.
5. Test well natural.
6. If necessary, acidize Strawn formation (10329' - 10375') w/4000 gals 15% NeFe HCl containing 1000 SCF N<sub>2</sub> per bbl and 88 - 7/8" RCNBS at a liquid rate of 5 BPM. Flush w/2% KCl water containing 1000 SCF N<sub>2</sub> per bbl. Flow back and recover load. Test well.
7. SI well for 72 hours. RU wireline and set tandem BHP bombs w/6000# elements and 24 day clocks in profile nipple. Run 4-pt test.
8. RU wireline and set blanking plug in profile nipple. Release on-off tool and TOO H and LD workstring. TIH w/production tbg to top of pkr and circ hole w/2% KCl water containing 3 gals per thousand Unichem Techni-hib 370 pkr fluid (or equivalent). Latch onto pkr w/on-off tool. Pressure test tbg to 3000#. RU wireline and retrieve blanking plug. Put well on production.

Submit to Appropriate  
District Office  
State Lease - 4 copies  
Fee Lease - 3 copies

State of New Mexico  
Energy, Minerals and Natural Resources Department

Form C-102  
Revised 1-1-89

OIL CONSERVATION DIVISION

P.O. Box 2088  
Santa Fe, New Mexico 87504-2088

DISTRICT I  
P.O. Box 1980, Hobbs, NM 88240

DISTRICT II  
P.O. Drawer DD, Artesia, NM 88210

DISTRICT III  
1000 Rio Brazos Rd., Aztec, NM 87410

WELL LOCATION AND ACREAGE DEDICATION PLAT

All Distances must be from the outer boundaries of the section

Operator OXY USA Inc.			Lease Merland A		Well No. 1
Unit Letter O	Section 19	Township 22S	Range 27E	County NMPM	Eddy
Actual Footage Location of Well: 660 feet from the South line and 1400 feet from the East line					
Ground level Elev. 3161'	Producing Formation Strawn		Pool South Carlsbad	Dedicated Acreage: 320 Acres	

1. Outline the acreage dedicated to the subject well by colored pencil or hatchure marks on the plat below.
2. If more than one lease is dedicated to the well, outline each and identify the ownership thereof (both as to working interest and royalty).
3. If more than one lease of different ownership is dedicated to the well, have the interest of all owners been consolidated by communitization, unitization, force-pooling, etc.?  
☐ Yes ☐ No If answer is "yes" type of consolidation \_\_\_\_\_  
If answer is "no" list the owners and tract descriptions which have actually been consolidated. (Use reverse side of this form if necessary.) \_\_\_\_\_  
No allowable will be assigned to the well until all interests have been consolidated (by communitization, unitization, forced-pooling, or otherwise) or until a non-standard unit, eliminating such interest, has been approved by the Division.

OPERATOR CERTIFICATION

I hereby certify that the information contained herein is true and complete to the best of my knowledge and belief.

Signature \_\_\_\_\_  
Printed Name  
David Stewart  
Position  
Production Accountant  
Company  
OXY USA Inc.  
Date  
12/18/91

SURVEYOR CERTIFICATION

I hereby certify that the well location shown on this plat was plotted from field notes of actual surveys made by me or under my supervision, and that the same is true and correct to the best of my knowledge and belief.

Date Surveyed \_\_\_\_\_  
Signature & Seal of Professional Surveyor \_\_\_\_\_  
Certificate No. \_\_\_\_\_

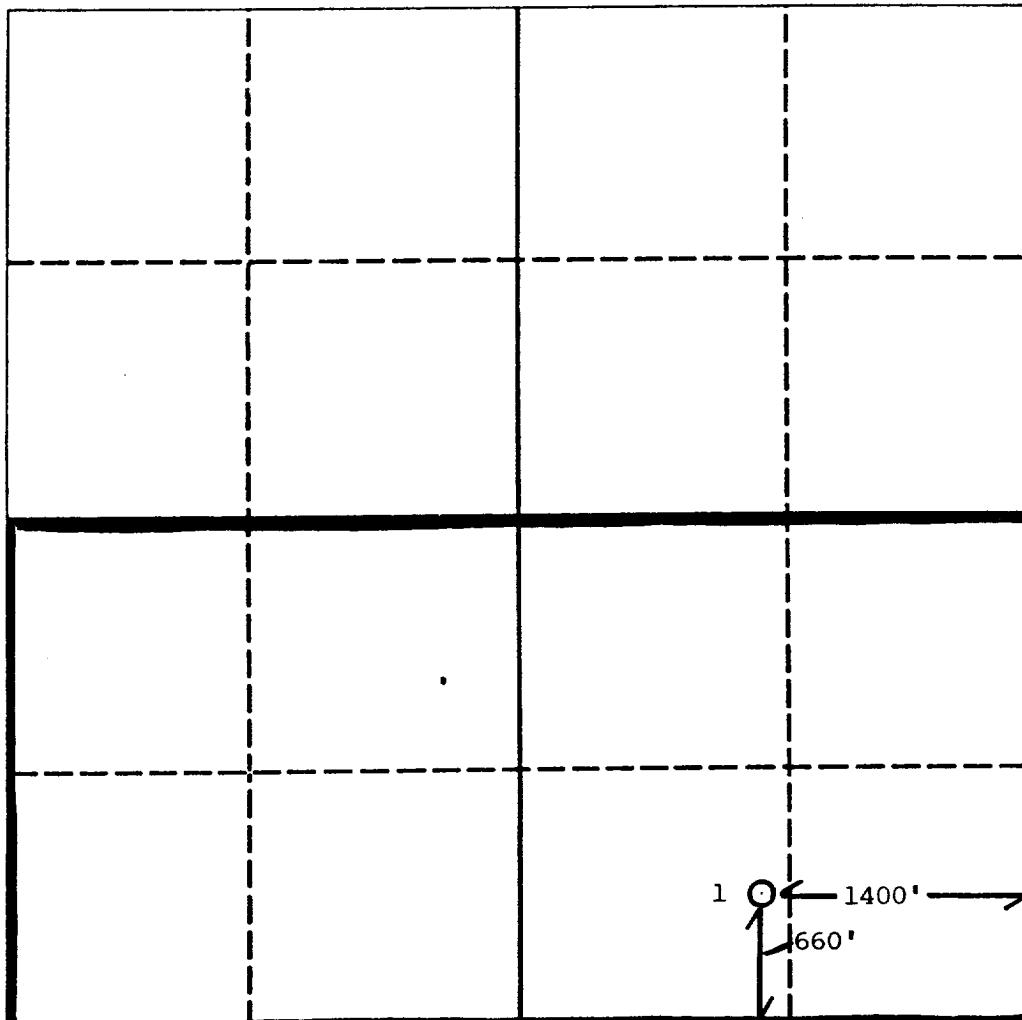

0 330 660 990 1320 1650 1980 2310 2640 2970 3300