

NEW MEXICO OIL CONSERVATION COMMISSION
WELL LOCATION AND ACREAGE DEDICATION PLAT

Form C-102
Supersedes C-128
Effective 1-1-65

All distances must be from the outer boundaries of the Section.

Operator PENNZOIL UNITED, INC.			Lease GULF FEDERAL		Well No. 2
Unit Letter L	Section 6	Township 23 SOUTH	Range 27 EAST	County EDDY	
Actual Footage Location of Well: 1980 feet from the SOUTH line and 990 feet from the WEST line					
Ground Level Elev. 3212.4	Producing Formation Morrow/Strawn	Pool South Carlsbad	Dedicated Acreage: 315.35 320 Acres		

1. Outline the acreage dedicated to the subject well by colored pencil or hatchure marks on the plat below.
2. If more than one lease is dedicated to the well, outline each and identify the ownership thereof (both as to working interest and royalty).
3. If more than one lease of different ownership is dedicated to the well, have the interests of all owners been consolidated by communitization, unitization, force-pooling, etc? *see per 4888 4-14-72*

☒ Yes ☐ No If answer is "yes," type of consolidation Communitization agreement being circulated for signatures.

If answer is "no," list the owners and tract descriptions which have actually been consolidated. (Use reverse side of this form if necessary.) _____

No allowable will be assigned to the well until all interests have been consolidated (by communitization, unitization, forced-pooling, or otherwise) or until a non-standard unit, eliminating such interests, has been approved by the Commission.

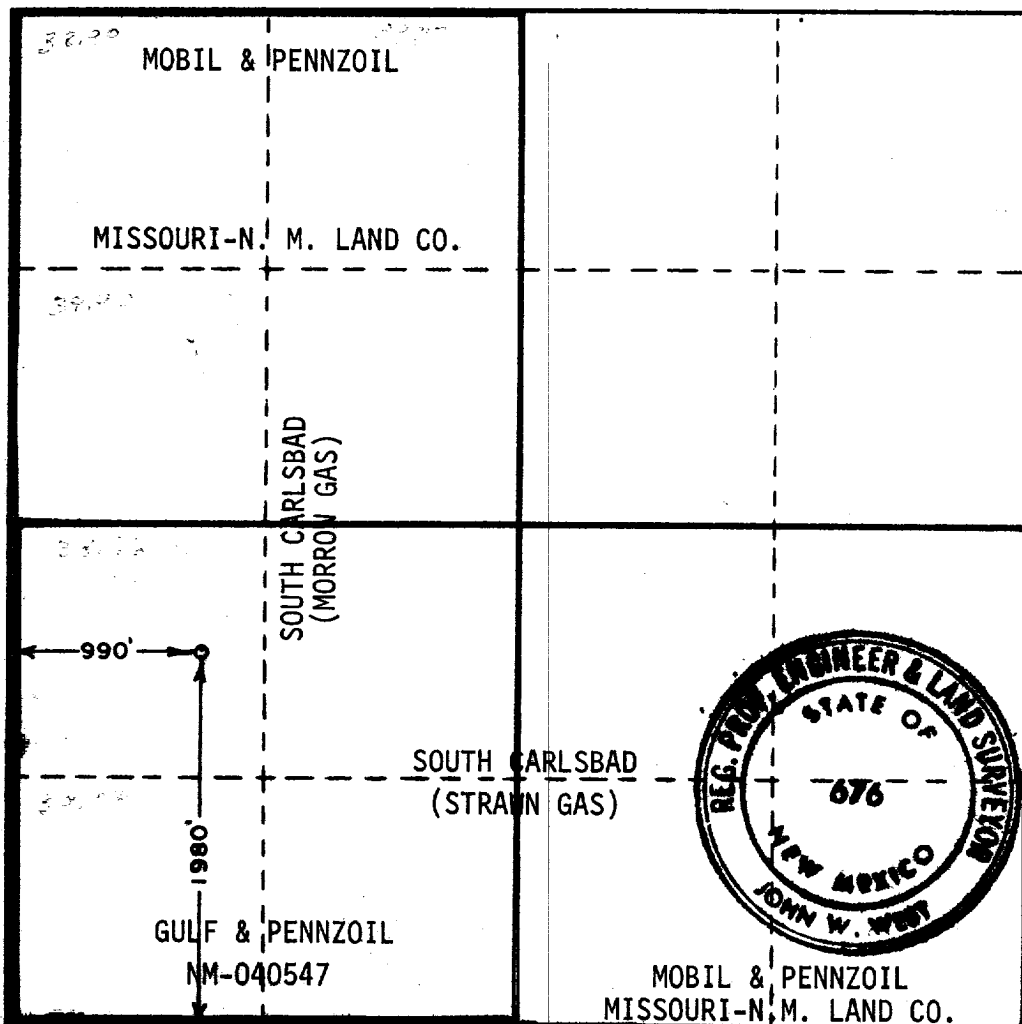

CERTIFICATION

I hereby certify that the information contained herein is true and complete to the best of my knowledge and belief.

Name *John W. West*

Position
Drilling Superintendent

Company
Pennzoil United, Inc.

Date
12-1-71

RECEIVED
I hereby certify that the location shown on this plat was plotted from field notes of actual surveys made by me or under my direct supervision and same is true and correct to the best of my knowledge and belief.
DEC 6 1971
U. S. GEOLOGICAL SURVEY
ARTESIA, NEW MEXICO

Date Surveyed

AUGUST 5, 1971

Registered Professional Engineer and/or Land Surveyor

John W. West

Certificate No.

676

