

N. M. O. C. G. S. COPY
UNITED STATES
DEPARTMENT OF THE INTERIOR
GEOLOGICAL SURVEYSUBMIT IN TRIPPLICATE*
(Other in reve. tions on ide)Form approved.
Budget Bureau No. 42-M-1422

30-015-20561

APPLICATION FOR PERMIT TO DRILL, DEEPEN, OR PLUG BACK

1a. TYPE OF WORK

DRILL ☒DEEPEN ☐PLUG BACK ☐

b. TYPE OF WELL

OIL
WELL ☐GAS
WELL ☒

OTHER

SINGLE
ZONEMULTIPLE
ZONE ☐

2. NAME OF OPERATOR

Atlantic Richfield Company

3. ADDRESS OF OPERATOR

P. O. Box 1978, Roswell, N.M. 88201

4. LOCATION OF WELL (Report location clearly and in accordance with any State requirements.)

At surface

1650' FNL & 1650' FEL Unit letter G

At proposed prod. zone

14. DISTANCE IN MILES AND DIRECTION FROM NEAREST TOWN OR POST OFFICE*

25 miles SW of Carlsbad, N.M.

10. DISTANCE FROM PROPOSED*
LOCATION TO NEAREST
PROPERTY OR LEASE LINE, FT.

(Also to nearest drlg. unit line, if any)

1650'

18. DISTANCE FROM PROPOSED LOCATION*

TO NEAREST WELL, DRILLING, COMPLETED,
OR APPLIED FOR, ON THIS LEASE, FT.

N/A

16. NO. OF ACRES IN LEASE

640

19. PROPOSED DEPTH

10500'

17. NO. OF ACRES ASSIGNED
TO THIS WELL

640

20. ROTARY OR CABLE TOOLS

Rotary

21. ELEVATIONS (Show whether DF, RT, GR, etc.)

To be reported

22. APPROX. DATE WORK WILL START*

1/1/72

23.

PROPOSED CASING AND CEMENTING PROGRAM

SIZE OF HOLE	SIZE OF CASING	WEIGHT PER FOOT	SETTING DEPTH	QUANTITY OF CEMENT
11"	8-5/8	24	2500	Circulate to surface
7-7/8"	5-1/2	15.5 & 17	10500	500 sx

We propose to drill a well as described above to test the producing capabilities of the Morrow-Penn formation. Two ram hydraulic BOP's will be used on all casing strings.

RECEIVED

DEC 17 1971

U.S. GEOLOGICAL SURVEY
ARTESIA, NEW MEXICO

IN ABOVE SPACE DESCRIBE PROPOSED PROGRAM: If proposal is to deepen or plug back, give data on present productive zone and proposed new productive zone. If proposal is to drill or deepen directionally, give pertinent data on subsurface locations and measured and true vertical depths. Give blowout preventer program, if any.

24.

SIGNED

O.D. Butcher

TITLE

Dist. Drlg. Supv.

DATE

12-16-71

(This space for Federal or State office use)

PERMIT NO.

APPROVED BY
CONDITIONS OF APPROVAL, IF ANY:APPROVED
JAN 3 - 1972
H. L. BEEKMAN
ACTING DISTRICT ENGINEERTHIS APPROVAL IS RESCINDED IF OPERATIONS
ARE NOT COMMENCED WITHIN 3 MONTHS.
APR 3 - 1972
*See Instructions On Reverse SideDECLARED WATER BASIN
CEMENT BEHIND THE
CASING MUST BE CIRCULATED
8 1/2NOTIFY USGS IN SUFFICIENT TIME TO
WITHIN CEMENTING THE CASING
8 1/2

NEW MEXICO OIL CONSERVATION COMMISSION
WELL LOCATION AND ACREAGE DEDICATION PLAT

Form C-102
Supersedes C-128
Effective 1-1-65

All distances must be from the outer boundaries of the Section.

Operator Atlantic Richfield Company			Lease W. G. Smith Federal Gas Com		Well No. 1
Unit Letter G	Section 13	Township 23-S	Range 24-E	County Eddy	
Actual Footage Location of Well: 1650 feet from the North line and 1650 feet from the East line					
Ground Level Elev. 	Producing Formation Morrow-Penn		Pool Rock Tank	Dedicated Acreage: 640 Acres	

1. Outline the acreage dedicated to the subject well by colored pencil or hachure marks on the plat below.
2. If more than one lease is dedicated to the well, outline each and identify the ownership thereof (both as to working interest and royalty).
3. If more than one lease of different ownership is dedicated to the well, have the interests of all owners been consolidated by communitization, unitization, force-pooling, etc?

☒ Yes ☐ No If answer is "yes," type of consolidation Communitization

If answer is "no," list the owners and tract descriptions which have actually been consolidated. (Use reverse side of this form if necessary.) _____

No allowable will be assigned to the well until all interests have been consolidated (by communitization, unitization, forced-pooling, or otherwise) or until a non-standard unit, eliminating such interests, has been approved by the Commission.

R-24-E

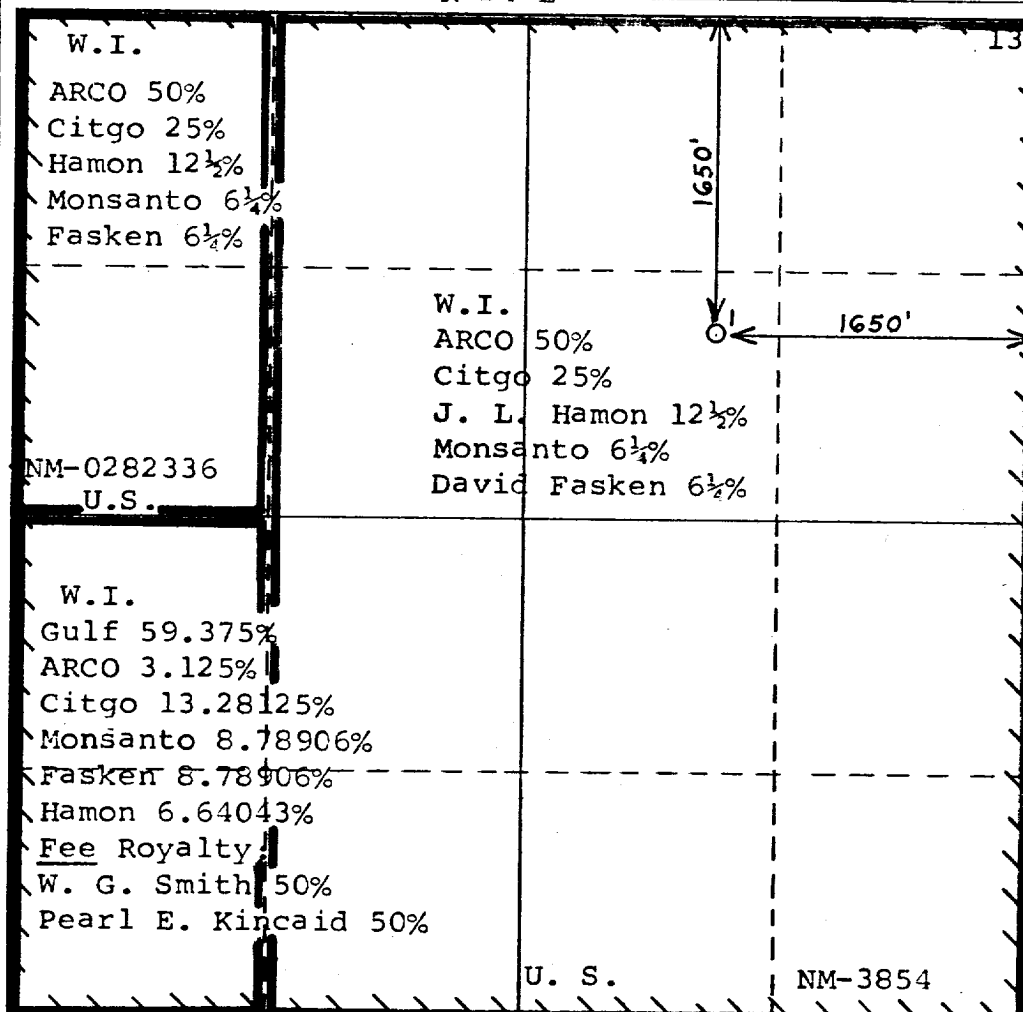

CERTIFICATION

I hereby certify that the information contained herein is true and complete to the best of my knowledge and belief.

O.D. Bretches

Name
O. D. Bretches
Position
Dist. Drlg. Supv.

Company
Atlantic Richfield Co.

Date
Dec. 14, 1971

RECEIVED
I hereby certify that the location shown on this plat was plotted from field notes of actual surveys made by me or under my supervision, and that the same is true and correct to the best of my knowledge and belief.

Date Surveyed
Dec 7 - 1971
Registered Professional Engineer and/or Land Surveyor

[Signature]

Certificate No.
648

T
23
S

0 330 660 990 1320 1650 1980 2310 2640 2000 1500 1000 500 0