

**MEXICO OIL CONSERVATION COMMISSION
WELL LOCATION AND ACREAGE DEDICATION PLAT**

RECEIVED

Form C-102
Supersedes C-128
Effective 1-1-65

MAR 22 1972

All distances must be from the outer boundaries of the Section.

Operator SKELLY OIL CO.			Lease CEDAR CANYON			Well No. 1		
Unit Letter P	Section 9	Township 24 SOUTH	Range 29 EAST	County EDDY				
Actual Footage Location of Well: 770 feet from the SOUTH line and 770 feet from the EAST line								
Ground Level Elev.		Producing Formation FUSSELMAN		Pool WILDCAT			Dedicated Acreage: 640 320 Acres	

**O.C.C.
ARTESIA, OFFICE**

1. Outline the acreage dedicated to the subject well by colored pencil or hatchure marks on the plat below.
2. If more than one lease is dedicated to the well, outline each and identify the ownership thereof (both as to working interest and royalty).
3. If more than one lease of different ownership is dedicated to the well, have the interests of all owners been consolidated by communitization, unitization, force-pooling, etc?

☐ Yes ☐ No If answer is "yes," type of consolidation _____

If answer is "no," list the owners and tract descriptions which have actually been consolidated. (Use reverse side of this form if necessary.) _____

No allowable will be assigned to the well until all interests have been consolidated (by communitization, unitization, forced-pooling, or otherwise) or until a non-standard unit, eliminating such interests, has been approved by the Commission.

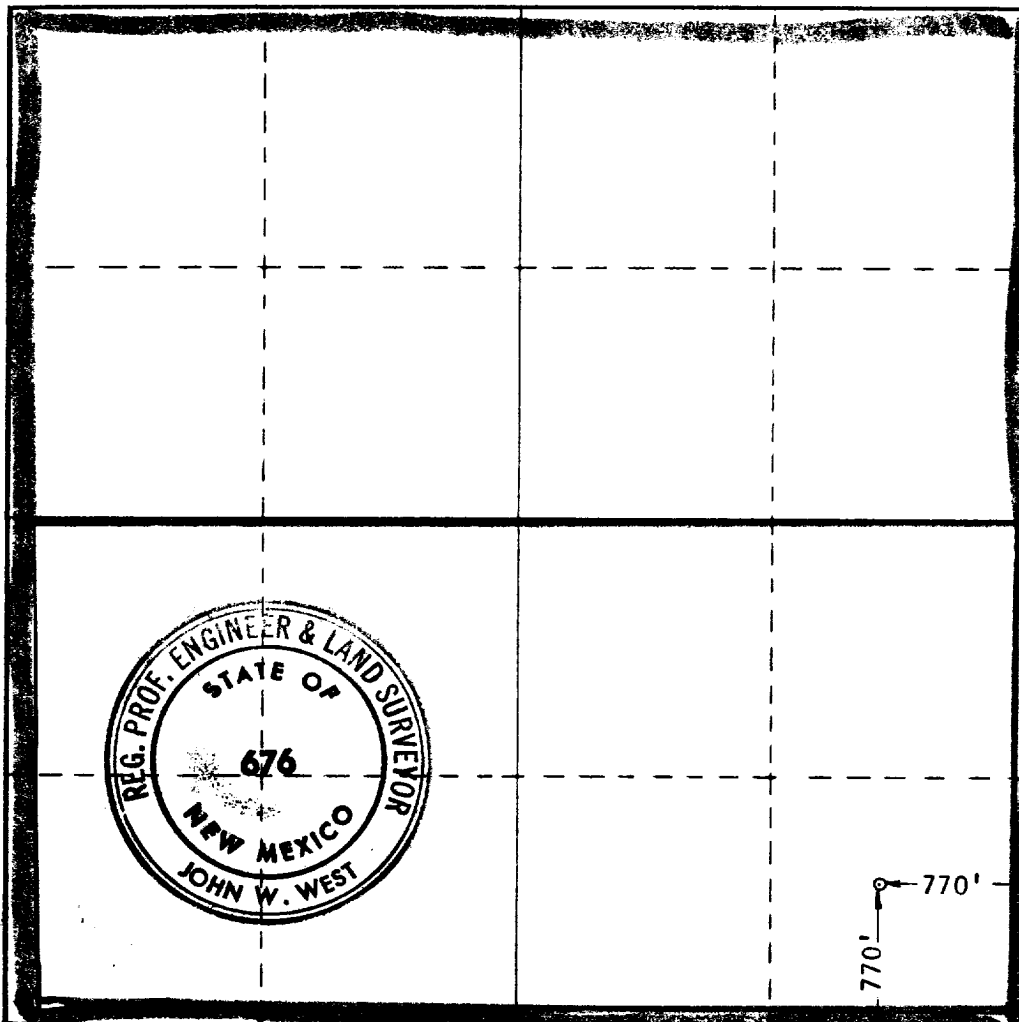

CERTIFICATION

I hereby certify that the information contained herein is true and complete to the best of my knowledge and belief.

Name W. R. Fickert
Position
AREA PRODUCTION FOREMAN
Company
SKELLY OIL COMPANY
Date
3-21-1972

I hereby certify that the well location shown on this plat was plotted from field notes of actual surveys made by me or under my supervision, and that the same is true and correct to the best of my knowledge and belief.

Date Surveyed
MARCH 17, 1972

Registered Professional Engineer and/or Land Surveyor

John W. West
Certificate No. **676**

