

NEW MEXICO OIL CONSERVATION COMMISSION
WELL LOCATION AND ACREAGE DEDICATION PLAT

RECEIVED

Form C-102
Supersedes C-128
Effective 1-1-65

OCT 17 1972

All distances must be from the outer boundaries of the Section.

Operator BELCO PETROLEUM CORPORATION			Lease UNION - MEAD Com		Well No. O. C. C. 2	
Unit Letter N	Section 4	Township 22 SOUTH	Range 27 EAST	County EDDY		

Actual Footage Location of Well:

1880 feet from the **WEST** line and **660** feet from the **SOUTH** line

Ground Level Elev. 3122.8'	Producing Formation Morrow	Pool Wildcat	Dedicated Acreage: 320 Acres
--------------------------------------	--------------------------------------	------------------------	--

1. Outline the acreage dedicated to the subject well by colored pencil or hachure marks on the plat below.
2. If more than one lease is dedicated to the well, outline each and identify the ownership thereof (both as to working interest and royalty).
3. If more than one lease of different ownership is dedicated to the well, have the interests of all owners been consolidated by communitization, unitization, force-pooling, etc?

☒ Yes ☐ No If answer is "yes," type of consolidation Communitization

If answer is "no," list the owners and tract descriptions which have actually been consolidated. (Use reverse side of this form if necessary.)

No allowable will be assigned to the well until all interests have been consolidated (by communitization, unitization, forced-pooling, or otherwise) or until a non-standard unit, eliminating such interests, has been approved by the Commission.

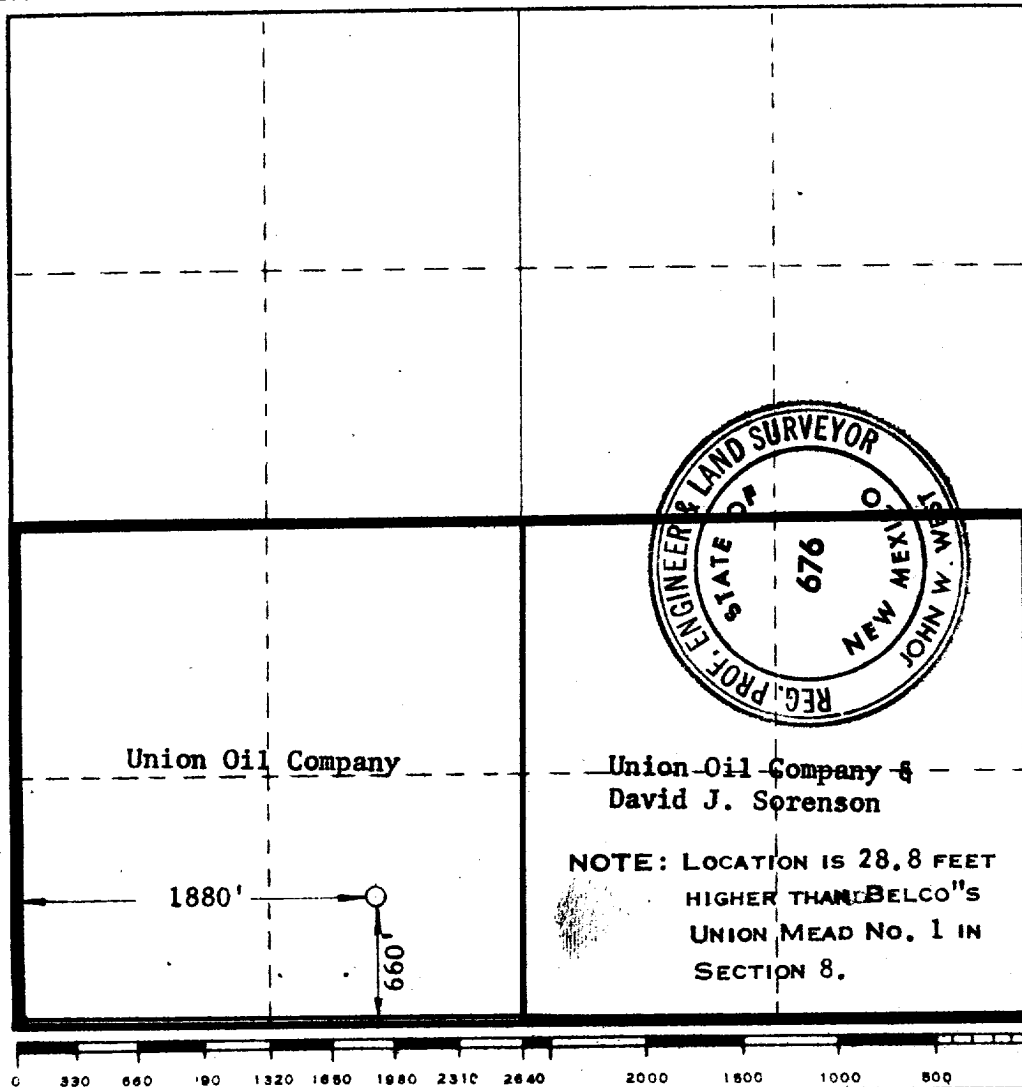

CERTIFICATION

I hereby certify that the information contained herein is true and complete to the best of my knowledge and belief.

Glenn Cope

Name

Glenn Cope

Position

District Engineer

Company

Belco Petroleum Corporation

Date

October 12, 1972

I hereby certify that the well location shown on this plat was plotted from field notes of actual surveys made by me or under my supervision, and that the same is true and correct to the best of my knowledge and belief.

Date Surveyed

OCTOBER 7, 1972

Registered Professional Engineer and/or Land Surveyor

John W. West

Certificate No.

676