

MEXICO OIL CONSERVATION COMMISSION
WELL LOCATION AND ACREAGE DEDICATION PLAT

RECEIVED

DEC 29 1972

All distances must be from the outer boundaries of the Section

Operator BELCO PETROLEUM CORP.			Lease UNION-MEAD			Office ARTESIA, OFFICE 3		
Unit Letter J	Section 5	Township 22 SOUTH	Range 27 EAST	County EDDY				
Actual Footage Location of Well:								
1980 feet from the SOUTH line and			1980 feet from the EAST line					
Ground Level Elev. 3158.6'	Producing Formation Morrow		Pool Undesignated			Elevation of Top of Pool 320.48'		

1. Outline the acreage dedicated to the subject well by colored pencil or hachure marks on the plat below.
2. If more than one lease is dedicated to the well, outline each and identify the ownership thereof (both as to working interest and royalty).
3. If more than one lease of different ownership is dedicated to the well, have the interests of all owners been consolidated by communitization, unitization, force-pooling, etc?

☒ Yes ☐ No If answer is "yes," type of consolidation Communitization

If answer is "no," list the owners and tract descriptions which have actually been consolidated. (Use reverse side of this form if necessary.)

No allowable will be assigned to the well until all interests have been consolidated (by communitization, unitization, forced-pooling, or otherwise) or until a non-standard unit, eliminating such interests, has been approved by the Commission.

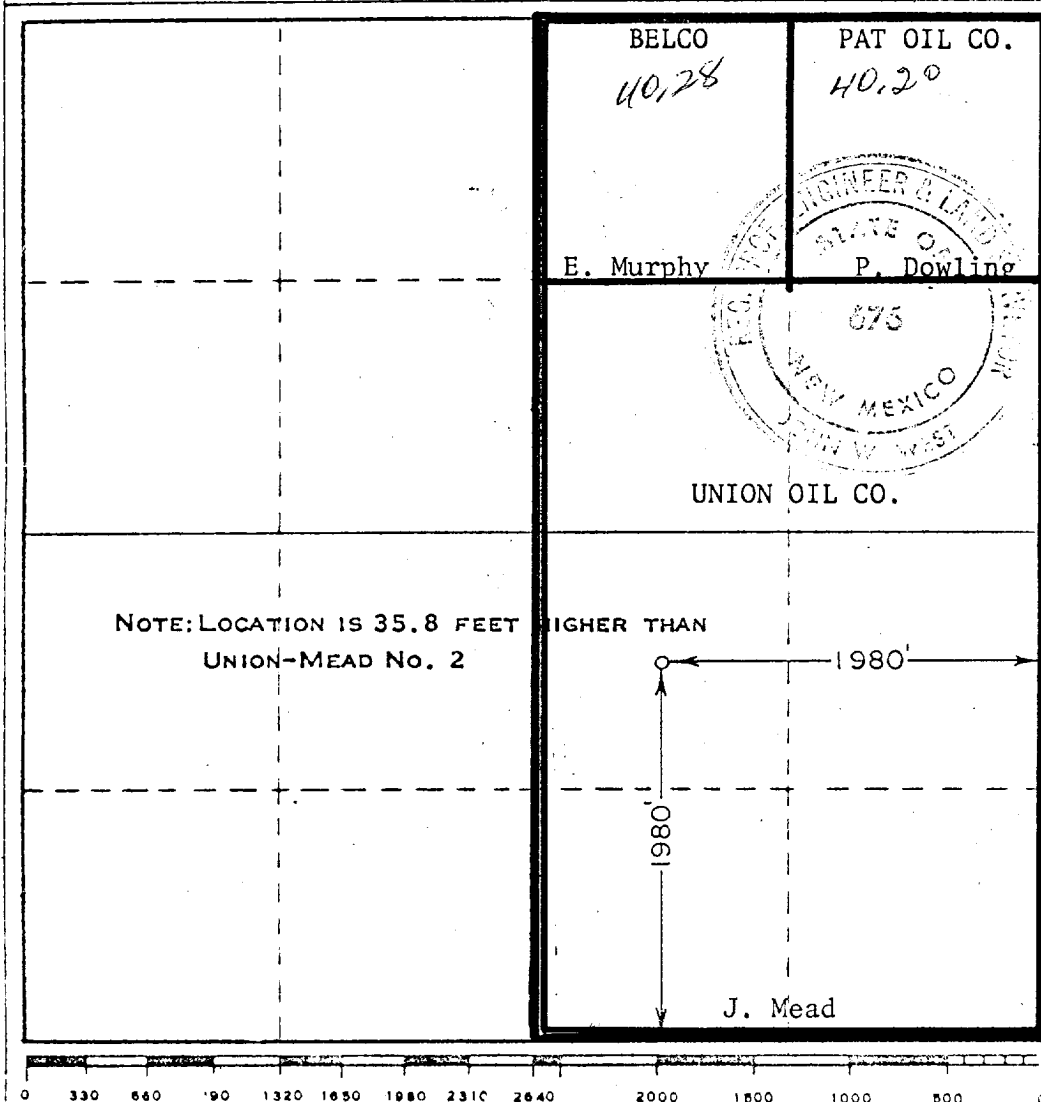

CERTIFICATION

I hereby certify that the information contained herein is true and complete to the best of my knowledge and belief.

Glenn Cope

Glenn Cope

District Engineer

Belco Petroleum Corporation

December 28, 1972

I hereby certify that the well location shown on this plat was plotted from field notes of actual surveys made by me or under my supervision, and that the same is true and correct to the best of my knowledge and belief.

Date Surveyed

DECEMBER 18, 1972

Registered Professional Engineer and/or Land Surveyor

John W. West

Certificate No.

676