

MEXICO OIL CONSERVATION COMMISSION
WE LOCATION AND ACREAGE DEDICATION PLAT

Form C-102
 Supersedes C-128
 Effective 1-1-65

All distances must be from the outer boundaries of the Section.

Operator BELCO Development CORP.			Lease UNION-MEAD Com		Well No. 3
Unit Letter J	Section 5	Township 22 SOUTH	Range 27 EAST	County EDDY	
Actual Footage Location of Well: 1980 feet from the SOUTH line and 1980 feet from the EAST line Ground Level Elev. 3158.6' Producing Formation Atoka/Strawn Pool Carlsbad, S. Dedicated Acreage: East $\frac{1}{2}$ 320 Acres					

1. Outline the acreage dedicated to the subject well by colored pencil or hachure marks on the plat below.
2. If more than one lease is dedicated to the well, outline each and identify the ownership thereof (both as to working interest and royalty).
3. If more than one lease of different ownership is dedicated to the well, have the interests of all owners been consolidated by communitization, unitization, force-pooling, etc?
☐ Yes ☐ No If answer is "yes," type of consolidation _____

If answer is "no," list the owners and tract descriptions which have actually been consolidated. (Use reverse side of this form if necessary.) _____

No allowable will be assigned to the well until all interests have been consolidated (by communitization, unitization, forced-pooling, or otherwise) or until a non-standard unit, eliminating such interests, has been approved by the Commission.

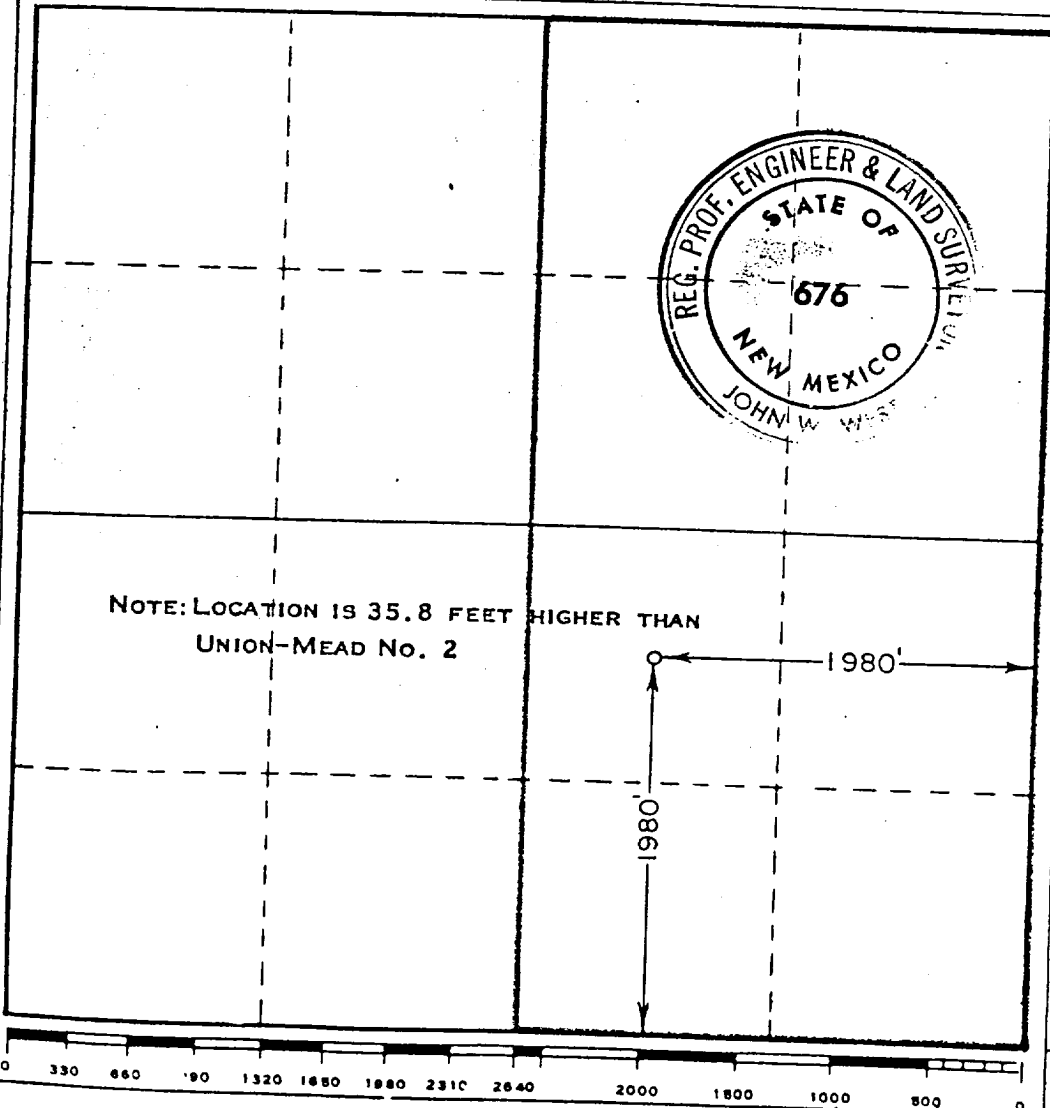

CERTIFICATION

I hereby certify that the information contained herein is true and complete to the best of my knowledge and belief.

Betty Gildon
 Name

Betty Gildon
 Position

Regulatory Analyst
 Company

Belco Development Corporation
 Date

9/11/86

I hereby certify that the well location shown on this plat was plotted from field notes of actual surveys made by me or under my supervision, and that the same is true and correct to the best of my knowledge and belief.

Date Surveyed

DECEMBER 18, 1972

Registered Professional Engineer and/or Land Surveyor

John W. West
 Certificate No.

676