

NEW MEXICO OIL CONSERVATION COMMISSION
WELL LOCATION AND ACREAGE DEDICATION PLAT

RECEIVED
Form C-102
Supersedes C-128
Effective 1-1-65

All distances must be from the outer boundaries of the Section.

JAN 29 1973

Operator BELCO PETROLEUM CORP.			Lease JAMES RANCH UNIT			Well No. 4		
Unit Letter L	Section 6	Township 23 SOUTH	Range 31 EAST	County ARTESIA, OFFICE EDDY				
Actual Footage Location of Well: 1980 feet from the SOUTH line and 660 feet from the WEST line								
Ground Level Elev. 3296.0'		Producing Formation MORROW		Pool Undesignated			Dedicated Acreage: 323.29 320 Acres	

1. Outline the acreage dedicated to the subject well by colored pencil or hachure marks on the plat below.
2. If more than one lease is dedicated to the well, outline each and identify the ownership thereof (both as to working interest and royalty).
3. If more than one lease of different ownership is dedicated to the well, have the interests of all owners been consolidated by communitization, unitization, force-pooling, etc?

☒ Yes ☐ No If answer is "yes," type of consolidation **James Ranch Unit**

If answer is "no," list the owners and tract descriptions which have actually been consolidated. (Use reverse side of this form if necessary.) _____

No allowable will be assigned to the well until all interests have been consolidated (by communitization, unitization, forced-pooling, or otherwise) or until a non-standard unit, eliminating such interests, has been approved by the Commission.

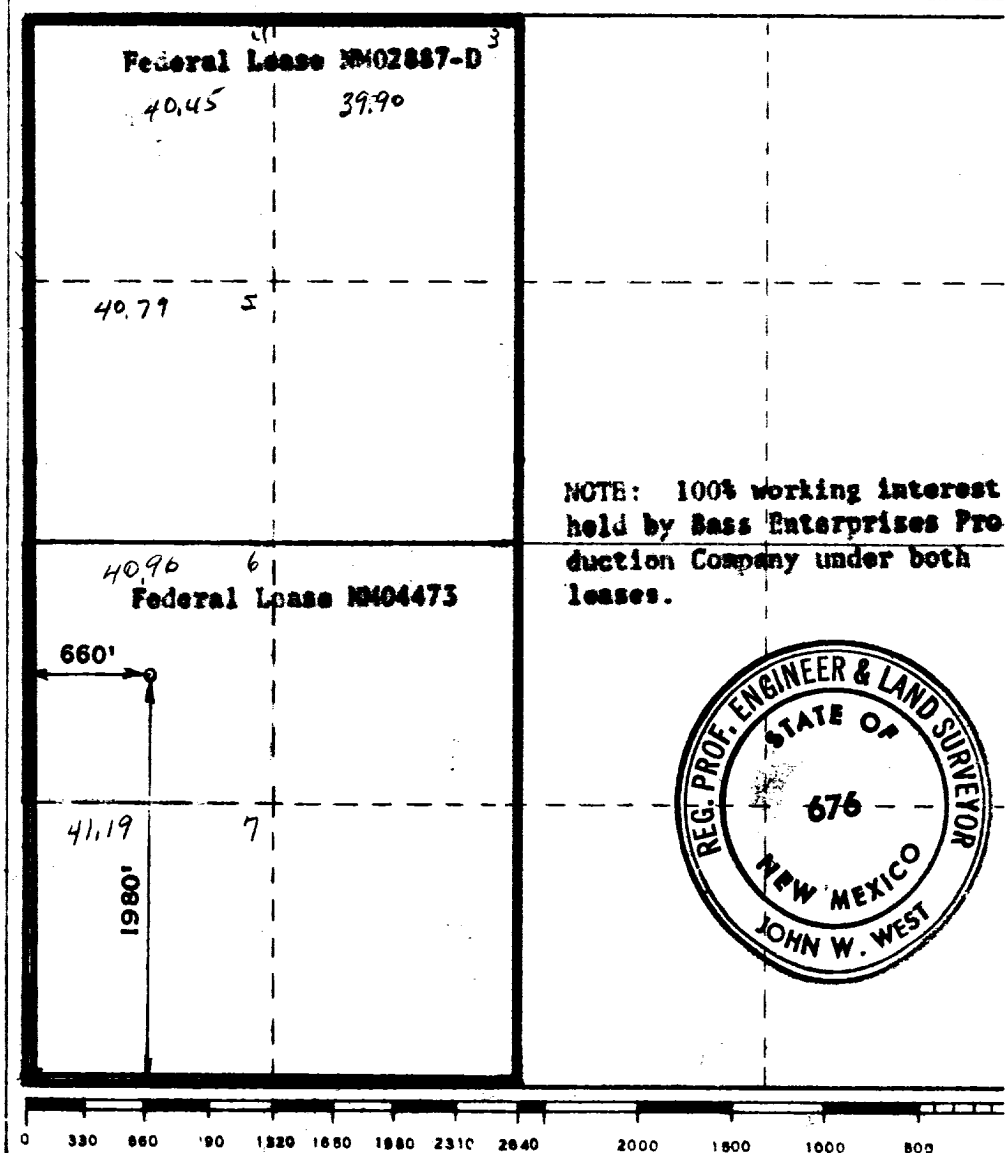

CERTIFICATION

I hereby certify that the information contained herein is true and complete to the best of my knowledge and belief.

Glenm Cope

Name

Glenm Cope

Position

District Engineer

Company

Belco Petroleum Corporation

Date

January 16, 1973

I hereby certify that the location shown on this plat is based on field notes and surveys made by me or under my supervision and that the same is true and correct to the best of my knowledge.

RECEIVED JAN 19 1973 D. E. GOLDMAN SURVEY ARTESIA, NEW MEXICO

Date Surveyed

JANUARY 10, 1973

Registered Professional Engineer and/or Land Surveyor

John W. West

Certificate No.

676