

NEW MEXICO OIL CONSERVATION COMMISSION  
WELL LOCATION AND ACREAGE DEDICATION PLAT

Form C-112  
Supersedes C-128  
Effective 1-1-65

All distances must be from the outer boundaries of the Section

Lessee <b>ADOBE OIL CO.</b>		Owner <i>Smith</i> <b>FEDERAL #</b>		Well No. <b>12</b>
Section <b>P</b>	Quarter <b>II</b>	Township <b>23 SOUTH</b>	Range <b>24 EAST</b>	County <b>EDDY</b>
State Well Location of Well:				
660 feet from the <b>SOUTH</b> line of the		330 feet from the <b>EAST</b> line of the		
Well Level Elev. <b>3873.7</b>	Forming Formation <b>Lower Morrow</b>	Rock <b>Rock Tank Lower Morrow</b>	Section Well Acreage <b>430</b>	

1. Outline the acreage dedicated to the subject well by colored pencil or hatchure marks on the plat below.
2. If more than one lease is dedicated to the well, outline each and identify the ownership thereof (both as to working interest and royalty).
3. If more than one lease of different ownership is dedicated to the well, have the interests of all owners been consolidated by communitization, unitization, force pooling, etc?

☐ Yes ☐ No If answer is "yes" type of consolidation \_\_\_\_\_

If answer is "no," list the owners and tract descriptions which have actually been consolidated (Use reverse side of this form if necessary.) \_\_\_\_\_

No allowable will be assigned to the well until all interests have been consolidated (by communitization, unitization, forced-pooling, or otherwise) or until a non-standard unit, eliminating such interests, has been approved by the Commission.

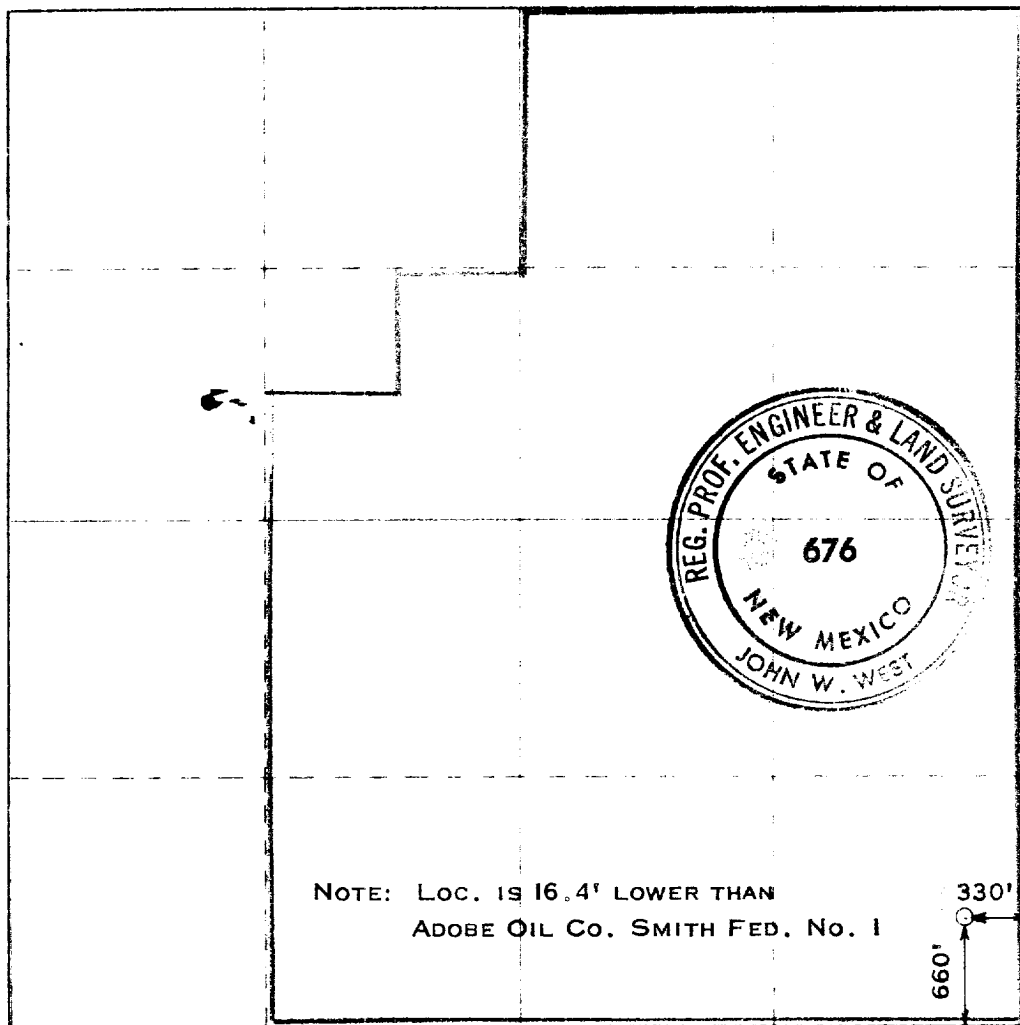

CERTIFICATION

I hereby certify that the information contained herein is true and complete to the best of my knowledge and belief.

*M. D. Rogers*

**M. D. Rogers  
Vice President**

**Adobe Oil Company**

**January 12, 1973**

I hereby certify that the well location shown on this plat was plotted from field notes of actual surveys made by me or under my supervision and that the same is true and correct to the best of my knowledge and belief.

*John W. West*

**JANUARY 9, 1973**

Registered Professional Land Surveyor  
State of New Mexico

*John W. West*  
676