

UNITED STATES
DEPARTMENT OF THE INTERIOR
BUREAU OF LAND MANAGEMENT

FORM APPROVED
Budget Bureau No. 1004-0136
Expires: December 31, 1991

SUBMIT IN TRIPLICATE

APPLICATION FOR PERMIT TO DRILL OR DEEPEN

1a. Type of Work ☒ DRILL ☐ DEEPEN
1b. Type of Well ☐ SINGLE ZONE ☐ MULTIPLE ZONE
OIL WELL ☐ GAS WELL ☒ OTHER RECOMPLETION

2. Name of Operator TEXACO EXPLORATION & PRODUCTION INC.
3. Address and Telephone No. 205 E. Bender, HOBBS, NM 88240 397-0405

4. Location of Well (Report location clearly and in accordance with any State requirements.)
At Surface Unit Letter G : 2310 Feet From The NORTH Line and 1650 Feet From The EAST Line
At proposed prod. zone

14. Distance In Miles and Direction from Nearest Town or Post Office*

15. Distance From Proposed* Location to Nearest Property or Lease Line, Ft. (also to nearest drlg. unit line, if any)

18. Distance From Proposed Location* to Nearest Well, Drilling, Completed or Applied For, On This Lease, Ft.

21. Elevations (Show whether DF, RT, GR, etc.)
GL-3435', KB-3459'

5. Lease Designation and Serial No.
LC-065457

6. If Indian, Alottee or Tribe Name

7. If Unit or CA, Agreement Designation

8. Well Name and Number
GATES, J. M. FEDERAL NCT-1

9. API Well No.
30 015 20821

10. Field and Pool, Exploratory Area
WILDCAT DELAWARE

11. SEC., T., R., M., or BLK. and Survey or Area
Sec. 30, Township 24S, Range 26E

12. County or Parish EDDY 13. State NEW MEXICO

17. No. of Acres Assigned To This Well

20. Rotary or Cable Tools

22. Approx. Date Work Will Start*
4/1/01

23 PROPOSED CASING AND CEMENT PROGRAM

SIZE OF HOLE	GRADE, SIZE OF CASING	WEIGHT PER FOOT	SETTING DEPTH	QUANTITY OF CEMENT
13 3/8"	48#	54.5#	1615'	1725 SX
9 5/8"	40#	43.5#	8385'	1650 SX
4 1/2"	11.6#	13.5	11,443'	800 SX

TEXACO INTENDS TO RECOMLETE THE SUBJECT WELL IN THE DELAWARE. THE INTENDED PROCEDURE IS AS FOLLOWS:

- 1) MIRU PU. NUBOP. REL PKR. TIH W/CIBP & SET @ 10,260'. DUMP 35' CMT ON CIBP.
- 2) TIH W/RBP & SET @ 7150'. CUT CSG, DUMP SAND TO FILL CSG ABOVE RBP.
- 3) TIH W/RBP & SET @ 6000. DUMP 30' SAND ON RBP.
- 4) PERF 4877-4910'. TIH W/PKR & SET @ 4825'.
- 5) SPOT ACID TO 4875' & ACIDIZE DELAWARE W/2000 GALS 15% HCL. FRAC DELAWARE FORM W/40 M#, 20/40 SAND.
- 6) REL PKR. TIH W/PROD TBG & RD STRING. SET SN @ 4950 W/3 JTS TP. SET UNIT & PLACE WELL ON PUMP TEST.

In Above Space Describe Proposed Program: If proposal is to deepen, give data on present productive zone and proposed new productive zone. If proposal is to drill or deepen directionally, give pertinent data on subsurface locations and measured true verticle depths. Give blowout preventer program, if any.

24. I hereby certify that the foregoing is true and correct

SIGNATURE J. Denise Leake TITLE Engineering Assistant DATE 3/5/01

TYPE OR PRINT NAME J. Denise Leake

(This space for Federal or State office use)

PERMIT NO. APPROVAL DATE

Application approval does not warrant or certify that the applicant holds legal or equitable title to those rights in the subject lease which would entitle the applicant to conduct operations thereon.

APPROVED

CONDITIONS OF APPROVAL, IF ANY: TITLE DATE

Title 18 U.S.C. Section 1001, makes it a crime for any person knowingly and willfully to make to any department or agency of the United States any false, fictitious or fraudulent statements or representations as to any matter within its jurisdiction.

UNITED STATES
DEPARTMENT OF THE INTERIOR
BUREAU OF LAND MANAGEMENT

FORM APPROVED
Budget Bureau No. 1004-0135
Expires: March 31, 1993

SUNDRY NOTICES AND REPORTS ON WELLS

Do not use this form for proposals to drill or to deepen or reentry to a different reservoir.

Use "APPLICATION FOR PERMIT --" for such proposals

SUBMIT IN TRIPLICATE

1. Type of Well: ☐ OIL WELL ☒ GAS WELL ☐ OTHER

2. Name of Operator
TEXACO EXPLORATION & PRODUCTION INC.

3. Address and Telephone No. 205 E. Bender, HOBBS, NM 88240 397-0405

4. Location of Well (Footage, Sec., T., R., M., or Survey Description)
Unit Letter G : 2310 Feet From The NORTH Line and 1650 Feet From The
EAST Line Section 30 Township 24S Range 26E

5. Lease Designation and Serial No.
LC-065457

6. If Indian, Alottee or Tribe Name

7. If Unit or CA, Agreement Designation

8. Well Name and Number
GATES, J. M. FEDERAL NCT-1

9. API Well No.
30 015 20821

10. Field and Pool, Exploratory Area
WILDCAT DELAWARE

11. County or Parish, State
EDDY, NEW MEXICO

12. Check Appropriate Box(s) To Indicate Nature of Notice, Report, or Other Data

TYPE OF SUBMISSION

☒ Notice of Intent
☐ Subsequent Report
☐ Final Abandonment Notice

TYPE OF ACTION

☐ Abandonment
☒ Recompletion
☐ Plugging Back
☐ Casing Repair
☐ Altering Casing
☒ OTHER: RECOMPLETE TO DELAWARE

☐ Change of Plans
☐ New Construction
☐ Non-Routine Fracturing
☐ Water Shut-Off
☐ Conversion to Injection
☐ Dispose Water

(Note: Report results of multiple completion on Well Completion or Recompletion Report and Log (Form 3160-5))

13. Describe Proposed or Completed Operations (Clearly state all pertinent details, and give pertinent dates, including estimated date of starting any proposed work. If well is directionally drilled, give subsurface locations and measured and true vertical depths for all markers and zones pertinent to this work.)

TEXACO INTENDS TO RECOMPLETE THE SUBJECT WELL IN THE DELAWARE. THE INTENDED PROCEDURE IS AS FOLLOWS:

- 1) MIRU PU. NUBOP. REL PKR. TIH W/CIBP & SET @ 10,260'. DUMP 35' CMT ON CIBP.
- 2) TIH W/RBP & SET @ 7150'. CUT CSG, DUMP SAND TO FILL CSG ABOVE RBP.
- 3) TIH W/RBP & SET @ 6000. DUMP 30' SAND ON RBP.
- 4) PERF 4877-4910'. TIH W/PKR & SET @ 4825'.
- 5) SPOT ACID TO 4875' & ACIDIZE DELAWARE W/2000 GALS 15% HCL. FRAC DELAWARE FORM W/40 M3 20/40 SAND.
- 6) REL PKR. TIH W/PROD TBG & RD STRING. SET SN @ 4950 W/3 JTS TP. SET UNIT & PLACE WELL ON PUMP TEST.

14. I hereby certify that the foregoing is true and correct

SIGNATURE J. Denise Leake TITLE Engineering Assistant

DATE 3/5/01

TYPE OR PRINT NAME J. Denise Leake

(This space for Federal or State office use)

APPROVED

CONDITIONS OF APPROVAL IF ANY:

TITLE

DATE

Title 18 U.S.C. Section 1001, makes it a crime for any person knowingly and willfully to make to any department or agency of the United States any false, fictitious or fraudulent statements or representations as to any matter within its jurisdiction.

DISTRICT I

P.O. Box 1980, Hobbs, NM 88241-1980

DISTRICT II

P.O. Box Drawer DD, Artesia, NM 88211-0719

DISTRICT III

1000 Rio Brazos Rd., Aztec, NM 87410

DISTRICT IV

P.O. Box 2088, Santa Fe, NM 87504-2088

State of New Mexico
Energy, Minerals and Natural Resources Depa. nt

OIL CONSERVATION DIVISION

P.O. Box 2088
Santa Fe, New Mexico 87504-2088

Form C-102

Revised February 10, 1999

Instructions on back

Submit to Appropriate District Office

State Lease - 4 Copie

Fee Lease - 3 Copie

☒ AMENDED REPORT

WELL LOCATION AND ACREAGE DEDICATION PLAT

1 API Number 30 015 20821	2 Pool Code	3 Pool Name WILDCAT DELAWARE
4 Property Code	5 Property Name GATES, J. M. FEDERAL NCT-1	6 Well No. 1
7 OGRID Number 022351	8 Operator Name TEXACO EXPLORATION & PRODUCTION INC.	9 Elevation GL-3435', KB-3459'

10 Surface Location

UI or lot no	Section	Township	Range	Lot.Idn	Feet From The	North/South Line	Feet From The	East/West Line	County
G	30	24S	26E		2310	NORTH	1650	EAST	EDDY

11 Bottom Hole Location If Different From Surface

UI or lot no	Section	Township	Range	Lot.Idn	Feet From The	North/South Line	Feet From The	East/West Line	County
--------------	---------	----------	-------	---------	---------------	------------------	---------------	----------------	--------

12 Dedicated Acre 160	13 Joint or Infill No	14 Consolidation Code	15 Order No.
--------------------------	--------------------------	-----------------------	--------------

NO ALLOWABLE WILL BE ASSIGNED TO THIS COMPLETION UNTIL ALL INTERESTS HAVE BEEN CONSOLIDATED
OR A NON-STANDARD UNIT HAS BEEN APPROVED BY THE DIVISION

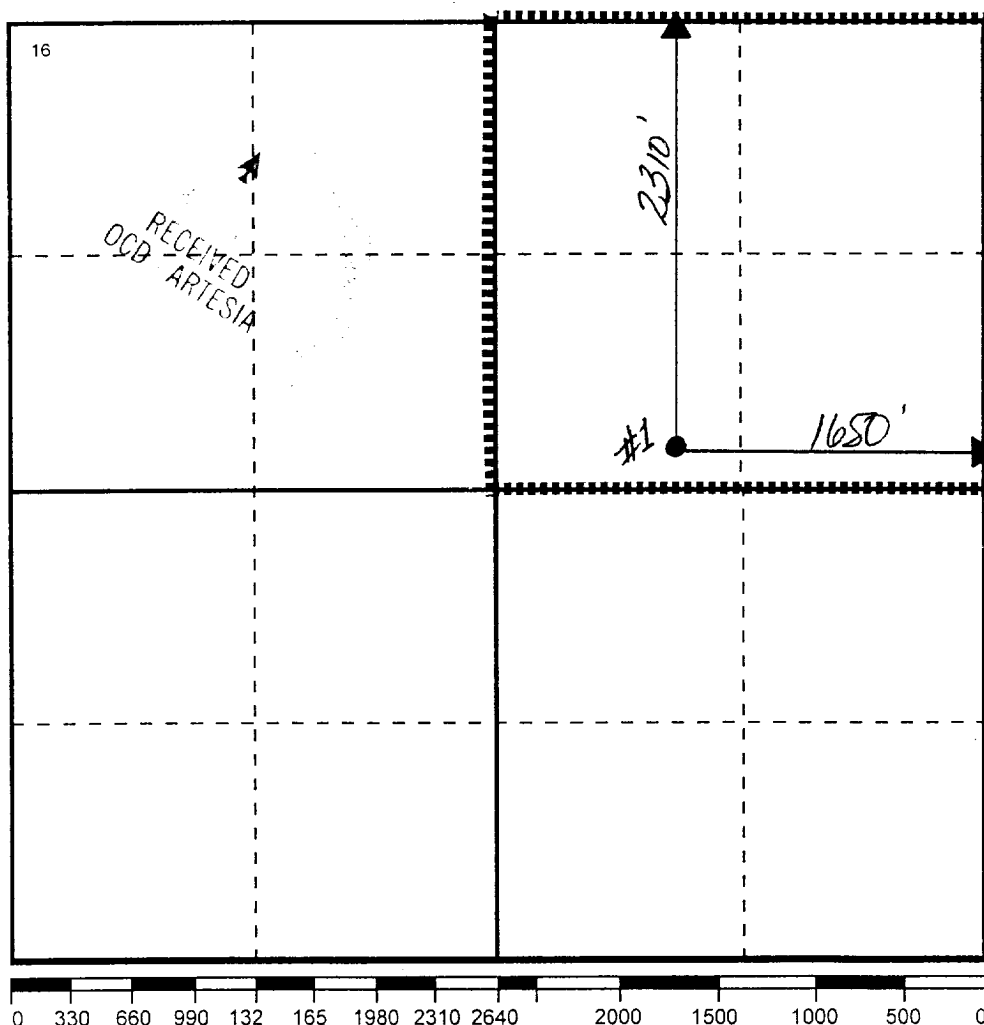

17 OPERATOR CERTIFICATION

I hereby certify that the information
contained herein is true and complete to the
best of my knowledge and belief

Signature

J. Denise Leake

Printed Name

J. Denise Leake

Positio

Engineering Assistant

Date

3/5/01

18 SURVEYOR CERTIFICATION

I hereby certify that the well location shown
on this plat was plotted from field notes of
actual surveys made by me or under my
supervision, and that the same is true and
correct to the best of my knowledge and
belief.

Date Surveyed

Signature & Seal of

Professional Surveyor

Certificate No.

JMI Gates Federal NC 1-1 #1

2310' FNL, 1650' FEL
SEC 30, TWN 24 S, RANGE 26 E
EDDY COUNTY, NEW MEXICO
API Well #: 30 015 20821

UPDATED 2/16/01

PROPOSED

ELEVATION : 3435 GL; KB: 3459
COMPLETION DATE : 5-73

Proposed Delaware Perfs:

4,877 - 4,910', 4 spf, 120° phasing

Proposed:

30' of Sand on RBP
9 5/8" RBP @ 6,000'

Proposed:

Sand to cover 4 1/2" Top by 10'
Top of 4 1/2" Csg @ +/- 7,100'
4 1/2" RBP @ 7,150'

Morrow & Atoka Perfs:

10,310 - 11,777' PERFS, 2 SPF (5/73)

11,340 - 11,337' PERFS, 2 SPF (5/73)

0 - 1615', 17.5" OD HOLE

13 3/8", 48# & 54.5#, SURF CSG
SET @ 1615' w/ 1725 sxs cmt, Circ'd

0 - 8385', 12 1/4" OD HOLE

9 5/8", 40#, 43.5# & 47#, Int.Csg
SET @ 8385' w/ 1650 sxs cmt, TOC @ 850 by TS.

0 - 11,450', 7 7/8" OD HOLE

4 1/2" CIBP set @ 10,260' w/ 35' cmt cap

4 1/2", 11.6# & 13.5# N-80 CSG SET @ 11,443'
w/ 800 sxs cmt, TOC @ 7,100' by T.S.

PBTD: 11,443'