

/ MEXICO OIL CONSERVATION COMMISSION
WELL LOCATION AND ACREAGE DEDICATION PLAT

Form C-102
Supersedes C-128
Effective 1-1-65

All distances must be from the outer boundaries of the Section.

Operator Hanagan Petroleum Corporation			Lease Squaw		Well No. 1
Unit Letter F	Section 12	Township 23 South	Range 25 East	County Eddy	
Actual Footage Location of Well: <div style="display: flex; justify-content: space-between;"> 1980 feet from the North line and 1980 feet from the West line </div>					
Ground Level Elev. 3524	Producing Formation Morrow	Pool Undesignated		Dedicated Acreage: 320 Acres	

1. Outline the acreage dedicated to the subject well by colored pencil or hachure marks on the plat below.
2. If more than one lease is dedicated to the well, outline each and identify the ownership thereof (both as to working interest and royalty).
3. If more than one lease of different ownership is dedicated to the well, have the interests of all owners been consolidated by communitization, unitization, force-pooling, etc?

☐ Yes ☐ No If answer is "yes," type of consolidation _____

If answer is "no," list the owners and tract descriptions which have actually been consolidated. (Use reverse side of this form if necessary.) _____

No allowable will be assigned to the well until all interests have been consolidated (by communitization, unitization, forced-pooling, or otherwise) or until a non-standard unit, eliminating such interests, has been approved by the Commission.

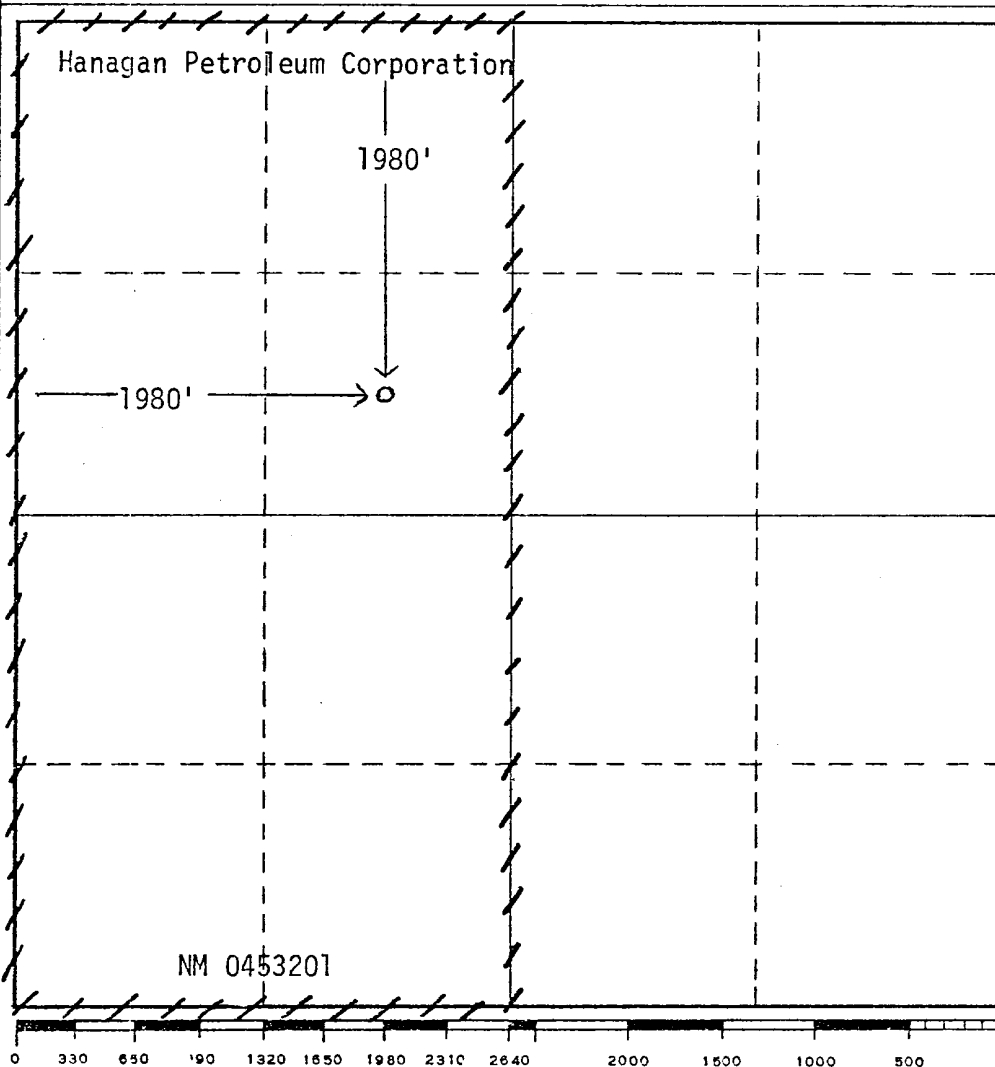

CERTIFICATION

I hereby certify that the information contained herein is true and complete to the best of my knowledge and belief.

Hugh E. Hanagan
Name
Hugh E. Hanagan

Position
Vice President

Company
Hanagan Petroleum Corporation

Date
10/16/73

I hereby certify that the well location shown on this plat was based on field notes of actual surveys made by me or under my supervision and that the same is true and correct to the best of my knowledge and belief.

RECEIVED
OCT 18 1973
U.S. GEOLOGICAL SURVEY
ARTESIA, NEW MEXICO
Oct. 10, 1973

Date Surveyed
[Signature]
Registered Professional Engineer
and/or Land Surveyor

N. M. 220

Certificate No.

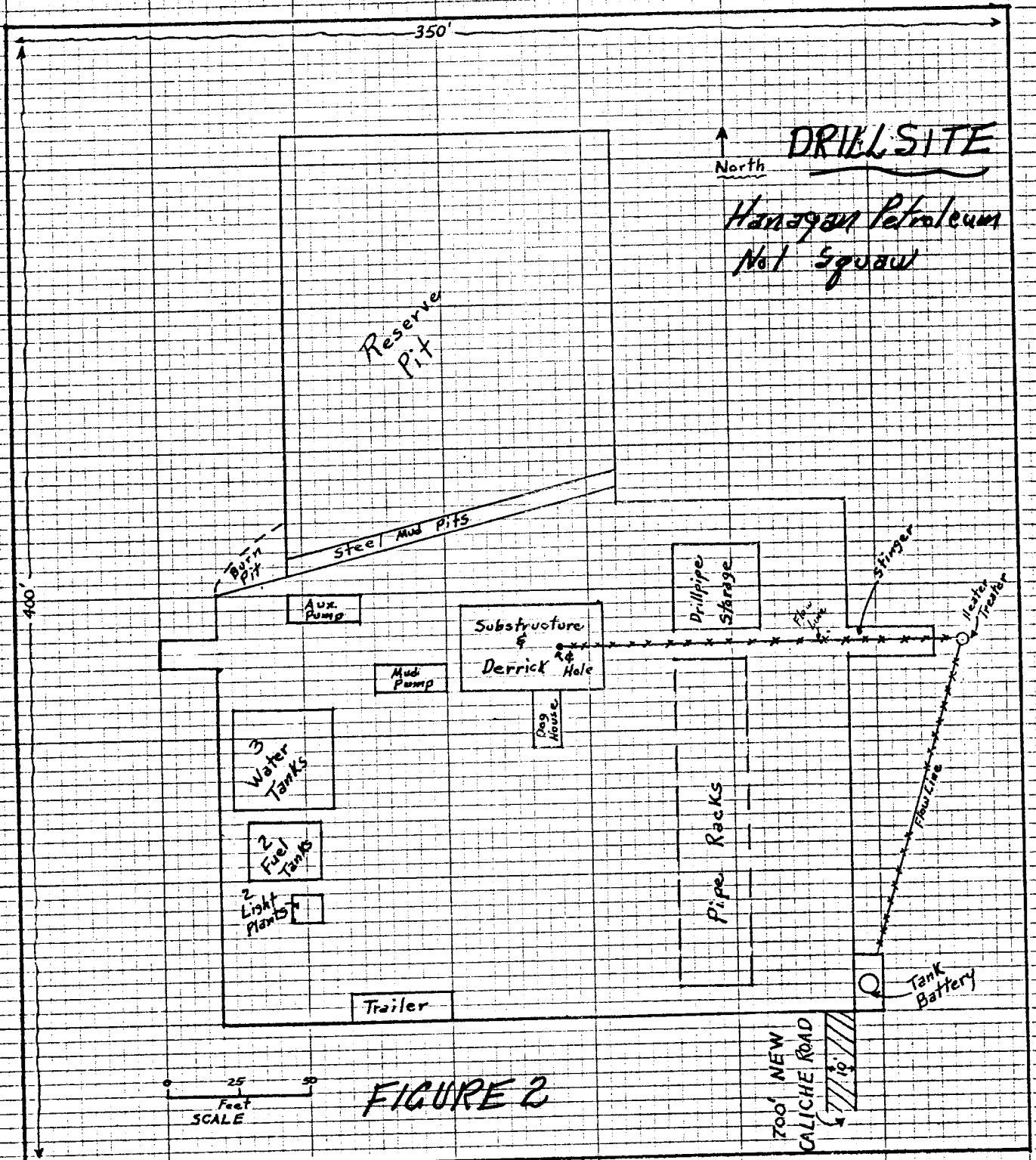

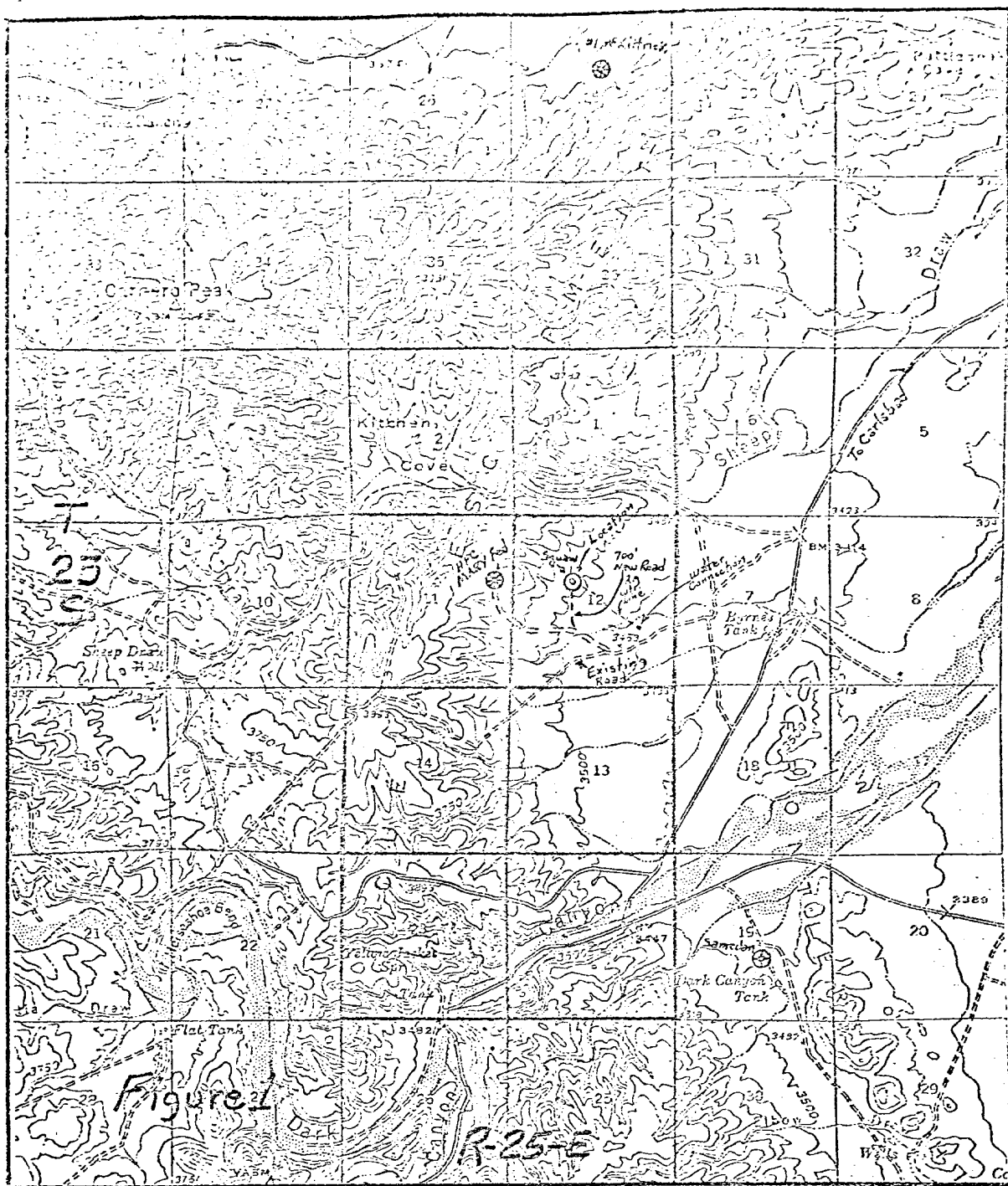

DEVELOPMENT PLAN for SURFACE USE
HANAGAN PETROLEUM CORPORATION NO. 1 SQUAW

1. Existing Roads & Planned Excess Roads - See Figure #1 (USGS Map of Area) - Main road colored red, existing side roads colored yellow, new excess road (approx. 700 feet long and 10 feet wide) colored in green, excess road to be caliche.
2. Location of Existing Wells - See Figure #1.
3. Water Supply - Arrangements have been made to get water for drilling from the City of Carlsbad water line, so noted in Figure #1 as "water connection". This water comes from several water wells located in immediate area. As noted in Figure #1, the rig water line will be approx. 3/4 of a mile in length.
4. Location of Tank Battery & Flow Lines - See Figure #2.
5. Drillsite Arrangement - See Figure #2. At the proposed drillsite, the surface dips southeast, the northwest corner of pad about 5 feet higher than the southeast corner, it is very rocky and is covered mostly by cactus, mesquite, and very little grass. Drilling pad will be caliche. There are no steep gullies, streams or trees on location.
6. Method of Handling Waste - Garbage & trash burned in waste pit and later pit covered over completely. Cuttings will be in reserve pit, which will also be covered over.
7. Plans Restoration of Surface - Area will be completely leveled and cleaned of all junk accumulated in the drilling of the well.