

OIL CONSERVATION COMMISSION

P. O. DRAWER DD

ARTESIA, NEW MEXICO 88210

RECEIVED

AUG 30 1974

O. C. C.  
ARTESIA, OFFICE

NOTICE OF GAS CONNECTION

Date August 27, 1974

This is to notify the Oil Conservation Commission that connection  
for the purchase of gas from the Belco Petroleum Corporation  
Operator

Hudson *Federal*  
Lease

Federal #1, 1-23S-30E  
Well & Unit S.T.R.

*Los Medanos*  
Atoka

Pool

Natural Gas Pipeline Co. of America  
Name of Purchaser

was made on 8-16-74.

Natural Gas Pipeline Co. of America  
Purchaser

*Sue Lannert*  
Representative

Senior Clerk  
Title

cc: To operator  
Oil Conservation Commission - Santa Fe

UNITED STATES  
DEPARTMENT OF THE INTERIOR  
GEOLOGICAL SURVEY

SUBMIT IN DUPLICATE

(See other instructions on reverse side)

Form approved  
Budget Bureau No. 42-R355.5.

## WELL COMPLETION OR RECOMPLETION REPORT AND LOG \*

1a. TYPE OF WELL: OIL WELL ☐ GAS WELL ☒ DRY ☐ Other \_\_\_\_\_

b. TYPE OF COMPLETION:

NEW WELL ☒ WORK OVER ☐ DEEP-EN ☐ PLUG BACK ☐ DIFF. RESVR. ☐ Other \_\_\_\_\_

RECEIVED

2. NAME OF OPERATOR

Belco Petroleum Corporation

AUG 21 1974

3. ADDRESS OF OPERATOR

2000 Wilco Building, Midland, Texas 79701

4. LOCATION OF WELL (Report location clearly and in accordance with any State requirements)

At surface 1830' FNL &amp; 1980' FWL, Sec. 1, T-23-S, R-30-E

At top prod. interval reported below SAME

At total depth SAME

14. PERMIT NO.

DATE ISSUED

2/27/74

15. DATE SPUDDED

2/25/74

16. DATE T.D. REACHED

5/10/74

17. DATE COMPL. (Ready to prod.)

7/26/74

18. ELEVATIONS (DF, REB, RT, GR, ETC.)\*

3298.4' GR

19. ELEV. CASINGHEAD

3296.4'

20. TOTAL DEPTH, MD &amp; TVD

14,325'

21. PLUG BACK T.D., MD &amp; TVD

13,800'

22. IF MULTIPLE COMPL., HOW MANY\*

---

23. INTERVALS DRILLED BY

0-14,325'

24. PRODUCING INTERVAL(S), OF THIS COMPLETION—TOP, BOTTOM, NAME (MD AND TVD)\*

Atoka Carbonate, 12,989-12,995'

25. WAS DIRECTIONAL SURVEY MADE

No

26. TYPE ELECTRIC AND OTHER LOGS RUN

Acoustic-GRN, Forxo, Guard, CBL

27. WAS WELL CORED

No

28. CASING RECORD (Report all strings set in well)

CASING SIZE	WEIGHT, LB./FT.	DEPTH SET (MD)	HOLE SIZE	CEMENTING RECORD	AMOUNT PULLED
16"	65#	492'	20"	350 Class C w/4% gel; 300 C	None
10-3/4"	45.5# & 40.5	3781'	12-1/4"	1450 "Lite"; 500 "C"	None
7-5/8"	26.4, 29.7 & 33#	11,800'	9-1/2"	300 "Lite"; 300 "H"	None
(Liner) 5-1/2"	16.87#	14,325'	6-1/2"	275 sx Class "H"	None

29. LINER RECORD

SIZE	TOP (MD)	BOTTOM (MD)	SACKS CEMENT*	SCREEN (MD)	SIZE	DEPTH SET (MD)	PACKER SET (MD)
5-1/2	11,503'	14,325'	275	---	2-7/8"	12,687'	12,687'

31. PERFORATION RECORD (Interval, size and number)

12,989-12,995', 4 SPF w/1-11/16" ceramic jet.

32. ACID, SHOT, FRACTURE, CEMENT SQUEEZE, ETC.

DEPTH INTERVAL (MD)	AMOUNT AND KIND OF MATERIAL USED
12,989-12,995'	250 gal. acetic acid

33.\* PRODUCTION

DATE FIRST PRODUCTION		PRODUCTION METHOD (Flowing, gas lift, pumping—size and type of pump)					WELL STATUS (Producing or shut-in)	
7/26/74		Flowing					Producing	
DATE OF TEST	HOURS TESTED	CHOKE SIZE	PROD'N. FOR TEST PERIOD	OIL—BBL.	GAS—MCF.	WATER—BBL.	GAS-OIL RATIO	
8/8/74	12	14/64	→	2	527	3.5	263,500	
FLOW. TUBING PRESS.	CASING PRESSURE	CALCULATED 24-HOUR RATE	OIL—BBL.	GAS—MCF.	WATER—BBL.	OIL GRAVITY-API (CORR.)		
1000 psi	0	→	4	1054	7	Unknown		

34. DISPOSITION OF GAS (Sold, used for fuel, vented, etc.)

Sold

TEST WITNESSED BY

Don Rutherford

35. LIST OF ATTACHMENTS

Deviation Record, One Set of Logs (Acoustic, Forxo, Guard, CBL)

36. I hereby certify that the foregoing and attached information is complete and correct as determined from all available records

SIGNED

Allen J. Owings

TITLE

District Engineer

DATE

8/15/74

\*(See Instructions and Spaces for Additional Data on Reverse Side)

# INSTRUCTIONS

**General:** This form is designed for submitting a complete and correct well completion report and log on all types of lands and leases to either a Federal agency or a State agency, or both, pursuant to applicable Federal and/or State laws and regulations. Any necessary special instructions concerning the use of this form and the number of copies to be submitted, particularly with regard to local, area, or regional procedures and practices, either are shown below or will be issued by, or may be obtained from, the local Federal and/or State office. See instructions on items 22 and 24, and 23, below regarding separate reports for separate completions.

If not filed prior to the time this summary record is submitted, copies of all currently available logs (drillers, geologists, sample and core analysis, all types electric, etc.), formation and pressure tests, and directional surveys, should be attached hereto, to the extent required by applicable Federal and/or State laws and regulations. All attachments should be listed on this form, see item 35.

**Item 4:** If there are no applicable State requirements, locations on Federal or Indian land should be described in accordance with Federal requirements. Consult local State or Federal office for specific instructions.

**Item 18:** Indicate which elevation is used as reference (where not otherwise shown) for depth measurements given in other spaces on this form and in any attachments. **Items 22 and 24:** If this well is completed for separate production from more than one interval zone (multiple completion), so state in item 22, and in item 24 show the producing interval, or intervals, top(s), bottom(s) and name(s) (if any) for only the interval reported in item 33. Submit a separate report (page) on this form, adequately identified, for each additional interval to be separately produced, showing the additional data pertinent to such interval.

**Item 29:** "Seals Cement": Attached supplemental records for this well should show the details of any multiple stage cementing and the location of the cementing tool.

**Item 33:** Submit a separate completion report on this form for each interval to be separately produced. (See instruction for items 22 and 24 above.)

37. SUMMARY OF POROUS ZONES: SHOW ALL IMPORTANT ZONES OF POROSITY AND CONTENTS THEREOF; CORED INTERVALS; AND ALL DRILL-STEM TESTS, INCLUDING DEPTH INTERVAL TESTED, CUSHION USED, TIME TOOL OPEN, FLOWING AND SHUT-IN PRESSURES, AND RECOVERIES				38. GEOLOGIC MARKERS			
FORMATION		TOP	BOTTOM	DESCRIPTION, CONTENTS, ETC.	NAME	MEAS. DEPTH	TRUE VERT. DEPTH
Delaware		3796	7676	Multiple sands containing salt water. ---	Delaware	3796	
* Atoka		12,964	12,998	Limestone containing gas (see DST #1).	Bone Spring	7676	
Morrow		14,228	14,252	Sandstone containing gas	Wolfcamp	10,988	
				* DST #1 from 12,980-13,021'. Ran 1000' water cushion. Tool open for 1 hr. 45 minutes. FFP - 1256 psi; FSIP - 6537 psi. Flowed at maximum rate of 2.7 MMCFD on 1/2" choke. Sample chamber recovery: 4.78 cu. ft. gas, 80 cc. condensate, 300 cc. water.	Atoka	12,802	
					Morrow	13,724	

August 14, 1974

HUDSON FEDERAL #1

Deviation Surveys

<u>Degree</u>	<u>Depth</u>
3/4 <sup>0</sup>	368'
1/2 <sup>0</sup>	600'
3/4 <sup>0</sup>	1050'
3/4 <sup>0</sup>	1456'
3/4 <sup>0</sup>	1860'
1/4 <sup>0</sup>	2115'
1/4 <sup>0</sup>	2275'
1-1/2 <sup>0</sup>	2847'
3/4 <sup>0</sup>	3340'
3/4 <sup>0</sup>	4282'
3/4 <sup>0</sup>	4615'
1-1/4 <sup>0</sup>	5109'
1/2 <sup>0</sup>	5600'
1 <sup>0</sup>	6047'
1/4 <sup>0</sup>	6540'
1-1/2 <sup>0</sup>	6850'
1-3/4 <sup>0</sup>	7420'
1-3/4 <sup>0</sup>	7770'
1 <sup>0</sup>	8330'
3/4 <sup>0</sup>	8800'
3/4 <sup>0</sup>	9300'
1 <sup>0</sup>	9710'
1 <sup>0</sup>	10,210'
1-1/2 <sup>0</sup>	10,710'
2 <sup>0</sup>	11,193'
1 <sup>0</sup>	11,790'
2-3/4 <sup>0</sup>	12,250'
2-3/4 <sup>0</sup>	12,762'
2-1/2 <sup>0</sup>	13,230'
2 <sup>0</sup>	13,655'
1-3/4 <sup>0</sup>	13,866'

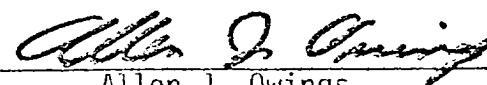
  
Allen J. Owings  
District Engineer

STATE OF..... TEXAS  
COUNTY OF..... Midland..... } ss.

The foregoing instrument was acknowledged before me this..... 14th..... day of..... August....., 19.74, by  
Allen J. Owings.

My commission expires:..... 6-1-75.....

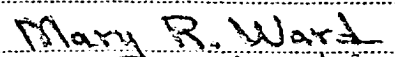
  
Notary Public in and for  
Midland County, Texas

NEW MEXICO OIL CONSERVATION COMMISSION  
WELL LOCATION AND ACREAGE DEDICATION PLAT

Form C-102  
Supersedes C-128  
Effective 11-65

All distances must be from the outer boundaries of the Section

Operator <b>BELCO PETROLEUM CORPORATION</b>			Lease <b>HUDSON FEDERAL Com</b>		Well No. <b>1</b>
Unit Number <b>F</b>	Section <b>1</b>	Township <b>23 SOUTH</b>	Range <b>30 EAST</b>	County <b>EDDY</b>	
Actual Well Location of Well: <b>1830</b> feet from the <b>NORTH</b> line and <b>1980</b> feet from the <b>WEST</b> line					
Ground Level Elev. <b>3298.4' GR</b>	Producing Formation <b>Atoka</b>	Pool <b>Los Medenos Atoka</b>		Estimated Acreage <b>160</b> Acres	

1. Outline the acreage dedicated to the subject well by colored pencil or hatchure marks on the plat below.
2. If more than one lease is dedicated to the well, outline each and identify the ownership thereof (both as to working interest and royalty).
3. If more than one lease of different ownership is dedicated to the well, have the interests of all owners been consolidated by communitization, unitization, force-pooling, etc?

☒ Yes ☐ No If answer is "yes," type of consolidation Unitization

If answer is "no," list the owners and tract descriptions which have actually been consolidated. (Use reverse side of this form if necessary.) \_\_\_\_\_

No allowable will be assigned to the well until all interests have been consolidated (by communitization, unitization, forced-pooling, or otherwise) or until a non-standard unit, eliminating such interests, has been approved by the Commission.

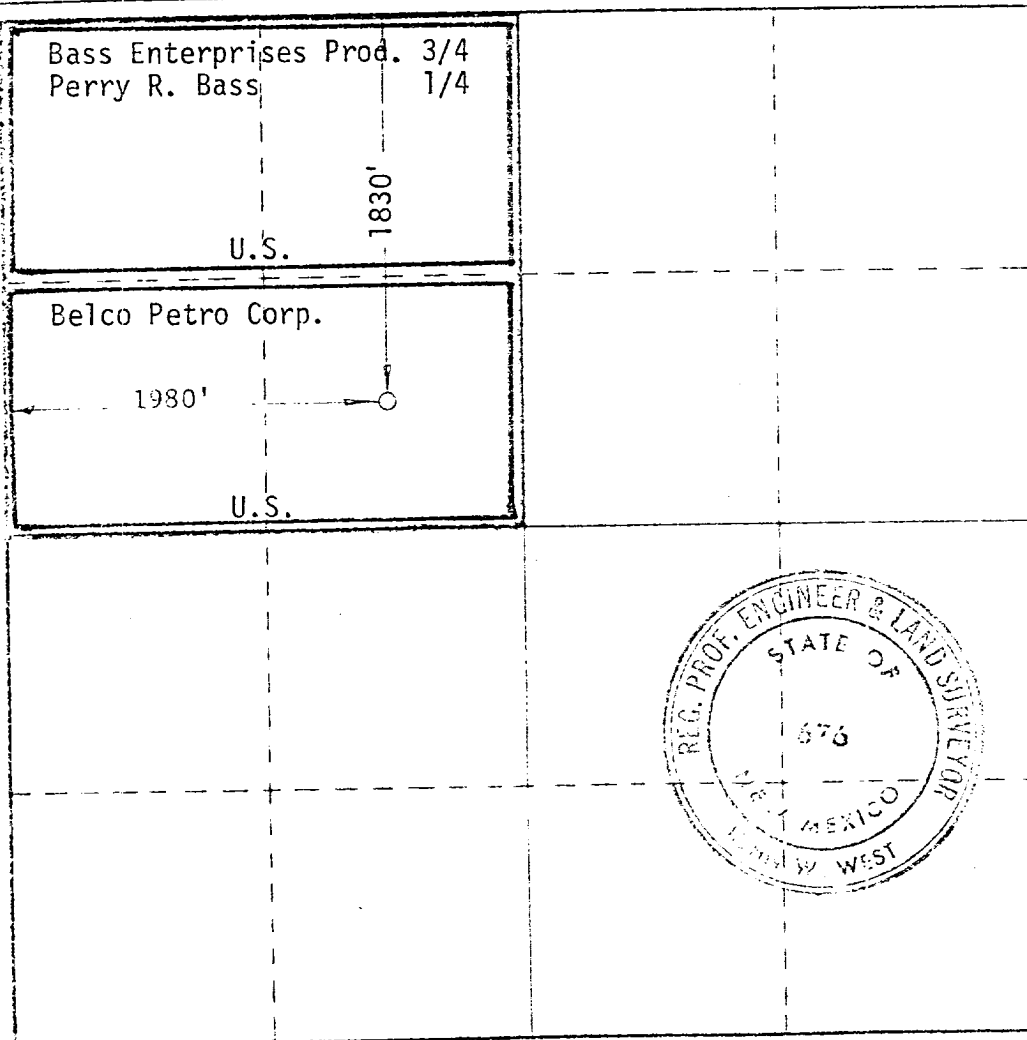

CERTIFICATION

I hereby certify that the information contained herein is true and complete to the best of my knowledge and belief.

*Allen J. Owings*

Allen J. Owings

District Engineer

Belco Petroleum Corporation

August 14, 1974

I hereby certify that the well location shown on this plat was plotted from field notes of actual surveys made by me or under my supervision, and that the same is true and correct to the best of my knowledge and belief.

Date Surveyed

AUGUST 9, 1973

Registered Professional Engineer  
in the State of New Mexico

*Edwin J. West*

Certificate No.

676

330 550 90 1320 1650 1980 2310 2540 2970 3400 3830 4260 4690 5120 5550 5980 6410 6840 7270 7700 8130 8560 8990 9420 9850 10280 10710 11140 11570 12000 12430 12860 13290 13720 14150 14580 15010 15440 15870 16300 16730 17160 17590 18020 18450 18880 19310 19740 20170 20600 21030 21460 21890 22320 22750 23180 23610 24040 24470 24900 25330 25760 26190 26620 27050 27480 27910 28340 28770 29200 29630 30060 30490 30920 31350 31780 32210 32640 33070 33500 33930 34360 34790 35220 35650 36080 36510 36940 37370 37800 38230 38660 39090 39520 39950 40380 40810 41240 41670 42100 42530 42960 43390 43820 44250 44680 45110 45540 45970 46400 46830 47260 47690 48120 48550 48980 49410 49840 50270 50700 51130 51560 51990 52420 52850 53280 53710 54140 54570 55000 55430 55860 56290 56720 57150 57580 58010 58440 58870 59300 59730 60160 60590 61020 61450 61880 62310 62740 63170 63600 64030 64460 64890 65320 65750 66180 66610 67040 67470 67900 68330 68760 69190 69620 70050 70480 70910 71340 71770 72200 72630 73060 73490 73920 74350 74780 75210 75640 76070 76500 76930 77360 77790 78220 78650 79080 79510 79940 80370 80800 81230 81660 82090 82520 82950 83380 83810 84240 84670 85100 85530 85960 86390 86820 87250 87680 88110 88540 88970 89400 89830 90260 90690 91120 91550 91980 92410 92840 93270 93700 94130 94560 94990 95420 95850 96280 96710 97140 97570 98000 98430 98860 99290 99720 100150 100580 101010 101440 101870 102300 102730 103160 103590 104020 104450 104880 105310 105740 106170 106600 107030 107460 107890 108320 108750 109180 109610 110040 110470 110900 111330 111760 112190 112620 113050 113480 113910 114340 114770 115200 115630 116060 116490 116920 117350 117780 118210 118640 119070 119500 119930 120360 120790 121220 121650 122080 122510 122940 123370 123800 124230 124660 125090 125520 125950 126380 126810 127240 127670 128100 128530 128960 129390 129820 130250 130680 131110 131540 131970 132400 132830 133260 133690 134120 134550 134980 135410 135840 136270 136700 137130 137560 137990 138420 138850 139280 139710 140140 140570 141000 141430 141860 142290 142720 143150 143580 144010 144440 144870 145300 145730 146160 146590 147020 147450 147880 148310 148740 149170 149600 150030 150460 150890 151320 151750 152180 152610 153040 153470 153900 154330 154760 155190 155620 156050 156480 156910 157340 157770 158200 158630 159060 159490 159920 160350 160780 161210 161640 162070 162500 162930 163360 163790 164220 164650 165080 165510 165940 166370 166800 167230 167660 168090 168520 168950 169380 169810 170240 170670 171100 171530 171960 172390 172820 173250 173680 174110 174540 174970 175400 175830 176260 176690 177120 177550 177980 178410 178840 179270 179700 180130 180560 180990 181420 181850 182280 182710 183140 183570 184000 184430 184860 185290 185720 186150 186580 187010 187440 187870 188300 188730 189160 189590 190020 190450 190880 191310 191740 192170 192600 193030 193460 193890 194320 194750 195180 195610 196040 196470 196900 197330 197760 198190 198620 199050 199480 199910 200340 200770 201200 201630 202060 202490 202920 203350 203780 204210 204640 205070 205500 205930 206360 206790 207220 207650 208080 208510 208940 209370 209800 210230 210660 211090 211520 211950 212380 212810 213240 213670 214100 214530 214960 215390 215820 216250 216680 217110 217540 217970 218400 218830 219260 219690 220120 220550 220980 221410 221840 222270 222700 223130 223560 223990 224420 224850 225280 225710 226140 226570 227000 227430 227860 228290 228720 229150 229580 230010 230440 230870 231300 231730 232160 232590 233020 233450 233880 234310 234740 235170 235600 236030 236460 236890 237320 237750 238180 238610 239040 239470 239900 240330 240760 241190 241620 242050 242480 242910 243340 243770 244200 244630 245060 245490 245920 246350 246780 247210 247640 248070 248500 248930 249360 249790 250220 250650 251080 251510 251940 252370 252800 253230 253660 254090 254520 254950 255380 255810 256240 256670 257100 257530 257960 258390 258820 259250 259680 260110 260540 260970 261400 261830 262260 262690 263120 263550 263980 264410 264840 265270 265700 266130 266560 266990 267420 267850 268280 268710 269140 269570 270000 270430 270860 271290 271720 272150 272580 273010 273440 273870 274300 274730 275160 275590 276020 276450 276880 277310 277740 278170 278600 279030 279460 279890 280320 280750 281180 281610 282040 282470 282900 283330 283760 284190 284620 285050 285480 285910 286340 286770 287200 287630 288060 288490 288920 289350 289780 290210 290640 291070 291500 291930 292360 292790 293220 293650 294080 294510 294940 295370 295800 296230 296660 297090 297520 297950 298380 298810 299240 299670 300100 300530 300960 301390 301820 302250 302680 303110 303540 303970 304400 304830 305260 305690 306120 306550 306980 307410 307840 308270 308700 309130 309560 310000

UNITED STATES  
DEPARTMENT OF THE INTERIOR  
GEOLOGICAL SURVEYSUBMIT IN TRIPLICATE\*  
(Other instructions on re-  
verse side)Form approved.  
Budget Bureau No. 42-R1424.

5. LEASE DESIGNATION AND SERIAL NO.

NM 0543280-A

6. IF INDIAN, ALLOTTEE OR TRIBE NAME

## SUNDRY NOTICES AND REPORTS ON WELLS

(Do not use this form for proposals to drill or to deepen or plug back to a different reservoir.  
Use "APPLICATION FOR PERMIT—" for such proposals.)1. OIL WELL ☐ GAS WELL ☒ OTHER

2. NAME OF OPERATOR

Belco Petroleum Corporation

3. ADDRESS OF OPERATOR

2000 Wilco Building, Midland, Texas 79701

4. LOCATION OF WELL (Report location clearly and in accordance with any State requirements.\*  
See also space 17 below.)  
At surface

1830' FNL &amp; 1980' FWL, Sec. 1, T-23-S, R-30-E

14. PERMIT NO.

15. ELEVATIONS (Show whether DF, RT, CR, etc.)

3298.4' GR

7. UNIT AGREEMENT NAME

Hudson Federal

8. FARM OR LEASE NAME

Hudson Federal

9. WELL NO.

1

10. FIELD AND POOL, OR WILDCAT

Undesignated

Atoka Gas

11. SEC., T., R., M., OR BLK. AND  
SURVEY OR AREA

Sec. 1, T-23-S, R-30-E

12. COUNTY OR PARISH

Eddy

13. STATE

New Mexico

16. Check Appropriate Box To Indicate Nature of Notice, Report, or Other Data

## NOTICE OF INTENTION TO:

TEST WATER SHUT-OFF

FRACTURE TREAT

SHOOT OR ACIDIZE

REPAIR WELL

(Other)

PULL OR ALTER CASING

MULTIPLE COMPLETE

ABANDON\*

CHANGE PLANS

## SUBSEQUENT REPORT OF:

WATER SHUT-OFF

FRACTURE TREATMENT

SHOOTING OR ACIDIZING

(Other) Plug Morrow; Test Atoka  
(NOTE: Report results of multiple completion on Well  
Completion or Recompletion Report and Log form.)

REPAIRING WELL

ALTERING CASING

ABANDONMENT\*

17. DESCRIBE PROPOSED OR COMPLETED OPERATIONS (Clearly state all pertinent details, and give pertinent dates, including estimated date of starting any proposed work. If well is directionally drilled, give subsurface locations and measured and true vertical depths for all markers and zones pertinent to this work.)\*

7/24/74: Set plug in packer at 13,800', tested to 5000 psi. Spotted 250 gallons acetic acid, set retrievable packer at 12,687' and perforated Atoka Carbonate from 12,989-12,995'. Displaced acid into formation. ISIP - 3500 psi, 5 min. SIP - 0 psi. Swabbed well in and tested on 7/26/74.

7/26/74: Testing well.

18. I hereby certify that the foregoing is true and correct

SIGNED

Allen L. Owings

TITLE District Engineer

DATE August 8, 1974

(This space for Federal or State office use)

APPROVED  
AUG 16 1974

CONDITIONS OF APPROVAL, IF ANY:

H. L. BEEKMAN

ACTING DISTRICT ENGINEER

TITLE

Subject to filing results  
of test on 4pt test

DATE

\*See Instructions on Reverse Side

UNITED STATES  
DEPARTMENT OF THE INTERIOR  
GEOLOGICAL SURVEYSUBMIT IN TRIPLICATE\*  
(Other instructions on re-  
verse side)Form approved.  
Budget Bureau No. 42-R1424.

5. LEASE DESIGNATION AND SERIAL NO.

NM 0543280-A

6. IF INDIAN, ALLOTTEE OR TRIBE NAME

7. UNIT AGREEMENT NAME

Hudson Federal

8. FARM OR LEASE NAME

Hudson Federal

9. WELL NO.

1

10. FIELD AND POOL, OR WILDCAT

Undesignated Atoka Gas

11. SEC., T., R., M., OR BLK. AND  
SURVEY OR AREA

Sec. 1, T-23-S, R-30-E

12. COUNTY OR PARISH

Eddy

13. STATE  
New Mexico1. OIL WELL ☐ GAS WELL ☒ OTHER

2. NAME OF OPERATOR

Belco Petroleum Corporation

3. ADDRESS OF OPERATOR

2000 Wilco Building, Midland, Texas 79701

4. LOCATION OF WELL (Report location clearly and in accordance with any State requirements.)  
See also space 17 below.)

At surface

1830' FNL and 1980' FWL, Section 1, T-23-S, R-30-E

14. PERMIT NO.

15. ELEVATIONS (Show whether DF, RT, GR, etc.)

3298.4' GR

16.

Check Appropriate Box To Indicate Nature of Notice, Report, or Other Data

NOTICE OF INTENTION TO:

TEST WATER SHUT-OFF

FRACTURE TREAT

SHOOT OR ACIDIZE

REPAIR WELL

(Other)

PULL OR ALTER CASING

MULTIPLE COMPLETE

X TEMP ABANDON\* MORROW

CHANGE PLANS

PERF TREAT &amp; TEST ATOKA

SUBSEQUENT REPORT OF:

WATER SHUT-OFF

FRACTURE TREATMENT

SHOOTING OR ACIDIZING

(Other)

REPAIRING WELL

ALTERING CASING

ABANDONMENT\*

(NOTE: Report results of multiple completion on Well  
Completion or Recompletion Report and Log form.)

17. DESCRIBE PROPOSED OR COMPLETED OPERATIONS (Clearly state all pertinent details, and give pertinent dates, including estimated date of starting any proposed work. If well is directionally drilled, give subsurface locations and measured and true vertical depths for all markers and zones pertinent to this work.)\*

Plan to temporarily abandon Morrow Zone, perforated from 13,844-14,248', (initial production 1.5 MMCFPD) as this zone is no longer commercially productive. Perforate Atoka Zone from 12,989-12,995' with four holes per foot, acidize and test. A blanking plug will be set in permanent packer at 13,801' to shut off Morrow Zone before Atoka is perforated. Verbal approval to do this work was obtained per telephone conversation between Mr. James A. Knauf, Artesia, New Mexico and the undersigned on 7/22/74. Work will start 7/24/74.

18. I hereby certify that the foregoing is true and correct

SIGNED

Joe T. Holten, Jr.

TITLE

Operations Engineer

DATE

7/23/74

(This space for Federal or State office use)

TITLE

DATE

APPROVAL, IF ANY:

\*See Instructions on Reverse Side

Form 9-331  
(May 1963)UNITED STATES  
DEPARTMENT OF THE INTERIOR  
GEOLOGICAL SURVEYSUBMIT IN TRI. DATE\*  
(Other instructions on re-  
verse side)Form approved.  
Budget Bureau No. 42-R1424.

5. LEASE DESIGNATION AND SERIAL NO.

NM 0543280-A

6. IF INDIAN, ALLOTTEE OR TRIBE NAME

7. UNIT AGREEMENT NAME

Hudson Federal

8. FARM OR LEASE NAME

Hudson Federal

9. WELL NO.

1

10. FIELD AND POOL, OR WILDCAT

Undesignated  
Morrow Gas11. SEC., T., R., M., OR BLK. AND  
SURVEY OR AREA

Sec. 1, T-23-S, R-30-E

12. COUNTY OR PARISH

Eddy

13. STATE

New Mexico

## SUNDRY NOTICES AND REPORTS ON WELLS

(Do not use this form for proposals to drill or to deepen or plug back to a different reservoir.  
Use "APPLICATION FOR PERMIT—" for such proposals.)

1.

OIL WELL ☐ GAS WELL ☒ OTHER

2. NAME OF OPERATOR

Belco Petroleum Corporation

3. ADDRESS OF OPERATOR

2000 Wilco Building, Midland, Texas 79701

4. LOCATION OF WELL (Report location clearly and in accordance with any State requirements.\*  
See also space 17 below.)  
At surface

1830' FNL &amp; 1980' FWL of Sec. 1, T-23-S, R-30-E

14. PERMIT NO.

15. ELEVATIONS (Show whether DF, RT, GR, etc.)

16.

## Check Appropriate Box To Indicate Nature of Notice, Report, or Other Data

## NOTICE OF INTENTION TO:

TEST WATER SHUT-OFF

FRACTURE TREAT

SHOOT OR ACIDIZE

REPAIR WELL

(Other)

PULL OR ALTER CASING

MULTIPLE COMPLETE

ABANDON\*

CHANGE PLANS

## SUBSEQUENT REPORT OF:

WATER SHUT-OFF

FRACTURE TREATMENT

SHOOTING OR ACIDIZING

(Other)

REPAIRING WELL

ALTERING CASING

ABANDONMENT\*

(NOTE: Report results of multiple completion on Well  
Completion or Recompletion Report and Log form.)

17. DESCRIBE PROPOSED OR COMPLETED OPERATIONS (Clearly state all pertinent details, and give pertinent dates, including estimated date of starting any proposed work. If well is directionally drilled, give subsurface locations and measured and true vertical depths for all markers and zones pertinent to this work.)\*

7/4/74: Fracture treated well with 46,000 gallons E-Z Flow fluid, 30,000# of proppant (80% 20/40 mesh frac sand and 20% 20/40 mesh glass beads), and 600 SCF/bbl. N<sub>2</sub> in three stages. Maximum treating pressure: 9500 psi. ISIP: 6800 psi. 15 min. SIP: 5600 psi. Average Injection Rate: 8-1/2 BPM.

RECEIVED

JUL 18 1974

U. S. GEOLOGICAL SURVEY  
ARTESIA, NEW MEXICO

18. I hereby certify that the foregoing is true and correct

SIGNED

Allen J. Owings

TITLE

District Engineer

DATE 7/17/74

(This space for Federal or State office use)

TITLE

DATE

APPROVED

CONDITIONS OF APPROVAL, IF ANY:

JUL 19 1974

H. L. BEEKMAN

ACTING DISTRICT ENGINEER

\*See Instructions on Reverse Side



UNITED STATES  
DEPARTMENT OF THE INTERIOR  
GEOLOGICAL SURVEYSUBMIT IN TRI  
(Other instructive  
verse side)DATE  
on re-Form approved.  
Budget Bureau No. 42-R1424.

5. LEASE DESIGNATION AND SERIAL NO.

NM 0543280-A

6. IF INDIAN, ALLOTTEE OR TRIBE NAME

7. UNIT AGREEMENT NAME

Hudson Federal

8. FARM OR LEASE NAME

Hudson Federal

9. WELL NO.

1

10. FIELD AND POOL, OR WILDCAT

Undesignated  
Morrow Gas11. SEC., T., R., M., OR BLK. AND  
SURVEY OR AREA

Sec. 1, T-23-S, R-30-E

12. COUNTY OR PARISH

Eddy

13. STATE

New Mexico

## SUNDRY NOTICES AND REPORTS ON WELLS

(Do not use this form for proposals to drill or to deepen or plug back to a different reservoir.  
Use "APPLICATION FOR PERMIT—" for such proposals.)

1.

OIL WELL ☐ GAS WELL ☒ OTHER

2. NAME OF OPERATOR

Belco Petroleum Corporation

3. ADDRESS OF OPERATOR

2000 Wilco Building, Midland, Texas 79701

4. LOCATION OF WELL (Report location clearly and in accordance with any State requirements.  
See also space 17 below.)

At surface

1830' FNL &amp; 1980' FWL of Sec. 1, T-23-S, R-30-E

14. PERMIT NO.

15. ELEVATIONS (Show whether DF, RT, GR, etc.)

16.

## Check Appropriate Box To Indicate Nature of Notice, Report, or Other Data

## NOTICE OF INTENTION TO:

TEST WATER SHUT-OFF ☐FRACTURE TREAT ☐SHOOT OR ACIDIZE ☐REPAIR WELL ☐(Other) ☐PULL OR ALTER CASING ☐MULTIPLE COMPLETE ☐ABANDON\* ☐CHANGE PLANS ☐

## SUBSEQUENT REPORT OF:

WATER SHUT-OFF ☐FRACTURE TREATMENT ☐SHOOTING OR ACIDIZING ☒(Other) ☐REPAIRING WELL ☐ALTERING CASING ☐ABANDONMENT\* ☐(NOTE: Report results of multiple completion on Well  
Completion or Recompletion Report and Log form.)

17. DESCRIBE PROPOSED OR COMPLETED OPERATIONS (Clearly state all pertinent details, and give pertinent dates, including estimated date of starting any proposed work. If well is directionally drilled, give subsurface locations and measured and true vertical depths for all markers and zones pertinent to this work.)\*

6/23-27/74: Swabbing well.6/28/74: Treated well with 500 gallons P-121 paraffin solvent at 1 BPM. ISIP: Vacuum.6/29-30/74: Swabbing well.7/1/74: Perforated Morrow Zone from 14,171-77', 13,870-75' and 13,844-56' with two shots per foot.7/2-3/74: Swabbing well.

RECEIVED

JUL 18 1974

U. S. GEOLOGICAL SURVEY  
ARTESIA, NEW MEXICO

18. I hereby certify that the foregoing is true and correct

SIGNED

Allen J. Owings  
Allen J. Owings

TITLE

District Engineer

DATE

7/17/74

(This space for Federal or State office use)

APPROVED BY  
CONDITIONS OF APPROVAL, IF ANY:

TITLE

DATE

APPROVED  
JUL 19 1974  
H. L. BEEKMAN  
ACTING DISTRICT ENGINEER

\*See Instructions on Reverse Side

UNITED STATES  
DEPARTMENT OF THE INTERIOR  
GEOLOGICAL SURVEYSUBMIT IN TRIPLICATE\*  
(Other instructions on reverse side)Form approved.  
Budget Bureau No. 42-R1424.

5. LEASE DESIGNATION AND SERIAL NO.

NM 0543280-A

6. IF INDIAN, ALLOTTEE OR TRIBE NAME

## SUNDRY NOTICES AND REPORTS ON WELLS

(Do not use this form for proposals to drill or to deepen or plug back to a different reservoir.  
Use "APPLICATION FOR PERMIT—" for such proposals.)

7. UNIT AGREEMENT NAME

Hudson Federal

8. FARM OR LEASE NAME

Hudson Federal

9. WELL NO.

1

10. FIELD AND POOL, OR WILDCAT

Undesignated  
Morrow Gas11. SEC., T., R., M., OR BLK. AND  
SURVEY OR AREA

Sec. 1, T-23-S, R-30-E

12. COUNTY OR PARISH

Eddy

13. STATE

New Mexico

1. OIL WELL ☐ GAS WELL ☒ OTHER

2. NAME OF OPERATOR

Belco Petroleum Corporation

3. ADDRESS OF OPERATOR

2000 Wilco Building, Midland, Texas 79701

4. LOCATION OF WELL (Report location clearly and in accordance with any State requirements.  
See also space 17 below.)  
At surface

1830' FNL &amp; 1980' FWL of Sec. 1, T-23-S, R-30-E

14. PERMIT NO.

15. ELEVATIONS (Show whether DF, RT, GR, etc.)

## 16. Check Appropriate Box To Indicate Nature of Notice, Report, or Other Data

## NOTICE OF INTENTION TO:

TEST WATER SHUT-OFF ☐FRACTURE TREAT ☐SHOOT OR ACIDIZE ☐REPAIR WELL ☐(Other) ☐PULL OR ALTER CASING ☐MULTIPLE COMPLETE ☐ABANDON\* ☐CHANGE PLANS ☐

## SUBSEQUENT REPORT OF:

WATER SHUT-OFF ☐FRACTURE TREATMENT ☐SHOOTING OR ACIDIZING ☒(Other) ☐REPAIRING WELL ☐ALTERING CASING ☐ABANDONMENT\* ☐(NOTE: Report results of multiple completion on Well  
Completion or Recompletion Report and Log form.)

17. DESCRIBE PROPOSED OR COMPLETED OPERATIONS (Clearly state all pertinent details, and give pertinent dates, including estimated date of starting any proposed work. If well is directionally drilled, give subsurface locations and measured and true vertical depths for all markers and zones pertinent to this work.)\*

5/27/74: Perforated Morrow Zone from 14,229-37' and 14,243-48' with two shots per foot.

5/30/74: Flowing at 1.4 MMCFD gas rate, tubing pressure 200 psi.

5/31/74: Acidized with 3000 gallons 7-1/2% MS Acid and 1000 SCF/bbl. N<sub>2</sub> at 5.3 BPM.  
ISIP - 4100 psi; 15 min. SIP - 2350 psi.

6/1-14/74: Swabbing well to unload.

6/15/74: Re-perforated Morrow Zone from 14,229-37' and 14,243-48' with one shot per foot.

6/16-21/74: Swabbing well.

6/22/74: Acidized with 4000 gallons 7-1/2% DAD at 5-1/2 BPM. ISIP - 4150 psi; 15 min.  
SIP - 1600 psi.

RECEIVED

JUL 18 1974

U. S. GEOLOGICAL SURVEY  
ARTESIA, NEW MEXICO

18. I hereby certify that the foregoing is true and correct

SIGNED

Allen J. Owings

TITLE

District Engineer

DATE

7/17/74

(This space for Federal or State office use)

TITLE

DATE

\*See Instructions on Reverse Side

APPROVED  
JUL 19 1974  
H. C. BEEKMAN  
ACTING DISTRICT ENGINEER

UNITED STATES  
DEPARTMENT OF THE INTERIOR  
GEOLOGICAL SURVEYSUBMIT IN TR.  
(Other instruction.  
verse side)DATE\*  
on re-Form approved.  
Budget Bureau No. 42-R1424.

5. LEASE DESIGNATION AND SERIAL NO.

NM 0543280-A

6. IF INDIAN, ALLOTTEE OR TRIBE NAME

7. UNIT AGREEMENT NAME

Hudson Federal

8. FARM OR LEASE NAME

Hudson Federal

9. WELL NO.

1

10. FIELD AND POOL, OR WILDCAT

Undesignated  
Morrow Gas11. SEC., T., R., M., OR BLK. AND  
SURVEY OR AREA

Sec. 1, T-23-S, R-30-E

12. COUNTY OR PARISH

Eddy

13. STATE

New Mexico

## SUNDRY NOTICES AND REPORTS ON WELLS

(Do not use this form for proposals to drill or to deepen or plug back to a different reservoir.  
Use "APPLICATION FOR PERMIT—" for such purposes.)1. OIL WELL ☐ GAS WELL ☒ OTHER

2. NAME OF OPERATOR

Belco Petroleum Corporation

3. ADDRESS OF OPERATOR

2000 Wilco Building, Midland, Texas 79701

4. LOCATION OF WELL (Report location clearly and in accordance with any State requirements.  
See also space 17 below.)  
At surface

1830' FNL &amp; 1980' FWL of Sec. 1, T-23-S, R-30-E

14. PERMIT NO.

15. ELEVATIONS (Show whether DF, RT, CR, etc.)

16.

## Check Appropriate Box To Indicate Nature of Notice, Report, or Other Data

## NOTICE OF INTENTION TO:

TEST WATER SHUT-OFF

FRACTURE TREAT

SHOOT OR ACIDIZE

REPAIR WELL

(Other)

PULL OR ALTER CASING

MULTIPLE COMPLETE

ABANDON\*

CHANGE PLANS

## SUBSEQUENT REPORT OF:

WATER SHUT-OFF

FRACTURE TREATMENT

SHOOTING OR ACIDIZING

(Other) Run Liner &amp; Cement

REPAIRING WELL

ALTERING CASING

ABANDONMENT\*

(NOTE: Report results of multiple completion on Well  
Completion or Recompletion Report and Log form.)

17. DESCRIBE PROPOSED OR COMPLETED OPERATIONS (Clearly state all pertinent details, and give pertinent dates, including estimated date of starting any proposed work. If well is directionally drilled, give subsurface locations and measured and true vertical depths for all markers and zones pertinent to this work.)\*

5/11/74: TD 14,325'. Ran 68 joints of 5-1/2", 16.87#, N-80, FL-4S liner to 14,325'. Top of liner at 11,503'. Cemented with 275 sx. Class "H" with .8% Halad 22 and 5# KCl per sx.

5/12/74: Drilled cement from 11,000' to 11,503'.

5/13/74: Tested top of liner with 1750 psi. Drilled cement inside liner from 13,978' to 14,278'.

5/14/74: Ran cement bond log - good bonding across all pay zones.

RECEIVED  
JUL 18 1974  
U. S. GEOLOGICAL SURVEY  
ARTESIA, NEW MEXICO

18. I hereby certify that the foregoing is true and correct

SIGNED

Allen J. Owings

TITLE

District Engineer

DATE 7/17/74

(This space for Federal or State office use)

TITLE

DATE

APPROVED

APPROVED BY

CONDITIONS OF APPROVAL, IF ANY:

JUL 19 1974

K. L. BEEKMAN

ACTING DISTRICT ENGINEER

\*See Instructions on Reverse Side