

WELL LOCATION AND ACREAGE DEDICATION PLAT

Supersedes C-128
Effective 1-1-65

All distances must be from the outer boundaries of the Section.

Operator THE DESANA CORPORATION			Lease TIN HENRY-FEDERAL		Well No. 1
Unit Letter "J"	Section 30	Township 23-S	Range 23-E	County EDDY	
Actual Footage Location of Well: 1980 feet from the SOUTH line and 1980 feet from the EAST line					
Ground Level Elev. 4347	Producing Formation MORROW		Pool WILDCAT	Dedicated Acreage: 320 Acres	

1. Outline the acreage dedicated to the subject well by colored pencil or hachure marks on the plat below.
2. If more than one lease is dedicated to the well, outline each and identify the ownership thereof (both as to working interest and royalty).
3. If more than one lease of different ownership is dedicated to the well, have the interests of all owners been consolidated by communitization, unitization, force-pooling, etc?

☐ Yes ☒ No * If answer is "yes," type of consolidation *Will be Communitized if productive.

If answer is "no," list the owners and tract descriptions which have actually been consolidated. (Use reverse side of this form if necessary.) * See Reverse side.

No allowable will be assigned to the well until all interests have been consolidated (by communitization, unitization, forced-pooling, or otherwise) or until a non-standard unit, eliminating such interests, has been approved by the Commission.

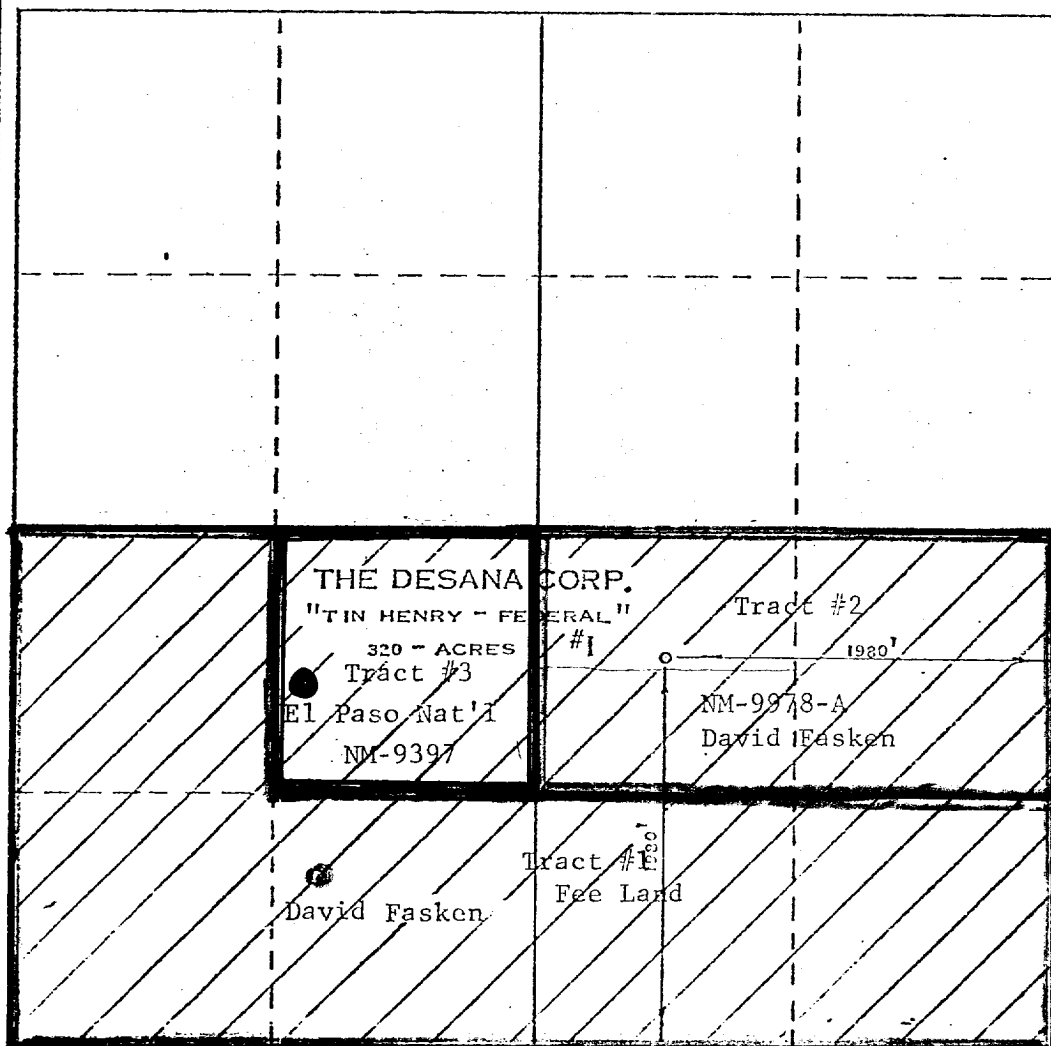

CERTIFICATION

I hereby certify that the information contained herein is true and complete to the best of my knowledge and belief.

Name
D. E. Cooper

Position
Administrative Supervisor

Company
The Desana Corporation

Date
1-23-74

I hereby certify that the well location shown on this plat was plotted from field notes of actual survey by me or under my supervision, and the same is true and correct to the best of my knowledge and belief.

Date Surveyed
JANUARY 12, 1974

Registered Professional Engineer and/or Land Surveyor

Max A. Schumann, Jr.
MAX A. SCHUMANN, JR.

Certificate No.

1510

OVER

Tract #1: ~~W/2 and SE/4 of SW/4~~ *SE/2 x NW/4 SW/4* Sec. 30, T-23-S, R-23-E.
W.I. - David Fasken - 100%
R.I. - Earl B. Guitar, As Attorney in Fact For:

- (1) John Guitar, Jr.
- (2) Virginia Guitar Witherspoon
- (3) Katherine Guitar Woods
- (4) Mary Guitar Polk
- (5) Laura Guitar Belcher
- (6) Ruth Guitar Alexander

R.I. - John F. Joyce II

Pardue Farms

Merland Inc.

Carmex Inc.

June Joyce Kugeler

Tract #2: N/2 of SE/4 Sec. 30, T-23-S, R-23-E.
NM-9978-A

W. I. - David Fasken - 100%

R.I. - Federal Lands

Tract #3: NE/4 of SW/4, Sec. 30, T-23-S, R-23-E.
NM-9397

W.I. - El Paso Nat't. - 100%

R. I. - Federal Lands