

NEW MEXICO OIL CONSERVATION COMMISSION

RECEIVED

MAR 18 1974

D. C. C.

30-015-21133

Form C-101
Revised 1-1-65

5A. Indicate Type of Lease	
STATE <input checked="" type="checkbox"/>	FEE <input type="checkbox"/>
5. State Oil & Gas Lease No. K-4046	
7. Unit Agreement Name TRAIL CANYON UNIT	
8. Farm or Lease Name	
9. Well No. 1	
10. Field and Pool, or Wildcat WILDCAT	
12. County EDDY	
on ROW	20. Rotary or C.T. ROTARY
22. Approx. Date Work will start 4-11-74	

APPLICATION FOR PERMIT TO DRILL, DEEPEN, OR FLOG BACK

1. Type of Work a. Type of Well OIL WELL <input type="checkbox"/> GAS WELL <input checked="" type="checkbox"/> OTHER <input type="checkbox"/>				DRILL <input checked="" type="checkbox"/> DEEPEN <input type="checkbox"/> PLUG BACK <input type="checkbox"/>			
Name of Operator Amoco Production Company ✓				b. Address of Operator BOX 68, HOBBS, N. M. 88240			
1. Location of Well UNIT LETTER <u>D</u> LOCATED <u>900</u> FEET FROM THE <u>NORTH</u> LINE AND <u>500</u> FEET FROM THE <u>WEST</u> LINE OF SEC. <u>11</u> TWP. <u>24-S</u> RGE. <u>2-E</u> NMPM				19. Proposed Depth <u>10,800</u>			
1. Elevations (Show whether DF, RT, etc.) <u>NYA</u>				21A. Kind & Status Plug. Bond <u>BLANKET- ON FILE</u>		19A. Formation <u>MOR</u>	
21B. Drilling Contractor <u>NYA</u>							

PROPOSED CASING AND CEMENT PROGRAM

SIZE OF HOLE	SIZE OF CASING	WEIGHT PER FOOT	SETTING DEPTH	SACKS OF CEMENT	EST. TOP
17 1/2 "	13 3/8	48 #	250'	Circ.	
12 1/4 "	8 7/8 - 9 5/8	36-40 #	2300'	Circ.	
8 1/4 - 7 7/8 "	5 1/2	17-20 #	10800'	Full 600' above uppermost pay.	

BOP. see attached

Case # 5181
3-13-74
NSL-645
3-13-74

APPROVAL VALID
FOR 90 DAYS UNLESS
DRILLING COMMENCED,
EXPIRES 6-20-74

IN ABOVE SPACE DESCRIBE PROPOSED PROGRAM; IF PROPOSAL IS TO DEEPEN OR PLUG BACK, GIVE DATA ON PRESENT PRODUCTIVE ZONE AND PROPOSED NEW PRODUCTION ZONE. GIVE BLOWOUT PREVENTER PROGRAM, IF ANY.

I hereby certify that the information above is true and complete to the best of my knowledge and belief.

Signed James E. York Title AREA ENGINEER Date MAR 15 1974

(This space for State Use)

1-DIV
APPROVED BY *W. L. Gressett* TITLE **OIL AND GAS INSPECTOR**

CONDITIONS OF APPROVAL, IF ANY:
1- RRV

1-TEXACO OIL CO
1700 HOUSTON CLUB BLDG
HOUSTON TEXAS 77002

Cement must be circulated to surface behind 13 7/8" x 9 1/8" casing

DATE MAR 20 1974
 Notify N.M.O.C.C. in sufficient
 time to witness cementing
 the 578" or 9 5/8" casing

OIL CONSERVATION COMMISSION

P. O. BOX 2038

SANTA FE, NEW MEXICO 87501

March 13, 1974

RECEIVED

MAR 14 1974

Amoco Production Company
P. O. Box 68
Hobbs, New Mexico 88240

O. C. C.
ARTESIA, OFFICE

Attention: Alex Clarke, Jr.

Administrative Order NSL-645

Gentlemen:

Reference is made to your application for approval of a Wildcat gas well location for your Trail Unit Canyon Well No. 1 to be located 900 feet from the North line and 500 feet from the West line of Section 11, Township 24 South, Range 23 East, NMPM, Bddy County, New Mexico.

A waiver of objection has been received from Inexco Oil Company and the waiting period prescribed by Rule 104 F may be dispensed with in this instance.

By authority granted me under the provisions of Rule 104 F of the Commission Rules and Regulations, the above-described unorthodox location is hereby approved.

Very truly yours,

A. L. PORTER, Jr.
Secretary-Director

ALP/JEK/dr

cc: ✓ Oil Conservation Commission - Artesia
Oil & Gas Engineering Committee - Hobbs
State Land Office - Santa Fe

C
O
P
Y

NE EXICO OIL CONSERVATION COMMISSION
WELL LOCATION AND ACREAGE DEDICATION PLAT

Form C-102
Supersedes C-128
Effective 1-1-65

All distances must be from the outer boundaries of the Section.

AMOCO PRODUCTION CO.			Lease		TRAIL CANYON UNIT		Well No. 1	
Section	11	Township	24 SOUTH	Range	23 EAST	County		
EDDY								
Location of Well:								
900		feet from the		NORTH		line and		500
								feet from the
								WEST
NYA		Producing Formation		MORROW		Pool		WILDCAT
								Dedicated Acres
								320

- Outline the acreage dedicated to the subject well by colored pencil or hatchure marks on the plat below.
- If more than one lease is dedicated to the well, outline each and identify the ownership thereof (both as to working interest and royalty).
- If more than one lease of different ownership is dedicated to the well, have the interests of all owners been consolidated by communitization, unitization, force-pooling, etc?

☐ Yes ☐ No If answer is "yes," type of consolidation _____

If answer is "no," list the owners and tract descriptions which have actually been consolidated. (Use reverse side of this form if necessary.) _____

No allowable will be assigned to the well until all interests have been consolidated (by communitization, unitization, forced-pooling, or otherwise) or until a non-standard unit, eliminating such interests, has been approved by the Commission.

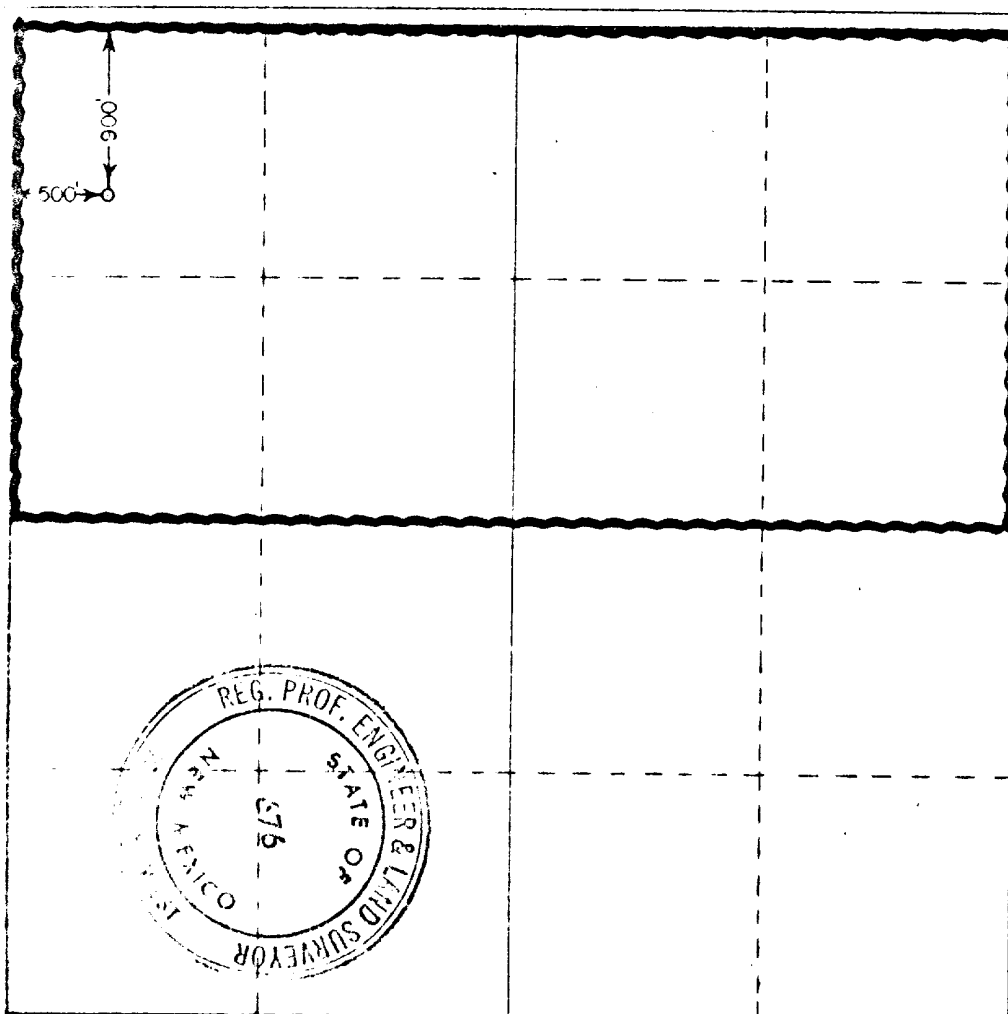

CERTIFICATION

I hereby certify that the information contained herein is true and complete, to the best of my knowledge and belief.

Name *James E. York*
Title
AREA ENGINEER

Company
Amoco Production Company

Date
MAR 15 1974

I hereby certify that the well location shown on this plat was plotted from field notes of actual surveys made by me or under my supervision, and that the same is true and correct to the best of my knowledge and belief.

Date Surveyed
FEBRUARY 14, 1974

Registered Professional Engineer
and/or Land Surveyor

John W. West
Certificate No. 676

130 660 100 1320 1680 1960 2310 2640 2000 1800 1000 800 0

BLOWOUT PREVENTER HOOK-UP FOR DRILLING BELOW INTERMEDIATE CASING

1. BLOWOUT PREVENTERS AND MASTER VALVE TO BE FLUID OPERATED AND ALL FITTINGS MUST BE IN GOOD CONDITION (MINIMUM: WP - 3000 PSI, TEST - 6000 PSI).
2. EQUIPMENT THROUGH WHICH BIT MUST PASS SHALL BE AS LARGE AS THE INSIDE DIAMETER OF CASING THAT IS BEING DRILLED THROUGH.
3. KELLY COCK REQUIRED (MINIMUM: 3000 PSI WP, 6000 PSI TEST)
4. OMSCO OR COMPARABLE SAFETY VALVE MUST BE AVAILABLE ON RIG FLOOR AT ALL TIMES WITH PROPER CONNECTION OR SUB. (MINIMUM: 3000 PSI WP, 6000 PSI TEST)

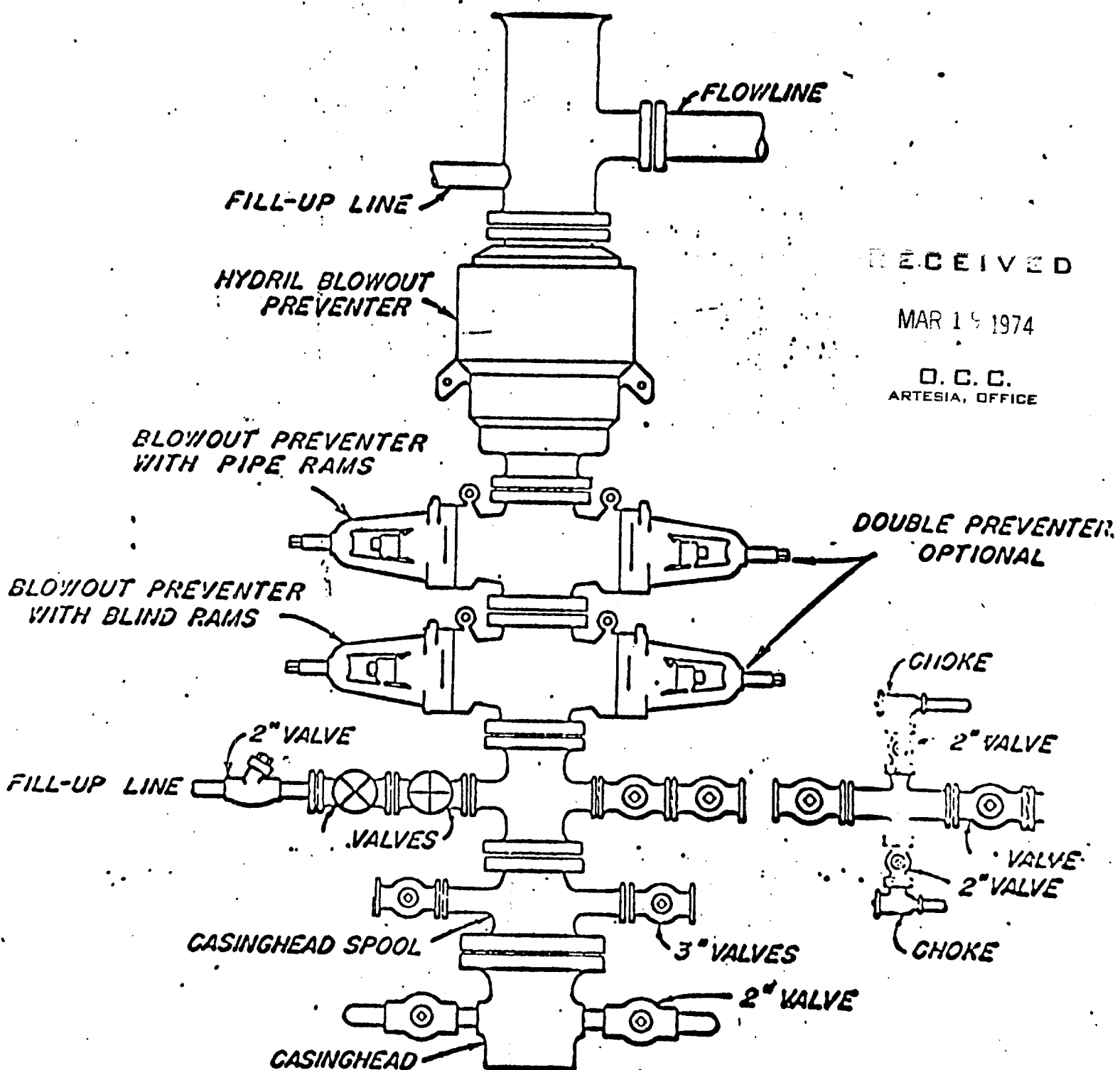

RECEIVED

MAR 19 1974

O. C. C.
ARTESIA, OFFICE

AMOCO PRODUCTION COMPANY

APRIL 13, 1973

TRAIL Canyon Unit #1
FROM C. WIP