

NEW MEXICO OIL CONSERVATION COMMISSION
WELL LOCATION AND ACREAGE DEDICATION PLAT

Form O-102
Supersedes C-128
Effective 1-1-63

All distances must be from the outer boundaries of the section.

Operator Yates Petroleum Corporation			Land Chaparral Fed.		Well No. #1
Unit Letter H	Section 17	Township 24 South	Range 24 East	County Eddy	
Actual Footage Location of Well:					
2310' feet from the North line		660' feet from the East line			
Ground Level Elev. 4127.3	Producing Formation Morrow	Brooked Creek Undesignated Morrow		Estimated Acreage 320	Acres

1. Outline the acreage dedicated to the subject well by colored pencil or hatchure marks on the plat below.
2. If more than one lease is dedicated to the well, outline each and identify the ownership thereof (both as to working interest and royalty).
3. If more than one lease of different ownership is dedicated to the well, have the interests of all owners been consolidated by communitization, unitization, force-pooling, etc?

☐ Yes ☐ No If answer is "yes," type of consolidation _____

If answer is "no," list the owners and tract descriptions which have actually been consolidated. (Use reverse side of this form if necessary.) _____

No allowable will be assigned to the well until all interests have been consolidated (by communitization, unitization, forced-pooling, or otherwise) or until a non-standard unit, eliminating such interests, has been approved by the Commission.

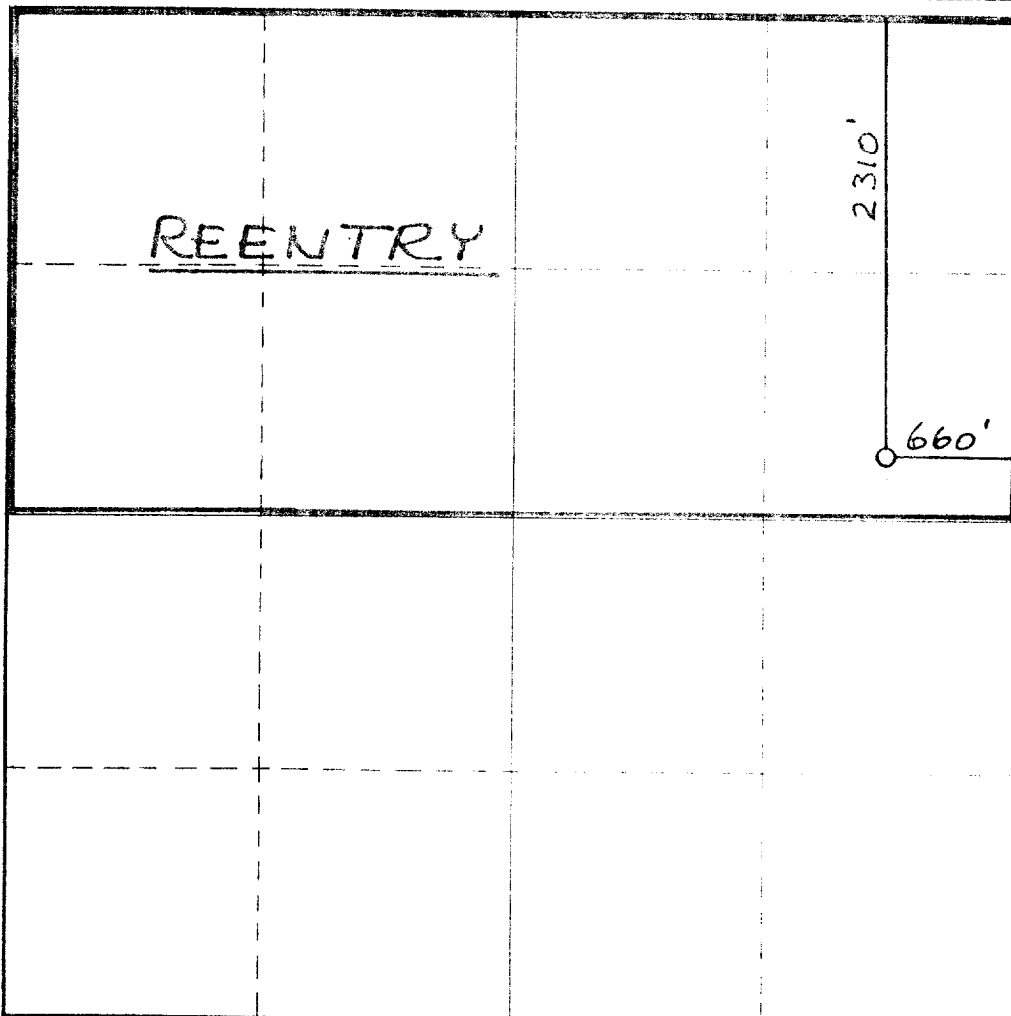

CERTIFICATION

I hereby certify that the information contained herein is true and complete to the best of my knowledge and belief.

Gliserio Rodriguez
Name
GLISERLO RODRIGUEZ
Title
GEOGRAPHER
Company
YATES PETROLEUM CORP.
Date
11-11-80

I hereby certify that the well location shown on this plat was plotted from field notes of actual surveys made by me or under my supervision, and that the same is true and correct to the best of my knowledge and belief.

Refer to Original Plate

The Surveyor

Witnessed and Forwarded to the
Surveyor and Operator

Filed into file

