

NO. OF COPIES RECEIVED 6

DISTRIBUTION

SANTA FE

FILE

U.S.G.S.

LAND OFFICE

OPERATOR

NEW MEXICO OIL CONSERVATION COMMISSION

RECEIVED

JUN 3 1974

O. C. C.  
ARTESIA, OFFICE

30-015-21236

Form C-101  
Revised 1-1-65

5A. Indicate Type of Lease  
STATE ☒ FEE ☐

5. State Oil & Gas Lease No.  
LG-0281

7. Unit Agreement Name

8. Farm or Lease Name  
Foster State

9. Well No.  
1

10. Field and Pool, or Wildcat  
Wildcat

12. County  
Eddy

19. Proposed Depth  
10,800'

19A. Formation  
Morrow

20. Rotary or C.T.  
Rotary

21. Elevations (Show whether DF, RT, etc.)  
Est. GL 4575', KB 4590'

21A. Kind & Status Plug, Bond  
Blanket on file

21B. Drilling Contractor  
Undetermined

22. Approx. Date Work will start  
July 1, 1974

APPLICATION FOR PERMIT TO DRILL, DEEPEN, OR PLUG BACK

1a. Type of Work  
DRILL ☒ DEEPEN ☐ PLUG BACK ☐

b. Type of Well  
OIL WELL ☐ GAS WELL ☒ OTHER ☐

2. Name of Operator  
INEXCO OIL COMPANY

3. Address of Operator  
1100 Milam Building, Suite 1900, Houston, Texas 77002

4. Location of Well  
UNIT LETTER E LOCATED 2310 FEET FROM THE North LINE  
AND 660 FEET FROM THE West LINE OF SEC. 8 TWP. 24S RGE. 23E NMPM

19. Proposed Depth  
10,800'

19A. Formation  
Morrow

20. Rotary or C.T.  
Rotary

21. Elevations (Show whether DF, RT, etc.)  
Est. GL 4575', KB 4590'

21A. Kind & Status Plug, Bond  
Blanket on file

21B. Drilling Contractor  
Undetermined

22. Approx. Date Work will start  
July 1, 1974

PROPOSED CASING AND CEMENT PROGRAM

SIZE OF HOLE	SIZE OF CASING	WEIGHT PER FOOT	SETTING DEPTH	SACKS OF CEMENT	EST. TOP
17-1/2"	13-3/8"	48#	350'	300	Surface
12-1/4"	8-5/8"	24#	2,800'	1,000	Surface
7-7/8"	5-1/2"	15.5 & 17#	10,800'	300	9,200'

It is proposed to drill to a total depth of 10,800' with rotary tools. New casing will be set and cemented as indicated above. Proper blowout prevention equipment will be set, tested, and periodically checked. Prudent drilling and safety procedures will be employed during all operations.

APPROVAL VALID  
FOR 90 DAYS UNLESS  
DRILLING COMMENCED,

EXPIRES 9-4-74

IN ABOVE SPACE DESCRIBE PROPOSED PROGRAM: IF PROPOSAL IS TO DEEPEN OR PLUG BACK, GIVE DATA ON PRESENT PRODUCTIVE ZONE AND PROPOSED NEW PRODUCTIVE ZONE. GIVE BLOWOUT PREVENTER PROGRAM, IF ANY.

I hereby certify that the information above is true and complete to the best of my knowledge and belief.

Signature W. A. Elstrom W. A. Elstrom Drilling Engineer Date May 14, 1974

(This space for State Use)

APPROVED BY W. A. Elstrom TITLE OIL AND GAS INSPECTOR DATE JUN 4 1974

CONDITIONS OF APPROVAL, IF ANY:

Cement must be circulated to surface behind 13 3/8" - 8 5/8" casing the 8 5/8"

Notify N.M.O.C.C. in sufficient time to witness cementing

NEW MEXICO OIL CONSERVATION COMMISSION  
WELL LOCATION AND ACREAGE DEDICATION PLAT

Form C-102  
Supersedes C-128  
Effective 1-1-65

All distances must be from the outer boundaries of the Section

Operator <b>Inexco Oil Company</b>			Lease <b>Foster State</b>		Well No. <b>1</b>
Unit Letter <b>E</b>	Section <b>8</b>	Township <b>24 South</b>	Range <b>23 East</b>	County <b>Eddy</b>	
Actual Footage Location of Well: <b>1980</b> feet from the <b>North</b> line and <b>660</b> feet from the <b>West</b> line					
Ground Level Elev. <b>4631.8</b>	Producing Formation <b>Morrow</b>		Pool <b>Wildcat</b>	Dedicated Acreage: <b>320</b> Acres	

1. Outline the acreage dedicated to the subject well by colored pencil or hatchure marks on the plat below.
2. If more than one lease is dedicated to the well, outline each and identify the ownership thereof (both as to working interest and royalty)
3. If more than one lease of different ownership is dedicated to the well, have the interests of all owners been consolidated by communitization, unitization, force-pooling, etc?

**RECEIVED**

**JUN 3 1974**

☐ Yes ☐ No If answer is "yes," type of consolidation \_\_\_\_\_

If answer is "no," list the owners and tract descriptions which have actually been consolidated (reverse side of this form if necessary.) \_\_\_\_\_

**O.C.C.**  
**ARTESIA, OFFICE**

No allowable will be assigned to the well until all interests have been consolidated (by communitization, unitization, forced-pooling, or otherwise) or until a non-standard unit, eliminating such interests, has been approved by the Commission.

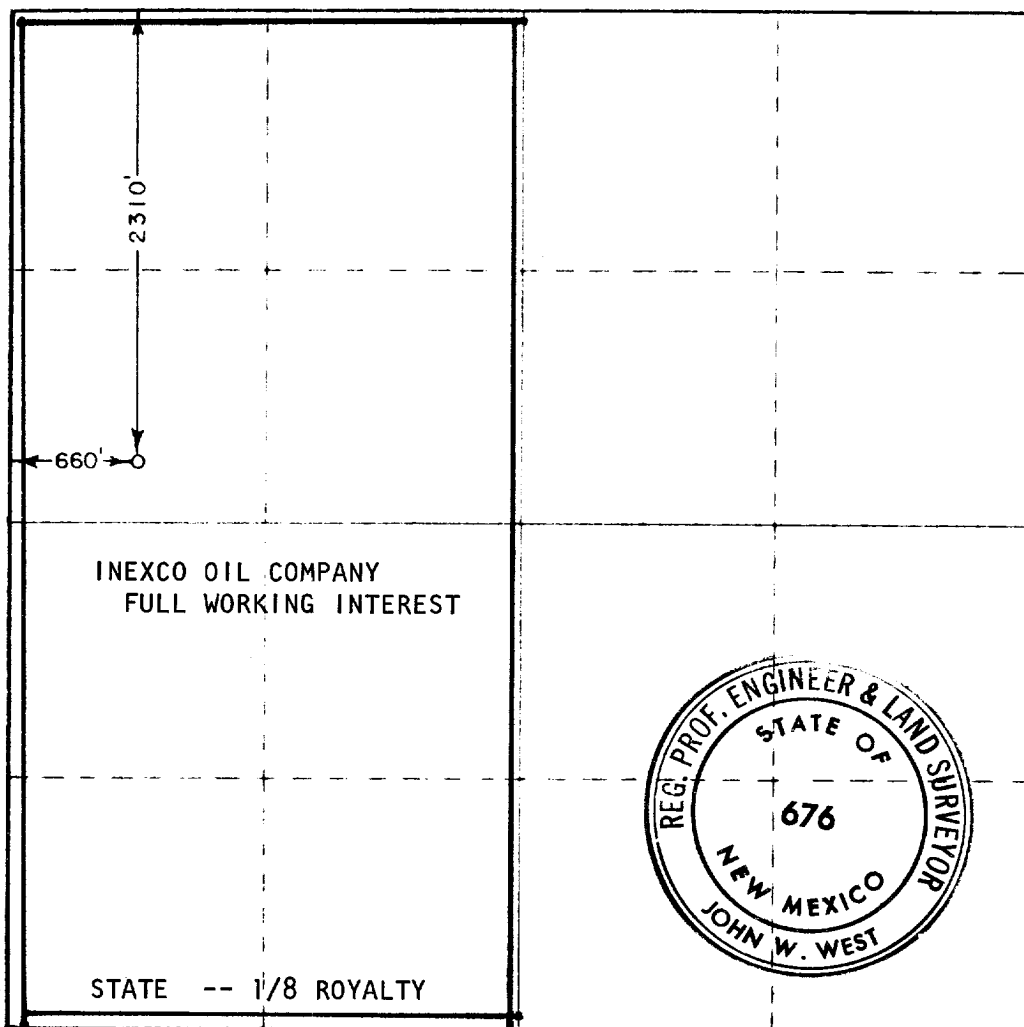

CERTIFICATION

I hereby certify that the information contained herein is true and complete to the best of my knowledge and belief.

*Terry W. Ellstrom*  
Name

Terry W. Ellstrom

Position

Drilling Engineer

Company

INEXCO OIL COMPANY

Date

May 28, 1974

I hereby certify that the well location shown on this plat was plotted from field notes of actual surveys made by me or under my supervision, and that the same is true and correct to the best of my knowledge and belief.

Date Surveyed

May 9, 1974

Registered Professional Engineer and/or Land Surveyor

*John W. West*  
Certificate No. 676