

NEW MEXICO OIL CONSERVATION COMMISSION
WELL LOCATION AND ACREAGE DEDICATION PLAT

NOV - 1 1974

Form C-102
Supersedes C-128
Effective 1-1-65

All distances must be from the outer boundaries of the Section.

Operator AMERICAN OUASAR PETROLEUM CO. OF NEW MEXICO			Lease Huber State		Well No. 1
Unit Letter F	Section 36	Township 23S	Range 22E	County Eddy	
Actual Footage Location of Well: 2310 feet from the North line and 2410 feet from the West line					
Ground Level Elev. 4410	Producing Formation Morrow		Pool Wildcat		Dedicated Acreage: 320 Acres

1. Outline the acreage dedicated to the subject well by colored pencil or hachure marks on the plat below.
2. If more than one lease is dedicated to the well, outline each and identify the ownership thereof (both as to working interest and royalty).
3. If more than one lease of different ownership is dedicated to the well, have the interests of all owners been consolidated by communitization, unitization, force-pooling, etc?

☐ Yes ☐ No If answer is "yes," type of consolidation N/A

If answer is "no," list the owners and tract descriptions which have actually been consolidated. (Use reverse side of this form if necessary.) N/A

No allowable will be assigned to the well until all interests have been consolidated (by communitization, unitization, forced-pooling, or otherwise) or until a non-standard unit, eliminating such interests, has been approved by the Commission.

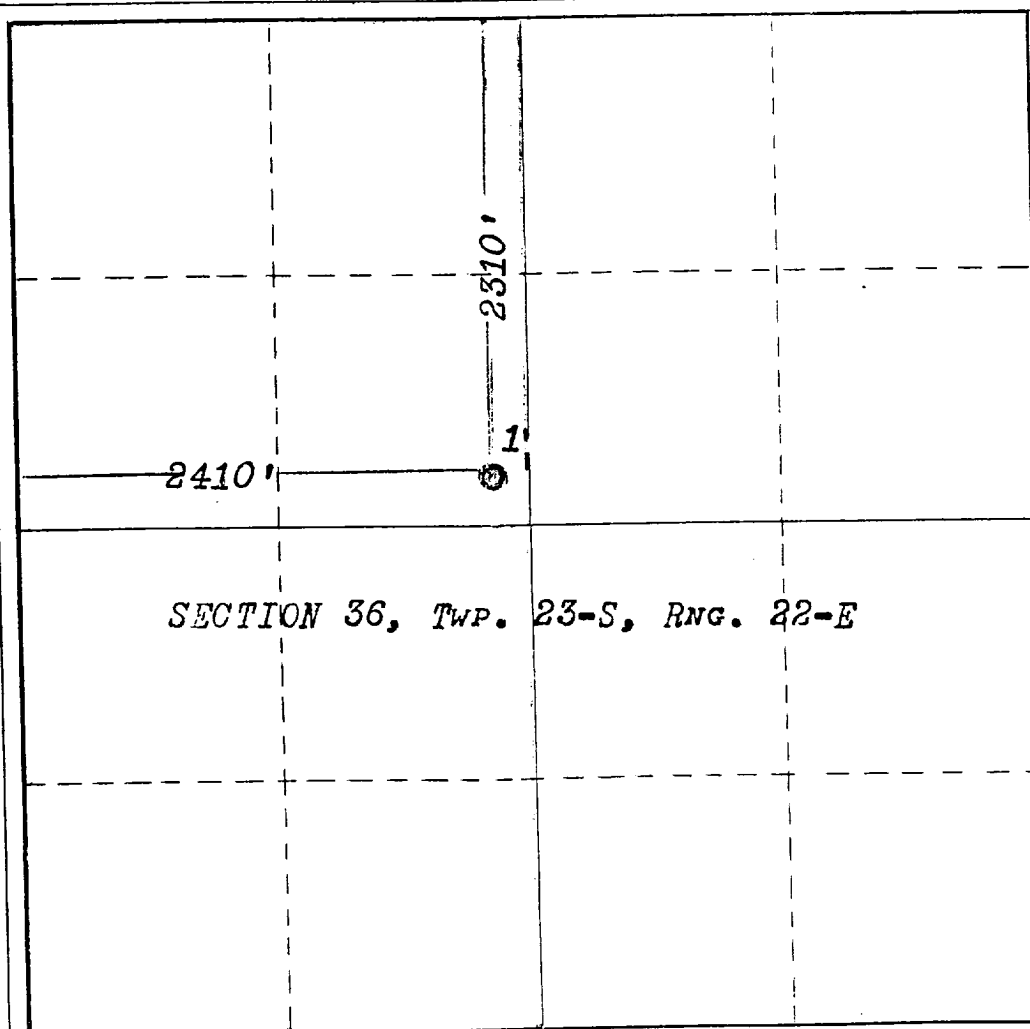

CERTIFICATION

I hereby certify that the information contained herein is true and complete to the best of my knowledge and belief.

Name Lynn D. Jones
Position Mgr. of Operations
Company American Quasar Petrol Co. of New Mexico
Date November 1, 1974

I hereby certify that the well location shown on this plat was plotted from field notes of actual surveys made by me or under my supervision, and that the same is true and correct to the best of my knowledge and belief.

Date Surveyed Oct. 29, 1974
Registered Professional Engineer and/or Land Surveyor
[Signature]
Certificate No. 754