

NEW MEXICO OIL CONSERVATION COMMISSION
WELL LOCATION AND ACREAGE DEDICATION PLAT

Form C-102
Supersedes C-128
Effective 1-1-65

All distances must be from the outer boundaries of the Section.

Operator COQUINA OIL CORP.		Lease JAKE-STATE		Well No. 2
Unit Letter "C"	Section 36	Township 24-S	Range 26-E	County EDDY
Actual Footage Location of Well: 660 feet from the NORTH line and 2180 feet from the WEST line				
Ground Level Elev. (EST) 3300	Producing Formation MORROW	Pool <i>in lease</i> CRAWFORD	Dedicated Acreage: 320 Acres	

1. Outline the acreage dedicated to the subject well by colored pencil or hachure marks on the plat below.
2. If more than one lease is dedicated to the well, outline each and identify the ownership thereof (both as to working interest and royalty).
3. If more than one lease of different ownership is dedicated to the well, have the interests of all owners been consolidated by communitization, unitization, force-pooling, etc?

☐ Yes ☐ No If answer is "yes," type of consolidation _____

If answer is "no," list the owners and tract descriptions which have actually been consolidated. (Use reverse side of this form if necessary.) _____

No allowable will be assigned to the well until all interests have been consolidated (by communitization, unitization, forced-pooling, or otherwise) or until a non-standard unit, eliminating such interests, has been approved by the Commission.

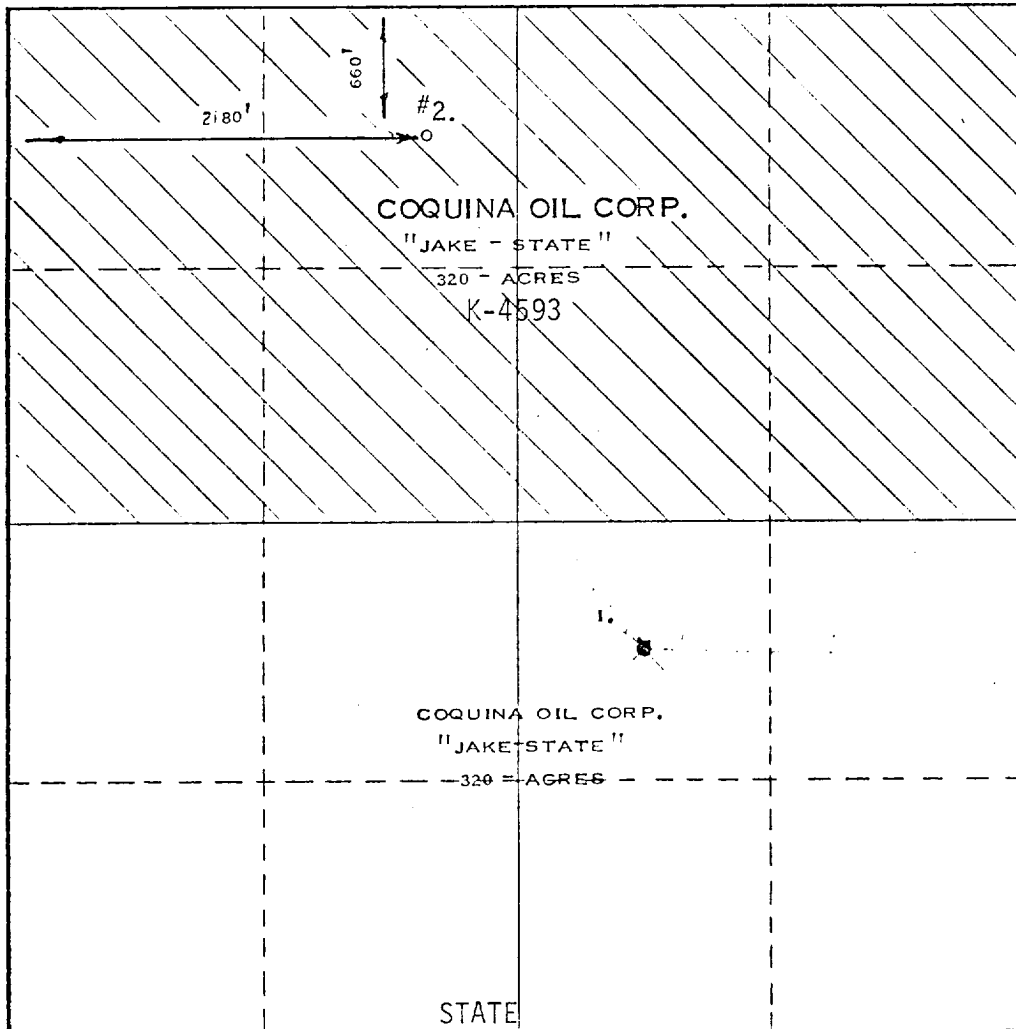

CERTIFICATION

I hereby certify that the information contained herein is true and complete to the best of my knowledge and belief.

Name
J. T. Berry

Position
Superintendent

Company
Coquina Oil Corporation

Date
April 18, 1975

I hereby certify that the well location shown on this plat was plotted from field notes of actual surveys made by me or under my supervision, and that the same is true and correct to the best of my knowledge and belief.

Date Surveyed
APRIL 18, 1975

Registered Professional Engineer and/or Land Surveyor

Max A. Schumann Jr.
MAX A. SCHUMANN JR.

Certificate No.
1510

0 330 660 990 1320 1650 1980 2310 2640 2970 3300 3630 3960 4290 4620 4950 5280 5610 5940 6270 6600

BILL GRESSET

3:45 PM, 7-24-75

Dwayne.

7 $\frac{9}{8}$ " liner 8028 - 10633

TD 11955 manna 11300

det. 12290-296 1260' X W

det. 11500-556 60' gem.

det. 11656-736 2125' X W

Poro. 11700

355X 11600-700

355X 11200-300

355X 10600-700

Comp. in Str. Grand 10500

Religient reports will be
in next week.