

UNITED STATES
DEPARTMENT OF THE INTERIOR
GEOLOGICAL SURVEY

SUNDRY NOTICES AND REPORTS ON WELLS

(Do not use this form for proposals to drill or to deepen or plug back to a different reservoir. Use Form 9-331-C for such proposals.)

1. oil well ☐ gas well ☒ other

MAR 13 1979

2. NAME OF OPERATOR
Exxon Corporation ✓

O. C. C.

3. ADDRESS OF OPERATOR
P. O. Box 1600, Midland, Texas 79702

ARTERIA OFFICE

4. LOCATION OF WELL (REPORT LOCATION CLEARLY. See space 17 below.)

AT SURFACE: 1,380'FSL & 990'FEL of Section

AT TOP PROD. INTERVAL:

Section

AT TOTAL DEPTH:

16. CHECK APPROPRIATE BOX TO INDICATE NATURE OF NOTICE, REPORT, OR OTHER DATA

REQUEST FOR APPROVAL TO:

SUBSEQUENT REPORT OF:

TEST WATER SHUT-OFF ☐
FRACTURE TREAT ☐
SHOOT OR ACIDIZE ☐
REPAIR WELL ☐
PULL OR ALTER CASING ☐
MULTIPLE COMPLETE ☐
CHANGE ZONES ☒
ABANDON* ☐
(other) ☐

☐
☐
☐
☐
☐
☐
☐
☐
☐

5. LEASE

NM 23177

6. IF INDIAN, ALLOTTEE OR TRIBE NAME

7. UNIT AGREEMENT NAME

Laguna Grande Unit

8. FARM OR LEASE NAME

Laguna Grande Unit (Federal)

9. WELL NO.

1

10. FIELD OR WILDCAT NAME

Wildcat Strawn

11. SEC., T., R., M., OR BLK. AND SURVEY OR AREA

Sec. 28, T-23-S, R-29-E

12. COUNTY OR PARISH

Eddy

13. STATE

New Mexico

14. API NO.

30-015-21636

15. ELEVATIONS (SHOW DF, KDB, AND WD)

3,003'DF

(NOTE: Report results of multiple completion or zone change on Form 9-330.)

17. DESCRIBE PROPOSED OR COMPLETED OPERATIONS (Clearly state all pertinent details, and give pertinent dates, including estimated date of starting any proposed work. If well is directionally drilled, give subsurface locations and measured and true vertical depths for all markers and zones pertinent to this work.)*

It is proposed to plug back from the Morrow Zone (13,107'-13,258') and recompleate in the Strawn Zone (11,888' - 11,900').

It is proposed to run a cast iron bridge plug to 13,000' on wireline and dump bail 3 sacks of cement on top. Plug will be set 35' above cast iron bridge plug. The zone from 11,888'-11,900' will be perforated.

Subsurface Safety Valve: Manu. and Type

Set @ _____ Ft.

18. I hereby certify that the foregoing is true and correct

SIGNED Micera Knippling TITLE Proration Specialist DATE March 2, 1979

(This space for Federal or State office use)

APPROVED BY Joe D. Lara
CONDITIONS OF APPROVAL, IF ANY:

TITLE ACTING DISTRICT ENGINEER

DATE

MAR 12 1979

Exxon Lse. No. _____ NEW MEXICO OIL CONSERVATION COMMISSION
State Lse. No. _____ WELL LOCATION AND ACREAGE DEDICATION PLAT
Federal Lse. No. NM-23177

Form C-102
Supersedes C-128
Effective 1-1-65

All distances must be from the outer boundaries of the Section.

Operator Exxon Corporation			Lease Laguna Grande Unit (Federal)		Well No. 1
Unit Letter I	Section 28	Township 23 South	Range 29 East	County Eddy	
Actual Footage Location of Well: 1380 feet from the South line and 990 feet from the East line					
Ground Level Elev. Strawn	Producing Formation Strawn		Pool Laguna Grande (Strawn)		Dedicated Acreage: 320 Acres

1. Outline the acreage dedicated to the subject well by colored pencil or hachure marks on the plat below.
2. If more than one lease is dedicated to the well, outline each and identify the ownership thereof (both as to working interest and royalty).
3. If more than one lease of different ownership is dedicated to the well, have the interests of all owners been consolidated by communitization, unitization, force-pooling, etc?

☐ Yes ☐ No If answer is "yes," type of consolidation _____

If answer is "no," list the owners and tract descriptions which have actually been consolidated. (Use reverse side of this form if necessary.) _____

No allowable will be assigned to the well until all interests have been consolidated (by communitization, unitization, forced-pooling, or otherwise) or until a non-standard unit, eliminating such interests, has been approved by the Commission.

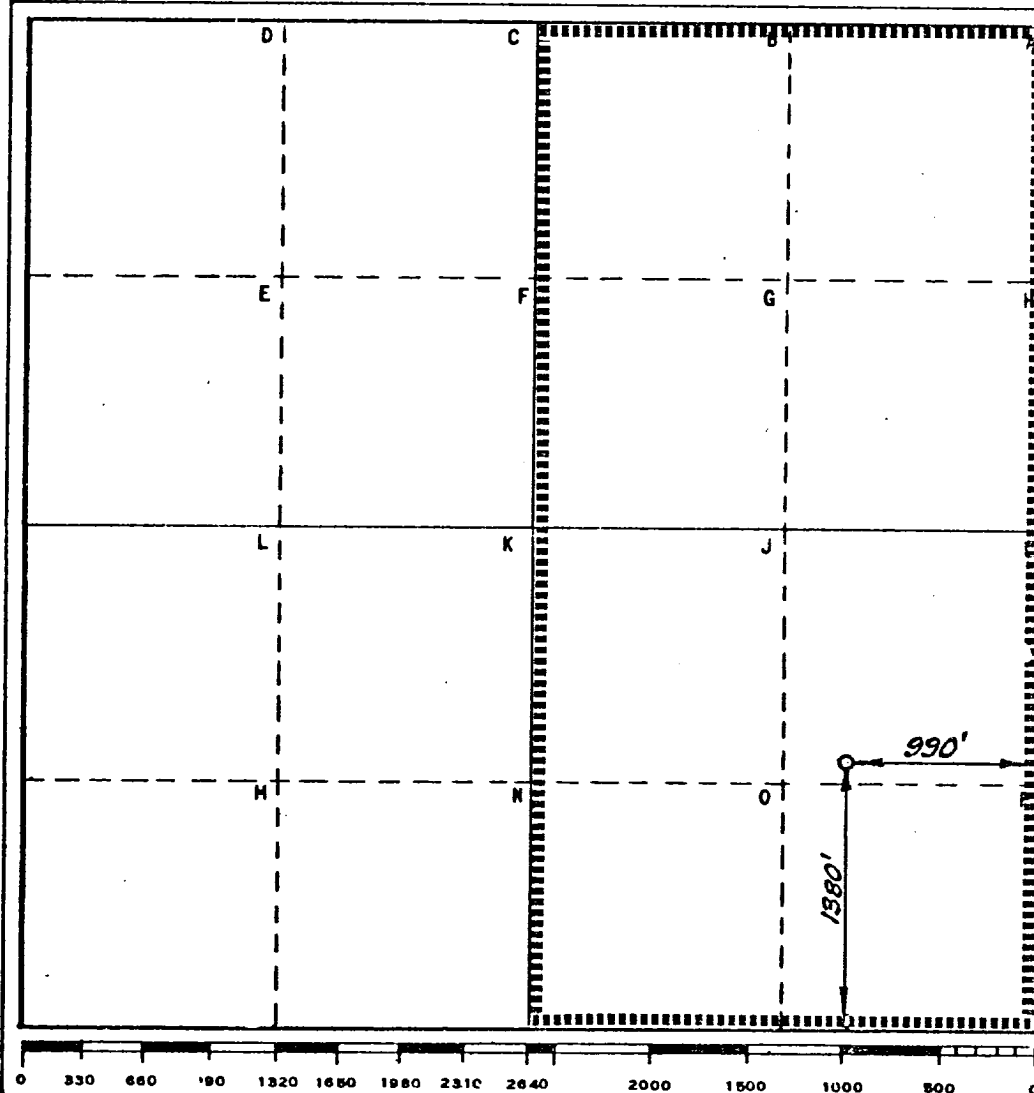

CERTIFICATION

I hereby certify that the information contained herein is true and complete to the best of my knowledge and belief.

Name

Melba Knepling

Position

Proration Specialist

Company Exxon Corporation

Box 1600 Midland, Texas

Date

March 2, 1979

I hereby certify that the well location shown on this plat was plotted from field notes of actual surveys made by me or under my supervision, and that the same is true and correct to the best of my knowledge and belief.

Date Surveyed

August 13, 1975

Registered Professional Engineer and/or Land Surveyor

H. L. Westorf

Certificate No.

1382